

STATE OF ILLINOIS  
DEPARTMENT OF TRANSPORTATION  
DIVISION OF HIGHWAYS

**PROPOSED  
HIGHWAY PLANS**

FAP ROUTE 573 (US 30) & FAP ROUTE 68 (IL 23)  
SECTION (116) I-2 & (30, 31) I  
PROJECT: ACHSIP-000V (026)  
SHOULDER WIDENING AND RUMBLE STRIPS  
DEKALB COUNTY

C-93-092-15

F.A.P. R.T.E. VAR	SECTION (116) I-2 & (30, 31) I ILLINOIS	COUNTY DEKALB	TOTAL SHEETS 6	SHEET NO. 1
			CONTRACT NO. 66E71	

INDEX OF SHEETS

- 1 COVER SHEET
- 2 GENERAL NOTES
- 3 SUMMARY OF QUANTITIES
- 4 TYPICAL SECTIONS
- 5 SCHEDULES
- 6 DETAILS

STANDARDS

000001-08	STANDARD SYMBOLS, ABBREVIATIONS AND PATTERNS
001006	DECIMAL OF AN INCH AND OF A FOOT
406201-01	MAILBOX TURNOUT
482001-02	HMA SHOULDER ADJACENT TO FLEXIBLE PAVEMENT
482006-03	HMA SHOULDER ADJACENT TO RIGID PAVEMENT
642006	SHOULDER RUMBLE STRIPS, 8 INCH
701306-03	LANE CLOSURE, 2L, 2W, SLOW MOVING OPERATIONS DAY ONLY, FOR SPEEDS ≥ 45 MPH
701311-03	LANE CLOSURE, 2L, 2W, MOVING OPERATIONS - DAY ONLY
701326-04	LANE CLOSURE, 2L, 2W, PAVEMENT WIDENING, FOR SPEEDS ≥ 45 MPH
701901-04	TRAFFIC CONTROL DEVICES



LOCATION OF SECTION INDICATED THIS: - [shaded box] -

**US 30, RURAL MINOR ARTERIAL**  
2013 ADT = 4000  
P.V. = 86.2% S.U. = 3.8% M.U. = 10.0%

**IL 23, RURAL MINOR ARTERIAL**  
2013 ADT = 1950  
P.V. = 85.6% S.U. = 4.1% M.U. = 10.3%

STATE OF ILLINOIS  
DEPARTMENT OF TRANSPORTATION  
DIVISION OF HIGHWAYS

SUBMITTED *March 27 2015*  
*Paul Coste*  
DEPUTY DIRECTOR OF HIGHWAYS, REGION ENGINEER

*May 8 2015*  
*David D. Baranzelli* P.E.  
ENGINEER OF DESIGN AND ENVIRONMENT

*May 8 2015*  
*Onker Osman* P.E.  
DIRECTOR OF HIGHWAYS, CHIEF ENGINEER

**PRINTED BY THE AUTHORITY  
OF THE STATE OF ILLINOIS**

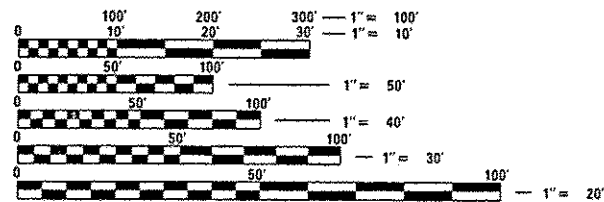

FULL SIZE PLANS HAVE BEEN PREPARED USING STANDARD ENGINEERING SCALES. REDUCED SIZED PLANS WILL NOT CONFORM TO STANDARD SCALES. IN MAKING MEASUREMENTS ON REDUCED PLANS, THE ABOVE SCALES MAY BE USED.

J.U.L.I.E.  
JOINT UTILITY LOCATION INFORMATION FOR EXCAVATION  
1-800-892-0123  
OR 811

PROJECT ENGINEER: SCOTT FERGUSON, P.E.  
UNIT CHIEF: MARC BUDZYNSKI  
DISTRICT 3 NO. (815) 434-6131  
CONTRACT NO. 66E71

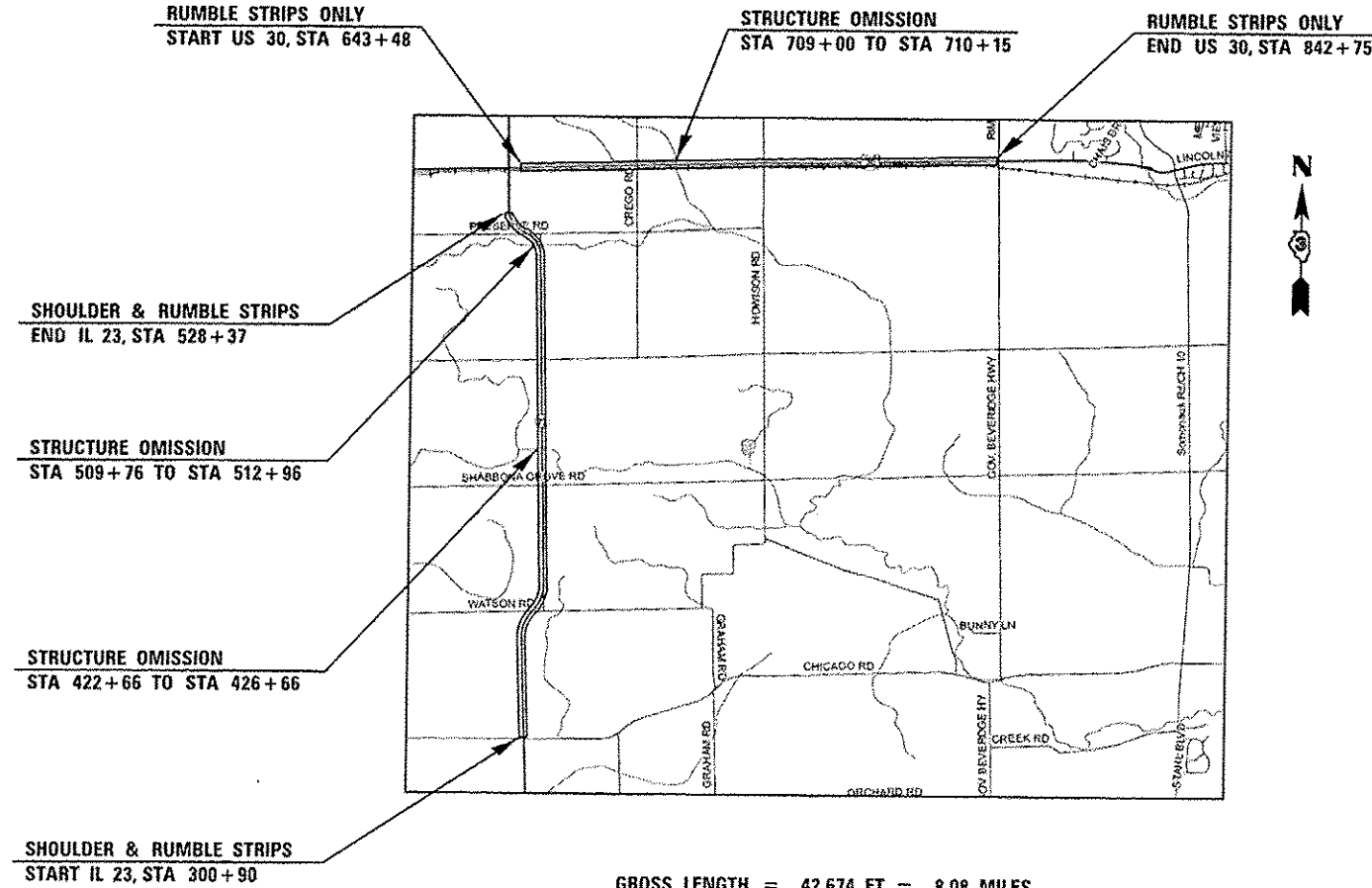

GROSS LENGTH = 42,674 FT. = 8.08 MILES  
NET LENGTH = 41,839 FT. = 7.92 MILES

GENERAL NOTES

THE THICKNESS OF HMA SHOWN ON THE PLANS IS THE NOMINAL THICKNESS. DEVIATIONS FROM THE NOMINAL THICKNESS WILL BE PERMITTED WHEN SUCH DEVIATIONS OCCUR DUE TO IRREGULARITIES IN THE EXISTING SURFACE OR BASE ON WHICH THE HMA IS PLACED.

THE HMA SURFACE OF ALL MAILBOX TURNOUTS, PRIVATE ENTRANCES, COMMERCIAL ENTRANCES, AND SIDE ROADS SHALL BE MADE NEATLY, IN A WORKMANLIKE MANNER, AND SHALL ACCURATELY CONFORM TO THE SHAPES AND DIMENSIONS SHOWN ON THE PLAN DETAILS. IF REQUIRED BY THE ENGINEER, THE CONTRACTOR SHALL SAW CUT THE HMA SURFACE TO CONFORM TO THE SHAPES AND DIMENSIONS SHOWN ON THE PLAN DETAILS. THIS WORK WILL BE INCLUDED IN THE COST OF THE HMA SURFACE.

THE ENGINEER WILL BE THE SOLE JUDGE CONCERNING CURING TIME FOR THE VARIOUS HMA LIFTS.

FOR STABILIZATION, ALL TYPE III BARRICADES WILL REQUIRE A MINIMUM OF FOUR SAND BAGS PER BARRICADE.

ALL EXCAVATED MATERIAL, WHICH INCLUDES DIGGING OR GRADING OF ANY SOIL OR FILL MATERIAL, WITH THE EXCEPTION OF AGGREGATE FILLS, MUST BE INCORPORATED WITHIN THE IDOT RIGHT OF WAY DUE TO ENVIRONMENTAL DOCUMENTATION REQUIREMENTS.

ON EXISTING PAVEMENT WHICH MAY BE SUPERELEVATED, THE NEW HMA PAVEMENT SHALL BE BUILT WITH THE SAME SUPERELEVATION UNLESS NEW SUPERELEVATION RATES ARE GIVEN ON THE PLANS.

ANY REFERENCE TO A STANDARD IN THESE PLANS SHALL BE INTERPRETED TO MEAN THE EDITION AS INDICATED BY THE SUBNUMBER SHOWN IN THE LIST OF STANDARDS OR THE COPY INCLUDED IN THESE PLANS.

THE FOLLOWING RATES OF APPLICATION HAVE BEEN USED IN CALCULATING PLAN QUANTITIES:

HMA RESURFACING	112	LBS / SQ YD / IN
-----------------	-----	------------------

MEMBERS OF JULIE KNOWN TO BE WITHIN THE LIMITS OF THE IMPROVEMENT ARE:

NON-MEMBERS OF JULIE KNOWN TO BE WITHIN THE LIMITS OF THE IMPROVEMENT ARE:

THE CONTRACTOR SHALL CONTACT JULIE AT LEAST 48 HOURS PRIOR TO EXCAVATION TO DETERMINE WHICH UTILITIES ARE IN THE AREA.

COMMITMENTS:

STATE OF ILLINOIS  
DEPARTMENT OF TRANSPORTATION  
DISTRICT THREE

PREPARED BY: Tom Beamin  
DISTRICT STUDIES & PLANS ENGINEER

DATE: March 27, 2015

EXAMINED BY: Herb Jung  
DISTRICT CONSTRUCTION ENGINEER

Wayne Phillips  
DISTRICT MATERIALS ENGINEER

Bruce A. Anderson  
DISTRICT OPERATIONS ENGINEER

FILE NAME *	USER NAME * budzynskim	DESIGNED -	REVISED -	<b>STATE OF ILLINOIS DEPARTMENT OF TRANSPORTATION</b>	<b>GENERAL NOTES</b>	F.A.P. RTE.	SECTION	COUNTY	TOTAL SHEETS	SHEET NO.	
c:\pwwork\pwwork\budzynskim\d0427389\d0	66E71-sh1-details.dgn	DRAWN -	REVISED -			VAR	(116) 1-2 & (30, 31) 1	DEKALB	6	2	
	PLOT SCALE * 1/8"=1'-0" / in.	CHECKED -	REVISED -			CONTRACT NO. 66E71					
	PLOT DATE * 3/27/2015	DATE -	REVISED -			ILLINOIS FED. AID PROJECT					
					SCALE:	SHEET OF SHEETS		STA.	TO STA.		

90% FED. / 10% STATE

CONSTR. CODE

CODE NO.	ITEM	UNIT	TOTAL QUANTITY	ROADWAY
				0021 RURAL
20200600	EXCAVATING AND GRADING EXISTING SHOULDER	UNIT	441	441
40600275	BITUMINOUS MATERIALS (PRIME COAT)	POUND	8847	8847
40800050	INCIDENTAL HOT-MIX ASPHALT SURFACING	TON	9.2	9.2
44000157	HOT-MIX ASPHALT SURFACE REMOVAL, 2"	SQ YD	81.8	81.8
48203029	HOT-MIX ASPHALT SHOULDERS, 8"	SO YD	19580	19580
64200108	SHOULDER RUMBLE STRIPS, 8 INCH	FOOT	83678	83678
67100100	MOBILIZATION	L SUM	1.0	1.0
70100460	TRAFFIC CONTROL AND PROTECTION, STANDARD 701306	L SUM	1.0	1.0
70100500	TRAFFIC CONTROL AND PROTECTION, STANDARD 701326	L SUM	1.0	1.0
70103815	TRAFFIC CONTROL SURVEILLANCE	CAL DA	40	40
* 78001110	PAINT PAVEMENT MARKING - LINE 4"	FOOT	88108	88108
X0800001	SHOULDER REMOVAL (SPECIAL)	SO YD	19580	19580
Z0030850	TEMPORARY INFORMATION SIGNING	SO FT	42	42

13

\* Specialty Items

FILE NAME =	USER NAME = budzynskim	DESIGNED -	REVISED -	<b>STATE OF ILLINOIS DEPARTMENT OF TRANSPORTATION</b>	<b>SUMMARY OF QUANTITIES</b>	F.A.P. RTE.	SECTION	COUNTY	TOTAL SHEETS	SHEET NO.	
66671-ehtr-detail.dgn	66671-ehtr-detail.dgn	DRAWN -	REVISED -			VAR	(16) 1-2 & 130, 31) 1	DEKALB	6	3	
PLOT SCALE = 1/8" = 1' / in.		CHECKED -	REVISED -			SCALE: SHEET OF SHEETS STA. TO STA.		CONTRACT NO. 66E71			
PLOT DATE = 3/27/2015		DATE -	REVISED -			ILLINOIS FED. AID PROJECT					

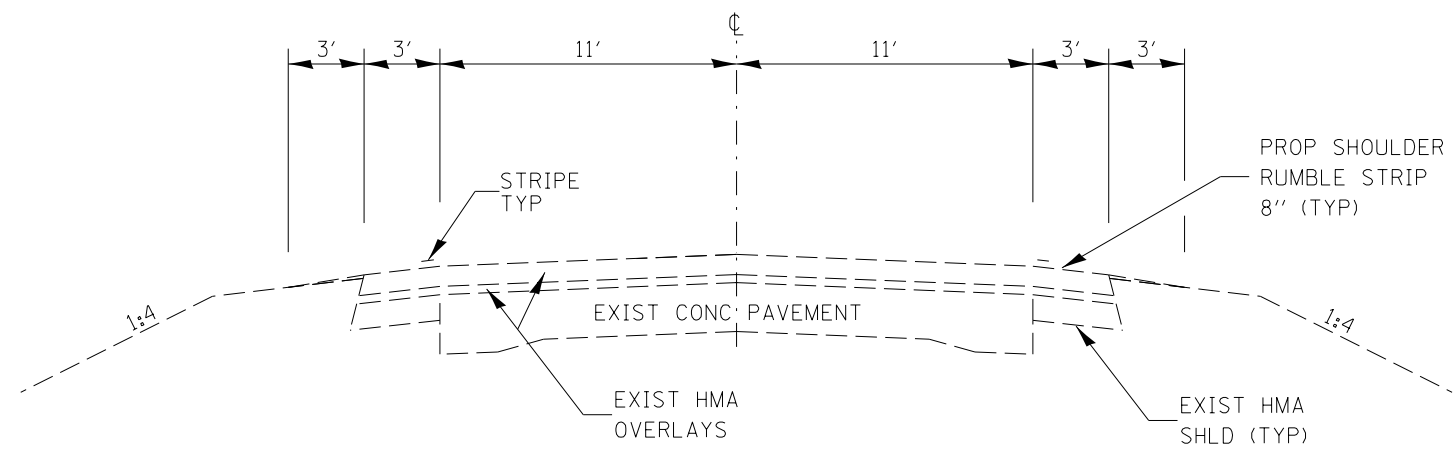

**PROPOSED TYPICAL SECTION (US 30)**

STA. 643+48 TO STA. 842+75

HMA MIXTURE REQUIREMENT TABLE		
LOCATION(S):	STA. 300+90 TO STA. 528+37	
MIXTURE USE(S):	SHOULDER BOTTOM LIFT(S)	SHOULDER TOP LIFT (2'')
BINDER GRADE (PG):	PG 64-22	PG 64-22
DESIGN AIR VOIDS:	4.0% @ N50	4.0% @ N50
MIXTURE COMPOSITION: (MIXTURE GRADATION):	IL-19.0 FG	IL-9.5 FG
FRICTION AGGREGATE:	-	MIXTURE C
MIXTURE WEIGHT:	112.0 LB/SY/IN	112.0 LB/SY/IN
QUALITY MANAGEMENT PROGRAM:	QC/QA	QC/QA
SUBLOT SIZE:	N/A	N/A
DENSITY TEST METHOD:	CORES	% GROWTH CURVE

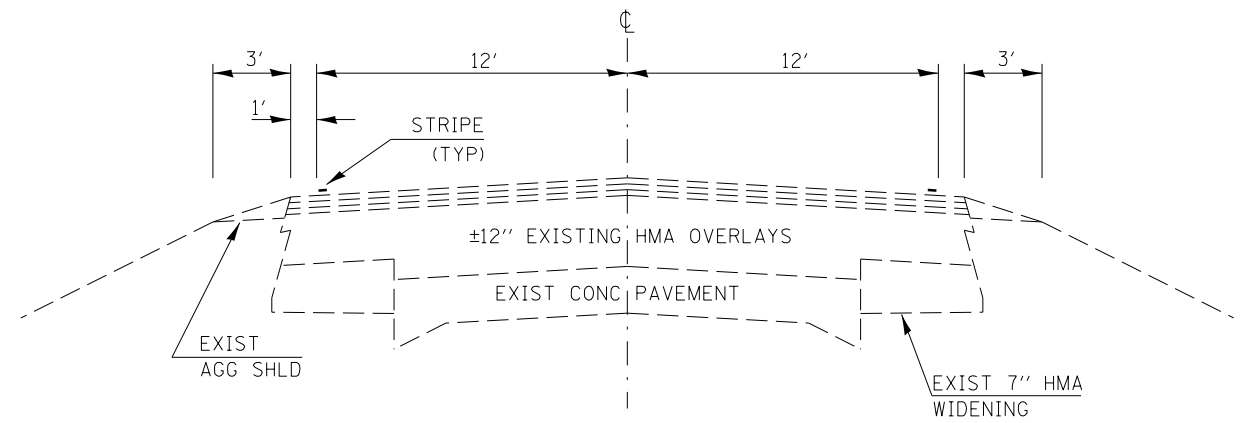

**EXISTING TYPICAL SECTION (IL 23)**

STA. 300+90 TO STA. 528+37

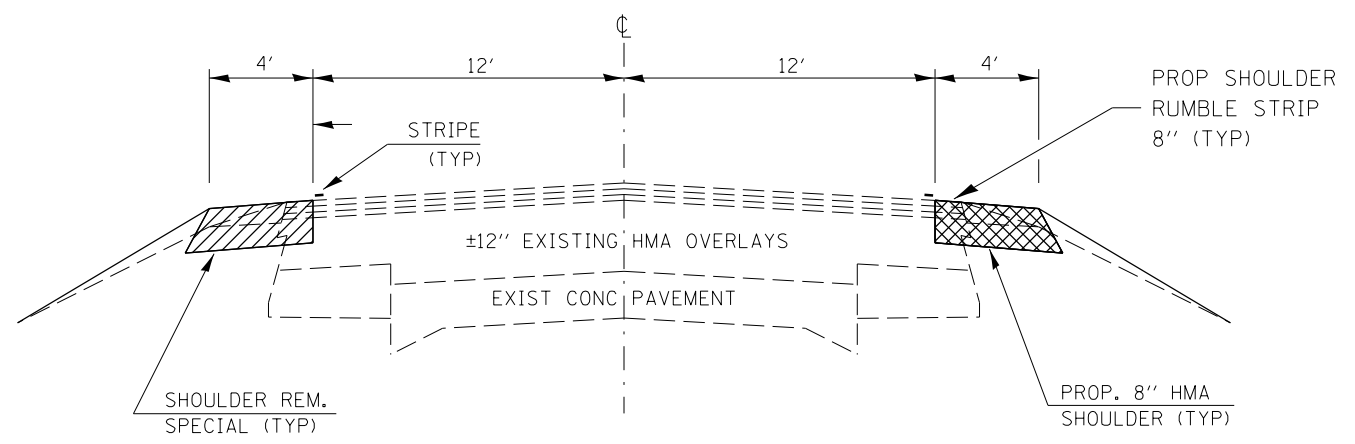

**PROPOSED TYPICAL SECTION (IL 23)**

STA. 300+90 TO STA. 528+37

FILE NAME =	USER NAME = budzynskim	DESIGNED -	REVISED -
ca:\pw\work\p\dot\budzynskim\d0427309\066E71-sht-details.dgn		DRAWN -	REVISED -
PLOT SCALE = 100.0000' / in.		CHECKED -	REVISED -
PLOT DATE = 3/27/2015		DATE -	REVISED -

**STATE OF ILLINOIS  
DEPARTMENT OF TRANSPORTATION**

**TYPICAL SECTIONS**

SCALE: SHEET OF SHEETS STA. TO STA.

F.A.P. RTE.	SECTION	COUNTY	TOTAL SHEETS	SHEET NO.
VAR	(116) I-2 & (30, 31) I	DEKALB	6	4
			CONTRACT NO. 66E71	
ILLINOIS FED. AID PROJECT				

SHOULDER REMOVAL & REPLACEMENT SCHEDULE								
LOCATION			LENGTH	SHOULDER REMOVAL (SPECIAL)	HMA SHOULDERS 8"	BIT MTLs PRIME COAT	SHOULDER RUMBLE STRIPS 8"	PAINT PVMT MARKING 4"
STA	TO	STA	FOOT	SQ YD	SQ YD	POUND	FOOT	FOOT
<b>IL 23</b>								
300+90	TO	422+66	12176	10823	10823	4870	24352	48704
STRUCTURE OMISSION								
426+66	TO	509+76	8310	7387	7387	3324	16620	33240
STRUCTURE OMISSION								
512+96	TO	528+37	1541	1370	1370	616	3082	6164
<b>US 30</b>								
643+48	TO	709+00	6552				13104	
STRUCTURE OMISSION								
710+15	TO	842+75	13260				26520	
<b>TOTAL</b>								
			<b>41839</b>	<b>19580</b>	<b>19580</b>	<b>8811</b>	<b>83678</b>	<b>88108</b>

MAILBOX TURNOUT REMOVAL & REPLACEMENT SCHEDULE					
LOCATION	AREA	HMA SURF REMOVAL 2"	INCIDENTAL HMA SURF 2"	BIT MTLs PRIME COAT	
	SQ YD	SQ YD	TON	POUND	
STA 479+49	40.9	40.9	4.6	18	
STA 502+48	40.9	40.9	4.6	18	
<b>TOTAL</b>					
		<b>81.8</b>	<b>81.8</b>	<b>9.2</b>	<b>36</b>

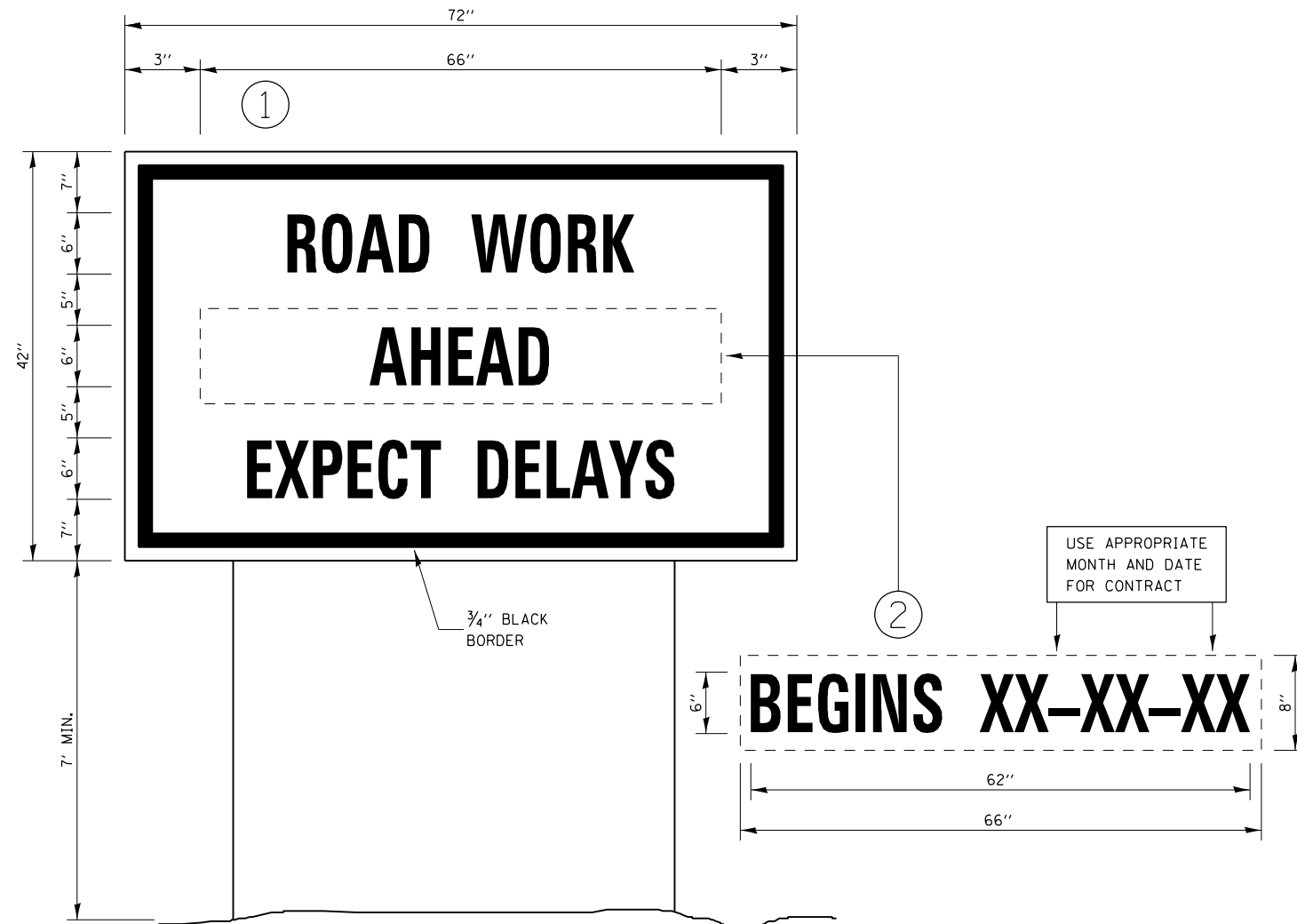

### TEMPORARY INFORMATION SIGNING

#### NOTES:

1. USE 6" D BLACK LETTERING ON FLOURESENT ORANGE BACKGROUND.
2. ERECT SIGNS AT LOCATIONS IN ADVANCE OF THE "ROAD CONSTRUCTION AHEAD" SIGNS AS DIRECTED BY THE ENGINEER.
3. ERECT SIGN ① WITH INSTALLED PANEL ② A MINIMUM OF ONE WEEK PRIOR TO THE START OF THE LANE CLOSURE.
4. REMOVE PANEL ② ON THAT DATE.
5. SEE SPECIAL PROVISION "TEMPORARY INFORMATION SIGNING" FOR ADDITIONAL INFORMATION.
6. WILL BE PAID FOR PER SO FT AS "TEMPORARY INFORMATION SIGNING". EACH SIGN = 21 SO FT AND THE DATE PANEL ② WILL NOT BE MEASURED SEPARATELY FOR PAYMENT.

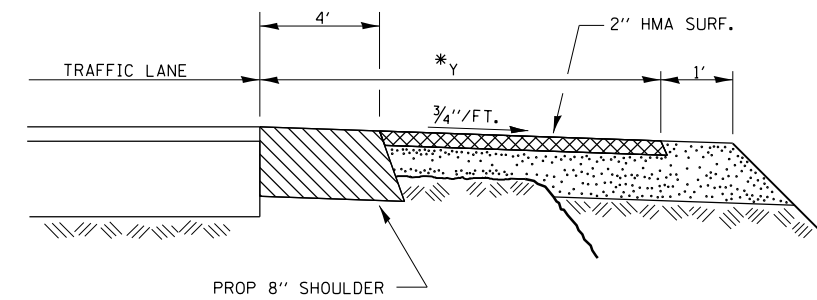
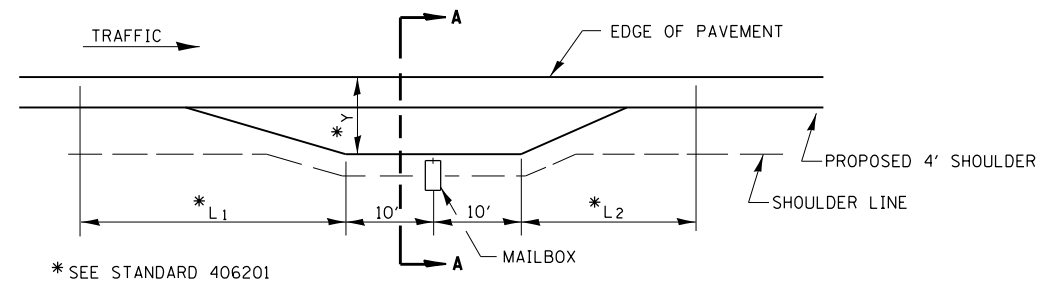

### SECTION A-A

### RURAL MAILBOX TURNOUT DETAILS

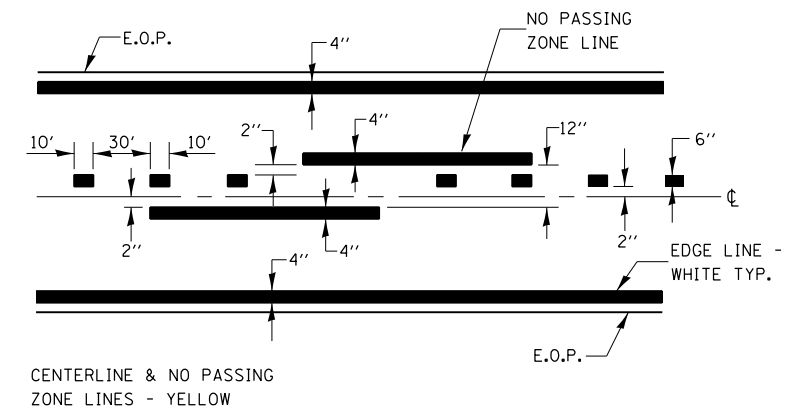

### PAVEMENT MARKING

FILE NAME =	USER NAME = budzynskim	DESIGNED -	REVISED -	<b>STATE OF ILLINOIS DEPARTMENT OF TRANSPORTATION</b>	<b>DETAILS</b>	F.A.P. RTE.	SECTION	COUNTY	TOTAL SHEETS	SHEET NO.	
ca:\pw_work\pwidot\budzynskim\d0427309.D	66E71-sht-details.dgn	DRAWN -	REVISED -			VAR	(116) I-2 & (30, 31) I	DEKALB	6	6	
	PLOT SCALE = 100.0000' / in.	CHECKED -	REVISED -			CONTRACT NO. 66E71					
	PLOT DATE = 3/27/2015	DATE -	REVISED -			ILLINOIS FED. AID PROJECT					
SCALE:						SHEET OF SHEETS STA. TO STA.					