

STATE OF ILLINOIS  
 DEPARTMENT OF TRANSPORTATION  
 DIVISION OF HIGHWAYS

F.A. RTE.	SECTION	COUNTY	TOTAL SHEETS	SHEET NO.
09	SAFETY SHLDRS 2015-1	..	19	1
ILLINOIS			CONTRACT NO. 78457	

• VARIOUS ROUTES  
 •• VARIOUS COUNTIES

ADT: HERRIN RD. (2015)  
 7780  
 PV = 7219  
 MU = 81  
 SU = 480

FOR INDEX OF SHEETS, SEE SHEET NO. 3

**PROPOSED  
 HIGHWAY PLANS**

VARIOUS ROUTES  
 SECTION D9 SAFETY SHLDRS 2015-1  
 PROJECT ACF-ACHSIP-000V (021)  
 SAFETY SHOULDER IMPROVEMENTS  
 VARIOUS COUNTIES

C-99-022-15

TOWNSHIPS : MURPHYSBORO, DESOTO, HERRIN,  
 MARION, CRAB ORCHARD, CARRIER MILLS,  
 DU QUOIN, SESSER, REND LAKE DAM, WEST  
 FRANKFORT, JOHNSTON CITY AND HARRISBURG

FOR EQUATION STATIONS, SEE  
 LOCATION MAPS, SHEETS 10 - 12.

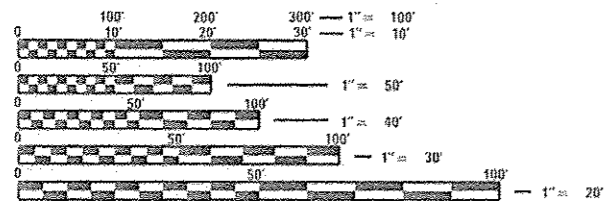

FULL SIZE PLANS HAVE BEEN PREPARED USING STANDARD  
 ENGINEERING SCALES. REDUCED SIZED PLANS WILL NOT  
 CONFORM TO STANDARD SCALES. IN MAKING MEASUREMENTS  
 ON REDUCED PLANS, THE ABOVE SCALES MAY BE USED.

J.U.L.I.E.  
 JOINT UTILITY LOCATION INFORMATION FOR EXCAVATION  
 1-800-892-0123  
 OR 811

PROJECT ENGINEER - Charles Stein (618) 351-5210  
 PROJECT MANAGER - Kathi McCord (618) 351-5319

CONTRACT NO. 78457

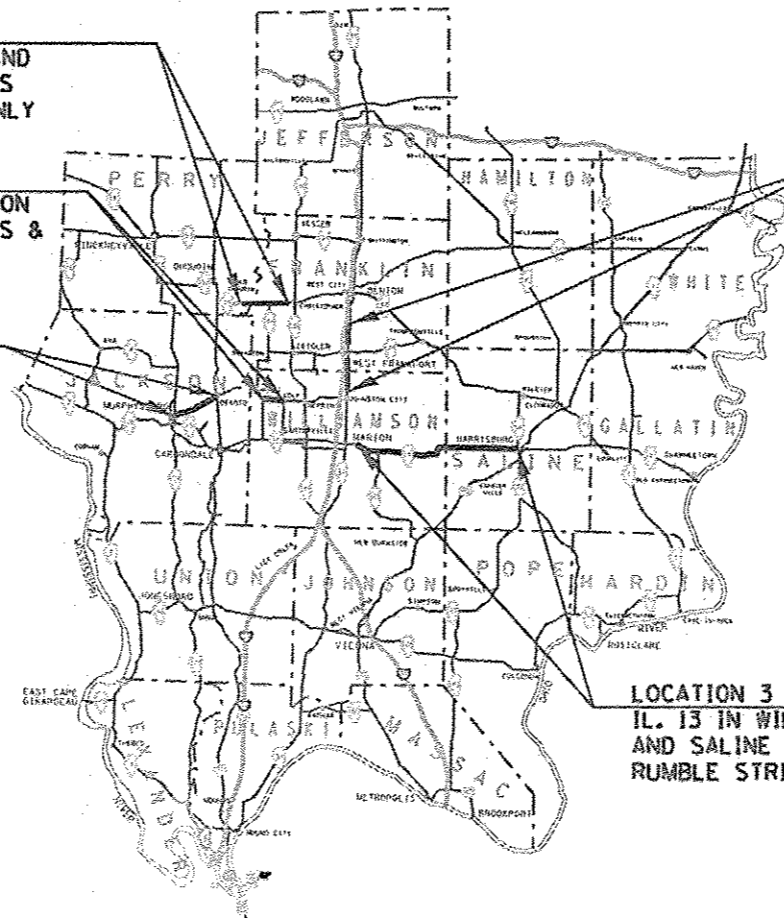

LOCATION 4 -  
 IL. 14 IN PERRY AND  
 FRANKLIN COUNTIES  
 RUMBLE STRIPS ONLY

LOCATION 2 -  
 HERRIN RD. IN WILLIAMSON  
 CO. - SAFETY SHOULDERS &  
 SMART SECTION

LOCATION 1 -  
 IL. 149 IN JACKSON CO.  
 SAFETY SHOULDERS

LOCATION 5 -  
 IL. 37 IN FRANKLIN AND  
 WILLIAMSON COUNTIES  
 RUMBLE STRIPS ONLY  
 (OMIT THROUGH WEST  
 FRANKFORT)

LOCATION 3 -  
 IL. 13 IN WILLIAMSON  
 AND SALINE COUNTIES  
 RUMBLE STRIP ONLY

GROSS LENGTH = 214,663 FT. = 40.66 MILE  
 NET LENGTH = 205,764 FT. = 38.97 MILE

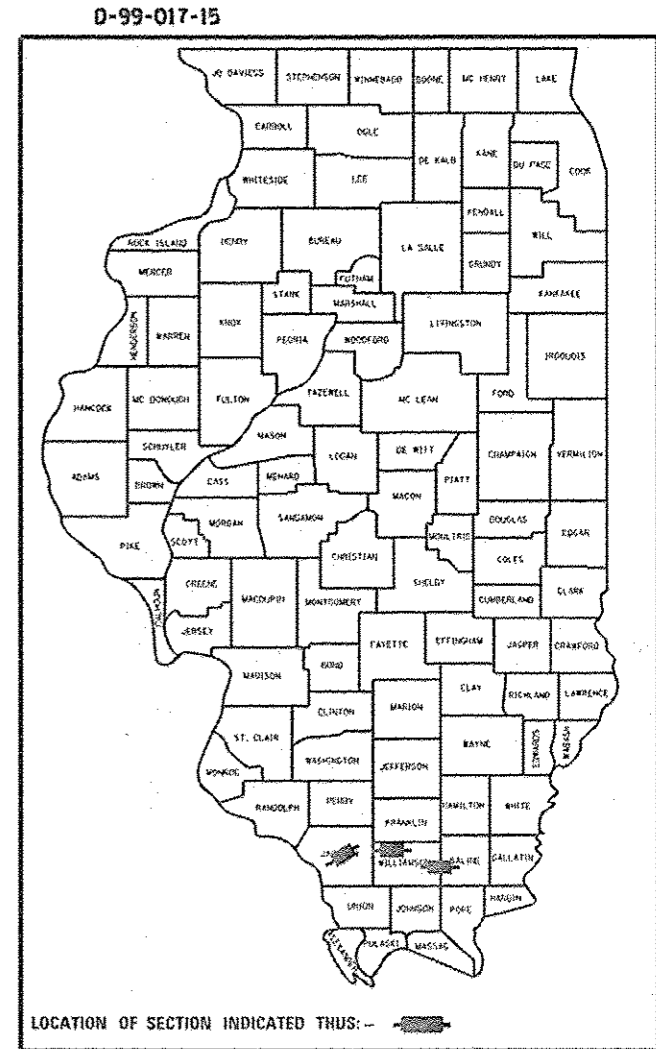

LOCATION OF SECTION INDICATED THUS: - [shaded area]

STATE OF ILLINOIS  
 DEPARTMENT OF TRANSPORTATION  
 DIVISION OF HIGHWAYS

SUBMITTED March 11 20 15

John D. Baranzelli PE/PA  
 DEPUTY DIRECTOR OF HIGHWAYS, REGION ENGINEER

May 8 20 15  
John D. Baranzelli PE/PA  
 acting ENGINEER OF DESIGN AND ENVIRONMENT

May 8 20 15  
Omer Osman PE/PA  
 DIRECTOR OF HIGHWAYS, CHIEF ENGINEER

PRINTED BY THE AUTHORITY  
 OF THE STATE OF ILLINOIS

RECEIVED  
 ADVISORY  
 TO USPTO  
 TRANSPORTATION & INFRASTRUCTURE

• VARIOUS ROUTES  
 \*\* VARIOUS COUNTIES

Prepared By: Joe Zdaniewicz  
 DISTRICT STUDIES & PLANS ENGINEER

Examined By: [Signature]  
 DISTRICT LAND ACQUISITION ENGINEER

Examined By: [Signature]  
 DISTRICT PROGRAM DEVELOPMENT ENGINEER

Examined By: [Signature]  
 DISTRICT OPERATIONS ENGINEER

Examined By: [Signature]  
 DISTRICT PROJECT IMPLEMENTATION ENGINEER

Examined By: \_\_\_\_\_  
 DISTRICT CONSTRUCTION ENGINEER

Examined By: \_\_\_\_\_  
 DISTRICT MATERIALS ENGINEER

FILE NAME * #FILE#	USER NAME * #USER#	DESIGNED -	REVISED -	STATE OF ILLINOIS DEPARTMENT OF TRANSPORTATION	SIGNATURE SHEET				F.A. RTE.	SECTION	COUNTY	TOTAL SHEETS	SHEET NO.
		DRAWN	REVISED		SCALE: _____	SHEET	OF	SHEETS	STA.	TO STA.	**	19	2
		CHECKED	REVISED										
#MODELNAME#		DATE	REVISED										

ILLINOIS FED. AID PROJECT  
 CONTRACT NO. 78457

# INDEX OF SHEETS

SHEET NO.	DESCRIPTION
1	COVER SHEET
2	SIGNATURE SHEET
3	INDEX OF SHEETS, STANDARDS GENERAL NOTES, MIXTURE REQUIREMENTS MTD RESTRICTIONS TABLE
4 - 5	SUMMARY OF QUANTITIES
6 - 7	TYPICAL SECTION
8 -10	SCHEDULES OF QUANTITIES
11	LOCATION MAP OF PROJECTS
12 - 16	INDIVIDUAL LOCATION MAPS & EQUATION STATIONS
17	DETAIL: ENTRANCE & SIDE ROAD DETAIL
18 - 19	DETAIL: LOCATION 2 MILLING AND RESURFACING DETAIL

## STANDARDS

000001-06	701306-03	701901-04
442101-07	701311-03	780001-05
482011-03	701336-06	781001-03
642006	701400-08	
701011-04	701401-09	
701301-04	701426-07	

## MIXTURE REQUIREMENTS

LOCATION(S):	HOT-MIX ASPHALT SURFACE COURSE
MIXTURE USE(S):	HOT-MIX ASPHALT SURFACE COURSE, MIX. D, N90
AC/PG:	PG64-22
ABR% (MAX):	SEE SPECIAL PROVISION
DESIGN AIR VOIDS:	4.0%, 90 CYRATION DESIGN
MIXTURE COMPOSITION: (GRADATION MIXTURE)	IL-19.0mm
FRICTION AGGREGATE:	D SURFACE
QUALITY MANAGEMENT PROGRAM:	QC/OA

LOCATION(S):	HOT-MIX ASPHALT SHOULDERS
MIXTURE USE(S):	HOT-MIX ASPHALT SHOULDERS, N70, IL-19.0mm
AC/PG:	PG64-22
ABR% (MAX):	SEE SPECIAL PROVISION
DESIGN AIR VOIDS:	4.0%, 70 CYRATION DESIGN
MIXTURE COMPOSITION: (GRADATION MIXTURE)	IL-19.0mm
FRICTION AGGREGATE:	NONE
QUALITY MANAGEMENT PROGRAM:	QC/OA

## GENERAL NOTES

FACTORS USED FOR ESTIMATING PLAN QUANTITIES ARE AS FOLLOWS AND SHALL NOT BE USED FOR THE BASIS OF FINAL QUANTITIES:

ALL HOT-MIX ASPHALT	2.016 TONS/CU. YD.
ALL AGGREGATE	2.05 TONS/CU. YD.
BITUMINOUS MATERIALS:	
ON EX. PAVEMENT	0.05 LBS. / SQ. FT.
ON SHOULDER (BOTTOM LAYER)	0.025 LBS. / SQ. FT.

THE ALGEBRAIC DIFFERENCE BETWEEN THE PAVEMENT AND SHOULDER SLOPES SHALL NOT EXCEED 8%. THE SHOULDER ON THE OUTSIDE OF SUPERELEVATED CURVES SHALL BE FLATTENED ACCORDINGLY.

THERE ARE NO AVAILABLE WASTE SITES ON THE EXISTING RIGHT OF WAY WITHIN THE PROJECT LIMITS. DISPOSAL WILL BE THE RESPONSIBILITY OF THE CONTRACTOR AND WASTE MUST BE DISPOSED OF IN ACCORDANCE WITH ARTICLE 202.03 OF THE STANDARD SPECIFICATIONS.

STATIONING SHOWN IN THE SCHEDULES IS BASED ON STAMPED STATIONS IN THE EXISTING PAVEMENT AND FROM OLD PLANS. MINOR ADJUSTMENTS MAY BE REQUIRED AS DIRECTED BY THE ENGINEER.

THE EXCAVATED AGGREGATE/EARTH FOR THE PROPOSED SHOULDER SHALL NOT BE WASTED ON THE CONSTRUCTION SITE, UNLESS APPROVAL IS FIRST GIVEN BY THE ENGINEER.

THE HMA SHOULDER SHALL BE 4' WIDE AS SHOWN ON THE HMA SHOULDER SCHEDULE. THE SHOULDER SHALL BE AS WIDE AS POSSIBLE THROUGH OUT LOCATION ONE AND TWO, EXCEPT IN LOCATIONS THAT THE EXISTING SHOULDER IS NOT WIDE ENOUGH TO SUSTAIN. IN THESE AREAS THE SHOULDER SHALL BE A MINIMUM OF 2' WIDE. THESE LOCATIONS SHALL BE DETERMINED BY THE ENGINEER. NO EXTRA COMPENSATION WILL BE GIVEN FOR THE VARYING WIDTH. THE HMA SHOULDER WILL BE PAID FOR BY THE SQUARE YARD.

AT LOCATIONS WHERE EXISTING GUTTER OUTLETS ARE NO LONGER IN USE, THEY SHALL BE FILLED WITH THE NEW HMA SHOULDER AND LEFT AS IS. AT LOCATIONS WHERE EXISTING V-GUTTER IS FILLED, BUT TOP LIP IS STILL VISABLE, IT SHALL BE GROUND OFF AND THE NEW HMA SHOULDER SHALL BE PLACED BEHIND IT AS SHOWN ON THE TYPICALS AND AS DIRECTED BY THE ENGINEER. THE COST OF GRINDING OFF ANY EXISTING V-GUTTER LIP SHALL BE INCLUDED IN THE HMA SHOULDERS, 8".

## MTD CROSSING RESTRICTIONS TABLE

SN & CENTERLINE STATION ROUTE (FAS 908 - HERRIN ROAD)	EXISTING FILL HEIGHT OVER BOX CULVERT	THICKNESS OF EXISTING PAVEMENT OVER BOX CULVERT	MTD CROSSING RESTRICTIONS
	FOOT	FOOT	
SN 100-0075 (STA. 115+57)			PENDING
SN 100-2018 (STA. 104+82)	2	1	PENDING

• VARIOUS ROUTES  
•• VARIOUS COUNTIES

FILE NAME :	USER NAME : mceordkr	DESIGNED -	REVISED -	<b>STATE OF ILLINOIS DEPARTMENT OF TRANSPORTATION</b>	<b>INDEX OF SHEETS, STANDARDS, GENERAL NOTES, MIXTURE REQUIREMENTS</b>	F.A. RTE.	SECTION	COUNTY	TOTAL SHEETS	SHEET NO.
et:\pwwork\pvidot\mceordkr\28423870\78	57-ah1-pln.dgn	DRAWN -	REVISED -			•	D9 SAFETY SHLDRS 2015-1	••	19	3
Default	PLOT SCALE = 1/8" = 1'-0"	CHECKED -	REVISED -			SCALE: SHEET OF SHEETS STA. TO STA.		ILLINOIS/FED. AID PROJECT		
	PLOT DATE = 3/16/2015	DATE -	REVISED -			CONTRACT NO. 78457				

# SUMMARY OF QUANTITIES

VARIOUS ROUTES	
RURAL	
VARIOUS COUNTIES	
90% FED.; 10% STATE	80% FED.; 20% STATE
CONSTRUCTION TYPE CODE 0021	CONSTRUCTION TYPE CODE 0005

CODE NUMBER	ITEM DESCRIPTION	UNIT	TOTAL QUANTITY	QUANTITY	QUANTITY
Z0034105	MATERIAL TRANSFER DEVICE	TON	809		809
Z0048665	RAILROAD PROTECTIVE LIABILITY INSURANCE	L SUM	1	1	
20200600	EXCAVATING AND GRADING EXISTING SHOULDERS	UNIT	903	903	
40600275	BITUMINOUS MATERIALS (PRIME COAT)	POUND	13,299	8,967	4332
40600990	TEMPORARY RAMP	SQ YD	60		60
40603345	HOT-MIX ASPHALT SURFACE COURSE, MIXTURE D, N90	TON	809		809
44000155	HOT-MIX ASPHALT SURFACE REMOVAL 1 1/2"	SQ YD	9,623		9623
44200990	CLASS B PATCHES, TYPE I, 12 INCH	SQ YD	172		172
44200994	CLASS B PATCHES, TYPE II, 12 INCH	SQ YD	78		78
44200998	CLASS B PATCHES, TYPE III, 12 INCH	SQ YD	150		150
44201299	DOWEL BARS 1 1/2"	EACH	1,254		1254
44213100	PAVEMENT FABRIC	SQ YD	227		227
44213200	SAW CUTS	FOOT	3,024		3024
44213204	TIE BARS 3/4 INCH	EACH	130		130
44300200	STRIP REFLECTIVE CRACK CONTROL TREATMENT	FOOT	6,662		6662
48203029	HOT-MIX ASPHALT SHOULDERS, 8"	SQ YD	39,852	39,852	
64200108	SHOULDER RUMBLE STRIPS, 8 INCH	FOOT	217,577	217,577	

• VARIOUS ROUTES  
•• VARIOUS COUNTIES

FILE NAME :	USER NAME : moordkr	DESIGNED -	REVISED -	<b>STATE OF ILLINOIS DEPARTMENT OF TRANSPORTATION</b>	<b>SUMMARY OF QUANTITIES SHEET 1</b>			F.A. RTE.	SECTION	COUNTY	TOTAL SHEETS	SHEET NO.	
c:\pwork\pvidot\moordkr\0423878\78	57-ent-plan.dgn	DRAWN -	REVISED -		SCALE:	SHEET	OF	SHEETS	STA.	TO STA.	•	19	4
	PLOT SCALE = 1/8" = 100'	CHECKED -	REVISED -								••		
Default	PLOT DATE = 3/15/2015	DATE -	REVISED -										

REF: 02 1947

## SUMMARY OF QUANTITIES

VARIOUS ROUTES	
RURAL	
VARIOUS COUNTIES	
90% FED.; 10% STATE	80% FED.; 20% STATE
CONSTRUCTION TYPE CODE 0021	CONSTRUCTION TYPE CODE 0005

CODE NUMBER	ITEM DESCRIPTION	UNIT	TOTAL QUANTITY	QUANTITY	QUANTITY
64200116	SHOULDER RUMBLE STRIPS, 16 INCH	FOOT	388,068	388,068	
67100100	MOBILIZATION	L SUM	1	0.5	0.5
70100460	TRAFFIC CONTROL AND PROTECTION, STANDARD 701306	L SUM	1	0.5	0.5
70100600	TRAFFIC CONTROL AND PROTECTION, STANDARD 701336	L SUM	1		1
70100800	TRAFFIC CONTROL AND PROTECTION, STANDARD 701401	L SUM	1	1	
70106800	CHANGEABLE MESSAGE SIGN	CAL MO	3	2	1
70300100	SHORT- TERM PAVEMENT MARKING	FOOT	778		778
70300220	TEMPORARY PAVEMENT MARKING, LINE 4"	FOOT	7,775		7775
70300280	TEMPORARY PAVEMENT MARKING, LINE 24"	FOOT	13		13
70301000	WORK ZONE PAVEMENT MARKING REMOVAL	SO FT	407		407
* 78000200	THERMOPLASTIC PAVEMENT MARKING - LINE 4"	FOOT	7,775		7775
* 78000650	THERMOPLASTIC PAVEMENT MARKING - LINE 24"	FOOT	13		13
* 78100100	RAISED REFLECTIVE PAVEMENT MARKER	EACH	48		48
78300200	RAISED REFLECTIVE PAVEMENT MARKER REMOVAL	EACH	48		48

14

\* SPECIALTY ITEM

• VARIOUS ROUTES  
•• VARIOUS COUNTIES

FILE NAME =	USER NAME = mosordkr	DESIGNED -	REVISED -	<b>STATE OF ILLINOIS DEPARTMENT OF TRANSPORTATION</b>	<b>SUMMARY OF QUANTITIES SHEET 2</b>	F.A. RTE.	SECTION	COUNTY	TOTAL SHEETS	SHEET NO.	
st:\p\work\p\sidot\mccordkr\10423878\78	07-shr-plan.dgn	DRAWN -	REVISED -			•	09 SAFETY SHLDRS 2015-1	••	19	5	
Default	PLT SCALE = 100.0000 / 1 in.	CHECKED -	REVISED -			SCALE: SHEET OF SHEETS STA. TO STA.					
	PLT DATE = 3/15/2015	DATE -	REVISED -			ILLINOIS FED. AID PROJECT CONTRACT NO. 78457					

TYPICAL FOR HMA SHOULDERS  
AND RESURFACING  
HERRIN RD.

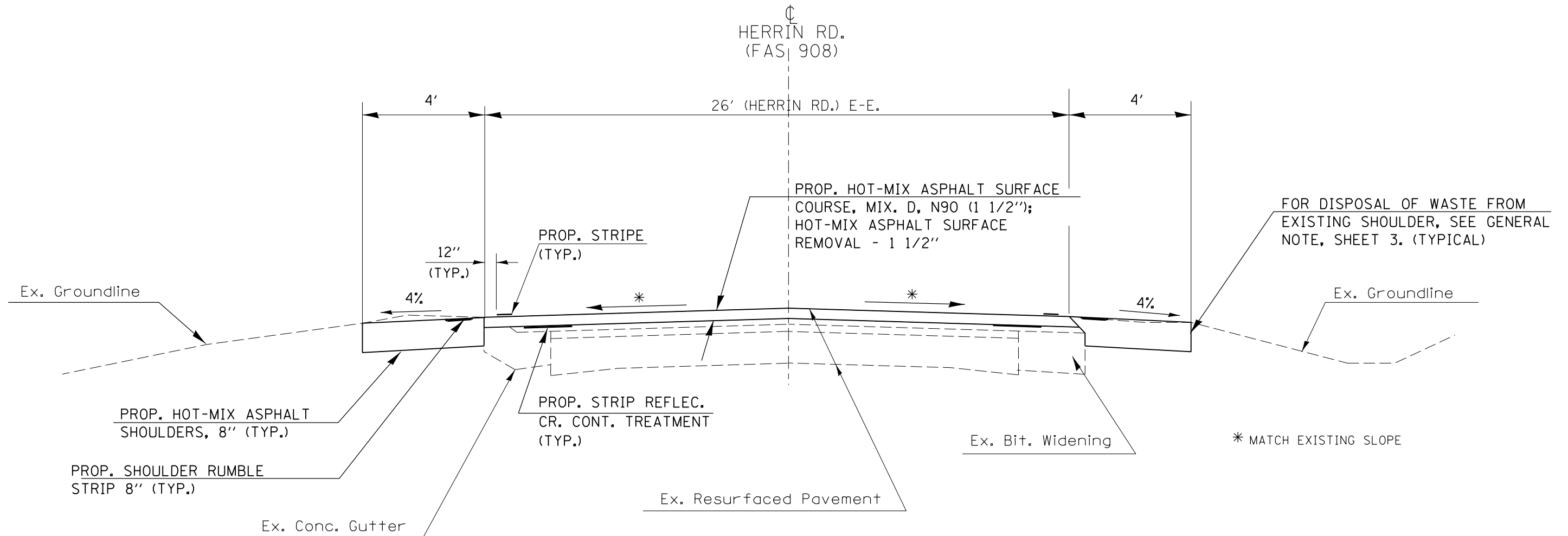

TO BE USED:

LOCATION 2 - HERRIN ROAD (WILLIAMSON CO.)  
STA. 131+64 TO STA. 97+00

• VARIOUS ROUTES  
•• VARIOUS COUNTIES

FILE NAME =	USER NAME = mccordkr	DESIGNED -	REVISED -	<b>STATE OF ILLINOIS DEPARTMENT OF TRANSPORTATION</b>	<b>TYPICAL SECTION</b>			F.A. RTE.	SECTION	COUNTY	TOTAL SHEETS	SHEET NO.	
et:\pw\work\p\dot\mccordkr\0423878\78357-sh1-plan.dgn		DRAWN -	REVISED -		SCALE:	SHEET	OF	SHEETS	STA.	TO	STA.	19	6
Default	PLOT SCALE = 100.0000' / in.	CHECKED -	REVISED -		CONTRACT NO. 78396								
	PLOT DATE = 3/16/2015	DATE -	REVISED -		ILLINOIS FED. AID PROJECT								

# TYPICAL FOR HMA SHOULDERS AND RUMBLE STRIP

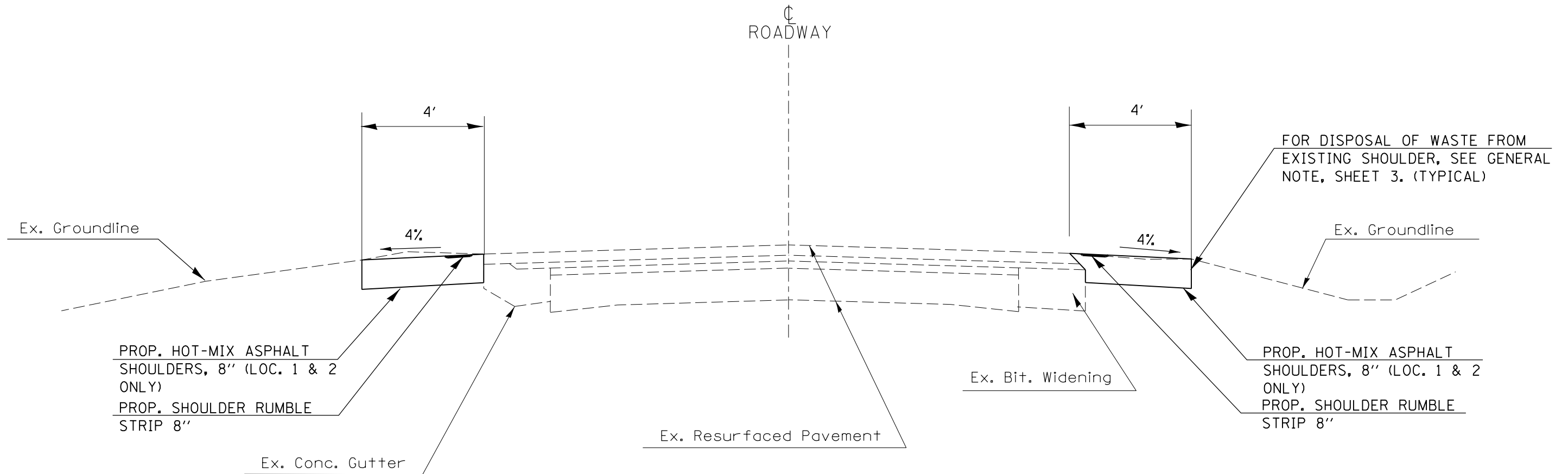

TO BE USED:

PROP. HMA SHOULDERS AND RUMBLE STRIP 8"  
LOCATION 1 (IL 149) & LOCATION 2 (HERRIN RD.)

PROP. RUMBLE STRIP 8" ONLY  
LOCATION 3 (IL 13), LOCATION 4 (IL 14)  
& LOCATION 5 (IL 37)

FILE NAME =	USER NAME = mccordkr	DESIGNED -	REVISED -	<b>STATE OF ILLINOIS DEPARTMENT OF TRANSPORTATION</b>	<b>TYPICAL SECTION</b>			F.A. RTE.	SECTION	COUNTY	TOTAL SHEETS	SHEET NO.				
et:\pw\work\p\dot\mccordkr\0423878\78396-57-sh1-plan.dgn		DRAWN -	REVISED -		SCALE:	SHEET	OF	SHEETS	STA.	TO	STA.	•	D9 SAFETY 2014-2	••	19	7
Default		CHECKED -	REVISED -		CONTRACT NO. 78396											
		DATE -	REVISED -		ILLINOIS FED. AID PROJECT											

## HMA SHOULDER SCHEDULE

LOCATION STATION TO STATION	EXIST. PAVEMENT LENGTH ( INFOR. ONLY)	EXIST. PAVEMENT WIDTH	EXIST. AGG. SHOULDER WIDTH	EXIST. BIT. SHOULDER WIDTH	HMA SHOULDERS, 8"	BITUMINOUS MATERIALS ( PRIME COAT)	SHOULDER RUMBLE STRIPS, 8 INCH	EXC. & GRADING EX. SHOULDER	NOTES
	FOOT	FOOT	FOOT	FOOT	SQ YD	POUND	FOOT	UNIT	
<b>LOCATION 1 - IL 149 IN JACKSON CO.</b>									
STA 60+84.00 TO STA 76+70.10	1,586	24	4		1410	318	3172	32	
<b>EO. STA 76+70.10 BK TO STA 47+90.00 AH</b>									
STA 47+90.00 TO STA 129+10.00	8,120	24	4		7218	1624	16240	164	
STA 129+10.00 TO STA 132+80.00	370	24	4				740		
<b>OMIT S. N. 039-0064 - STA. 132+80 TO STA. 137+80</b>									
STA 137+80.00 TO STA 144+25.00	645	24	4				1290		
STA 144+25.00 TO STA 330+28.00	18,603	24	4		16536	3721	37206	374	
<b>JACKSON CO TOTALS</b>					<b>25,164</b>	<b>5,663</b>	<b>58,648</b>	<b>570</b>	
<b>LOCATION 2 - HERRIN ROAD IN WILLIAMSON CO. ( FAS 908)</b>									
LT STA. 0+63.00 TO LT STA. 133+15.00	13,252	26	4		5890	1325	13,252	133	
RT STA. 1+16.00 TO RT STA. 132+46.00	13,130	26	4		5836	1313	13,130	132	
<b>EO STA. 133+32.29 BK TO STA 132+29.80 AH</b>									
LT STA. 131+64.00 TO STA 116+37.00	1,527	26	4		679	153	1,527	16	
RT STA. 131+64.00 TO STA 116+37.00	1,527	26	4		679	153	1,527	16	
<b>OMIT S. N. 100-0075 - STA. 116+37 TO STA. 115+04</b>									
LT STA. 115+04.00 TO STA 97+00.00	1,804	26	4		802	180	1,804	18	
RT STA. 115+04.00 TO STA 97+00.00	1,804	26	4		802	180	1,804	18	
<b>WILLIAMSON CO TOTALS</b>					<b>14,688</b>	<b>3304</b>	<b>33,044</b>	<b>333</b>	
<b>LOCATION 3 - IL 13 IN WILLIAMSON/SALINE COUNTIES</b>									
STA 127+25.00 TO STA 135+62.00	837	24		6' INSIDE/10' OUTSIDE			3,348		
<b>OMIT S. N. 100-0022 &amp; S. N. 100-0023 - STA. 135+62 TO STA. 136+70</b>									
STA 136+70.00 TO STA 158+99.52	2,230	24		6' INSIDE/10' OUTSIDE			8,920		
<b>EO STA 158+99.52 BK TO STA 158+82.63 AH</b>									
STA 158+82.63 TO STA 187+35.71	2,853	24		6' INSIDE/10' OUTSIDE			11,412		
<b>EO STA 187+35.71 BK TO STA 187+24.75 AH</b>									
STA 187+24.75 TO STA 207+07.46	1,983	24		6' INSIDE/10' OUTSIDE			7,932		
<b>EO STA 207+07.46 BK TO STA 73+56.13 AH</b>									
STA 73+56.13 TO STA 100+44.65	2,689	24		6' INSIDE/10' OUTSIDE			10,756		INTERSECTION IL 13/IL 166
RT STA 100+44.65 TO RT STA 476+76.00	37,631	24		6' INSIDE/10' OUTSIDE			75,263		
<b>OMIT S. N. 100-0071 - STA. 476+76 TO STA. 479+47</b>									
RT STA 479+47.00 TO RT STA 539+03.00	5,956	24		6' INSIDE/10' OUTSIDE			11,912		
LT STA 100+44.65 TO LT STA 477+37.00	37,692	24		6' INSIDE/10' OUTSIDE			75,385		
<b>OMIT S. N. 100-0068 - STA. 477+37 TO STA. 478+87</b>									
LT STA 478+87.00 TO LT STA. 539+03.00	6,016	24		6' INSIDE/10' OUTSIDE			12,032		
<b>WILLIAMSON CO TOTALS</b>							<b>216,960</b>		
<b>WILLIAMSON/SALINE CO. LINE STA. 539+03</b>									
STA 539+03.00 TO STA 651+98.00	11,295	24		6' INSIDE/10' OUTSIDE			45,180		
<b>OMIT S. N. 083-0050 &amp; S. N. 083-0051 - STA. 651+98 TO STA. 653+36</b>									
STA 653+36.00 TO STA 773+51.00	12,015	24		6' INSIDE/10' OUTSIDE			48,060		
<b>OMIT S. N. 083-0052 &amp; S. N. 083-0053 - STA. 773+51 TO STA. 778+33</b>									
STA 775+33.00 TO STA 970+00.00	19,467	24		6' INSIDE/10' OUTSIDE			77,868		
<b>SALINE CO TOTALS</b>							<b>171,108</b>		

• VARIOUS ROUTES  
•• VARIOUS COUNTIES

FILE NAME =	USER NAME = mccordkr	DESIGNED -	REVISED -	<b>STATE OF ILLINOIS DEPARTMENT OF TRANSPORTATION</b>	<b>HMA SHOULDER SCHEDULE SHEET 1</b>	SCALE:	SHEET	OF	SHEETS	STA.	TO	STA.	F.A. RTE.	SECTION	COUNTY	TOTAL SHEETS	SHEET NO.		
Default	et:\pw\work\p\dot\mccordkr\0423878\783957-sh1-pln.dgn	DRAWN -	REVISED -												•	D9 SAFETY 2014-2	••	19	8
	PLOT SCALE = 100.0000' / in.	CHECKED -	REVISED -																
	PLOT DATE = 3/16/2015	DATE -	REVISED -																
													CONTRACT NO. 78396						
													ILLINOIS FED. AID PROJECT						



HMA SHOULDER SCHEDULE  
( CONTINUED )

LOCATION STATION TO STATION	EXIST. PAVEMENT LENGTH ( INFOR. ONLY )	EXIST. PAVEMENT WIDTH	EXIST. AGG. SHOULDER WIDTH	EXIST. BIT. SHOULDER WIDTH	HMA SHOULDERS, 8"	BITUMINOUS MATERIALS ( PRIME COAT )	SHOULDER RUMBLE STRIPS, 8 INCH	EXC. & GRADING EX. SHOULDER	NOTES
	FOOT	FOOT	FOOT	FOOT	SQ YD	POUND	FOOT	UNIT	
<b>LOCATION 4 - IL 14 IN PERRY/FRANKLIN COUNTIES</b>									
STA 177+00.00 TO STA 190+09.00	1,309	22					2,618		
<b>OMIT S. N. 073-0036 - STA. 190+09 TO STA. 191+91</b>									
STA 191+91.00 TO STA 228+24.00	3,633	22					7,266		
<b>OMIT S. N. 073-0038 - STA. 228+24 TO STA. 230+21</b>									
<b>PERRY CO TOTALS</b>							<b>9,884</b>		
<b>PERRY/FRANKLIN CO. LINE STA. 229+22</b>									
STA 230+21.00 TO STA 304+61.55	7,441	22					14,881		
<b>EO STA 304+61.55 (BK) TO STA 304+83.20 (AH)</b>									
STA 304+83.20 TO STA 326+35.00	2,152	22					4,304		
<b>OMIT RAILROAD CROSSING - STA. 326+35 TO STA. 326+60</b>									
STA 326+60.00 TO STA 446+50.00	11,990	22					23,980		
<b>FRANKLIN CO TOTALS</b>							<b>43,165</b>		
<b>LOCATION 5 - IL 37 IN FRANKLIN/WILLIAMSON COUNTIES</b>									
STA 130+00.00 TO STA 253+83.00	12,383	24					24,766		
<b>OMIT S. N. 028-0034 - STA. 253+83 TO STA. 257+51</b>									
STA 257+51.00 TO STA 268+78.00	1,127	24					2,254		
<b>EO STA 268+78.00 (BK) TO STA 0+08.00 (AH)</b>									
STA 0+08.00 TO STA 18+31.00	1,823	24					3,646		
<b>OMIT THROUGH W. FRANKFORT - STA. 18+31 TO STA. 83+80</b>									
STA 83+80.00 TO STA 93+90.20	1,010	24					2,020		
<b>EO STA 93+90.20 (BK) TO STA 365+76.20 (AH)</b>									
STA 365+76.20 TO STA 372+30.00	654	24					1,308		
<b>OMIT S. N. 028-0078 - STA. 372+30 TO STA. 374+70</b>									
STA 374+70.00 TO STA 382+95.40	825	24					1,651		
<b>EO STA 382+95.40 (BK) TO STA 383+00.50 (AH)</b>									
STA 383+00.50 TO STA 430+36.00	4,736	24					9,471		
<b>EO STA 430+36.00 (BK) TO STA 430+45.00 (AH)</b>									
STA 430+45.00 TO STA 457+18.00	2,673	24					5,346		
<b>FRANKLIN CO TOTALS</b>							<b>50,462</b>		
<b>FRANKLIN/WILLIAMSON CO. LINE STA. 457+18</b>									
STA 457+18.00 TO STA 569+05.00	11,187	24					22,374		
<b>WILLIAMSON CO TOTALS</b>							<b>22,374</b>		
<b>PROJECT TOTAL</b>									
	<b>47,347</b>				<b>39,852</b>	<b>8,967</b>	<b>605,644</b>	<b>903</b>	

### HERRIN ROAD RESURFACING SCHEDULE

LOCATION STATION TO STATION	EXIST. PAVEMENT LENGTH ( INFOR. ONLY)	EXIST. PAVEMENT WIDTH	EXIST. AGG. SHOULDER WIDTH	TEMPORARY RAMPS	HMA SURFACE CSE., MIX. D, N90 ( 1 1/2'' )	HMA SURFACE REMOVAL, 1 1/2''	BITUMINOUS MATERIALS ( PRIME COAT)	STRIP REFLECTIVE CRACK CONT. TREATMENT
	FOOT	FOOT	FOOT	SQ YD	TON	SQ YD	POUND	FOOT
<b>LOCATION 2 - HERRIN ROAD IN WILLIAMSON CO. ( FAS 908 )</b>								
STA 131+64.00 TO STA 116+37.00	1,527	26	4	30	371	4411	1986	3,054
<b>OMIT S.N. 100-0075 - STA. 116+37 TO STA. 115+04</b>								
STA 115+04.00 TO STA 97+00.00	1,804	26	4	30	438	5212	2346	3,608
<b>PROJECT TOTALS</b>								
				60	809	9,623	4332	6,662

### HERRIN RD. ( FAS 908 ) PAVEMENT MARKING SCHEDULE

STATION TO STATION	PAINT PAVEMENT MARKING				TEMPORARY		SHORT-TERM PAVEMENT MARKING	NOTES	
	4 INCH WHITE ( EDGELINE )	4 INCH YELLOW ( SKIP-DASH )	4 INCH YELLOW ( NPZ OR DBL )	24 INCH ( STOP BARS )	4 INCH	24 INCH			
	FOOT	FOOT	FOOT	FOOT	FOOT	FOOT			
<b>LOCATION 2 - HERRIN RD. ( WILLIAMSON CO. )</b>									
LT & RT	131+64.0	TO	116+37.0	3054	382		3436	3036	
	131+64.0					13	13		
<b>OMIT SN 100-0075 - STA. 116+37 TO STA. 115+04</b>									
LT & RT	115+04.0	TO	97+00.0	3608	451		4059	360	
RT	99+80.0	TO	97+00.0		280		280	112	
<b>PROJECT TOTALS</b>				6662	833	280	13	7775	13
				7775					

# LOCATION MAP

LOCATION 1: IL. 149 IN JACKSON CO. FROM IL. 13/127 TO DESOTO.  
 LOCATION 2: HERRIN ROAD IN WILLIAMSON CO. FROM CAMBRIA ROAD TO HERRIN ELEMENTARY SCHOOL.  
 LOCATION 3: IL. 13 IN WILLIAMSON AND SALINE COUNTIES FROM MARION TO HARRISBURG.  
 LOCATION 4: IL. 14 IN PERRY AND FRANKLIN COUNTIES FROM OLD DUQUOIN TO WEST OF CHRISTOPHER  
 LOCATION 5: IL 37 IN FRANKLIN AND WILLIAMSON COUNTIES FROM JOHNSTON CITY TO YELLOW BANKS RD.

LOCATION 1

LOCATION 2

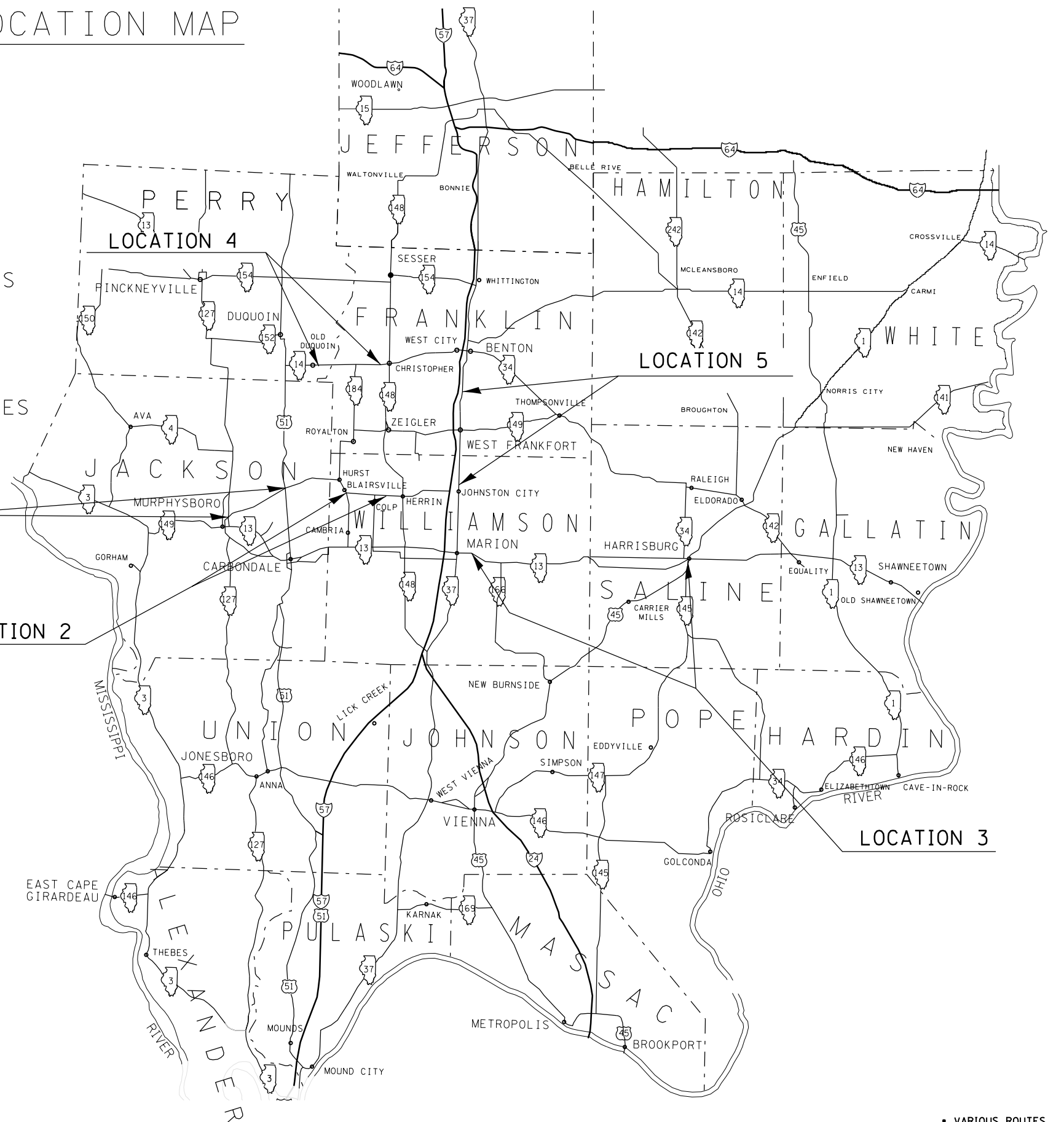

• VARIOUS ROUTES  
 •• VARIOUS COUNTIES

FILE NAME =	USER NAME = mccordkr	DESIGNED -	REVISED -
et:\pw_work\p\idot\mccordkr\0423878\78457-sh1-plan.dgn		DRAWN -	REVISED -
Default	PLOT SCALE = 100.0000' / in.	CHECKED -	REVISED -
	PLOT DATE = 3/16/2015	DATE -	REVISED -

**STATE OF ILLINOIS  
 DEPARTMENT OF TRANSPORTATION**

**LOCATION MAP OF PROJECTS**

SCALE:      SHEET    OF    SHEETS    STA.                    TO STA.

F.A. RTE.	SECTION	COUNTY	TOTAL SHEETS	SHEET NO.
•	D9 SAFETY 2015-1	••	19	11
CONTRACT NO. 78457				
ILLINOIS FED. AID PROJECT				

LOCATION 1

IL 149 IN JACKSON CO.

FROM IL 13/127 NEAR MURPHYSBORO TO WEST OF DESOTO

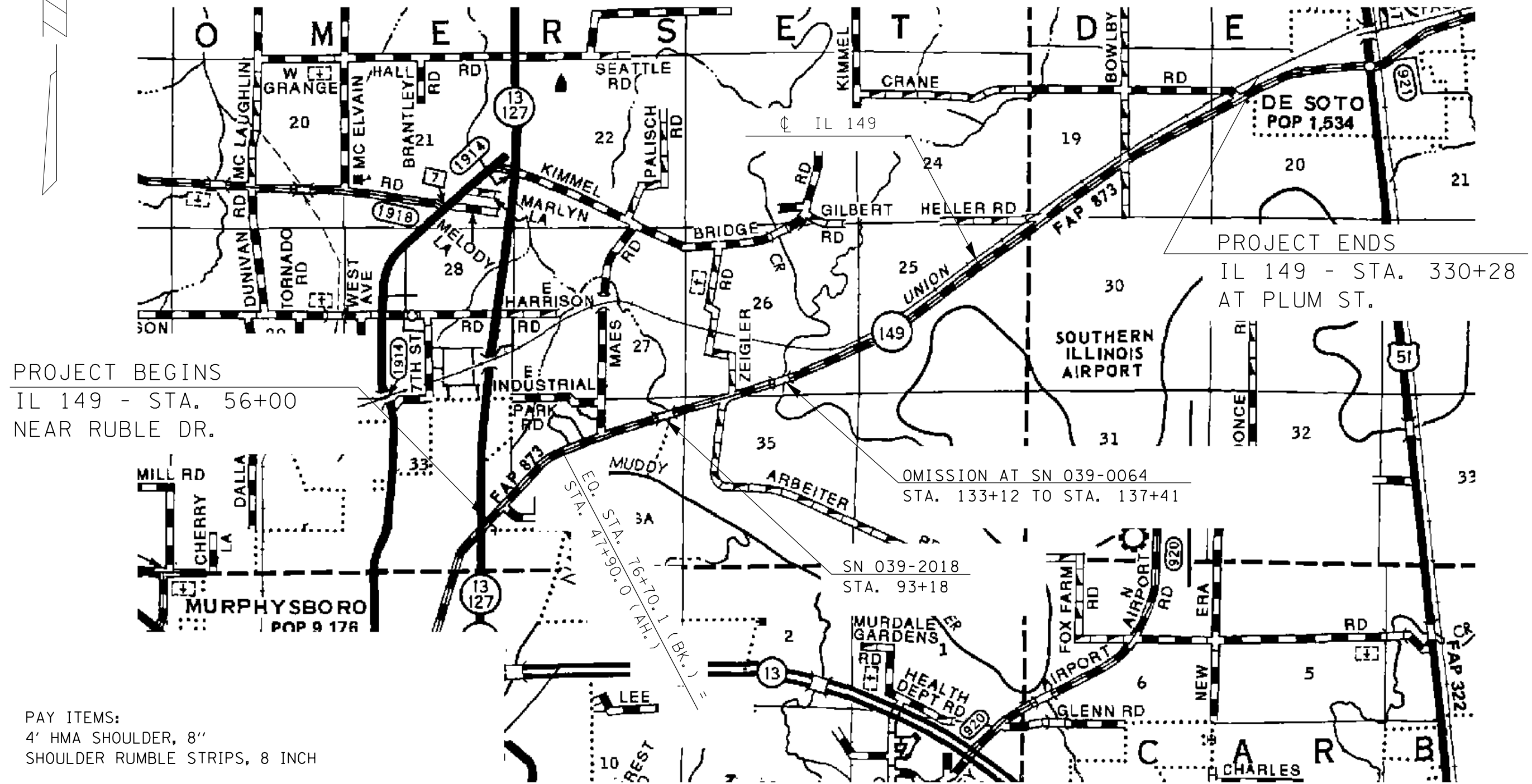
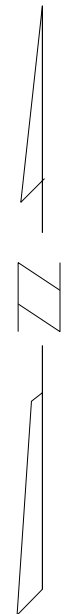

PROJECT BEGINS  
IL 149 - STA. 56+00  
NEAR RUBLE DR.

PROJECT ENDS  
IL 149 - STA. 330+28  
AT PLUM ST.

OMISSION AT SN 039-0064  
STA. 133+12 TO STA. 137+41

PAY ITEMS:  
4' HMA SHOULDER, 8"  
SHOULDER RUMBLE STRIPS, 8 INCH

• VARIOUS ROUTES  
•• VARIOUS COUNTIES

FILE NAME =	USER NAME = mccordkr	DESIGNED -	REVISED -	STATE OF ILLINOIS DEPARTMENT OF TRANSPORTATION	LOCATION 1 IL 149 IN JACKSON COUNTY			F.A. RTE.	SECTION	COUNTY	TOTAL SHEETS	SHEET NO.
et:\pw\work\p\dot\mccordkr\0423878\78457-sht-plan.dgn		DRAWN -	REVISED -		•	D9 SAFETY SHLDS 2015-1	••	19	12			
Default		CHECKED -	REVISED -		SCALE: SHEET OF SHEETS STA. TO STA.			CONTRACT NO. 78457				
		DATE -	REVISED -		ILLINOIS FED. AID PROJECT							

LOCATION 2  
HERRIN ROAD IN WILLIAMSON CO.  
FROM CAMBRIA ROAD TO EAST OF COLP AT  
HERRIN ELEMENTARY SCHOOL

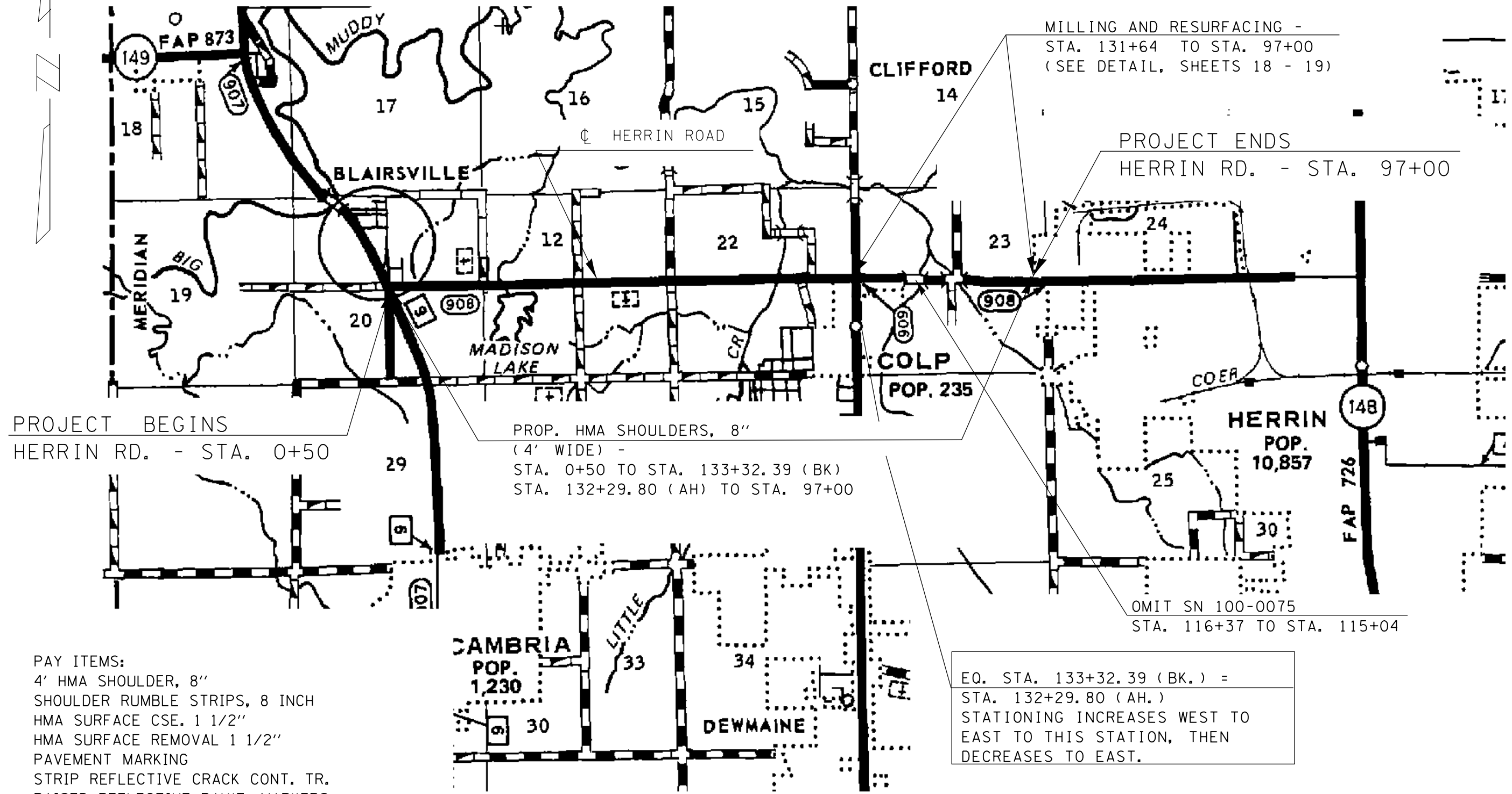

PROJECT BEGINS  
HERRIN RD. - STA. 0+50

PROP. HMA SHOULDERS, 8"  
(4' WIDE) -  
STA. 0+50 TO STA. 133+32.39 (BK)  
STA. 132+29.80 (AH) TO STA. 97+00

MILLING AND RESURFACING -  
STA. 131+64 TO STA. 97+00  
(SEE DETAIL, SHEETS 18 - 19)

PROJECT ENDS  
HERRIN RD. - STA. 97+00

- PAY ITEMS:  
4' HMA SHOULDER, 8"  
SHOULDER RUMBLE STRIPS, 8 INCH  
HMA SURFACE CSE. 1 1/2"  
HMA SURFACE REMOVAL 1 1/2"  
PAVEMENT MARKING  
STRIP REFLECTIVE CRACK CONT. TR.  
RAISED REFLECTIVE PAV'T. MARKERS

EQ. STA. 133+32.39 (BK.) =  
STA. 132+29.80 (AH.)  
STATIONING INCREASES WEST TO  
EAST TO THIS STATION, THEN  
DECREASES TO EAST.

• VARIOUS ROUTES  
•• VARIOUS COUNTIES

FILE NAME = e:\p\work\p\midot\mccordkr\0423878\78457-sh1-plan.dgn	USER NAME = mccordkr	DESIGNED -	REVISED -	<b>STATE OF ILLINOIS DEPARTMENT OF TRANSPORTATION</b>	<b>LOCATION 2 HERRIN ROAD IN WILLIAMSON COUNTY</b>				F.A. RTE.	SECTION	COUNTY	TOTAL SHEETS	SHEET NO.
Default	PLOT SCALE = 100.0000' / in.	DRAWN -	REVISED -		SCALE:	SHEET	OF	SHEETS	STA.	TO	STA.	19	13
	PLOT DATE = 3/16/2015	CHECKED -	REVISED -		CONTRACT NO. 78457								
		DATE -	REVISED -		ILLINOIS FED. AID PROJECT								

LOCATION 3

IL. 13 IN WILLIAMSON & SALINE COUNTIES  
FROM MAIN ST. IN MARION TO W. POPLAR ST. IN HARRISBURG

PROJECT BEGINS  
IL. 13 - STA. 127+27  
(NEAR MAIN ST.)

PROJECT ENDS  
IL. 13 - STA. 970+00

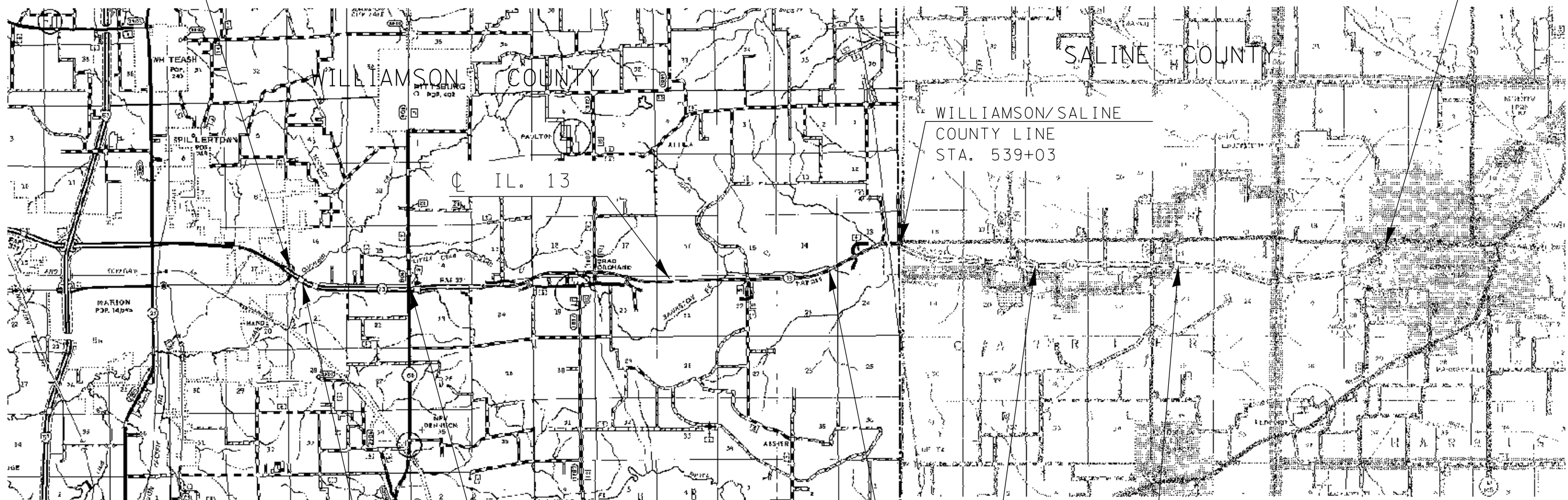

SN 100-0022 (EBL)  
SN 100-002 (WBL)  
STA. 136+16

INTERSECTION IL. 13 &  
IL. 166 - STA. 100+44.65

SN 100-006 (EBL)  
SN 100-0068 (WBL)  
STA. 478+12

WILLIAMSON/SALINE  
COUNTY LINE  
STA. 539+03

SN 083-0052 (EBL)  
SN 083-0053 (WBL)  
STA. 774+42

SN 083-0050 (EBL)  
SN 083-0051 (WBL)  
STA. 652+77

PAY ITEMS:  
SHOULDER RUMBLE STRIPS, 8 INCH

- VARIOUS ROUTES
- VARIOUS COUNTIES

FILE NAME =	USER NAME = mccordkr	DESIGNED -	REVISED -
ei:\pw\work\p\dot\mccordkr\0423878\78457-sh1-plan.dgn		DRAWN -	REVISED -
Default	PLOT SCALE = 100.0000' / in.	CHECKED -	REVISED -
	PLOT DATE = 3/16/2015	DATE -	REVISED -

STATE OF ILLINOIS  
DEPARTMENT OF TRANSPORTATION

LOCATION 3  
IL 13 IN WILLIAMSON/SALINE COUNTIES

SCALE: SHEET OF SHEETS STA. TO STA.

F.A. RTE.	SECTION	COUNTY	TOTAL SHEETS	SHEET NO.
•	D9 SAFETY SHLDRS 2015-1	••	19	14
			CONTRACT NO. 78457	
ILLINOIS FED. AID PROJECT				

LOCATION 4

IL. 14 IN PERRY AND FRANKLIN COUNTIES  
 FROM OLD DUQUOIN TO SYLVIA RD. NEAR CHRISTOPHER

PROJECT ENDS  
 IL. 14 - STA. 446+50  
 (SYLVIA RD. WEST  
 OF CHRISTOPHER)

PROJECT BEGINS  
 IL. 14 - STA. 177+00  
 (EAST OF OLD DU QUOIN)

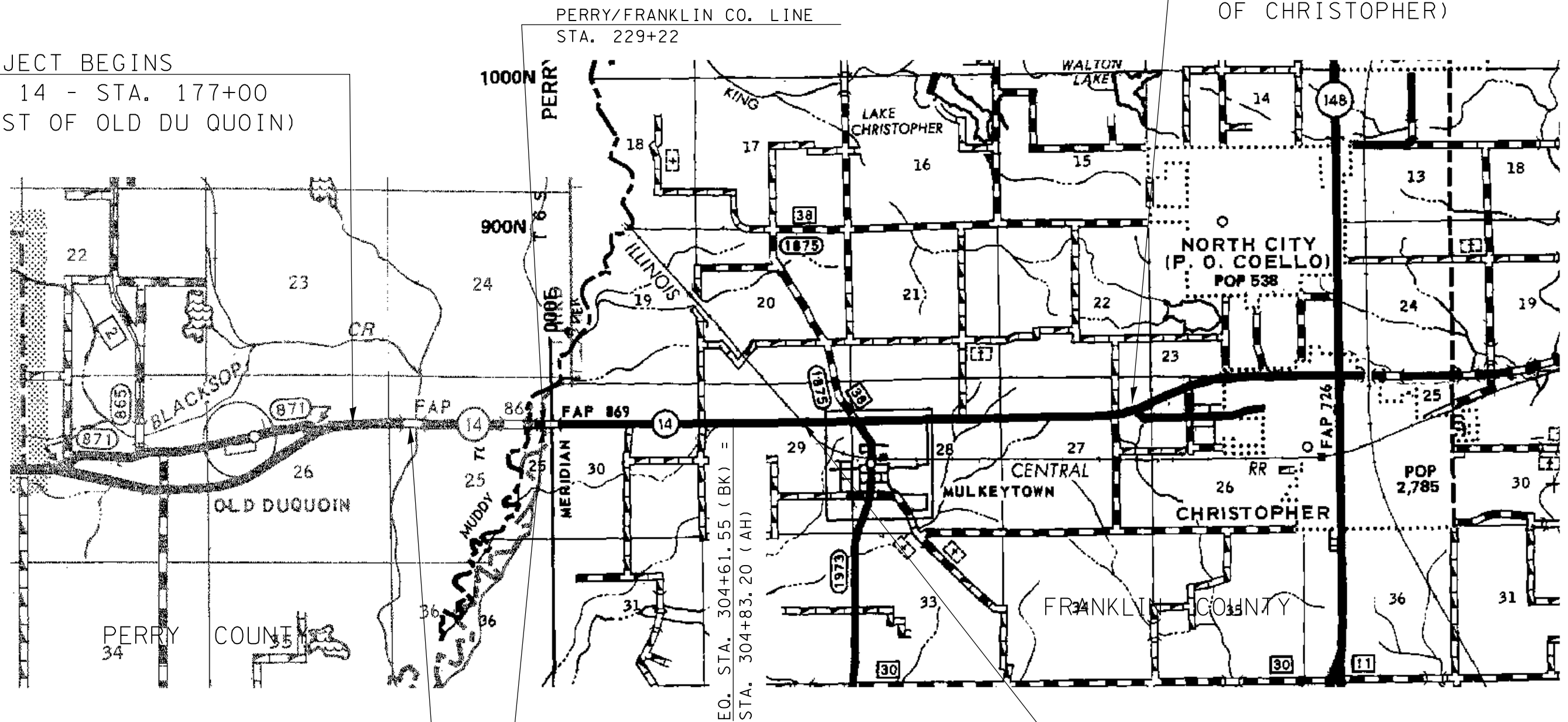

OMISSION AT SN 073-0036  
 STA. 190+09 TO STA. 191+91

OMISSION AT SN 073-0038  
 STA. 228+24 TO STA. 230+21

OMISSION AT RAILROAD X-ING  
 STA. 326+35 TO STA. 326+60  
 (SEE SPECIAL PROVISIONS FOR  
 RAILROAD PROTECTIVE LIABILITY  
 INSURANCE AND INFO.)

PAY ITEMS:  
 SHOULDER RUMBLE STRIPS, 8 INCH  
 RAILROAD PROTECTIVE LIABILITY INSURANCE

FILE NAME = c:\p\work\p\dot\mccordkr\0423878\78457-sh1-plan.dgn	USER NAME = mccordkr	DESIGNED -	REVISED -	STATE OF ILLINOIS DEPARTMENT OF TRANSPORTATION	LOCATION 4 IL 14 IN PERRY/FRANKLIN COUNTIES	F.A. RTE.	SECTION	COUNTY	TOTAL SHEETS	SHEET NO.
	PLOT SCALE = 100.0000' / in.	CHECKED -	REVISED -			D9 SAFETY SHLDRS 2015-1	**	19	15	CONTRACT NO. 78457
Default	PLOT DATE = 3/16/2015	DATE -	REVISED -	SCALE:	SHEET OF SHEETS	STA. TO STA.	ILLINOIS FED. AID PROJECT			

LOCATION 5

IL. 37 IN FRANKLIN AND WILLIAMSON COUNTIES  
FROM YELLOW BANKS RD. NORTH OF W. FRANKFORT TO  
NORTH OF JOHNSTON CITY

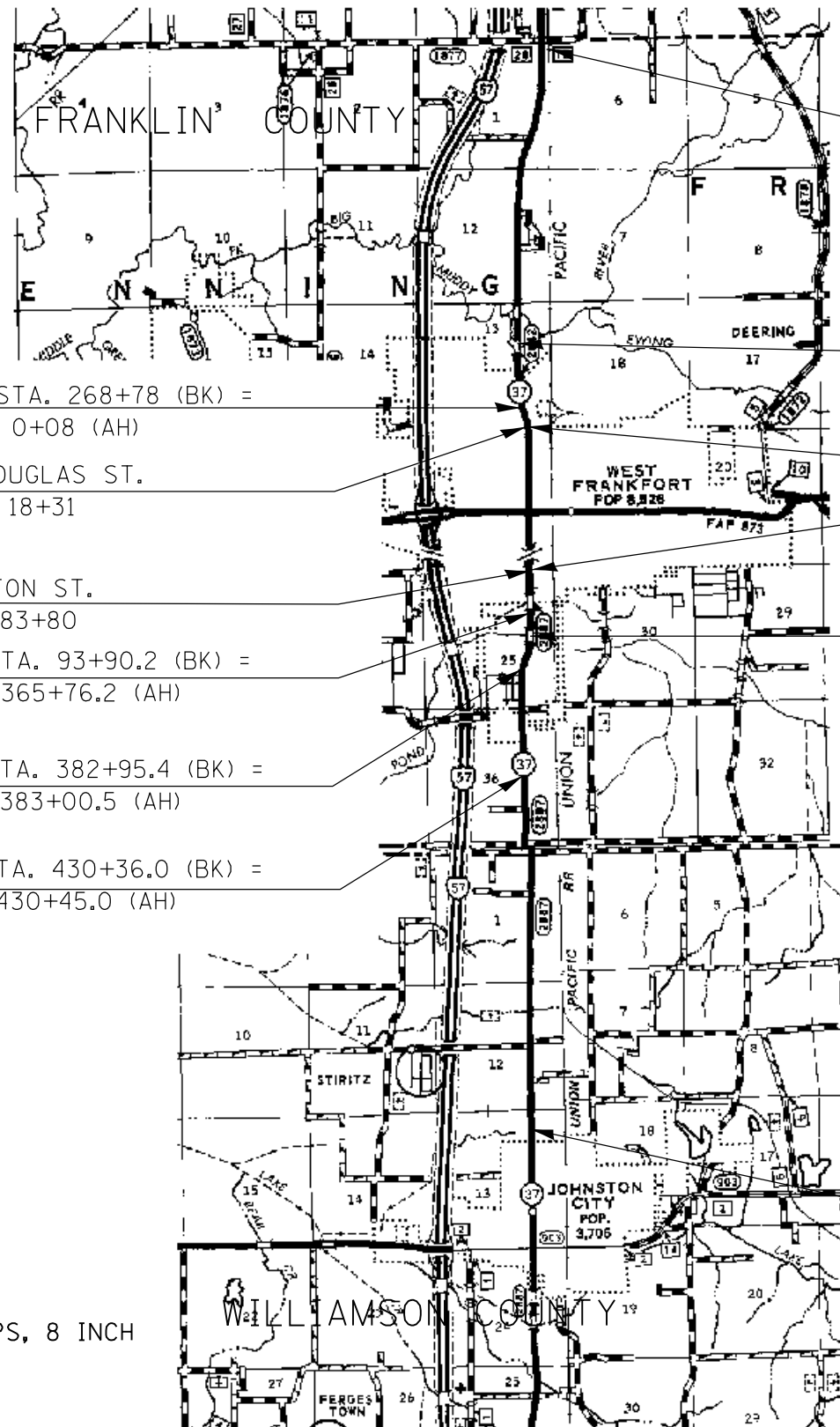

PROJECT BEGINS  
IL. 37 - STA. 130+00  
(SOUTH OF YELLOW BANKS RD.)

OMIT SN 028-0034 - STA. 253+83  
TO STA. 257+51

OMISSION - STA. 18+31 (N. DOUGLAS ST.) TO  
STA. 83+80 (SKELTON ST. ) THROUGH WEST  
FRANKFORT

OMIT SN 028-0078 - STA. 372+30  
TO STA. 374+70

FRANKLIN/WILLIAMSON CO. LINE  
STA. 457+18

PROJECT ENDS  
IL. 37 - STA. 569+05  
(NORTH OF JOHNSTON CITY  
AT SN 100-7125)

EQ. STA. 268+78 (BK) =  
STA. 0+08 (AH)

N. DOUGLAS ST.  
STA. 18+31

SKELTON ST.  
STA. 83+80

EQ. STA. 93+90.2 (BK) =  
STA. 365+76.2 (AH)

EQ. STA. 382+95.4 (BK) =  
STA. 383+00.5 (AH)

EQ. STA. 430+36.0 (BK) =  
STA. 430+45.0 (AH)

PAY ITEMS:  
SHOULDER RUMBLE STRIPS, 8 INCH

FILE NAME =	USER NAME = mccordkr	DESIGNED -	REVISED -
et:\pw\work\p\dot\mccordkr\0423878\78457-sh1-plan.dgn		DRAWN -	REVISED -
Default		CHECKED -	REVISED -
	PLOT SCALE = 100.0000' / in.	DATE -	REVISED -
	PLOT DATE = 3/16/2015		

STATE OF ILLINOIS  
DEPARTMENT OF TRANSPORTATION

LOCATION 5			
IL 37 IN FRANKLIN WILLIAMSON COUNTIES			
SCALE:	SHEET	OF SHEETS	STA. TO STA.

F.A. RTE.	SECTION	COUNTY	TOTAL SHEETS	SHEET NO.
•	D9 SAFETY SHLDRS 2015-1	**	19	16
				CONTRACT NO. 78457
ILLINOIS FED. AID PROJECT				



# ENTRANCE AND SIDE ROAD DETAILS

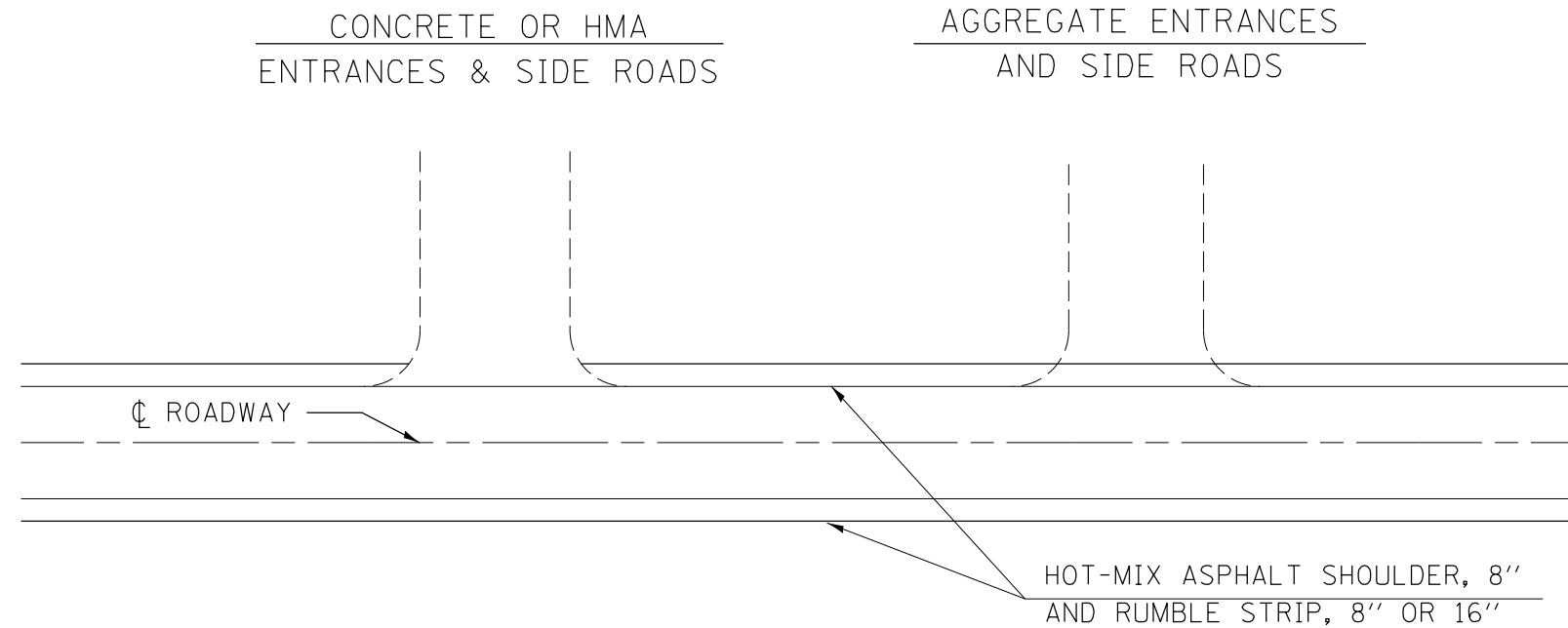

## GENERAL NOTES

1. CONSTRUCT HOT-MIX ASPHALT SHOULDER THROUGH AGGREGATE ENTRANCE OR SIDE ROADS. IF THE ENTRANCE OR SIDE ROAD IS CONCRETE OR HMA, THEN PLACE SHOULDER UP TO EDGE OF THE ENTRANCE OR SIDE ROAD PAVEMENT.
2. THE MATERIAL THAT IS REMOVED TO PLACE THE SHOULDER SHALL NOT BE WASTED ON THE FORESLOPE. DO NOT PLACE WASTE MATERIAL ONTO EXISTING ENTRANCES, SIDE ROADS OR ON MAINTAINED LAWNS. (SEE GENERAL NOTES)

• VARIOUS ROUTES  
•• VARIOUS COUNTIES

FILE NAME =	USER NAME = mccordkr	DESIGNED -	REVISED -	<b>STATE OF ILLINOIS DEPARTMENT OF TRANSPORTATION</b>	<b>ENTRANCE AND SIDE ROAD DETAILS</b>	F.A. RTE.	SECTION	COUNTY	TOTAL SHEETS	SHEET NO.
et:\pw\work\p\dot\mccordkr\0423878\78457-shr-plan.dgn	DRAWN -	REVISED -	•			D9 SAFETY SHLDRS 2015-1	••	19	17	
Default	PLOT SCALE = 100.0000' / in.	CHECKED -	REVISED -			CONTRACT NO. 78457				
	PLOT DATE = 3/16/2015	DATE -	REVISED -			ILLINOIS FED. AID PROJECT				
					SCALE:	SHEET	OF	SHEETS	STA.	TO STA.

LOCATION 2  
MILLING AND RESURFACING DETAIL  
ON HERRIN ROAD  
STA. 131+64 TO STA. 109+37

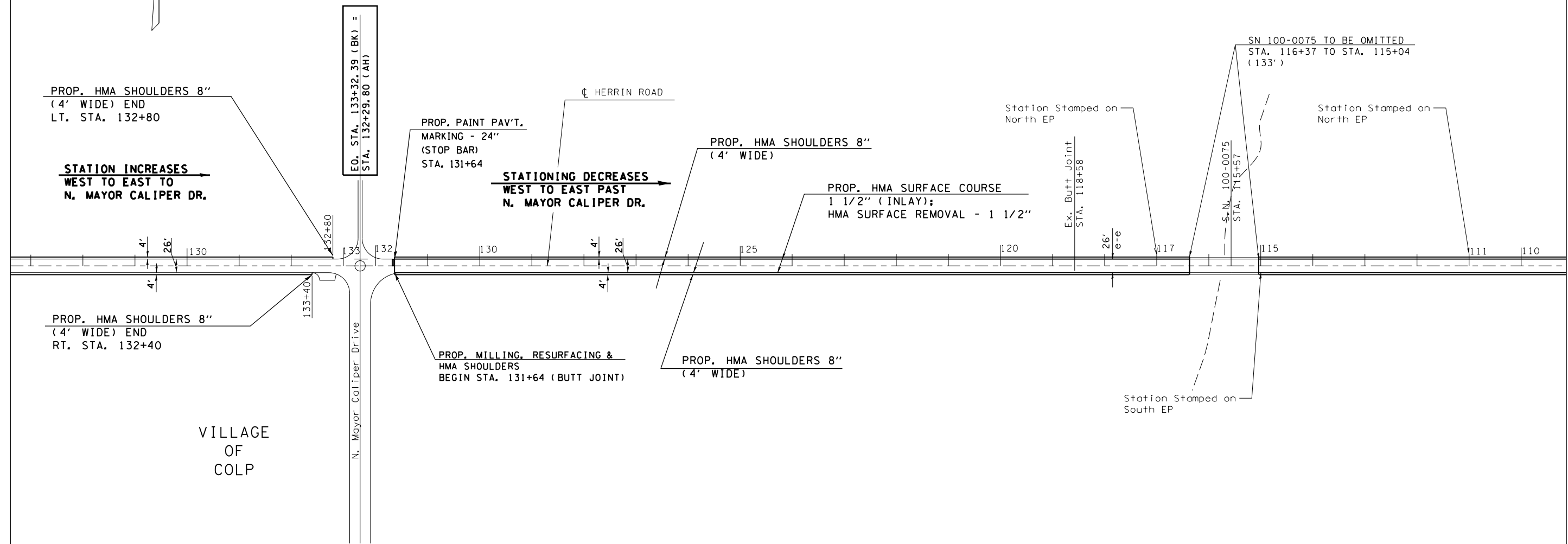

FILE NAME =	USER NAME = mccordkr	DESIGNED -	REVISED -
et:\pw\work\p\dot\mccordkr\0423878\78457-sh1-plan.dgn		DRAWN -	REVISED -
Default	PLOT SCALE = 200.0000' / in.	CHECKED -	REVISED -
	PLOT DATE = 3/16/2015	DATE -	REVISED -

**STATE OF ILLINOIS  
DEPARTMENT OF TRANSPORTATION**

<b>LOCATION 2 MILLING AND RESURFACING DETAIL</b>			
SCALE:	SHEET	OF	SHEETS
	STA.	TO	STA.

F.A. RTE.	SECTION	COUNTY	TOTAL SHEETS	SHEET NO.
D9 SAFETY SHLDRS 2015-1		••	19	18
CONTRACT NO. 78457			ILLINOIS FED. AID PROJECT	

LOCATION 2  
MILLING AND RESURFACING DETAIL  
ON HERRIN ROAD  
STA. 109+37 TO STA. 97+00

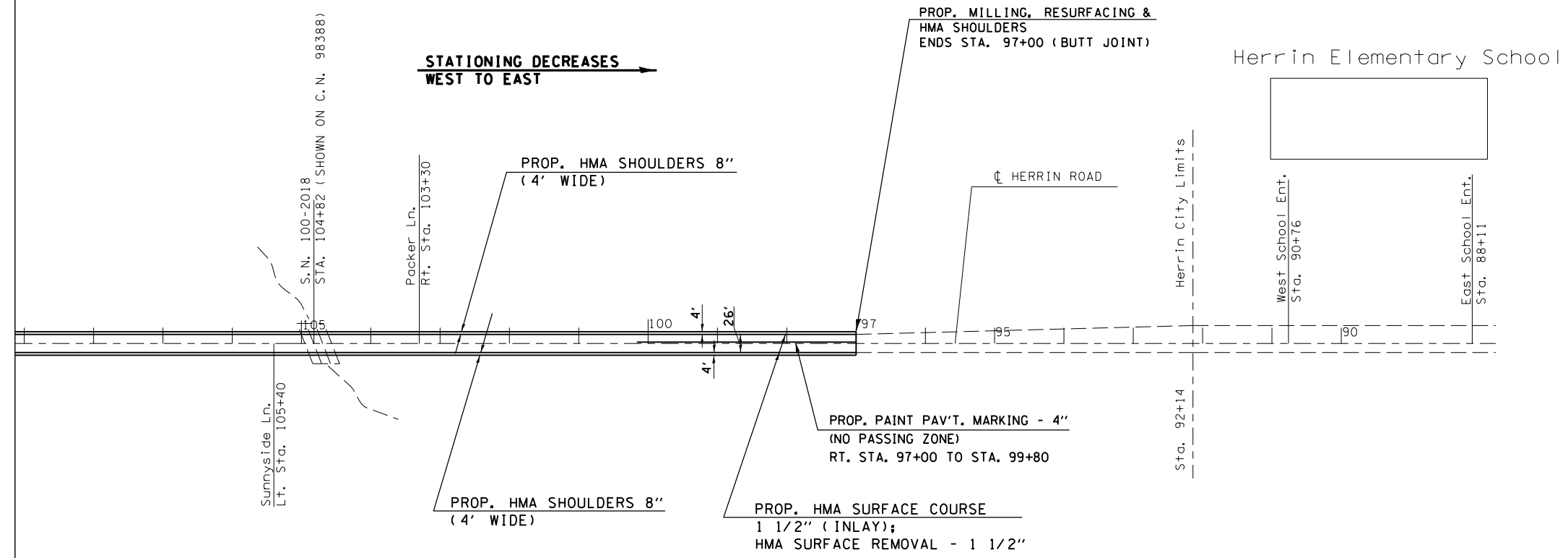

FILE NAME =	USER NAME = mccordkr	DESIGNED -	REVISED -
et:\pw\work\p\dot\mccordkr\0423878\78457-sh1-plan.dgn		DRAWN -	REVISED -
Default	PLOT SCALE = 200.0000' / in.	CHECKED -	REVISED -
	PLOT DATE = 3/16/2015	DATE -	REVISED -

**STATE OF ILLINOIS  
DEPARTMENT OF TRANSPORTATION**

<b>LOCATION 2 MILLING AND RESURFACING DETAIL</b>			
SCALE:	SHEET	OF	SHEETS
	STA.	TO	STA.

F.A. RTE.	SECTION	COUNTY	TOTAL SHEETS	SHEET NO.
•	D9 SAFETY SHLDRS 2015-1	••	19	19
CONTRACT NO. 78457				
ILLINOIS FED. AID PROJECT				