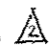

INDEX OF SHEETS

1	COVER SHEET
2	INDEX OF SHEETS, HIGHWAY STANDARDS, GENERAL NOTES AND COMMITMENTS
3 - 8A	SUMMARY OF QUANTITIES
9 - 12	TYPICAL SECTIONS
13	SCHEDULE OF QUANTITIES
14 - 17	ALIGNMENT AND TIES
18 - 19	EXISTING CONDITIONS AND REMOVAL PLAN
20 - 24	PLAN AND PROFILE: GEOMETRIC IL 132 (GRAND AVENUE)
25 - 26	PLAN AND PROFILE: GEOMETRIC FAIRFIELD ROAD
29 - 30	MAINTENANCE OF TRAFFIC
31	DETOUR 1 PLAN: IL 132 (GRAND AVENUE)
32	DETOUR 2 PLAN: FAIRFIELD ROAD
33	MAINTENANCE OF TRAFFIC STAGE 1 IL 132 (GRAND AVENUE)
34	MAINTENANCE OF TRAFFIC STAGE 1 FAIRFIELD ROAD
35	MAINTENANCE OF TRAFFIC STAGE 2 IL 132 (GRAND AVENUE)
36	MAINTENANCE OF TRAFFIC STAGE 2 FAIRFIELD ROAD
37 - 38	EROSION CONTROL PLAN
39 - 43	PLAN AND PROFILE: DRAINAGE AND UTILITY IL 132 (GRAND AVENUE)
44 - 47	PLAN AND PROFILE: DRAINAGE AND UTILITY FAIRFIELD ROAD
48 - 55	PLAT OF HIGHWAYS
56 - 57	PAVEMENT MARKING AND SIGNAGE PLAN
58 - 59	LANDSCAPING PLAN
60 - 66	DISTRICT ONE DETAIL - TS-06 STANDARD TRAFFIC SIGNAL DESIGN DETAILS
67	DISTRICT ONE MAST ARM MOUNTED STREET NAME SIGNS
68	EXISTING FLASHING BEACON REMOVAL PLAN AND TEMPORARY FLASHING BEACON INSTALLATION PLAN - IL 132 (GRAND AVENUE) AND FAIRFIELD ROAD
69	TRAFFIC SIGNAL INSTALLATION PLAN - IL 132 (GRAND AVENUE) AND FAIRFIELD ROAD
70	CABLE PLAN, PHASE DESIGNATION DIAGRAM AND EMERGENCY VEHICLE PREEMPTION SEQUENCE IL RTE 132 (GRAND AVE) AND FAIRFIELD ROAD
71	MAST ARM MOUNTED STREET NAMES AND SCHEDULE OF QUANTITIES IL RTE 132 (GRAND AVE) AND FAIRFIELD ROAD
72 - 75	LAKE COUNTY DETAILS
76	(BD-01) DRIVEWAY DETAILS - DISTANCE BETWEEN R.O.W. AND CURB OR EDGE GREATER THAN OR EQUAL TO 15'
77	(BD-07) DETAIL OF STORM SEWER CONNECTION TO EXISTING SEWER
78	(BD-22) PAVEMENT PATCHING FOR HMA SURFACED PAVEMENT
79	(BD-32) BUTT JOINTS AND HMA TAPER DETAILS
80	(TC-10) TRAFFIC CONTROL AND PROTECTION FOR SIDE ROADS, INTERSECTIONS, AND DRIVEWAYS
81	(TC-11) TYPICAL APPLICATIONS RAISED REFLECTIVE PAVEMENT MARKERS (SNOW-PLOW RESISTANT)
82	(TC-13) DISTRICT ONE TYPICAL PAVEMENT MARKINGS
83	(TC-16) PAVEMENT MARKING LETTERS AND SYMBOLS FOR TRAFFIC STAGING
84	(TC-21) DETOUR SIGNING FOR CLOSING STATE HIGHWAYS
85	(TC-22) ARTERIAL ROAD INFORMATION SIGNING
86	(TC-26) DRIVEWAY ENTRANCE SIGNING
87	CONCRETE BOX CULVERT EXTENSION STA 124+70
88 - 89	TEMPORARY SOIL RETENTION SYSTEM 
90 - 99	BORING LOGS
100-105	EXISTING PLANS - FOR INFORMATION ONLY
106-112	CROSS SECTIONS - IL 132 (GRAND AVE)
113-116	CROSS SECTIONS - FAIRFIELD ROAD

COMMITMENTS

1. THE CONTRACTOR SHALL PROTECT AND AVOID THE TENNIS COURT FENCE ON THE WEST SIDE OF FAIRFIELD ROAD SOUTH OF GRAND AVENUE.
2. THE CONTRACTOR SHALL CONTACT THE LAKE VILLA FIRE PROTECTION DISTRICT AT 847-356-2525 TO CONFIRM THAT THE EMERGENCY PRE-EMPTION EQUIPMENT SHALL BE THE "TOMAR" BRAND PRIOR TO ORDERING ANY EQUIPMENT.

HIGHWAY STANDARDS

- 000001-04 STANDARD SYMBOLS, ABBREVIATIONS AND PATTERNS
- 001001-02 AREAS OF REINFORCEMENT BARS
- 280001-07 TEMPORARY EROSION CONTROL SYSTEMS
- 406201-01 MAILBOX TURNOUT
- 424001-08 PERPENDICULAR CURB RAMPS FOR SIDEWALKS
- 424011-02 CORNER PARALLEL CURB RAMPS FOR SIDEWALKS
- 442201-03 CLASS C AND D PATCHES
- 482011-03 HMA SHLD. STRIPS/SHLDS. WITH RESURFACING OR WIDENING AND RESURFACING PROJECTS
- 542301-03 PRECAST REINFORCED CONCRETE FLARED END SECTION
- 542306-02 PRECAST REINFORCED CONCRETE ELLIPTICAL FLARED END SECTION
- 601001-04 SUB-SURFACE DRAINS
- 601101-01 CONCRETE HEADWALL FOR PIPE DRAIN
- 602301-04 INLET - TYPE A
- 602401-03 MANHOLE TYPE A
- 602601-03 PRECAST REINFORCED CONCRETE FLAT SLAB TOP
- 602701-02 MANHOLE STEPS
- 604001-04 FRAME AND LIDS TYPE 1
- 630001-10 STEEL PLATE BEAM GUARDRAIL
- 630106-01 LONG-SPAN GUARDRAIL OVER CULVERT
- 630301-06 SHOULDER WIDENING FOR TYPE 1 (SPECIAL) GUARDRAIL TERMINALS
- 631011-07 TRAFFIC BARRIER TERMINAL, TYPE 2
- 635001-01 DELINEATORS
- 635006-03 REFLECTOR AND TERMINAL MARKER PLACEMENT
- 635011-02 REFLECTOR MARKER AND MOUNTING DETAILS
- 701001-02 OFF-RD OPERATIONS, 2L, 2W, MORE THAN 15' (4.5 m) AWAY
- 701006-05 OFF-RD OPERATIONS, 2L, 2W, 15' (4.5 m) TO 24' (600 mm) FROM PAVEMENT EDGE
- 701011-04 OFF-RD MOVING OPERATIONS, 2L, 2W, DAY ONLY
- 701301-04 LANE CLOSURE, 2L, 2W, SHORT TIME OPERATIONS
- 701306-03 LANE CLOSURE, 2L, 2W, SLOW MOVING OPERATIONS DAY ONLY, FOR SPEEDS ≥ 45 MPH
- 701311-03 LANE CLOSURE, 2L, 2W MOVING OPERATIONS - DAY ONLY
- 701326-04 LANE CLOSURE, 2L, 2W, PAVEMENT WIDENING, FOR SPEEDS ≥ 45 MPH
- 701336-04 LANE CLOSURE, 2L, 2W, WORK AREAS IN SERIES, FOR SPEEDS ≥ 45 MPH
- 701801-05 SIDEWALK, CORNER OR CROSSWALK CLOSURE
- 701901-04 TRAFFIC CONTROL DEVICES
- 704001-07 TEMPORARY CONCRETE BARRIER
- 720001-01 SIGN PANEL MOUNTING DETAILS
- 720006-04 SIGN PANEL ERECTION DETAILS
- 720016-03 MAST ARM MOUNTED STREET NAME SIGNS
- 728001-01 TELESCOPING STEEL SIGN SUPPORT
- 780001-05 TYPICAL PAVEMENT MARKINGS
- 781001-03 TYPICAL APPLICATIONS RAISED REFLECTIVE PAVEMENT MARKERS
- 814001-03 HANDHOLES
- 814006-02 DOUBLE HANDHOLES
- 857001-04 STANDARD PHASE DESIGNATION DIAGRAMS AND PHASE SEQUENCES
- 862001-01 UNINTERRUPTABLE POWER SUPPLY (UPS)
- 873001-02 TRAFFIC SIGNAL GROUNDING & BONDING
- 876001-03 PEDESTRIAN PUSH BUTTON POST
- 877001-05 STEEL MAST ARM ASSEMBLY AND POLE 16' THROUGH 55'
- 877011-05 STEEL COMB. MAST ARM ASSEMBLY AND POLE 16' THROUGH 55'
- 878001-10 CONCRETE FOUNDATION DETAILS
- 880001-01 SPAN WIRE MOUNTED SIGNALS AND FLASHING BEACON INSTALLATION
- 880006-01 TRAFFIC SIGNAL MOUNTING DETAILS
- 886001-04 DETECTOR LOOP INSTALLATIONS
- 886006-04 TYPICAL LAYOUTS FOR DETECTION LOOPS

GENERAL NOTES

1. ALL CONSTRUCTION SHALL BE DONE IN ACCORDANCE WITH THE DETAILS IN THE PLANS, THE SPECIAL PROVISIONS INCLUDED IN THE CONTRACT DOCUMENTS, AND THE LATEST EDITION OF THE FOLLOWING STATE OF ILLINOIS SPECIFICATIONS: "THE STANDARD SPECIFICATIONS FOR ROAD AND BRIDGE CONSTRUCTION" (REFERRED TO AS THE "STANDARD SPECIFICATIONS"), THE "SUPPLEMENTAL SPECIFICATIONS AND RECURRING SPECIAL PROVISIONS", THE "MANUAL ON UNIFORM TRAFFIC CONTROL DEVICES FOR STREETS AND HIGHWAYS" AND THE "MANUAL OF TEST PROCEDURES FOR MATERIALS".
2. BEFORE STARTING ANY EXCAVATION, THE CONTRACTOR SHALL CALL "JULIE" AT (800) 892-0123 FOR FIELD LOCATIONS OF BURIED ELECTRIC, TELEPHONE, AND GAS FACILITIES. 48 HOUR NOTIFICATION REQUIRED.
3. THE CONTRACTOR WILL NOT BE ALLOWED TO SET UP A YARD OR FIELD OFFICE ON STATE PROPERTY WITHOUT THE WRITTEN PERMISSION OF THE DEPARTMENT.
4. THE CONTRACTOR SHALL COORDINATE ALL CONSTRUCTION ACTIVITIES WITH UTILITY COMPANIES, VILLAGE OF LAKE VILLA, LAKE COUNTY DIVISION OF TRANSPORTATION, AND LAKE VILLA TOWNSHIP.
5. BUTT JOINTS WILL BE INSTALLED AT THE ENDS OF ALL RESURFACING (WHERE RESURFACING MEETS EXISTING PAVEMENT), IN ACCORDANCE WITH THE "BUTT JOINT AND HMA TAPER DETAILS" SHEET INCLUDED IN THE PLANS UNLESS OTHERWISE SPECIFIED.
6. WHEN MILLED PAVEMENT IS OPEN TO TRAFFIC, THE MAXIMUM GRADE DIFFERENTIAL BETWEEN PASSES OF THE MILLING MACHINE SHALL NOT EXCEED 1/2 INCHES WHERE THE SPEED LIMIT IS 45 MPH OR LESS AND 1 INCH WHERE THE SPEED LIMIT IS GREATER THAN 45 MPH. WITH WRITTEN APPROVAL FROM THE ENGINEER, A MAXIMUM GRADE DIFFERENTIAL OF 3 INCHES MAY BE ALLOWED IF THE EDGE OF MILLING IS SLOPED AT A MINIMUM OF 1:3 (V:H).
7. THE RESIDENT ENGINEER SHALL CONTACT WALTER CZAPNY, AREA TRAFFIC FIELD ENGINEER, AT (847) 438-2300 AT LEAST TWO (2) WEEKS PRIOR TO PLACING PERMANENT PAVEMENT MARKINGS.
8. THE CONTRACTOR SHALL CONTACT THE DISTRICT ONE TRAFFIC CONTROL SUPERVISOR AT (847) 705-4470 A MINIMUM OF 72 HOURS IN ADVANCE OF BEGINNING WORK.
9. ALL PAVEMENT PATCHING LOCATIONS WILL BE DETERMINED IN THE FIELD BY THE ENGINEER.
10. LANE MARKERS ARE TO BE USED AS SHOWN ON THE DISTRICT ONE DETAIL "TYPICAL APPLICATIONS - RAISED REFLECTIVE MARKERS (SNOW-PLOW RESISTANT)" SHOWN IN THE PLANS.
11. THE CONTRACTOR SHALL BE RESPONSIBLE FOR VERIFYING ALL DIMENSIONS AND EXISTING CONDITIONS IN THE FIELD PRIOR TO CONSTRUCTION AND ORDERING MATERIALS.
12. THE CONTRACTOR SHALL BE REQUIRED TO PROVIDE ACCESS TO ADJUTING PROPERTY AT ALL TIMES DURING THE CONSTRUCTION OF THIS PROJECT.
13. WHEN CONSTRUCTION OPERATIONS ON TWO-LANE ROADS OPEN TO TRAFFIC RESULT IN THE REMOVAL OR COVERING OF ANY PAVEMENT MARKING INDICATING PASSING RESTRICTIONS, "NO PASSING ZONES STRIPED NEXT ----- MILES" SIGNS SHALL BE USED. THE CONTRACTOR SHALL PLACE THE SIGNS AT THE BEGINNING OF THE UNSTRIPED AREA, JUST BEYOND EACH MAJOR INTERSECTION WITHIN THE UNSTRIPED AREA, AND AT SUCH LOCATIONS AS THE ENGINEER MAY DIRECT TO ENSURE A MINIMUM SPACING OF FIVE MILES.
14. ALL CRACKS AND JOINTS SHALL BE CLEANED PRIOR TO FILLING THEM. THIS WORK SHALL BE INCLUDED IN THE ITEM "MIXTURE FOR CRACKS, JOINTS AND FLANGEWAYS".
15. THE THICKNESS OF HMA SHOWN ON THE PLANS IS THE NOMINAL THICKNESS. DEVIATIONS FROM THE NOMINAL THICKNESS WILL BE PERMITTED WHEN SUCH DEVIATIONS OCCUR DUE TO IRREGULARITIES IN THE EXISTING SURFACE OR BASE ON WHICH THE HMA IS PLACED.
16. ONLY THOSE TREES DESIGNATED BY THE ENGINEER SHALL BE REMOVED. THE CONTRACTOR SHALL PROTECT ALL REMAINING TREES FROM DAMAGE DUE TO HIS OPERATIONS.
17. SHORT TERM PAVEMENT MARKING SHALL BE USED TO OUTLINE TRAVEL LANES FOR THE PRIME COAT APPLICATION AND EACH RESURFACING LIFT.
18. SIGNS INDICATED FOR REMOVAL SHALL BE DISPOSED OF BY THE CONTRACTOR ACCORDING TO ARTICLE 202.03.
19. THE DEPARTMENT HAS NOT OBTAINED ANY PERMITS FOR OFFSITE BORROW, WASTE, USE (BWU) AREAS. PRIOR TO WORKING IN BWU AREAS, IF THE CONTRACTOR CHOOSES TO USE ACTIVITIES REQUIRING PERMITS IT IS THE CONTRACTOR'S RESPONSIBILITY TO SECURE THE PROPER PERMITS. IN ADDITION TO THE BORROW REVIEW (BDE 2289) AND USE/WASTE REVIEW (UDE 2290) SUBMITTALS, THE CONTRACTOR SHALL SUBMIT AN EROSION AND SEDIMENT CONTROL (ESC) PLAN FOR EVERY BWU SITE TO THE DEPARTMENT FOR ACCEPTANCE. GUIDELINES FOR ACCEPTABLE BWU PRACTICES CAN BE FOUND IN SECTION II.G.1 AND 2 OF THE SWPPP. THE COST OF ALL MATERIALS AND LABOR NECESSARY TO COMPLY WITH THE ABOVE PROVISIONS TO PREPARE AND IMPLEMENT ESC PLANS WILL NOT BE PAID FOR SEPARATELY, BUT SHALL BE CONSIDERED AS INCLUDED IN THE UNIT BID PRICES OF THE CONTRACT AND NO ADDITIONAL COMPENSATION WILL BE ALLOWED.
20. SOME SOILS EXCAVATED THROUGHOUT THE PROJECT AREA MAY HAVE HIGH PLASTICITY (LL AND PI) AND MAY BE PRONE TO SWELLING UPON WETTING. THESE SOILS SHOULD NOT BE USED AS EMBANKMENT FILL UNLESS THEY HAVE LL LESS THAN 50%, PI LESS THAN 20%, AND A MDD GREATER THAN 90 PCF.
21. IT IS ASSUMED THE TOP 16" OF THE EXISTING GROUND OUTSIDE THE SHOULDER SHALL BE EXCAVATED, STOCKPILED, AND PLACED. QUANTITIES FOR THIS WORK ARE INCLUDED IN TOPSOIL EXCAVATION AND PLACEMENT.

COPYRIGHT © 2015 BY BAXTER & WOODMAN, INC.
 STATE OF ILLINOIS - PROFESSIONAL DESIGN FIRM
 LICENSE NO. 017-08121 - EXPIRES 4/20/2019
 A member of the Woodman Group of Companies
 4737 26th St. Skokie, IL 60077-4000
 TEL: 847.479.2600 FAX: 847.479.2606
 www.baxterandwoodman.com

DESIGNED	- G.S.	REVISED	- 3-17-15 1007 REVIEW
DRAWN	- URS	REVISED	- 3-07-15 1007 REVIEW
CHECKED	- LOM	REVISED	-
DATE	- 1-30-15	FILE	- 100193-0037-001a.dwg

STATE OF ILLINOIS
DEPARTMENT OF TRANSPORTATION

IL 132 (GRAND AVE) AND FAIRFIELD ROAD
INDEX OF SHEETS, HIGHWAY STANDARDS, GENERAL NOTES
AND COMMITMENTS

SCALE: NO SCALE STA. TO STA.

PAR. RFE.	SECTION	COUNTY	TOTAL SHEET SHEETS
841	W-11	LAKE	119 2
			CONTRACT NO. 6CR85
FED. ROAD DIST. NO. 1 ILLINOIS FED. AID PROJECT			

Rev. 6-2-15

SUMMARY OF QUANTITIES

CODE NO.	ITEM	UNIT	TOTAL QUANTITY	CONSTRUCTION CODE				
				80% FEDERAL 20% STATE	100% COUNTY	80% FEDERAL 20% TOWNSHIP	80% FEDERAL 10% STATE 10% COUNTY	100% FIRE PROTECTION DISTRICT
				ROADWAY 0004 URBAN	ROADWAY 0004 URBAN	SHARE USE PATH 0021 URBAN	TRAFFIC SIGNALS 0021 URBAN	EVP 0021 URBAN
88030100	SIGNAL HEAD, LED, 1-FACE, 5-SECTION, BRACKET MOUNTED	EACH	4				4	
88030110	SIGNAL HEAD, LED, 1-FACE, 5-SECTION, MAST-ARM MOUNTED	EACH	4				4	
88102717	PEDESTRIAN SIGNAL HEAD, LED, 1-FACE, BRACKET MOUNTED WITH COUNTDOWN TIMER	EACH	8				8	
88200210	TRAFFIC SIGNAL BACKPLATE, LOUVERED, ALUMINUM	EACH	8				8	
88500100	INDUCTIVE LOOP DETECTOR	EACH	8				8	
88600100	DETECTOR LOOP, TYPE I	FOOT	921				921	
88700200	LIGHT DETECTOR	EACH	2					2
88700300	LIGHT DETECTOR AMPLIFIER	EACH	1					1
88800100	PEDESTRIAN PUSH BUTTON	EACH	8				8	
89502400	REMOVE EXISTING FLASHING BEACON INSTALLATION COMPLETE	EACH	1				1	
A2002910	TREE, CELTIS OCCIDENTALIS (COMMON HACKBERRY), 2" CALIPER, BALLED AND BURLAPPED	EACH	10	10				
A2006568	TREE, QUERCUS BICOLOR (SWAMP WHITE OAK), 7' HEIGHT, CLUMP FORM, BALLED AND BURLAPPED	EACH	10	10				
A2006572	TREE, QUERCUS BICOLOR (SWAMP WHITE OAK), 9' HEIGHT, CLUMP FORM, BALLED AND BURLAPPED	EACH	10	10				
A2007132	TREE, QUERCUS SCHUETZ (SWAMP BUR OAK), 2" CALIPER, BALLED AND BURLAPPED	EACH	10	10				
Z0013798	CONSTRUCTION LAYOUT	L SUM	1	1				

CODE NO.	ITEM	UNIT	TOTAL QUANTITY	CONSTRUCTION CODE				
				80% FEDERAL 20% STATE	100% COUNTY	80% FEDERAL 20% TOWNSHIP	80% FEDERAL 10% STATE 10% COUNTY	100% FIRE PROTECTION DISTRICT
				ROADWAY 0004 URBAN	ROADWAY 0004 URBAN	SHARE USE PATH 0021 URBAN	TRAFFIC SIGNALS 0021 URBAN	EVP 0021 URBAN
Z0018500	DRAINAGE STRUCTURES TO BE CLEANED	EACH	2	2				
Z0030850	TEMPORARY INFORMATION SIGNING	SQ FT	226	226				
Z0062456	TEMPORARY PAVEMENT	SQ YD	153	153				
Z0077803	REMOVE WOOD POST	EACH	3	3				
X0300268	WOODEN FENCE REMOVAL	FOOT	87	87				
X0324085	EMERGENCY VEHICLE PRIORITY SYSTEM LINE SENSOR CABLE, NO. 20 3/C	FOOT	267					267
Z0073002	TEMPORARY SOIL RETENTION SYSTEM	SQ FT	32,174	32,174				
X02020110	GRADING AND SHAPING SHOULDERS	UNIT	1	1				
X2110100	TOPSOIL FURNISH AND PLACE, SPECIAL	CU YD	25	25				
X4020000	AGGREGATE SURFACE COURSE, TYPE B SPECIAL	SQ YD	1,641			1,641		
X4021000	TEMPORARY ACCESS (PRIVATE ENTRANCE)	EACH	13	13				
X4022000	TEMPORARY ACCESS (COMMERCIAL ENTRANCE)	EACH	4	4				
X5400504	PRECAST CONCRETE BOX CULVERTS 2' X 2' (SPECIAL)	FOOT	22	22				
X6013600	PIPE UNDERDRAINS 4" (MODIFIED)	FOOT	2,511	2,511				
X7010216	TRAFFIC CONTROL AND PROTECTION, (SPECIAL)	L SUM	1	1				

* INDICATES SPECIALTY ITEM

* INDICATES SPECIALTY ITEM

△ NON-PARTICIPATING (100% STATE)

COPYRIGHT © 2014 BY BAXTER & WOODMAN, INC.
 STATE OF ILLINOIS PROFESSIONAL ENGINEER
 LICENSE NO. 041-04897-1 EXP. 03/31/2015
 B&W FOR LANCELOTTI DOT WORKS - NO. 100153-R037-5017.sht
 11/21/15

BAXTER & WOODMAN	DESIGNED - DJS	REVISED - 3-17-15 100% REVIEW
	DRAWN - DKS	REVISED - 3-27-15 100% REVIEW
	CHECKED - LDH	REVISED -
	DATE - 1-20-15	FILE - 100153-R037-5017.sht

STATE OF ILLINOIS
DEPARTMENT OF TRANSPORTATION

IL 132 (GRAND AVE) AND FAIRFIELD ROAD
SUMMARY OF QUANTITIES

△ Rev. 6-2-15

S.P.R. RTE.	SECTION	COUNTY	TOTAL SHEETS
594	W-N-1	LAKE	118 : 8
CONTRACT NO. 60R85			
FED. ROAD DIST. NO. 1 ILL. DIST. FED. AID PROJECT			

SCALE: STA. TO STA.



MATCH LINE STA. 109+50 - SEE BELOW LEFT

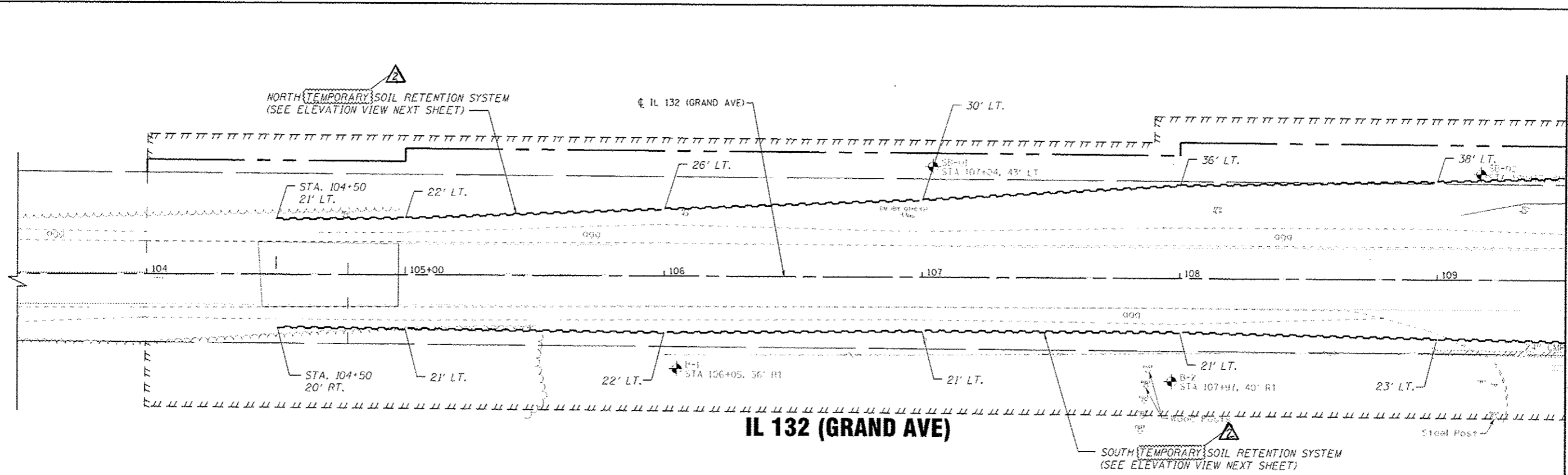

IL 132 (GRAND AVE)

PLAN

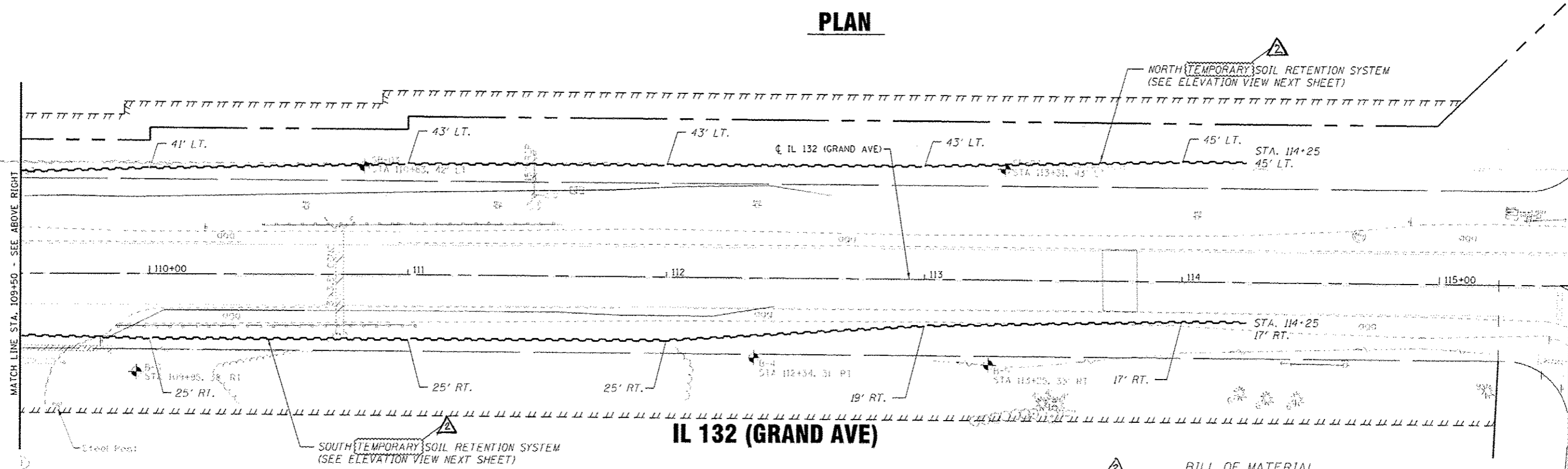

IL 132 (GRAND AVE)

PLAN

BILL OF MATERIAL

ITEM	UNIT	TOTAL
TEMPORARY SOIL RETENTION SYSTEM	SQ FT	32,174



PROJECT: ILLINOIS DEPARTMENT OF TRANSPORTATION - TEMPORARY SOIL RETENTION SYSTEM
 DRAWN BY: UKB
 CHECKED BY: LGH
 DATE: 1-30-15
 FILE: 100153-W037-Temp-Soil-Retention.dgn

BAXTER & WOODMAN CONSULTING ENGINEERS	DESIGNED - BLB	REVISED - 3-27-15 IDOT REVIEW
	DRAWN - UKB	REVISED - 6/2/15 ADDENDUM
	CHECKED - LGH	REVISED -
	DATE - 1-30-15	FILE - 100153-W037-Temp-Soil-Retention.dgn

STATE OF ILLINOIS
DEPARTMENT OF TRANSPORTATION

IL 132 GRAND AVE AND FAIRFIELD ROAD TEMPORARY SOIL RETENTION SYSTEM		F.A.P. RTE. 541	SECTION W-N-1	COUNTY LAKE	TOTAL SHEETS 116	SHEET NO. 88
SCALE: 1" = 20'	STA. 103+50 TO STA. 115+50	CONTRACT NO. 60R85				
FED. ROAD DIST. NO. 1 ILLINOIS FED. AID PROJECT						

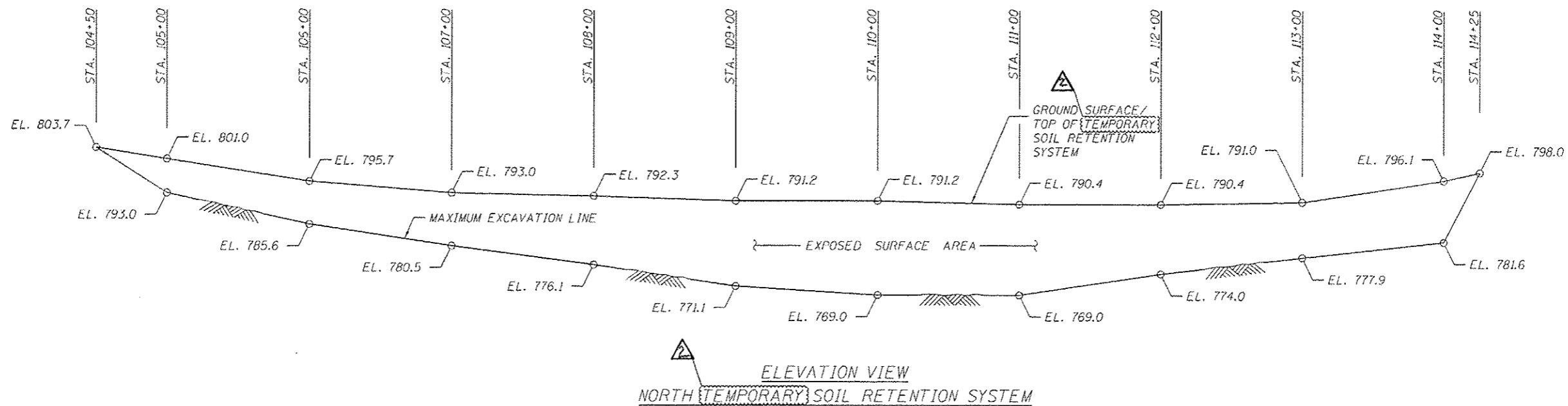

ELEVATION VIEW
NORTH TEMPORARY SOIL RETENTION SYSTEM

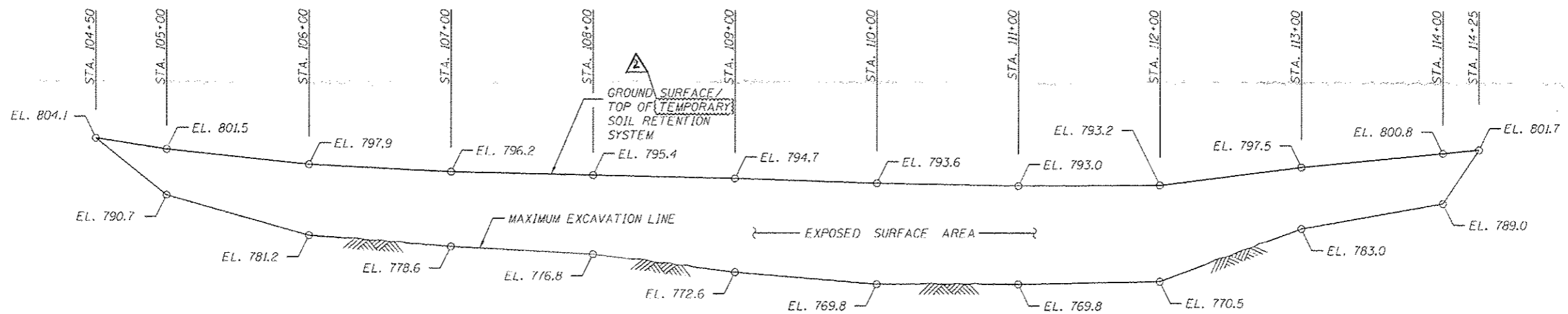

ELEVATION VIEW (REFLECTED)
SOUTH TEMPORARY SOIL RETENTION SYSTEM

NOTE:

A CANTILEVERED SHEET PILING DESIGN DOES NOT APPEAR FEASIBLE AND ADDITIONAL MEMBERS OR OTHER RETENTION SYSTEM MAY BE NECESSARY. THE CONTRACTOR SHALL SUBMIT A TEMPORARY SOIL RETENTION SYSTEM DESIGN INCLUDING PLAN DETAILS AND CALCULATIONS FOR REVIEW AND ACCEPTANCE BY THE ENGINEER.

CONTRACT NO. 60R85, SHEET 116 OF 116, DATE 1-30-15, PROJECT: IL 132 GRAND AVE AND FAIRFIELD ROAD, CONTRACT NO. 60R85, SHEET NO. 116, DRAWN BY: UKB, CHECKED BY: LBH, DATE: 1-30-15, FILE: I00153-W037-Temp-Soil-Retention.dwg, PROJECT: IL 132 GRAND AVE AND FAIRFIELD ROAD, CONTRACT NO. 60R85, SHEET NO. 116, DRAWN BY: UKB, CHECKED BY: LBH, DATE: 1-30-15, FILE: I00153-W037-Temp-Soil-Retention.dwg

BAXTER & WOODMAN
CONSULTING ENGINEERS

DESIGNED -	HLB	REVISED -	3-27-15 IDOT REVIEW
DRAWN -	UKB	REVISED -	6/27/15 ADDENDUM
CHECKED -	LBH	REVISED -	
DATE -	1-30-15	FILE -	I00153-W037-Temp-Soil-Retention.dwg

STATE OF ILLINOIS
DEPARTMENT OF TRANSPORTATION

IL 132 GRAND AVE AND FAIRFIELD ROAD
TEMPORARY SOIL RETENTION SYSTEM

SCALE: 1" = 20'

STA. TO STA.

F.A.P. RTE.	SECTION	COUNTY	TOTAL SHEETS	SHEET NO.
541	W-N-1	LAKE	116	89

CONTRACT NO. 60R85
FED. ROAD DIST. NO. 1 ILLINOIS FED. AID PROJECT