

STATE OF ILLINOIS
DEPARTMENT OF TRANSPORTATION

F.A.P. RY	SECTION	COUNTY	TOTAL SHEETS	SHEET NO.
317	D5 CM INLAY 2020-1	MCLEAN	8	8
		CONTRACT NO. 70E31		

FOR INDEX OF SHEETS, SEE SHEET NO. 2
FOR SUMMARY OF QUANTITIES, SEE SHEET NO. 3

CURRENT TRAFFIC DATA				
LOCATION	ADT 2019	PU %	SU %	MU %
F.A.P. 317 (U.S. 24) LEG "A"	= 3,300	69.7	8.3	22.0
F.A.P. 317 (U.S. 24) LEG "B"	= 7,500	80.6	9.7	9.7
FUNCTIONAL CLASSIFICATION = OTHER PRINCIPAL ARTERIAL				

DESIGN DESIGNATION
N / A

PROPOSED HIGHWAY PLANS

F.A.P. ROUTE 317 (US 24)
SECTION D5 CM INLAY 2020-1
PROJECT
PARTIAL WIDTH RESURFACING
MCLEAN COUNTY

C-95-016-20
0.3 MI W OF I-55 TO OLD RTE 66 W OF CHENOA

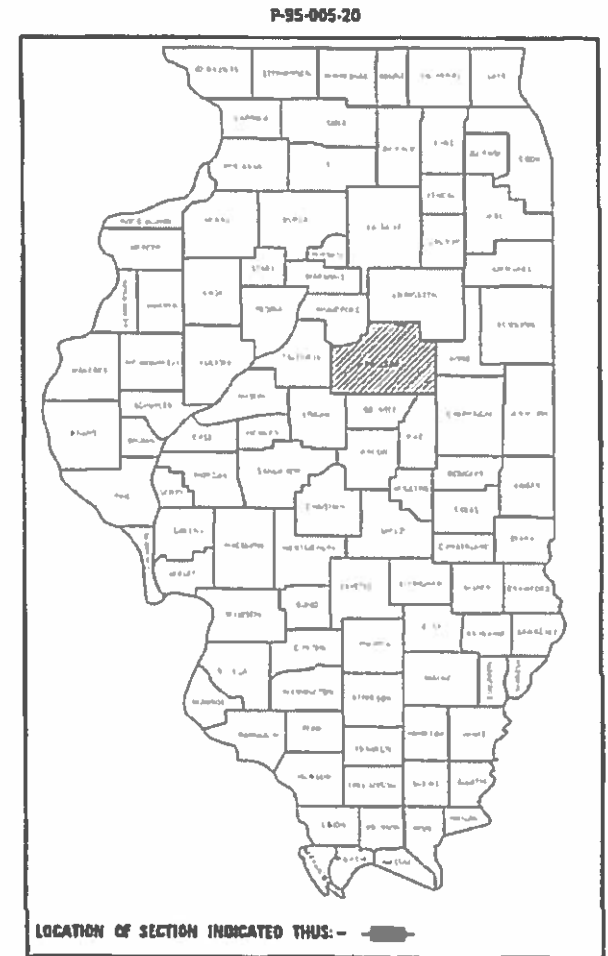

FULL SIZE PLANS HAVE BEEN PREPARED USING STANDARD ENGINEERING SCALES. REDUCED SIZED PLANS WILL NOT CONFORM TO STANDARD SCALES. IN MAKING MEASUREMENTS ON REDUCED PLANS, THE ABOVE SCALES MAY BE USED.

J.U.L.E.
JOINT UTILITY LOCATION INFORMATION FOR EXCAVATORS
1-800-492-0123
OR 811 CHENOA TOWNSHIP

PROJECT ENGINEER: JASON W. STULTS
SQUAD LEADER: DAVID F. JAYME
DESIGNERS: JASON C. HELANDER
PHONE NUMBER: (217) 465-4181

CONTRACT NO. 70E31

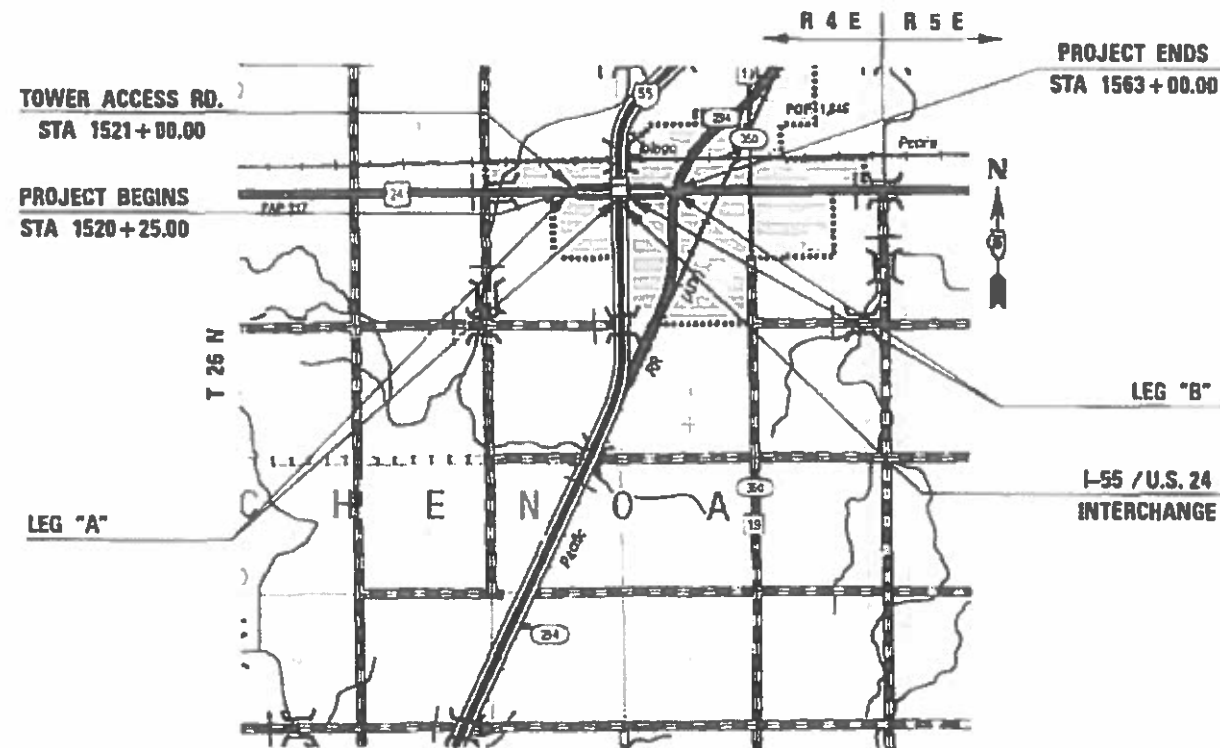

* FOR REFERENCE, USE CENTER OF TOWER ACCESS RD AS STA. 1521+00.00



GROSS LENGTH = 4,275.00 FT. = 0.810 MILE
NET LENGTH = 1,630.00 FT. = 0.309 MILE

STATE OF ILLINOIS
DEPARTMENT OF TRANSPORTATION

SUBMITTED 01/16/2020
Kenneth A. Amundson
REGIONAL ENGINEER

March 20, 2020
cc E.A. Etk
ENGINEER OF DESIGN AND ENVIRONMENT

March 20, 2020
Ormond, Jr.
DIRECTOR OF HIGHWAY PROJECT IMPLEMENTATION

PRINTED BY THE AUTHORITY
OF THE STATE OF ILLINOIS

INDEX OF SHEETS

SHEET NO.	DESCRIPTION
1	COVER SHEET
2	INDEX OF SHEETS / HIGHWAY STANDARDS / GENERAL NOTES
3	SUMMARY OF QUANTITIES
4 - 6	TYPICAL SECTIONS
7	SCHEDULE OF QUANTITIES
8	SIGN DETAIL FOR I-55 OFF RAMP

HIGHWAY STANDARDS

STANDARD NO.	DESCRIPTION
000001-07	STANDARD SYMBOLS, ABBREVIATIONS AND PATTERNS
001006	DECIMAL OF AN INCH AND OF A FOOT
701006-05	OFF-RD OPERATIONS, 2L, 2W, 15' (4.5 m) TO 24" (600 mm) FROM PAVEMENT EDGE
701101-05	OFF-RD OPERATIONS, MULTILANE, 15' (4.5 m) TO 24" (600 mm) FROM PAVEMENT EDGE
701301-04	LANE CLOSURE, 2L, 2W, SHORT TIME OPERATIONS
701306-04	LANE CLOSURE, 2L, 2W, SLOW MOVING OPERATION DAY ONLY, FOR SPEEDS ≥ 45 MPH
701601-09	URBAN LANE CLOSURE, MULTILANE, 1W OR 2W WITH NONTRAVERABLE MEDIAN
701701-10	URBAN LANE CLOSURE, MULTILANE INTERSECTION
701901-08	TRAFFIC CONTROL DEVICES

GENERAL NOTES

G.N.-100A
ELECTRONIC FILES AND/OR ELECTRONIC SURVEY INFORMATION INCLUDING CADD FILES WILL NOT BE AVAILABLE TO THE CONTRACTOR.

G.N.-105.07C
EXISTING STATE-OWNED AND MAINTAINED UNDERGROUND UTILITY FACILITIES EXIST WITHIN THE ROW. THE DEPARTMENT IS NOT A MEMBER OF JULIE AND DOES NOT LOCATE IT'S OWN FACILITIES. THE CONTRACTOR SHALL BE RESPONSIBLE AT THEIR OWN EXPENSE FOR SECURING AN APPROVED LOCATING FIRM TO LOCATE ALL EXISTING IDOT UNDERGROUND FACILITIES PRIOR TO COMMENCING ANY EXCAVATION, PER THE REQUIREMENTS OF ARTICLE 803 OF THE STANDARD SPECIFICATIONS. UTILITY LOCATES MAY ALSO BE REQUIRED OUTSIDE THE PROJECT LIMITS, SUCH AS FOR TRAFFIC CONTROL SIGNING AND OTHER ITEMS. THE CONTRACTOR MAY OBTAIN, ON REQUEST, PLANS OF EXISTING ELECTRICAL FACILITIES FROM THE DEPARTMENT. FOR FURTHER INFORMATION, THE CONTRACTOR MAY CONTACT THE DISTRICT TRAFFIC OPERATIONS ENGINEER, GARY SIMS, AT 217-251-4859.

G.N.-406
THE QUANTITIES INCLUDED IN THE PLANS FOR HOT-MIX ASPHALT RESURFACING ARE INTENDED TO GIVE THE COVERAGE SHOWN ON THE TYPICAL CROSS SECTIONS. IT IS NOT INTENDED TO INCREASE THE THICKNESS OF THE HOT-MIX ASPHALT MIXTURE IN ORDER TO USE ALL OF THE QUANTITIES INCLUDED IN THE CONTRACT.

G.N.-406H

MIXTURE REQUIREMENTS

THE FOLLOWING MIXTURE REQUIREMENTS ARE APPLICABLE FOR THIS PROJECT:

LOCATION(S):	U.S. 24
MIXTURE USE	POLYMER SURFACE
AC/PG	SBS PG 70-22
DESIGN AIR VOIDS	4.0% @ Ndes=70
MIX COMP (GRADATION)	IL 9.5
FRICTION AGGREGATE	Mix D
MIXTURE WEIGHT	112
QUALITY MANAGEMENT PROGRAM	QC/QA
SUBLOT SIZE	N.A.

NO COMMITMENTS.

**STATE OF ILLINOIS
DEPARTMENT OF TRANSPORTATION**

**INDEX OF SHEETS, HIGHWAY STANDARDS
& GENERAL NOTES**

USER NAME = hodgsonra	DESIGNED - JCH	REVISED -
	DRAWN - JCH	REVISED -
PLOT SCALE = 40,0000 ' / in.	CHECKED -	REVISED -
PLOT DATE = 1/15/2020	DATE - 11/25/2019	REVISED -

SCALE: N/A SHEET 1 OF 1 SHEETS STA. TO STA.

F.A.P. RTE.	SECTION	COUNTY	TOTAL SHEETS	SHEET NO.
317	D5 CM INLAY 2020-1	MCLEAN	8	2
CONTRACT NO. 70E31				
ILLINOIS FED. AID PROJECT				

SUMMARY OF QUANTITIES

LOCATION OF WORK:	F.A.P. 317 (U.S. 24)
	RURAL MULTILANE
	OTHER PRINCIPAL ARTERIAL
	STA. 1520+25.00 TO
	STA. 1563+00.00
	MCLEAN COUNTY
FUNDING BREAKOUT:	100% STATE
CONSTRUCTION TYPE CODE:	0005

CODE NO.	ITEM	UNIT	TOTAL QUANTITIES
40600290	BITUMINOUS MATERIALS (TACK COAT)	POUND	2,080.0
40604162	POLYMERIZED HOT-MIX ASPHALT SURFACE COURSE, IL-9.5, MIX "D", N70	TON	388.0
44000155	HOT-MIX ASPHALT SURFACE REMOVAL, 1 1/2"	SQ YD	4,619.0
67100100	MOBILIZATION	L SUM	1.0
70100460	TRAFFIC CONTROL AND PROTECTION, STANDARD 701306	L SUM	1.0
70102630	TRAFFIC CONTROL AND PROTECTION, STANDARD 701601	L SUM	1.0
70102635	TRAFFIC CONTROL AND PROTECTION, STANDARD 701701	L SUM	1.0
70300100	SHORT TERM PAVEMENT MARKING	FOOT	280.0
78300200	RAISED REFLECTIVE PAVEMENT MARKER REMOVAL	EACH	54.0

* DENOTES SPECIALTY ITEM

MODEL: \\MODEL\MP\ES
 FILE: \\MP\ES - Proj\G:\mcomata\dat\illinois\goc\RWIDOT\Documents\DOT - Offices\District 5\Projects\0570E31\CADDData\CAD\Sheet\0570E31 - 500.dgn

USER NAME = hodgsonra	DESIGNED - JCH	REVISED -
	DRAWN - JCH	REVISED -
PLOT SCALE = 40.0000 ' / in.	CHECKED -	REVISED -
PLOT DATE = 1/15/2020	DATE - 10/25/2019	REVISED -

**STATE OF ILLINOIS
DEPARTMENT OF TRANSPORTATION**

SUMMARY OF QUANTITIES

SCALE: N/A SHEET 1 OF 1 SHEETS STA. TO STA.

F.A.P. RTE.	SECTION	COUNTY	TOTAL SHEETS	SHEET NO.
317	D5 CM INLAY 2020-1	MCLEAN	8	3
CONTRACT NO. 70E31				
		ILLINOIS	FED. AID PROJECT	

EXISTING TYPICAL SECTION ①

F.A.P. 317 (U.S. 24)

NOTE: FOR INFORMATIONAL PURPOSES ONLY

STATION 1520+25.00 TO STATION 1526+09.45 ②

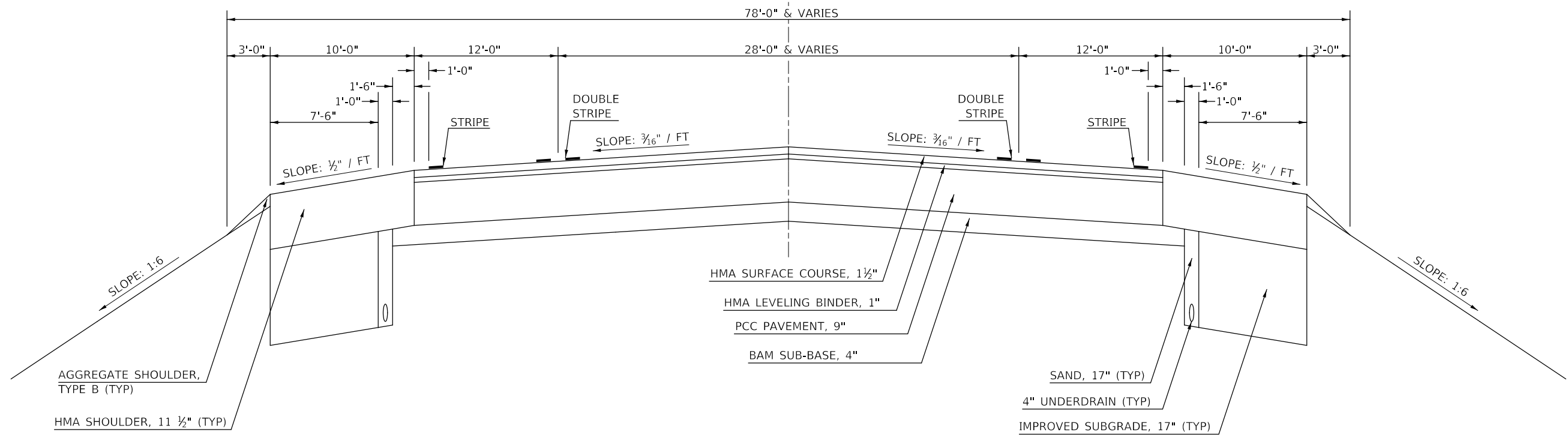

MODEL: \\MODEL\NAMES
FILE: \\models\pav\illinois\gov\pww\dot\Documents\DOT_Offices\District_5\Projects\0570E31\CAD\Drawings\CAD\Drawings\0570E31\c11c\typical.dgn

USER NAME = hodgsonra	DESIGNED - JCH	REVISED -
DRAWN - JCH	REVISIONS -	REVISIONS -
PLOT SCALE = 40.0000' / in.	CHECKED -	REVISIONS -
PLOT DATE = 1/15/2020	DATE - 11/18/2019	REVISIONS -

STATE OF ILLINOIS
DEPARTMENT OF TRANSPORTATION

TYPICAL SECTIONS	
SCALE: N/A	SHEET 1 OF 3 SHEETS
STA.	TO STA.

F.A.P. RTE.	SECTION	COUNTY	TOTAL SHEETS	SHEET NO.
317	D5 CM INLAY 2020-1	MCLEAN	8	4
CONTRACT NO. 70E31				
ILLINOIS FED. AID PROJECT				

EXISTING TYPICAL SECTION ②

F.A.P. 317 (U.S. 24)

STATION ① 1526+09.45 TO STATION ③ 1557+55.78

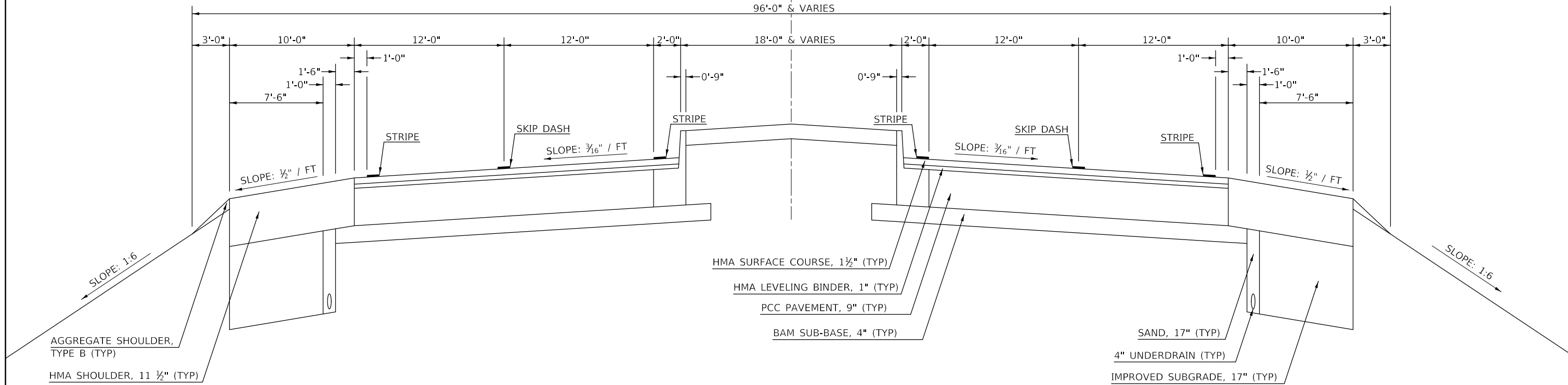

PROPOSED TYPICAL SECTION ②

F.A.P. 317 (U.S. 24)

STATION ① 1526+09.45 TO STATION ③ 1557+55.78

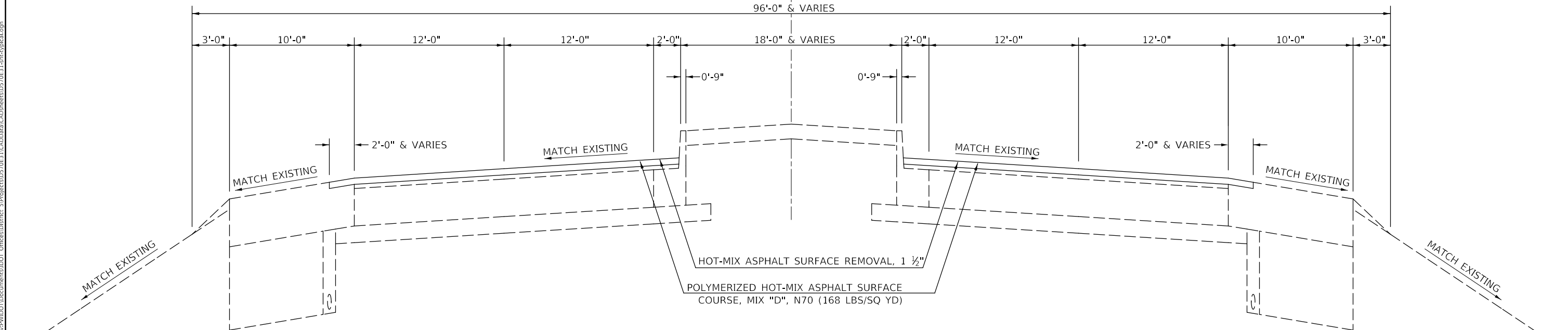

****SEE SCHEDULE FOR INLAY LOCATIONS****

MODEL: S:\MODEL\NAME: FILE: NAME: P:\pub\m\moma\data\illinois.gov\PIWDOT\Documents\DOT_Offices\District_5\Projects\0570E31\CADD\data\CAD\sheet\0570E31-rh-cp\typical.dgn

USER NAME = hodgsonra	DESIGNED - JCH	REVISED -
	DRAWN - JCH	REVISED -
PLOT SCALE = 40.0000 ' / in.	CHECKED -	REVISED -
PLOT DATE = 1/15/2020	DATE - 11/18/2019	REVISED -

**STATE OF ILLINOIS
DEPARTMENT OF TRANSPORTATION**

TYPICAL SECTIONS

SCALE: N/A SHEET 2 OF 3 SHEETS STA. TO STA.

F.A.P. RTE. 317	SECTION D5 CM INLAY 2020-1	COUNTY MCLEAN	TOTAL SHEETS 8	SHEET NO. 5
CONTRACT NO. 70E31				
ILLINOIS FED. AID PROJECT				

EXISTING TYPICAL SECTION ③

NOTE: FOR INFORMATIONAL PURPOSES ONLY

F.A.P. 317 (U.S. 24)

STATION ② 1557+55.78 TO STATION ④ 1560+57.61

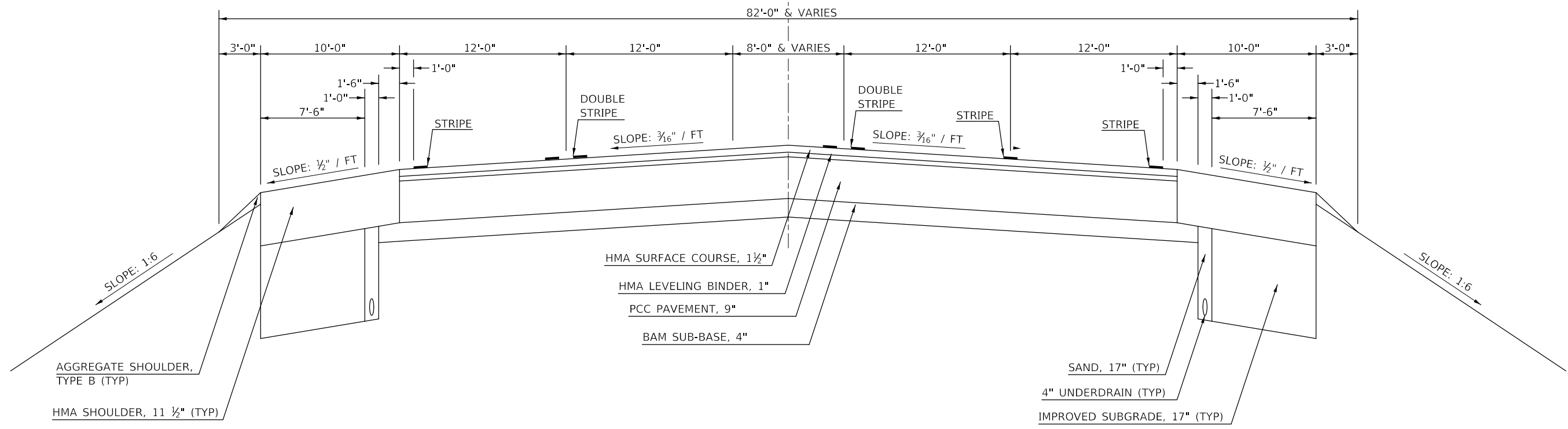

EXISTING TYPICAL SECTION ④

NOTE: FOR INFORMATIONAL PURPOSES ONLY

F.A.P. 317 (U.S. 24)

STATION ③ 1560+57.61 TO STATION 1563+00.00

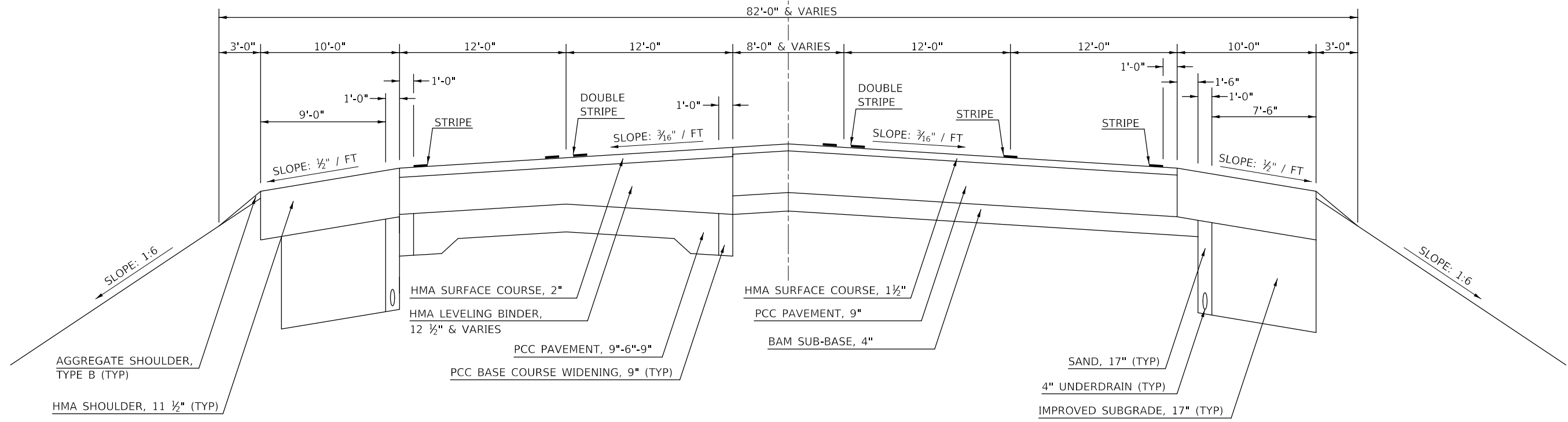

MODEL: \\MODEL\NAME: FILE: \\NAME: PROJECT: \\PROJECT\DATA\CADD\DATA\CADD\PROJECTS\70E31\CH\TYPICAL.dgn

USER NAME = hodgsonra	DESIGNED - JCH	REVISED -
DRAWN - JCH	REVISIONS -	
PLOT SCALE = 40.0000' / in.	CHECKED -	REVISED -
PLOT DATE = 1/15/2020	DATE - 11/18/2019	REVISED -

STATE OF ILLINOIS
DEPARTMENT OF TRANSPORTATION

TYPICAL SECTIONS

SCALE: N/A SHEET 3 OF 3 SHEETS STA. TO STA.

F.A.P. RTE.	SECTION	COUNTY	TOTAL SHEETS	SHEET NO.
317	D5 CM INLAY 2020-1	MCLEAN	8	6
CONTRACT NO. 70E31				
ILLINOIS FED. AID PROJECT				

SCHEDULE OF QUANTITIES

HOT-MIX ASPHALT

LOCATIONS	STATION	TO	STATION	LENGTH (FOOT)	WIDTH (FOOT)	AREA (SQ FT)	AVG. DEPTH (INCH)	RATE (LB/SQ FT)	BITUMINOUS MATERIALS (TACK COAT) 40600290 (POUND)	POLYMERIZED HOT-MIX ASPHALT SURFACE COURSE, IL-9.5, MIX "D", N70 40604162 (TON)	HOT-MIX ASPHALT SURFACE REMOVAL, 1 1/2" 44000155 (SQ YD)
F.A.P. 317 (U.S. 24)											
W.B.D.L.	1527+60.00	TO	1528+00.00	40.00	14.00	560.00	1.50	0.05	28.0	5.2	62.22
E.B.D.L.	1531+25.00	TO	1532+75.00	150.00	14.00	2,100.00	1.50	0.05	105.0	19.6	233.33
E.B.P.L.	1531+25.00	TO	1532+75.00	150.00	13.00	1,950.00	1.50	0.05	97.5	18.2	216.67
W.B.D.L.	1531+75.00	TO	1534+90.00	315.00	14.00	4,410.00	1.50	0.05	220.5	41.2	490.00
W.B.D.L.	1538+85.00	TO	1542+60.00	375.00	14.00	5,250.00	1.50	0.05	262.5	49.0	583.33
W.B.P.L.	1538+85.00	TO	1542+60.00	375.00	14.00	5,250.00	1.50	0.05	262.5	49.0	583.33
E.B.D.L.	1540+50.00	TO	1543+65.00	315.00	14.00	4,410.00	1.50	0.05	220.5	41.2	490.00
E.B.P.L.	1540+50.00	TO	1543+65.00	315.00	14.00	4,410.00	1.50	0.05	220.5	41.2	490.00
E.B.D.L.	1545+00.00	TO	1549+25.00	425.00	14.00	5,950.00	1.50	0.05	297.5	55.5	661.11
E.B.P.L.	1547+25.00	TO	1549+25.00	200.00	14.00	2,800.00	1.50	0.05	140.0	26.1	311.11
E.B.P.L.	1552+80.00	TO	1554+50.00	170.00	14.00	2,380.00	1.50	0.05	119.0	22.2	264.44
W.B.D.L.	1555+50.00	TO	1557+00.00	150.00	14.00	2,100.00	1.50	0.05	105.0	19.6	233.33
F.A.P. 317 (U.S. 24) TOTAL =									2,078.5	388.0	4,618.9
USE =									2,080.0	388.0	4,619.0

NOTE:

FIELD LAYOUT WILL BE COORDINATED WITH OPERATIONS SUPERVISOR, ROD LASHUAY, AT 217-251-4866 PRIOR TO CONSTRUCTION.

MISC. PAVEMENT ITEMS

LOCATIONS	STATION	TO	STATION	LENGTH (FOOT)	RAISED REFLECTIVE PAVEMENT MARKER REMOVAL 78300200 (EACH)	SHORT TERM PAVEMENT MARKING 70300100 (FOOT)	
						WHITE CENTERLINE	WHITE EDGE LINE
						F.A.P. 317 (U.S. 24)	
W.B.D.L.	1527+60.00	TO	1528+00.00	40.00	2.0	4.0	0.0
E.B.D.L.	1531+25.00	TO	1532+75.00	150.00	4.0	16.0	8.0
W.B.D.L.	1531+75.00	TO	1534+90.00	315.00	8.0	32.0	12.0
W.B.D.L.	1538+85.00	TO	1542+60.00	375.00	10.0	40.0	16.0
E.B.D.L.	1540+50.00	TO	1543+65.00	315.00	8.0	32.0	12.0
E.B.D.L.	1545+00.00	TO	1549+25.00	425.00	12.0	44.0	20.0
E.B.P.L.	1552+80.00	TO	1554+50.00	170.00	6.0	20.0	0.0
W.B.D.L.	1555+50.00	TO	1557+00.00	150.00	4.0	16.0	8.0
F.A.P. 317 (U.S. 24) SUB TOTAL =					54.0	204.0	76.0
F.A.P. 317 (U.S. 24) TOTAL =					54.0	280.0	

MODEL: I:\MODEL\NAMES
 FILE: N:\nmsc_pavementitems.dwg
 PROJECT: I:\Projects\0570E31\CADD\DATA\CAD\PROJECTS\0570E31\pht-schedule.dwg

USER NAME = hodgsonra	DESIGNED - JCH	REVISED -
	DRAWN - JCH	REVISED -
PLOT SCALE = 40.0000 ' / in.	CHECKED -	REVISED -
PLOT DATE = 1/15/2020	DATE - 11/25/2019	REVISED -

**STATE OF ILLINOIS
DEPARTMENT OF TRANSPORTATION**

SCHEDULE OF QUANTITIES

SCALE: N/A SHEET 1 OF 1 SHEETS STA. TO STA.

F.A.P. RTE.	SECTION	COUNTY	TOTAL SHEETS	SHEET NO.
317	D5 CM INLAY 2020-1	MCLEAN	8	7
CONTRACT NO. 70E31				
ILLINOIS FED. AID PROJECT				

I-55 OFF RAMPS

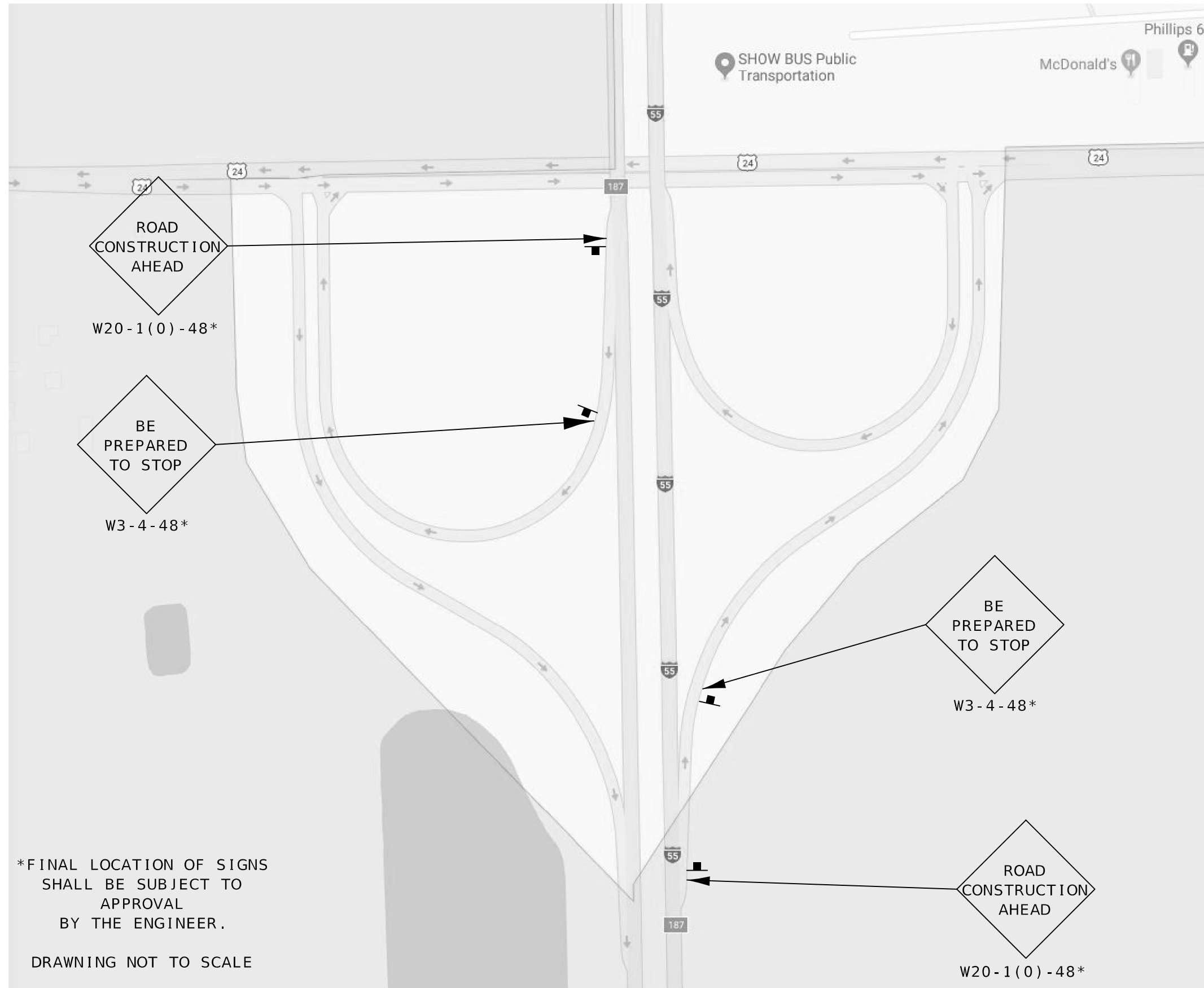

*FINAL LOCATION OF SIGNS SHALL BE SUBJECT TO APPROVAL BY THE ENGINEER.

DRAWING NOT TO SCALE

MODEL: \\MODEL\NAMES
FILE: \\models\p10\p10m\com\data\illinois\p10\p10\DOT\Documents\DOT_Offices\District 5\Projects\I5570E31\CADD\data\CAD\Sheet\I5570E31-Off-ramp-plans.dgn

USER NAME = hodgsonra	DESIGNED - JCH	REVISED -
	DRAWN - JCH	REVISED -
PLOT SCALE = 40,0000 ' / in.	CHECKED -	REVISED -
PLOT DATE = 1/15/2020	DATE - 11/26/2019	REVISED -

STATE OF ILLINOIS
DEPARTMENT OF TRANSPORTATION

SIGN DETAIL FOR
I-55 OFF RAMPS

SCALE: N/A SHEET 1 OF 1 SHEETS STA. TO STA.

F.A.P. RTE.	SECTION	COUNTY	TOTAL SHEETS	SHEET NO.
317	D5 CM INLAY 2020-1	MCLEAN	8	8
CONTRACT NO. 70E31				
ILLINOIS FED. AID PROJECT				