

\\VLT00R46.DGN, \\EXH0019.DGN, \\S000001.DGN, \\S000002.DGN, \\S000003.DGN, \\S000004.DGN, \\S000005.DGN, \\S000006.DGN, \\S000007.DGN, \\S000008.DGN, \\S000009.DGN, \\S000010.DGN, \\S000011.DGN, \\S000012.DGN, \\S000013.DGN, \\S000014.DGN, \\S000015.DGN, \\S000016.DGN, \\S000017.DGN, \\S000018.DGN, \\S000019.DGN, \\S000020.DGN, \\S000021.DGN, \\S000022.DGN, \\S000023.DGN, \\S000024.DGN, \\S000025.DGN, \\S000026.DGN, \\S000027.DGN, \\S000028.DGN, \\S000029.DGN, \\S000030.DGN, \\S000031.DGN, \\S000032.DGN, \\S000033.DGN, \\S000034.DGN, \\S000035.DGN, \\S000036.DGN, \\S000037.DGN, \\S000038.DGN, \\S000039.DGN, \\S000040.DGN, \\S000041.DGN, \\S000042.DGN, \\S000043.DGN, \\S000044.DGN, \\S000045.DGN, \\S000046.DGN, \\S000047.DGN, \\S000048.DGN, \\S000049.DGN, \\S000050.DGN, \\S000051.DGN, \\S000052.DGN, \\S000053.DGN, \\S000054.DGN, \\S000055.DGN, \\S000056.DGN, \\S000057.DGN, \\S000058.DGN, \\S000059.DGN, \\S000060.DGN, \\S000061.DGN, \\S000062.DGN, \\S000063.DGN, \\S000064.DGN, \\S000065.DGN, \\S000066.DGN, \\S000067.DGN, \\S000068.DGN, \\S000069.DGN, \\S000070.DGN, \\S000071.DGN, \\S000072.DGN, \\S000073.DGN, \\S000074.DGN, \\S000075.DGN, \\S000076.DGN, \\S000077.DGN, \\S000078.DGN, \\S000079.DGN, \\S000080.DGN, \\S000081.DGN, \\S000082.DGN, \\S000083.DGN, \\S000084.DGN, \\S000085.DGN, \\S000086.DGN, \\S000087.DGN, \\S000088.DGN, \\S000089.DGN, \\S000090.DGN, \\S000091.DGN, \\S000092.DGN, \\S000093.DGN, \\S000094.DGN, \\S000095.DGN, \\S000096.DGN, \\S000097.DGN, \\S000098.DGN, \\S000099.DGN, \\S000100.DGN, \\S000101.DGN, \\S000102.DGN, \\S000103.DGN, \\S000104.DGN, \\S000105.DGN, \\S000106.DGN, \\S000107.DGN, \\S000108.DGN, \\S000109.DGN, \\S000110.DGN, \\S000111.DGN, \\S000112.DGN, \\S000113.DGN, \\S000114.DGN, \\S000115.DGN, \\S000116.DGN, \\S000117.DGN, \\S000118.DGN, \\S000119.DGN, \\S000120.DGN

F.A.I. RTE.	SECTION	COUNTY	TOTAL SHEETS	SHEET NO.
55		WILL	608	120
STA.	TO STA.			
FED. ROAD DIST. NO. 1	ILLINOIS	FED. AID PROJECT		
• (26, 26HB-1&114) R-2 CONTRACT NO. 60363				

NOTES:
1. ANY CONFLICTING PAVEMENT MARKING SHALL BE REMOVED.

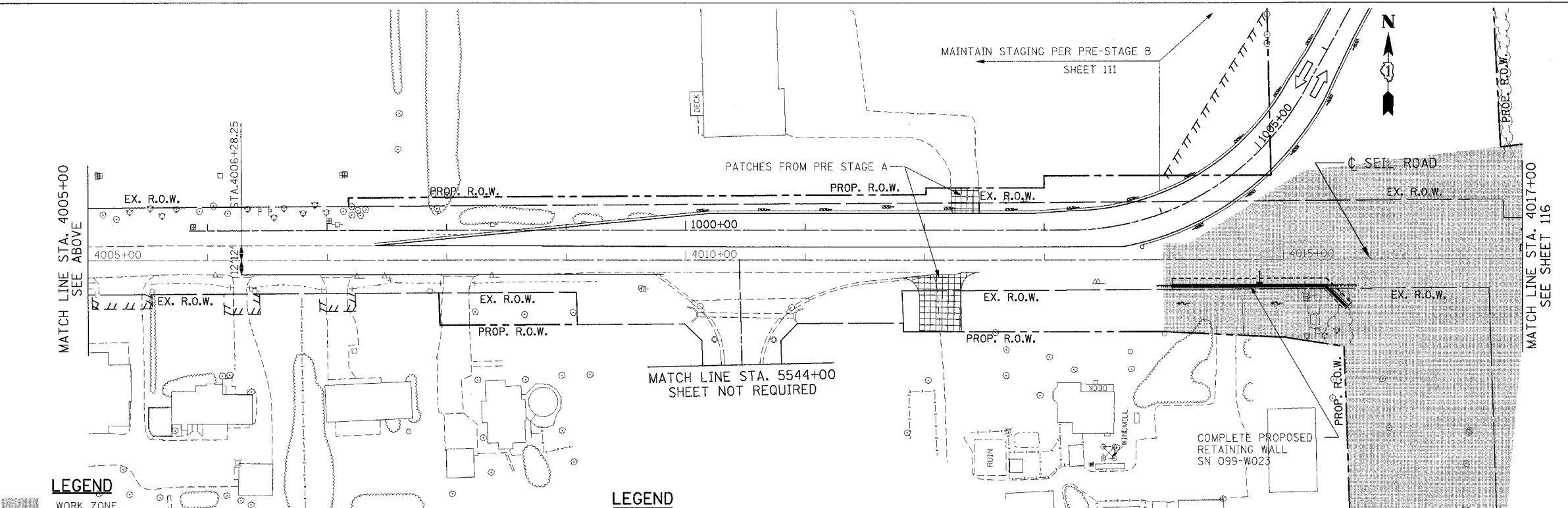

LEGEND

[Symbol]	WORK ZONE
[Symbol]	TEMPORARY PAVEMENT
[Symbol]	TEMP. PVMT - PREVIOUS STAGE
[Symbol]	CLASS D PATCHES (TYPE AND THICKNESS SPECIFIED AT EACH PATCH LOCATION)
[Symbol]	PAVEMENT REMOVAL
[Symbol]	PAVED SHOULDER REMOVAL (INCL. GORES)
[Symbol]	TRAFFIC FLOW
[Symbol]	ARROW BOARD
[Symbol]	VERTICAL PANELS
[Symbol]	BARRICADE, TYPE III
[Symbol]	PROP. TRAFFIC SIGN BARRICADES, TYPE II W/ FLASHING LIGHTS
[Symbol]	PLASTIC TYPE II BARRICADES OR DRUMS W/ STEADY BURN LIGHT
[Symbol]	TEMPORARY CONCRETE BARRIER

LEGEND

① EPOXY PAVEMENT MARKING - LINE 4" (WHITE)	⑤ TEMPORARY PAVEMENT MARKING - 8" (WHITE)	⑨ PAVEMENT MARKING TAPE, TYPE III - LETTERS AND SYMBOLS	⑬ PAVEMENT MARKING TAPE, TYPE III - 8" (WHITE)
② TEMPORARY PAVEMENT MARKING - 4" (WHITE)	⑥ TEMPORARY PAVEMENT MARKING - 12" (WHITE)	⑩ PAVEMENT MARKING TAPE, TYPE III - 4" (WHITE)	⑭ PAVEMENT MARKING TAPE, TYPE III - 12" (WHITE)
③ TEMPORARY PAVEMENT MARKING - 4" (YELLOW)	⑦ EPOXY PAVEMENT MARKING - LINE 5" (WHITE) 10' DASH-30' SKIP	⑪ PAVEMENT MARKING TAPE, TYPE III - 4" (YELLOW)	⑮ PAVEMENT MARKING TAPE, TYPE III - 12" (YELLOW)
④ EPOXY PAVEMENT MARKING - LINE 4" (YELLOW)	⑧ TEMPORARY PAVEMENT MARKING - 24" (WHITE)	⑫ PAVEMENT MARKING TAPE, TYPE III - 6" (WHITE)	⑯ PAVEMENT MARKING TAPE, TYPE III - 24" (WHITE)
⑩A PAVEMENT MARKING TAPE, TYPE III - 4" (YELLOW), 10' DASH-30' SKIP		⑬ PAVEMENT MARKING TAPE, TYPE III - 5" (WHITE), 10' DASH-30' SKIP	

MOT33

REVISIONS	
NAME	DATE

ILLINOIS DEPARTMENT OF TRANSPORTATION
FAI 55 AT FAP 338 ILLINOIS ROUTE 59
SECTION: (26, 26HB-1&114) R-2
**MAINTENANCE OF TRAFFIC
STAGE 1**
STA. 4002+18 TO STA. 4017+00
SCALE: 1" = 50'
DATE: 03/14/08
DRAWN BY: JB
CHECKED BY: ACL

TENG
TENG & ASSOCIATES, INC.
ENGINEERS/ARCHITECTS/PLANNERS
505 N. MICHIGAN AVE. CHICAGO, IL 60610
TELEPHONE 312/666-8200