

TIES IN SECTIONS 21, 22, & 27 TOWNSHIP 35 NORTH, RANGE 9 EAST OF THE THIRD PRINCIPAL MERIDIAN, WILL COUNTY, ILLINOIS.

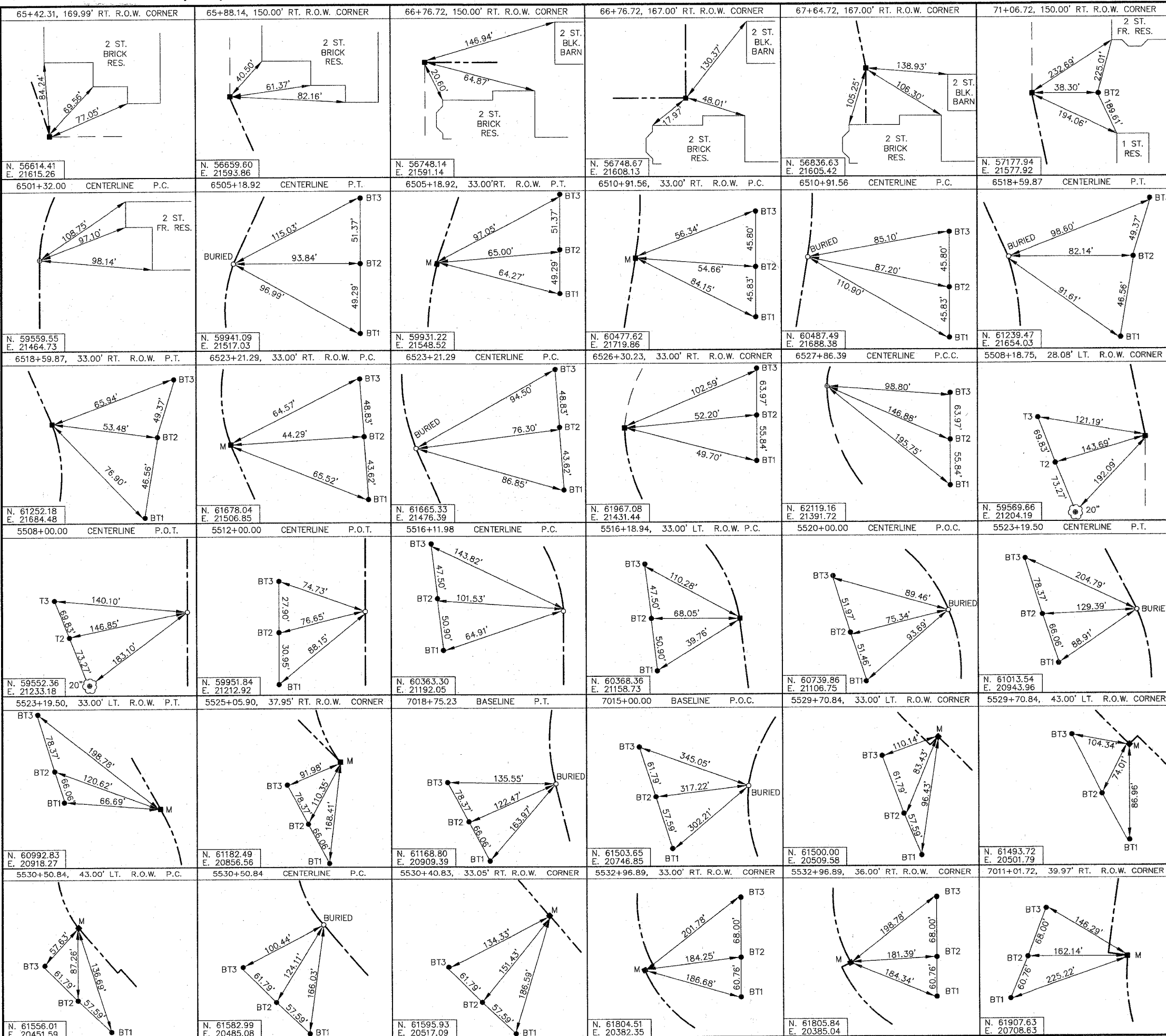

LEGEND

- SECTION CORNER
- QUARTER SECTION CORNER
- SECTION LINE
- QUARTER SECTION LINE
- QUARTER, QUARTER SECTION LINE
- PLATTED LOT LINE
- PROPERTY (DEED) LINE
- APL
- APPARENT PROPERTY LINE
- CENTERLINE
- EXISTING RIGHT OF WAY LINE
- EXISTING EASEMENT
- PROPOSED RIGHT OF WAY LINE
- PROPOSED EASEMENT
- MEASURED DIMENSION
- COMPUTED DIMENSION
- RECORD DATA
- ENGLISH EQUIVALENT
- EXISTING BUILDINGS
- IRON PIPE OR ROD FOUND
- CUT CROSS FOUND OR SET
- T1 THESE STAKES REFERENCE FOUND OR SET MONUMENTATION. SET 5/8" INCH IRON ROD FLUSH WITH THE GROUND TO THE MONUMENTATION. IDENTIFIED BY COLORED PLASTIC CAP BEARING SURVEYORS REGISTRATION NUMBER.
- T2 THESE STAKES, IN CULTIVATED AREAS, REFERENCE FOUND OR SET MONUMENTATION. BURIED 5/8" INCH ROD 20 INCHES BELOW GROUND TO THE MONUMENTATION. IDENTIFIED BY COLORED PLASTIC CAP BEARING SURVEYORS REGISTRATION NUMBER.
- T3 THESE STAKES, IN CULTIVATED AREAS, REFERENCE FOUND OR SET MONUMENTATION. BURIED 5/8" INCH ROD 20 INCHES BELOW GROUND TO THE MONUMENTATION. IDENTIFIED BY COLORED PLASTIC CAP BEARING SURVEYORS REGISTRATION NUMBER.
- M STAKING OF PROPOSED RIGHT OF WAY. SET DIVISION OF HIGHWAYS SURVEY MARKER TO MONUMENT THE POSITION SHOWN. IDENTIFIED BY INSCRIPTION DATA AND SURVEYORS REGISTRATION NUMBER.
- M STAKING OF PROPOSED RIGHT OF WAY IN CULTIVATED AREAS. BURIED 5/8" INCH IRON ROD 20 INCHES BELOW GROUND TO MARK FUTURE SURVEY MARKER POSITION. IDENTIFIED BY COLORED PLASTIC CAP BEARING SURVEYORS REGISTRATION NUMBER.
- PERMANENT SURVEY MARKER, IDOT STD. 2135 (TO BE SET BY OTHERS)
- RIGHT OF WAY STAKING PROPOSED TO BE SET

STATE OF ILLINOIS }
COUNTY OF KANE }

THIS IS TO CERTIFY THAT I, REJENA H. LYON, AN ILLINOIS PROFESSIONAL LAND SURVEYOR, HAVE SURVEYED THE PLAT OF HIGHWAYS SHOWN HEREON IN SECTIONS 21, 22, & 27, TOWNSHIP 35 NORTH, RANGE 9 EAST OF THE THIRD PRINCIPAL MERIDIAN, WILL COUNTY; THAT THE SURVEY IS TRUE AND COMPLETE AS SHOWN TO THE BEST OF MY KNOWLEDGE AND BELIEF; THAT THE PLAT CORRECTLY REPRESENTS SAID SURVEY; THAT ALL MONUMENTS FOUND AND ESTABLISHED ARE OF PERMANENT QUALITY AND OCCUPY THE POSITIONS SHOWN HEREON AND THAT THE MONUMENTS ARE SUFFICIENT TO ENABLE THE SURVEY TO BE RETRACED. MADE FOR THE DEPARTMENT OF TRANSPORTATION, STATE OF ILLINOIS.

DATED AT ELGIN, ILLINOIS, THIS 5th DAY OF January, 2007 A.D.

Rejena H. Lyon
ILLINOIS PROFESSIONAL LAND SURVEYOR NO. 3302

PREPARED BY:
HAMPTON, LENZINI, AND RENWICK INC.
380 SHEPARD DRIVE
ELGIN, ILLINOIS 60123-7010
ACCOUNT NO. 2-12-0005(a)

LICENSE EXPIRES 11/30/2008

PLAT OF HIGHWAYS
STATE OF ILLINOIS
DEPARTMENT OF TRANSPORTATION
F.A.I. 55 (I 55)

WILL COUNTY SECTION 26 HB-1BR
PROJECT JOB NO. R-91-032-01
STATION 65+00 TO STATION 120+00
SCALE: NONE SHEET 14 OF 22

BUREAU OF LAND ACQUISITION
201 WEST CENTER COURT
SCHAUMBURG, ILLINOIS 60196