

CONTRACT NO.				
F.A. RTE.	SECTION	COUNTY	TOTAL SHEETS	SHEET NO.
2943	1999-162 RS	COOK	48	31
STA.	TO STA.			
FED. ROAD DIST. NO.	ILLINOIS	FED. AID PROJECT		

CONTRACT NO. 60829

PROJECT ENDS  
STATION 66+46.5

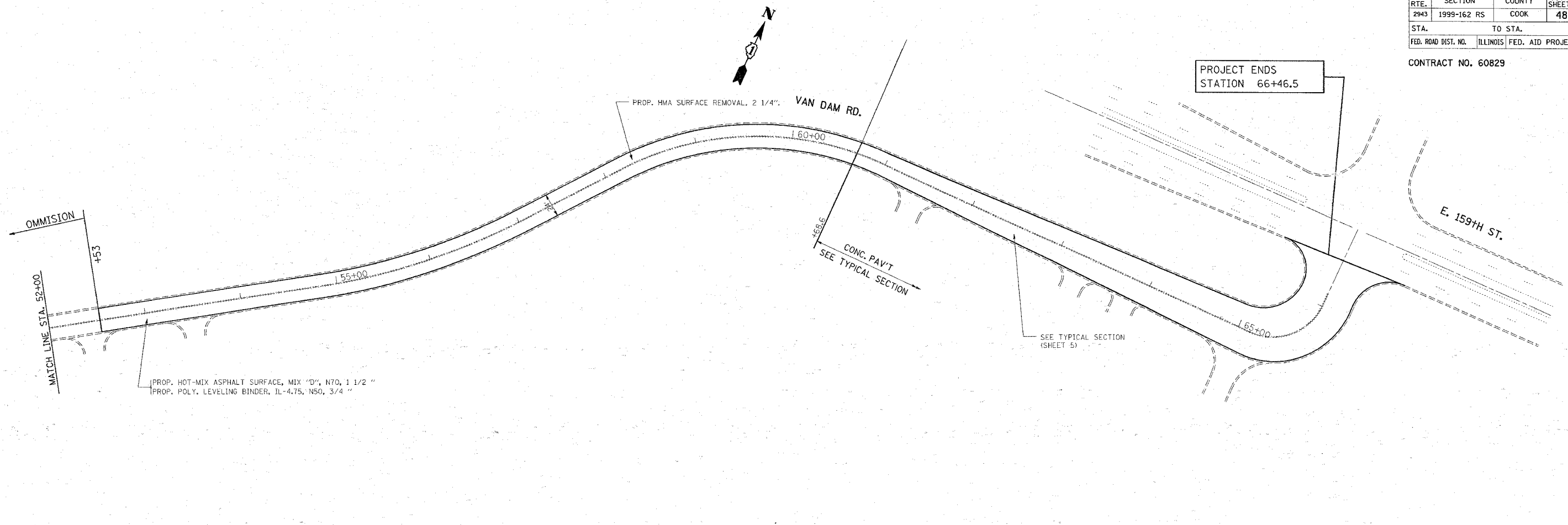

PLOT DATE = 4/14/2008  
 FILE NAME = c:\projects\vol\175\175\plan.dwg  
 USER NAME = ababara

REVISIONS	
NAME	DATE

ILLINOIS DEPARTMENT OF TRANSPORTATION

**ROADWAY PLANS**

**VOLBRECHT/175TH ST. FRONTAGE RD.**

SCALE: VERT. \_\_\_\_\_  
 HORIZ. \_\_\_\_\_

DATE \_\_\_\_\_

DRAWN BY \_\_\_\_\_  
 CHECKED BY \_\_\_\_\_