

F.A.I. RTE.	SECTION	COUNTY	TOTAL SHEETS	SHEET NO.
90/94	2005-066 LS	COOK	77	51
STA. 4393+50		TO STA. 4398+25		
FED. ROAD DIST. NO. 1		ILLINOIS FED. AID PROJECT		

60A72

(76) VIRGINIA CREEPER (2' OC - ALONG BASE OF RETAINING WALL)  
 INTERPLANTED WITH (7) YELLOW TRUMPET VINE (20' OC - ALONG  
 BASE OF RETAINING WALL/MULCH BED)  
 (150) HAPPY RETURNS DAYLILY  
 (12' OC - IN FRONT OF VINES/MULCH BED)

(135) MISS KIM MANCHURIAN LILAC  
 (3' OC - STAGGERED/MULCH BED)

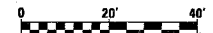
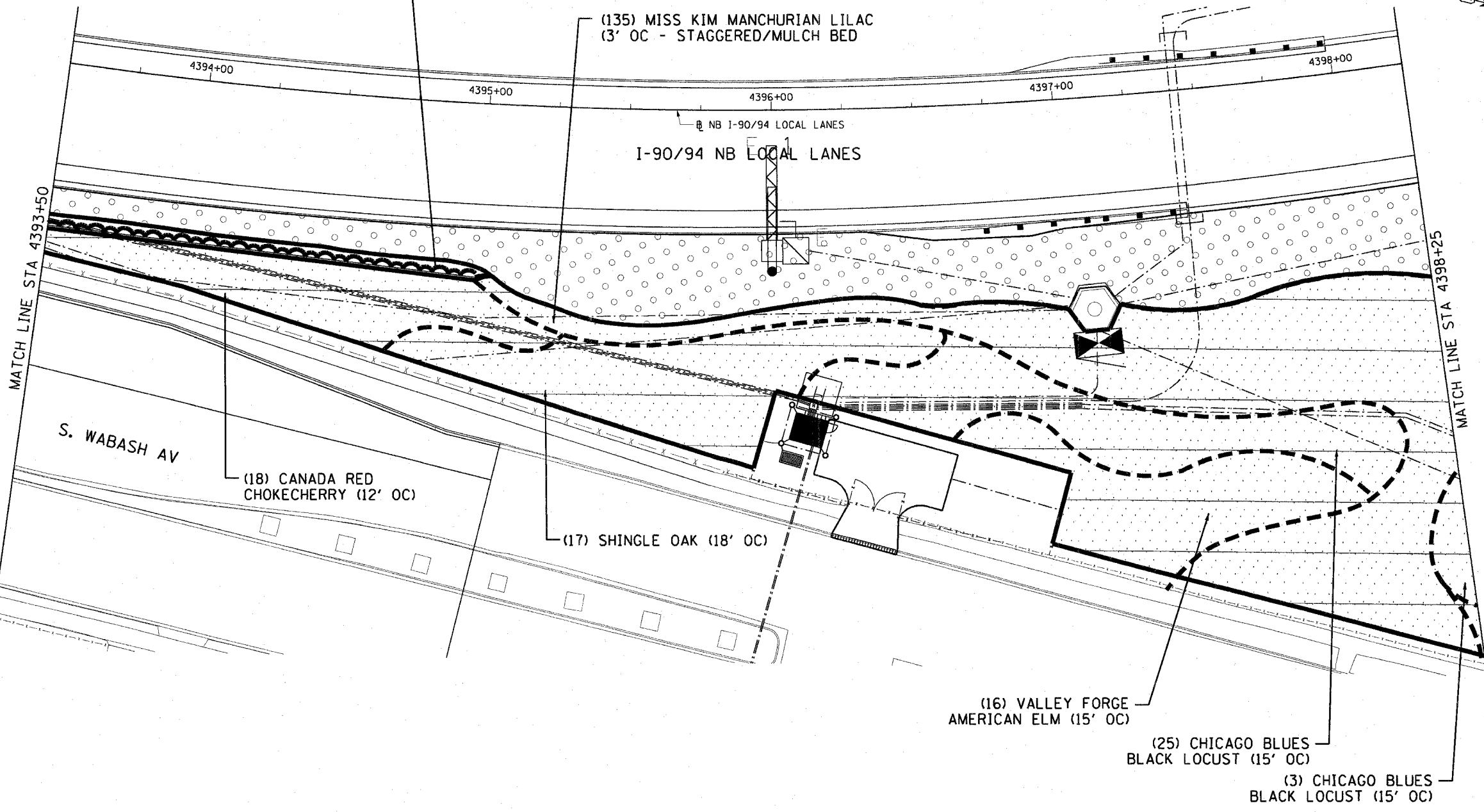

SHT-42 of 67

REVISIONS	
NAME	DATE

ILLINOIS DEPARTMENT OF TRANSPORTATION  
 F.A.I. 90/94 (DAN RYAN EXPRESSWAY)  
 NB ROADSIDE EMBANKMENT LANDSCAPE

**PROPOSED IMPROVEMENT**  
**I-57 INTERCHANGE TO 31ST STREET**

SCALE: 1"=20'  
 DATE: JUNE 2008

DRAWN BY: LAM  
 CHECKED BY: RMG

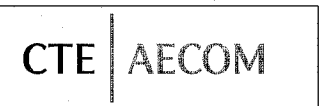

P:\10460\civil\10-roadside-embankment\sh42.dwg 6/19/2008 6:57:18 PM