

F.A.I.	SECTION	COUNTY	TOTAL SHEETS	SHEET NO.
94/90	2005-086 I	COOK	228	17
STA.		TO STA.		
FED. ROAD DIST. NO.	ILLINOIS	FED. AID PROJECT		
60B07				

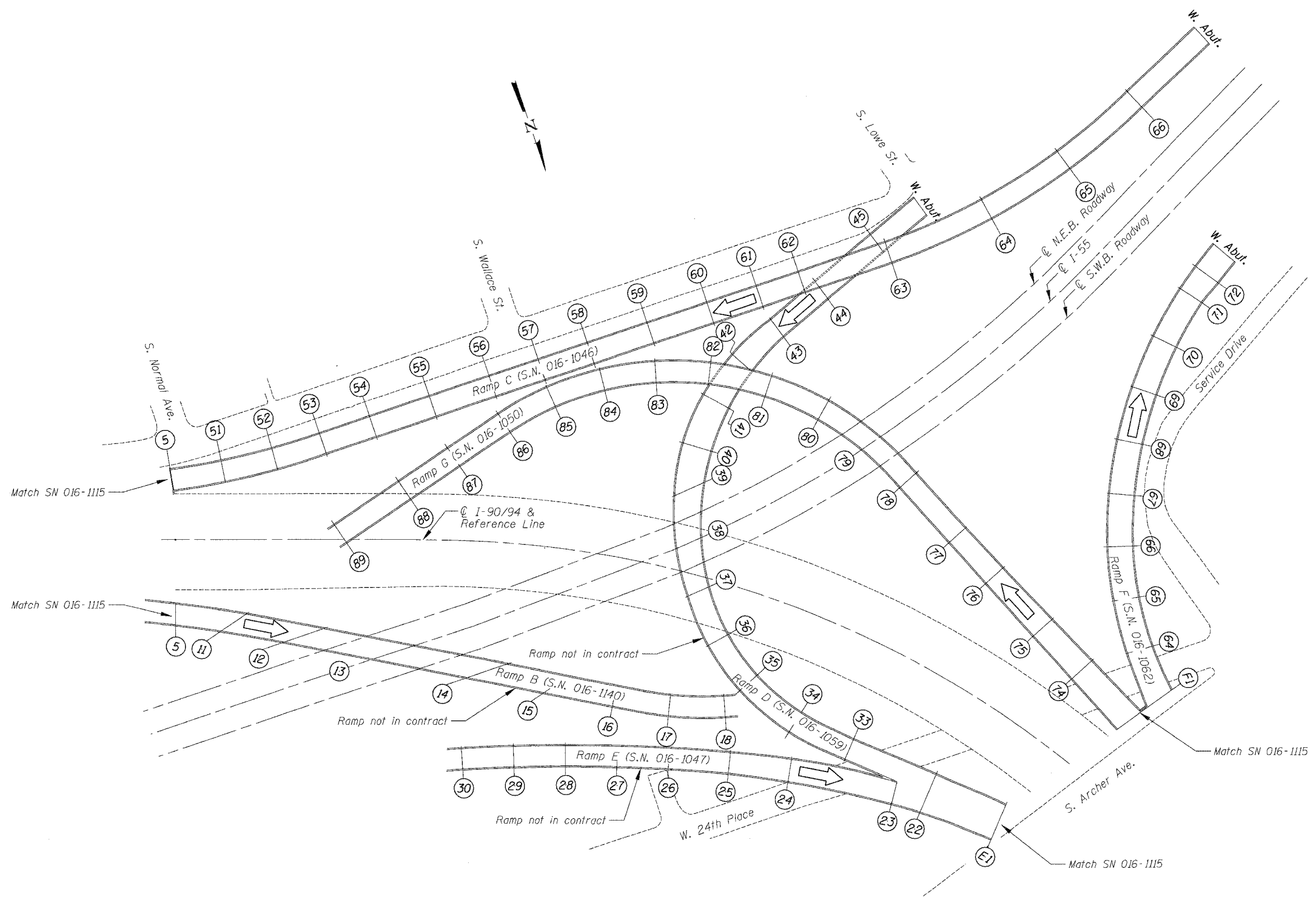

BOWMAN, BARRETT & ASSOCIATES INC.
 CONSULTING ENGINEERS
 Chicago, Illinois
 312.228.0100
 www.bbainc.com

Note:
 This sheet created from original 1988-89 reconstruction as-builts. These are provided for general reference to structure number, span lengths, etc. Work Items for this contract are identified on the partial framing plans and detail sheets that follow.

REVISIONS		ILLINOIS DEPARTMENT OF TRANSPORTATION F.A.I. 94/90 (DAN RYAN EXPRESSWAY) DAN RYAN ELEVATED BRIDGE BEARING REPLACEMENT & STEEL REPAIR GENERAL PLAN SN 016-1046, SN 016-1050, SN 016-1062, SN 016-1059, SN 016-1140, SN 016-1047 SCALE: NTS DATE: 5/18/2007
NAME	DATE	
		DRAWN BY: LAM CHECKED BY: BLU

5/24/2007 5:13:47 PM
 W:\60B07\BRIDGE\21A\SHEETS\60B_21A_016-1115-016-1140.dwg