

F.A.I.	SECTION	COUNTY	TOTAL SHEETS	SHEET NO.
94/90	2005-086 I	COOK	228	27
STA.	TO STA.			
FED. ROAD DIST. NO.	ILLINOIS	FED. AID PROJECT	60B07	

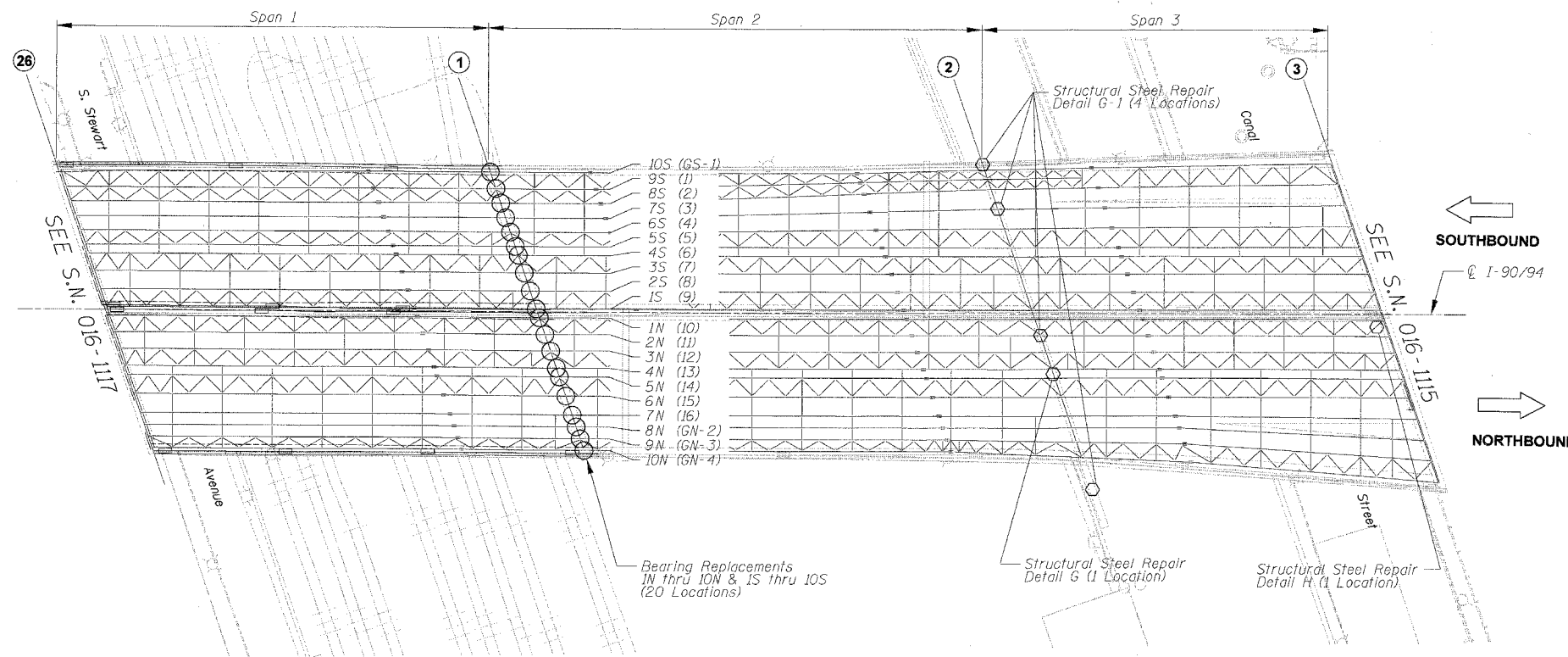

S.N. 016-1116 FRAMING PLAN

ELEMENT IDENTIFICATION

Elements on the Southbound Structure are identified 1S, 2S, 3S etc. starting from the centerline of I-90/94.

Elements on the Northbound Structure are identified 1N, 2N, 3N etc. starting from the centerline of I-90/94.

Numbers within () refer to as-built beam designations.

① = Pier No.

○ = Location of bearing replacement

◡ = Location of Structural Steel Repair

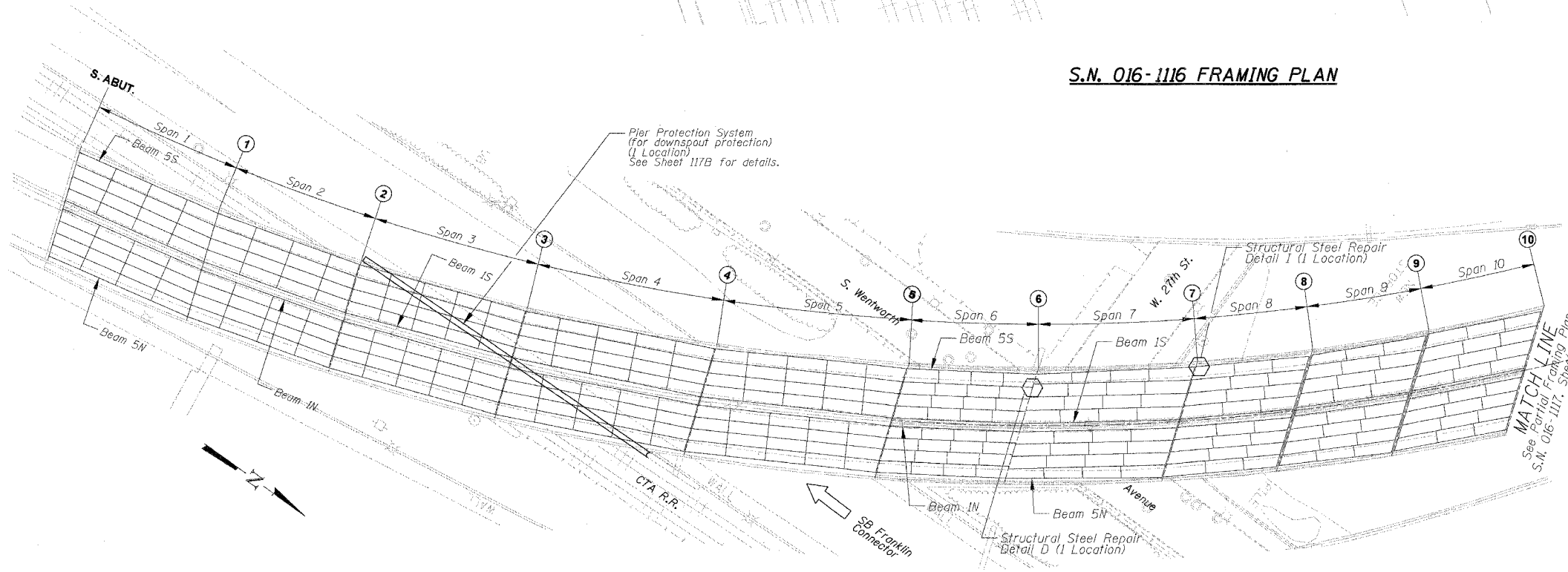

S.N. 016-1117 PARTIAL FRAMING PLAN

REVISIONS	NAME	DATE

ILLINOIS DEPARTMENT OF TRANSPORTATION
 F.A.I. 94/90 (DAN RYAN EXPRESSWAY)
 DAN RYAN ELEVATED BRIDGE
 BEARING REPLACEMENT & STEEL REPAIR
 PARTIAL FRAMING PLAN
 S.N. 016-1116 & 016-1117
 SCALE: NTS
 DATE: 3/7/2008
 DRAWN BY: LAM
 CHECKED BY: BLU

BOWMAN, BARRETT & ASSOCIATES INC.
 CONSULTING ENGINEERS
 Chicago, Illinois
 312.228.0100
 www.bbainc.com

I:\9400\9400\BRIDGE\2\ASHEETS\660_2\A_016-1116-FRAME.PIC
 3/21/2008 8:48 AM