

F.A.I.	SECTION	COUNTY	TOTAL SHEETS	SHEET NO.
94/90	2005-086 I	COOK	228	106
STA.	TO STA.			
FED. ROAD DIST. NO.	ILLINOIS	FED. AID PROJECT		

60B07

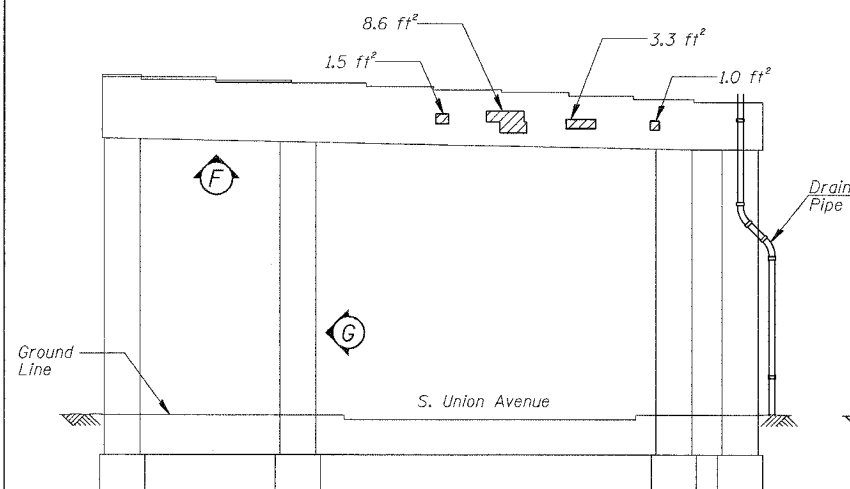

PIER C-5 - SOUTH ELEVATION
(Looking North)

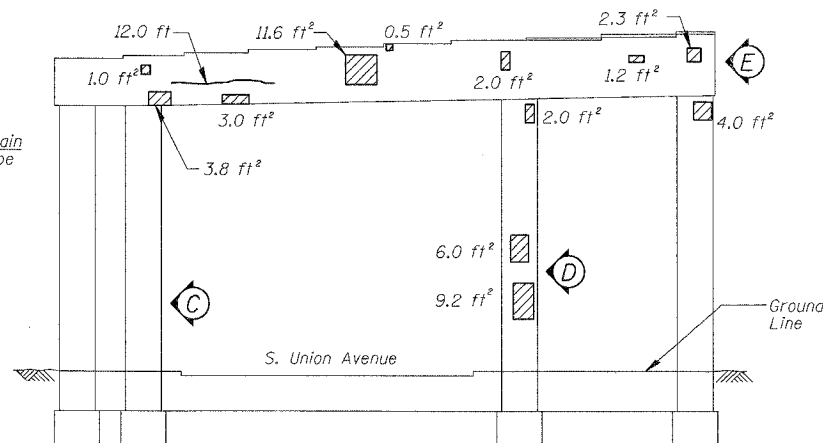

PIER C-5 - NORTH ELEVATION
(Looking South)

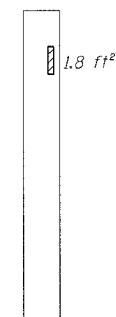

PIER C-5 - VIEW C
Looking East at side of column



PIER C-5 - VIEW D
Looking East at side of column



PIER C-5 - VIEW G
Looking West at side of column

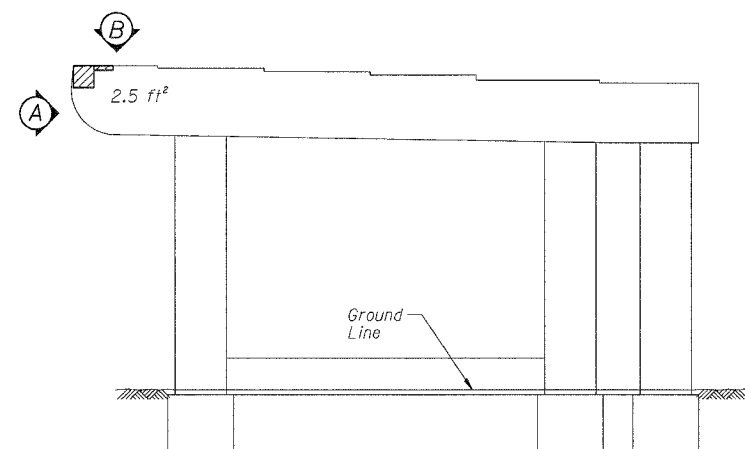

PIER C-11 - SOUTH ELEVATION
(Looking North)



PIER C-5 - VIEW E
Looking East at end of cap

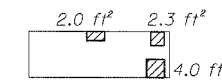

PIER C-5 - VIEW F
Looking up at bottom of cap

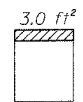

PIER C-11 - VIEW A
Looking East at end of cap

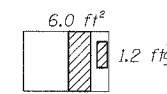

PIER C-11 - VIEW B
Looking down at top of seat

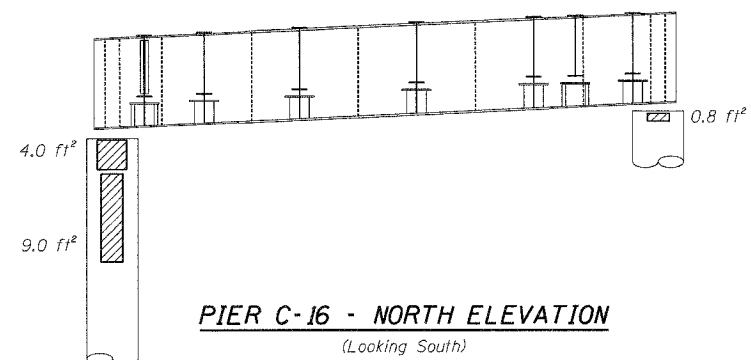

PIER C-16 - NORTH ELEVATION
(Looking South)

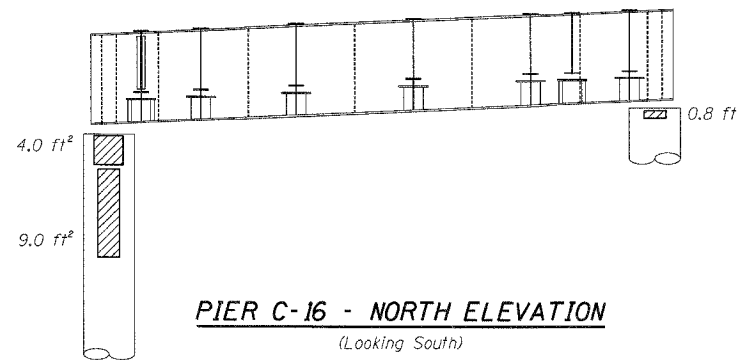

PIER C-16 - NORTH ELEVATION
(Looking South)

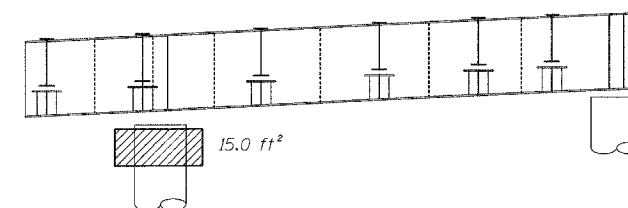

PIER C-18 - NORTH ELEVATION
(Looking South)

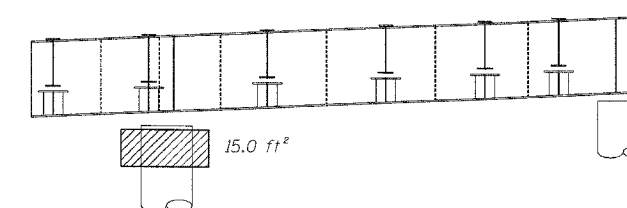

PIER C-18 - NORTH ELEVATION
(Looking South)

BILL OF MATERIAL

ITEM	UNIT	QUANTITY
Structural Repair of Concrete (Depth equal to or less than 5")	SQ. FT.	160.6
Epoxy Crack Injection	FOOT	12.0

REVISIONS	
NAME	DATE

ILLINOIS DEPARTMENT OF TRANSPORTATION
F.A.I. 94/90 (DAN RYAN EXPRESSWAY)
DAN RYAN ELEVATED BRIDGE
BEARING REPLACEMENT & STEEL REPAIR
CONCRETE PIER REPAIRS
SN 016-1046, PIERS C-5,C-11,C-16,C-18
SCALE: NTS
DATE: 5/18/2007

DRAWN BY: LAM
CHECKED BY: BLU

BOWMAN, BARRETT & ASSOCIATES INC.
CONSULTING ENGINEERS
Chicago, Illinois
312.228.0100
www.bbainc.com

For Notes and Legend See Sheet 6

5/24/2007 5:00:25 PM