

QUANTITY
 4 (100) LINE = 64.1 ft. (19.7 m)
 21.1 sq. ft. (1.97 sq. m)

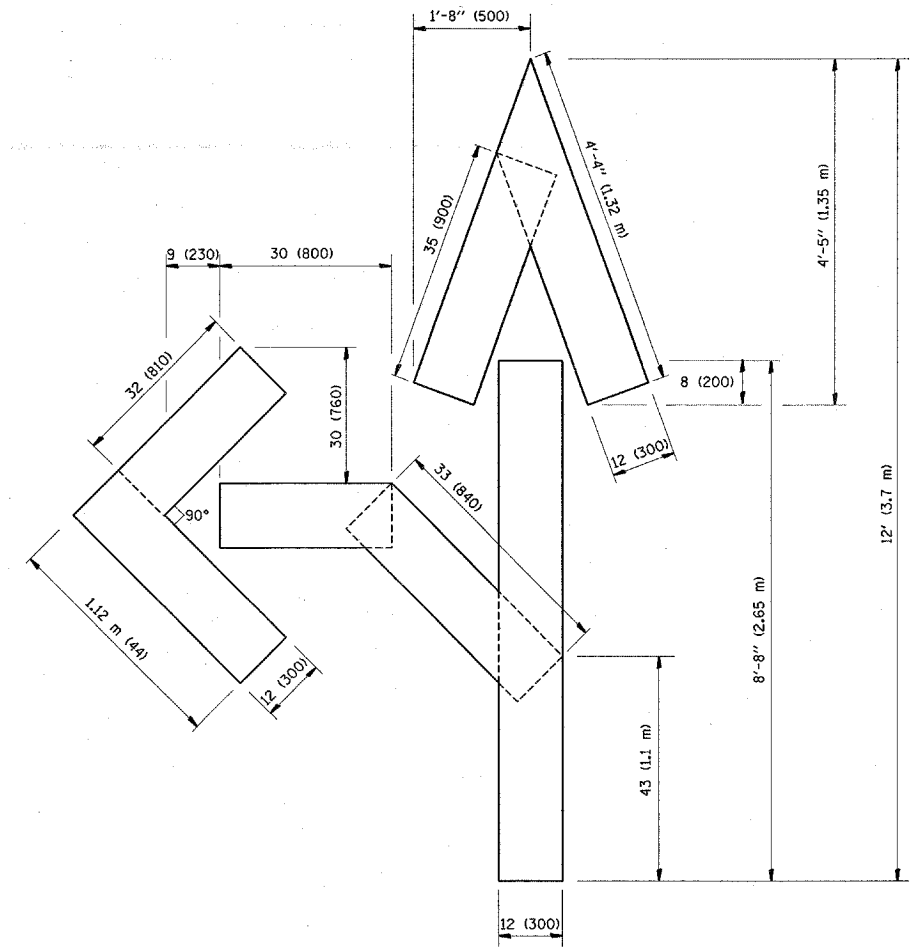

QUANTITY
 4 (100) LINE = 82.5 ft. (25.3 m)
 27.5 sq. ft. (2.53 sq. m)

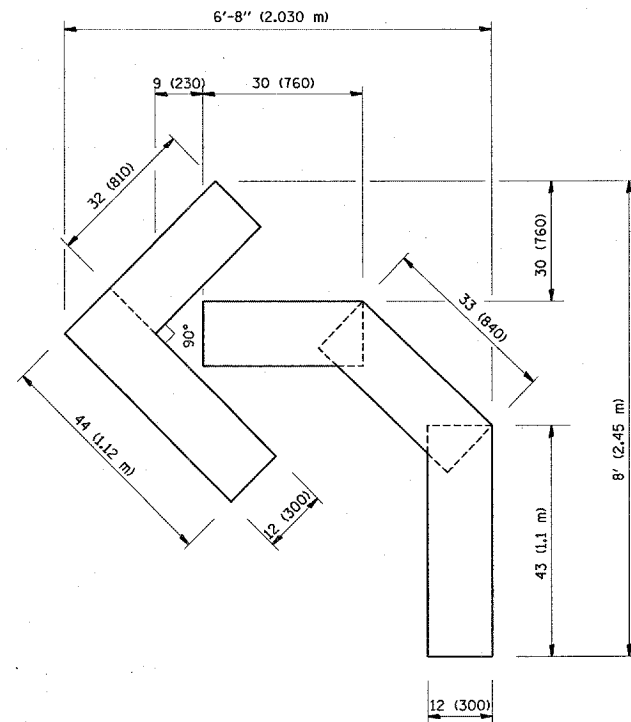

QUANTITY
 4 (100) LINE = 45.5 ft. (13.9 m)
 15.2 sq. ft. (1.39 sq. m)

All dimensions are in inches (millimeters) unless otherwise shown.

FILE NAME =	USER NAME = wlgreendp	DESIGNED -	REVISED -T. RAMMACHER 06-05-96
\\dist\ntfs2\users\wlgreendp\Desktop\99	TH ST. DETAILS\tcl16.dgn	DRAWN -	REVISED -T. RAMMACHER 11-04-97
	PLOT SCALE = 49.9999 / IN.	CHECKED -	REVISED -T. RAMMACHER 03-02-98
	PLOT DATE = 2/4/2008	DATE - 09-18-94	REVISED -E. GOMEZ 08-28-00

**STATE OF ILLINOIS
 DEPARTMENT OF TRANSPORTATION**

**PAVEMENT MARKING LETTERS AND SYMBOLS
 FOR TRAFFIC STAGING**

SCALE: NONE SHEET NO. 17 OF 18 SHEETS STA. TO STA.

F.A.P. RTE.	SECTION	COUNTY	TOTAL SHEETS	SHEET NO.
029	3230 (B-X&C) Z-RS-1	COOK	54	51
TC-16			CONTRACT NO. 60D96	
FED. ROAD DIST. NO. 1 ILLINOIS FED. AID PROJECT				