

REF-PP07  
REF-PP08

IL. RTE. 53

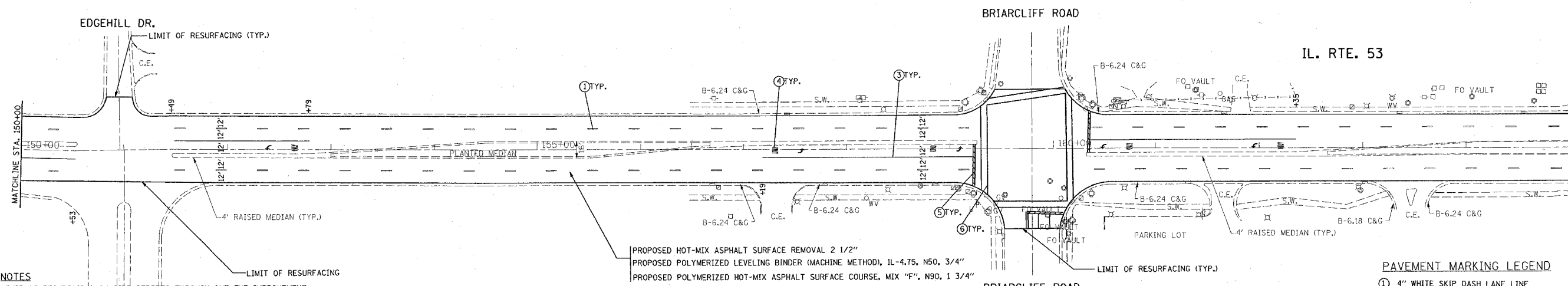
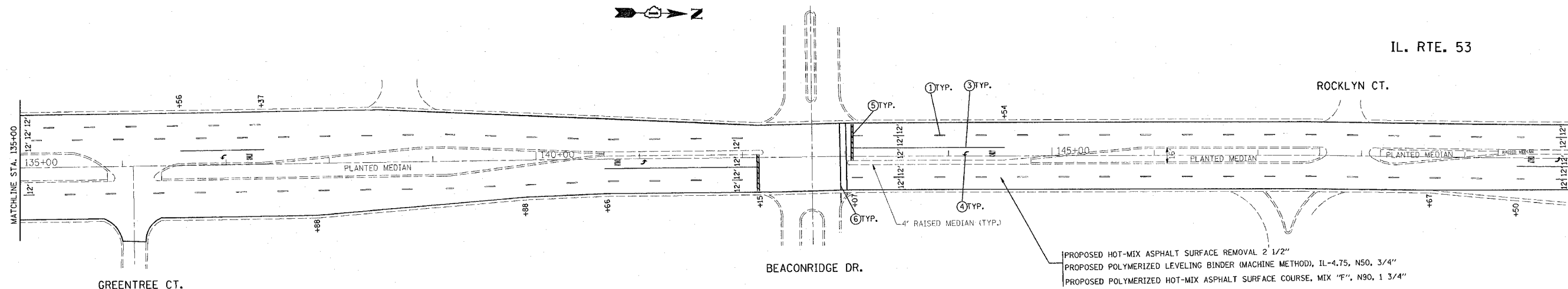

**NOTES**  
LIMIT OF RESURFACING ON SIDE-STREETS THROUGH OUT THE IMPROVEMENT SHALL BE TO THE RADIUS OF RETURN OR AS DIRECTED BY THE ENGINEER.  
ALL FINAL PAVEMENT MARKINGS SHALL BE THERMOPLASTIC (OF THE EXTRUDED TYPE) AND SHOULD BE PLACED IN ACCORDANCE WITH "DISTRICT ONE TYPICAL PAVEMENT MARKINGS" DETAIL, (TC-13).  
ALL RAISED REFLECTIVE PAVEMENT MARKERS SHALL BE PLACED IN ACCORDANCE WITH THE DISTRICT ONE "TYPICAL APPLICATIONS RAISED REFLECTIVE PAVEMENT MARKER DETAIL." (TC-11).

PROPOSED HOT-MIX ASPHALT SURFACE REMOVAL 2 1/2"  
PROPOSED POLYMERIZED LEVELING BINDER (MACHINE METHOD), IL-4.75, N50, 3/4"  
PROPOSED POLYMERIZED HOT-MIX ASPHALT SURFACE COURSE, MIX "F", N90, 1 3/4"

- PAVEMENT MARKING LEGEND**
- ① 4" WHITE SKIP DASH LANE LINE
  - ② 6" WHITE DOTTED TURN LANE LINE EXTENSION
  - ③ 6" WHITE TURN LANE LINE
  - ④ WHITE LETTERS & SYMBOLS
  - ⑤ 24" WHITE STOP BAR
  - ⑥ 6" WHITE CROSS WALK LINE
  - ⑦ 4" YELLOW SOLID MEDIAN LINE
  - ⑧ 12" YELLOW DIAGONAL LINE
  - ⑨ 8" WHITE GORE LINE
  - ⑩ 12" WHITE DIAGONAL LINE

FILE NAME = c:\projects\dl16908\sh_rdw.dgn	USER NAME = abrouah	DESIGNED - DRAWN -	REVISED - REVISED -	<b>STATE OF ILLINOIS DEPARTMENT OF TRANSPORTATION</b>	<b>IL. ROUTE 53 (JOLIET ROAD TO DUPAGE CO. LINE) ROADWAY PLAN</b>			F.A.P. RTE. 870	SECTION 534 RS-3	COUNTY WILL	TOTAL SHEETS 41	SHEET NO. 13
PLOT SCALE = 58.0000' / IN.					CHECKED -	SCALE: 1"=50'	SHEET NO. OF SHEETS	STA. 135+00 TO STA. 165+00	CONTRACT NO. 60E08			
PLOT DATE = 2/27/2008					DATE -	FED. ROAD DIST. NO. 1 ILLINOIS FED. AID PROJECT						