

F.A.P. RTE.	SECTION	COUNTY	TOTAL SHEETS	SHEET NO.
351	2008-001VB	COOK	579	46
STA.	TO STA.			
FED. ROAD DIST. NO.	ILLINOIS FED. AID PROJECT			
	CONTRACT NO. 60E10			

SIGN LEGEND

10 W 20-1 W 1-7 1200mm x 1200mm	28 M 4-6 600mm x 300mm	30L 30R M 4-10 L OR M 4-10 R 1200mm x 450mm
31 W 20-2 1200mm x 1200mm	32 W 20-2 1200mm x 1200mm	33 M 1-4 600mm x 600mm
34 R 11-3a 1500mm x 750mm	35 R 11-3a 1500mm x 750mm	36 M 4-8 600mm x 300mm
37 M 3-4 600mm x 300mm	38 M 3-2 600mm x 300mm	39 W17-1100 750mm x 300mm
40 W17-1100 750mm x 300mm	41L 41R M 5-1L OR M 5-1R 525mm x 375mm	42L 42R M 6-1L OR M 6-1R 525mm x 375mm
43 M 6-3 525mm x 375mm	44L 44R M 6-6L OR M 6-6R 525mm x 375mm	45L 45R M 5-2L OR M 5-2R 525mm x 375mm
46 R 11-3 1500mm x 750mm	47L 47R M 6-2L OR M 6-2R 525mm x 375mm	50 300mm x 450mm
		51 300mm x 450mm

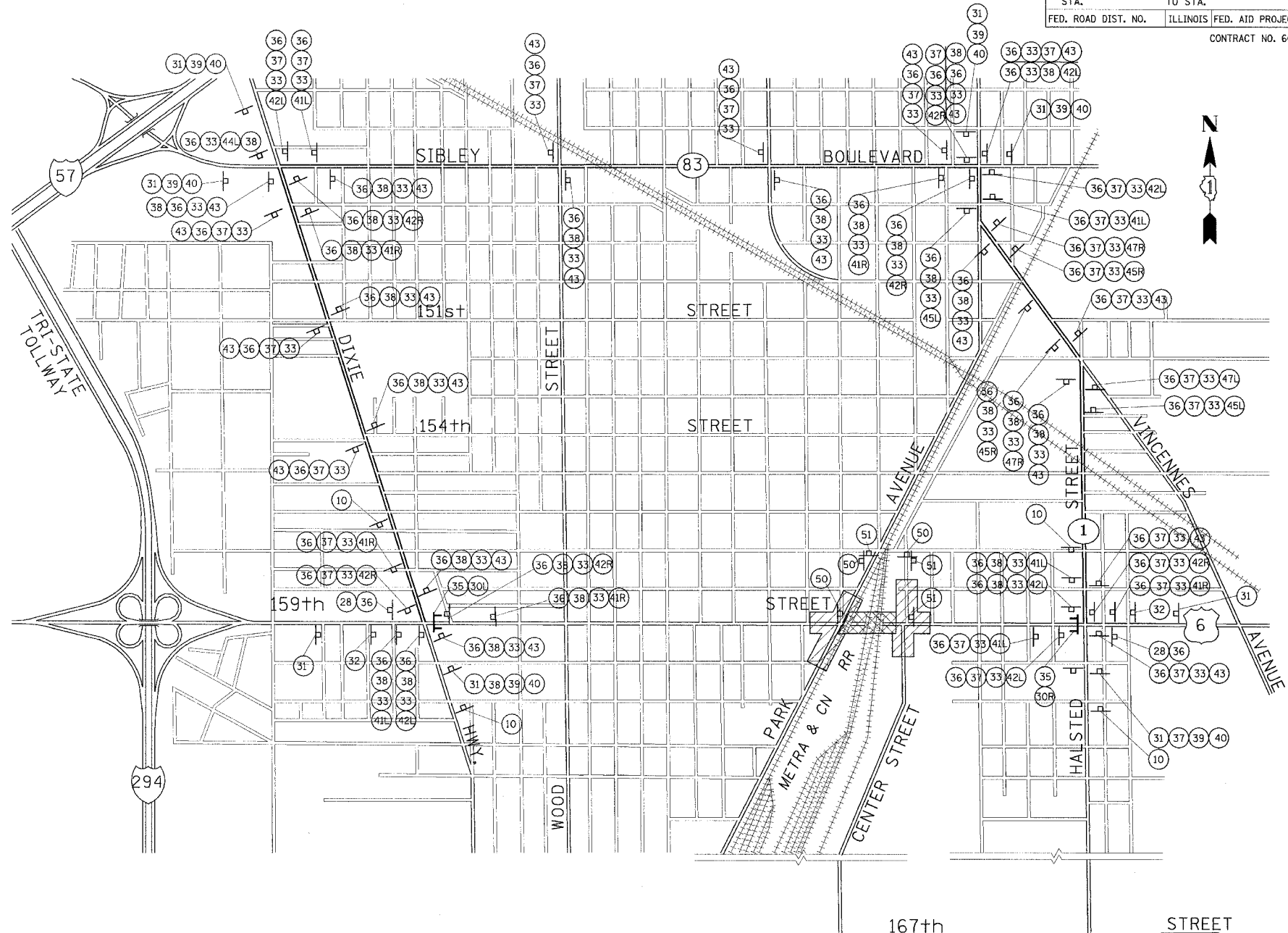

THROUGH TRAFFIC DETOUR ROUTING NOTES

- PRIOR TO START OF RAILROAD BRIDGE CONSTRUCTION, THE CONTRACTOR SHALL REHABILITATE DETOUR ROUTE ROADWAYS (DIXIE HWY., SIBLEY BLVD., AND HALSTED ST.) AS NEEDED, AND AS DETERMINED BY THE ENGINEER. SUCH WORK INCLUDES GRINDING, PATCHING, RESURFACING, AND STRIPING OF ROADS.
- FOR THE DURATION OF THE DETOUR, THE CONTRACTOR WILL BE RESPONSIBLE FOR ALL MAINTENANCE OF THE THROUGH TRAFFIC DETOUR ROUTE.
- UPON COMPLETION OF RAILROAD BRIDGE CONSTRUCTION AND THE REOPENING OF 159TH STREET TRAFFIC, THE CONTRACTOR SHALL BE RESPONSIBLE FOR RESURFACING, PATCHING, AND RESTRIPING THOSE SEGMENTS OF THE THROUGH TRAFFIC DETOUR ROUTE NEEDED, AS DETERMINED BY THE ENGINEER.
- ALL TRAFFIC CONTROL REQUIRED FOR ANY REHABILITATION WORK PERFORMED ALONG THE THROUGH TRAFFIC DETOUR ROUTE PRIOR TO, DURING, OR IMMEDIATELY AFTER RAILROAD BRIDGE CONSTRUCTION SHALL BE INCLUDED AS PART OF "TRAFFIC CONTROL AND PROTECTION (SPECIAL)".

THROUGH TRAFFIC DETOUR ROUTING, WITH SIGNAGE

LEGEND

	BARRICADE TYPE III WITH FLASHING LIGHT (ONE SYMBOL SHALL REPRESENT ANY NUMBER OF BARRICADES REQUIRED TO ADEQUATELY PROTECT THE AREA SHOWN)
	TEMPORARY TRAFFIC ADVISORY SIGN
	SIGN LEGEND NUMBER (SEE SIGN LEGEND FOR SIGNS AND CORRESPONDING NUMBERS)
	CONSTRUCTION WORK ZONE
	SECTION OF ROAD CLOSURE (FOR 20 MONTHS)
	APPROVED DETOUR ROUTE

NOTE: ALL DETOUR SIGNS SHALL BE INCLUDED IN THE COST OF "TRAFFIC CONTROL AND PROTECTION FOR TEMPORARY DETOUR".

REVISIONS	
NAME	DATE

ILLINOIS DEPARTMENT OF TRANSPORTATION
 US RTE 6 FROM LEXINGTON AVE TO FISK AVE
 MAINTENANCE OF TRAFFIC
 THROUGH TRAFFIC DETOUR ROUTING

MT-03
 DATE 02/21/08

DRAWN BY MRF
 CHECKED BY JWK