

F.A.P. RTE.	SECTION	COUNTY	TOTAL SHEETS	SHEET NO.
351	2008-001VB	COOK	579	76
STA. 2+700		TO STA. 2+825		
FED. ROAD DIST. NO.		ILLINOIS	FED. AID PROJECT	
CONTRACT NO. 60E10				

DRAINAGE TABLE LEGEND
A3 = TYPE C, 0.6m DIAMETER
A4 = TYPE A, 1.2m DIAMETER
A5 = TYPE A, 1.5m DIAMETER
A6 = TYPE A, 1.8m DIAMETER
A7 = TYPE A, 2.1m DIAMETER
*WMB = WATER MAIN REQUIREMENTS
**WTB = WATERTIGHT BOOT REQUIRED AT ALL PIPES ENTERING STRUCTURE

NOTE:
STA. 2+748.413 U.S. ROUTE 6 = STA. 41+000.000 EXIST. PARK AVE. (N)
STRUCTURE OFFSET LOCATIONS GIVEN ON THE PLANS ARE TO THE FOLLOWING POINTS
A) FOR STRUCTURES FALLING IN THE CURB LINE - TO THE EDGE OF PAVEMENT
B) FOR ALL OTHER STRUCTURE LOCATIONS - TO THE CENTER OF THE STRUCTURE

FINAL SURVEY PLOTTED	BY	DATE
NOTE BOOK TEMPLATE		
AREAS CHECKED		
NO.		

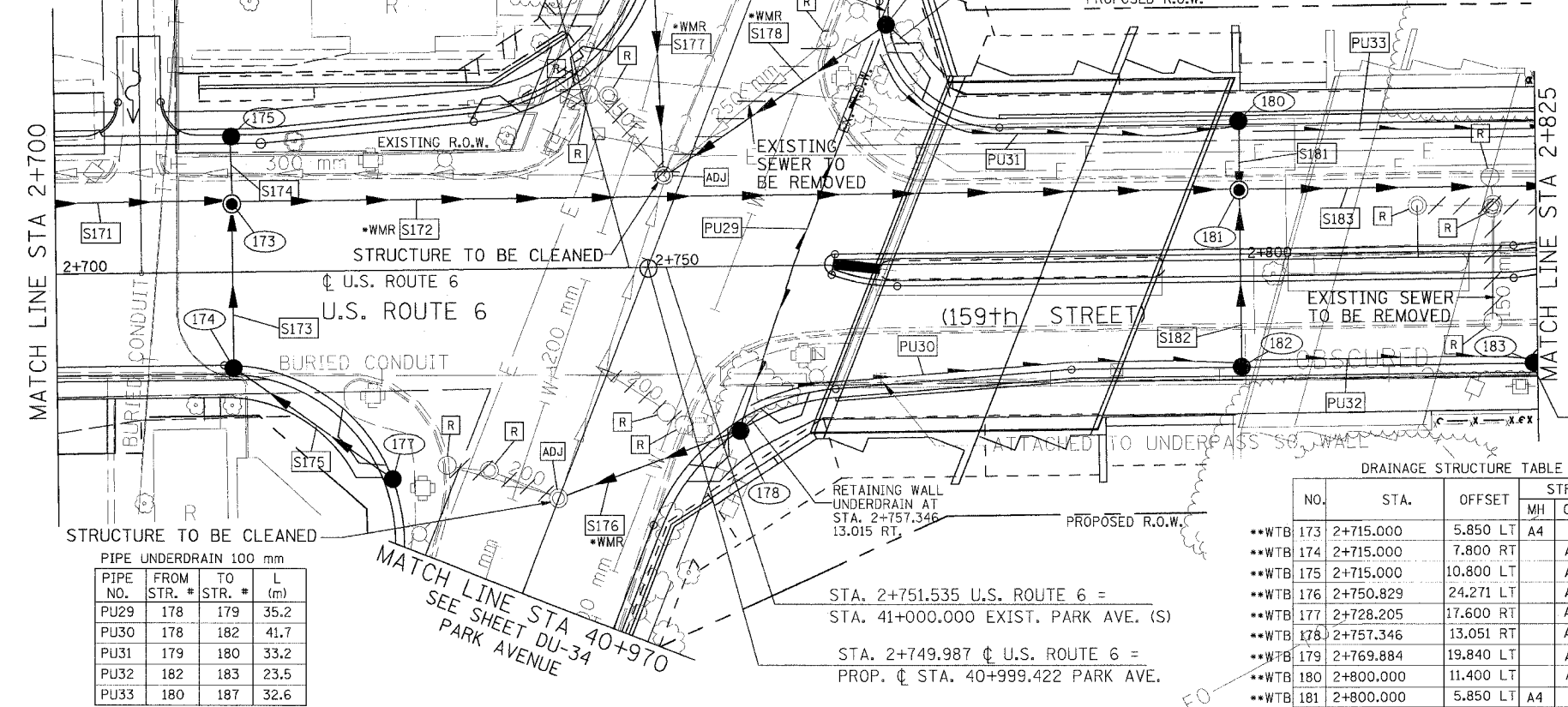

PIPE TABLE STA. 2+700 TO STA. 2+825

PIPE NO.	PIPE LOCATION FROM STR. #	PIPE LOCATION TO STR. #	DESCRIPTION	DIA. (mm)	L (M)	S (%)	TRENCH BACKFILL VOLUME (CU M)
S172	173	181	SS, WMR	525	83.8	1.00	116.5
S173	174	173	SS T2, RCP CL III	300	12.8	1.00	22.6
S174	175	173	SS T1, RCP CL IV	300	4.4	1.00	1.7
S175	177	174	SS T2, RCP CL III	300	15.2	1.00	23.5
S176	178	EX MH	SS, WMR	300	13.6	1.00	3.8
S177	176	EX MH	SS, WMR	300	15.6	1.00	4.4
S178	179	EX MH	SS, WMR	300	17.2	1.00	6.6
S181	180	181	SS T1, RCP CL IV	300	5.8	1.00	2.0
S182	182	181	SS T2, RCP CL III	300	14.3	1.00	5.9
S183	181	184	SS T1, RCP CL IV	600	32.8	0.30	13.0

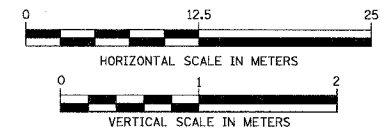

PIPE UNDERDRAIN 100 mm

PIPE NO.	FROM STR. #	TO STR. #	L (m)
PU29	178	179	35.2
PU30	178	182	41.7
PU31	179	180	33.2
PU32	182	183	23.5
PU33	180	187	32.6

DRAINAGE STRUCTURE TABLE STA. 2+700 TO STA. 2+825

NO.	STA.	OFFSET	STRUCTURE TYPE/SIZE	FRAME & GRATE	INVERT				RIM ELEV
					N	S	E	W	
**WTB 173	2+715.000	5.850 LT	A4	T-1-CL	183.066	182.275	182.167	182.932	184.423
**WTB 174	2+715.000	7.800 RT	A4	T-24	182.403		182.403		184.384
**WTB 175	2+715.000	10.800 LT	A3	T-24		183.110			184.324
**WTB 176	2+750.829	24.271 LT	A4	T-24		182.384			183.500
**WTB 177	2+728.205	17.600 RT	A3	T-24				182.555	183.770
**WTB 178	2+757.346	13.051 RT	A3	T-24				182.225	183.440
**WTB 179	2+769.884	19.840 LT	A4	T-24				182.057	183.272
**WTB 180	2+800.000	11.400 LT	A3	T-24		181.403			182.633
**WTB 181	2+800.000	5.850 LT	A4	T-1-CL	181.353	181.308	181.254	181.329	182.744
**WTB 182	2+800.000	9.000 RT	A3	T-24	181.451				182.660
**WTB 183	2+824.640	9.000 RT	A3	T-24			181.326		182.519

ORIGINAL SURVEY PLOTTED	BY	DATE
NOTE BOOK TEMPLATE		
AREAS CHECKED		
NO.		

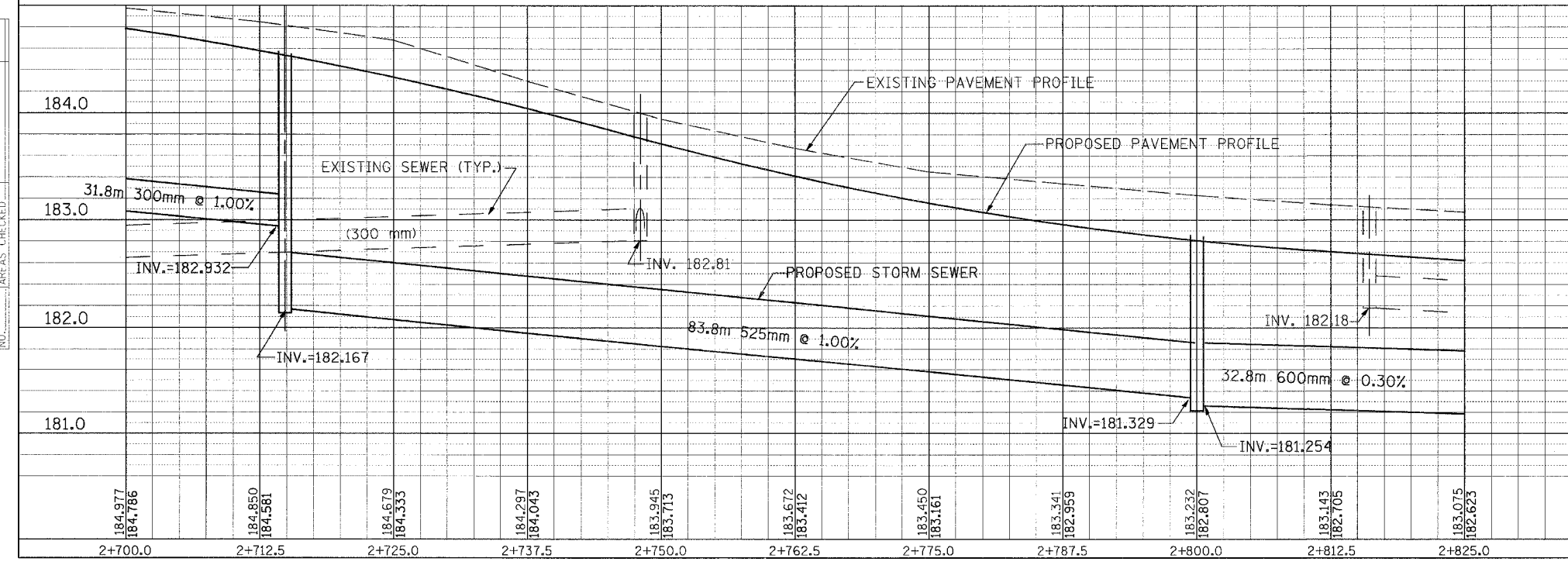

REVISIONS	
NAME	DATE

ILLINOIS DEPARTMENT OF TRANSPORTATION
US RTE 6 FROM LEXINGTON AVE TO FISK AVE
DRAINAGE AND UTILITIES
STA. 2+700 TO STA. 2+825
DU-17
DATE 02/21/08
DRAWN BY JAM
CHECKED BY JWK