



STS Consultants Ltd.
Consulting Engineers
STS PROJECT NO.: 32646

DRAWN BY: CJD 4-10-02
CHECKED BY: SEK 4-10-02
APPROVED BY: TDB 4-10-02

| BY | DATE |
|------------------------|------|
| FINAL SURVEY | |
| SURVEY PLOTTED | |
| NOTE BOOK COMPLETED | |
| TEMPLATE AREAS CHECKED | |
| NO. | |

| BY | DATE |
|------------------------|------|
| ORIGINAL SURVEY | |
| SURVEY PLOTTED | |
| NOTE BOOK COMPLETED | |
| TEMPLATE AREAS CHECKED | |
| NO. | |

| F.A. RTE. | SECTION | COUNTY | TOTAL SHEETS NO. | SHEET NO. |
|---------------------|---------|---------------------------|------------------|-----------|
| 351 | 3277R | COOK | 679 | 108 |
| STA. 2+825 | | TO STA. 2+950 | | |
| FED. ROAD DIST. NO. | | ILLINOIS FED. AID PROJECT | | |

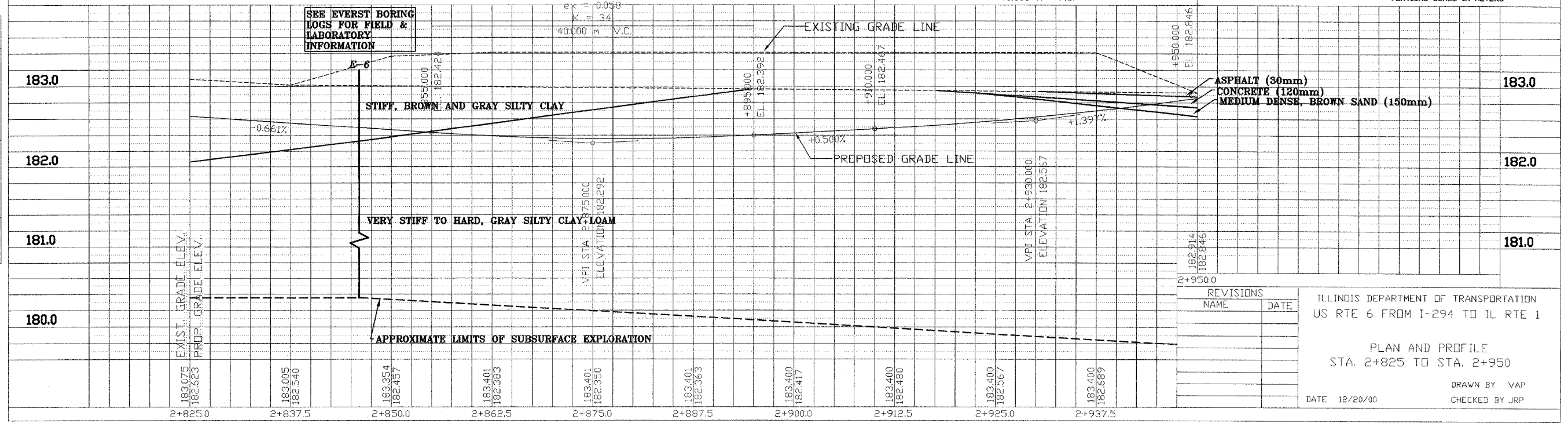
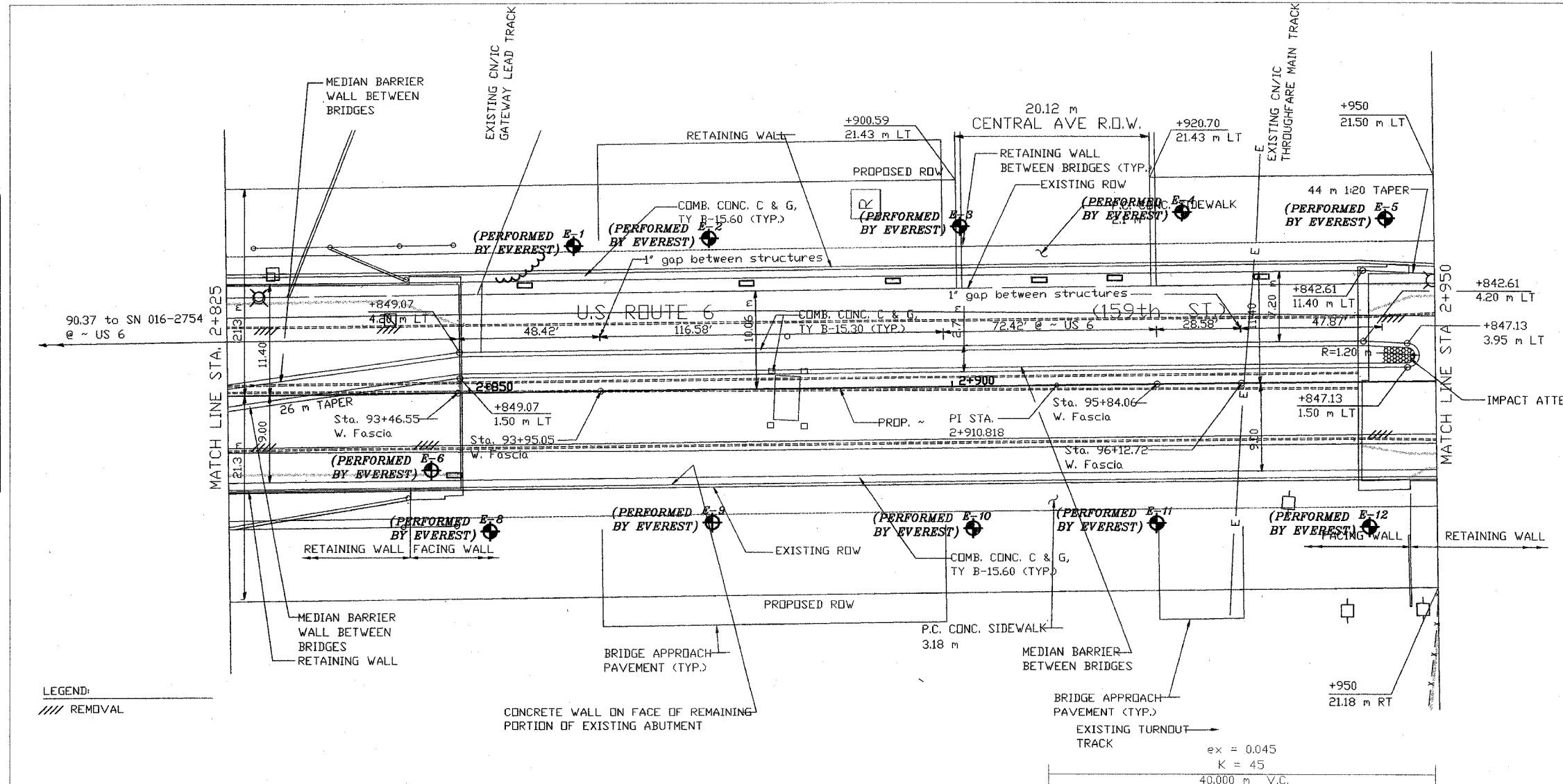

| REVISIONS | NAME | DATE |
|-----------|------|------|
| | | |

ILLINOIS DEPARTMENT OF TRANSPORTATION
US RTE 6 FROM I-294 TO IL RTE 1

PLAN AND PROFILE
STA. 2+825 TO STA. 2+950

DATE: 12/20/00
DRAWN BY: VAP
CHECKED BY: JRP

8: 180.0 181.0 182.0 183.0
04/10/2002 14:31