



STS Consultants Ltd.  
Consulting Engineers  
STS PROJECT NO.: 32646

DRAWN BY	CJD	4-10-02
CHECKED BY	SEK	4-10-02
APPROVED BY	TDB	4-10-02

F.A. RTE	SECTION	COUNTY	TOTAL SHEETS NO.	SHEET NO.
351	3277R	COOK	579	116
STA. 50+900		TO STA. 50+970		
FED. ROAD DIST. NO.		ILLINOIS FED. AID PROJECT		

BY	DATE

BY	DATE

X:\PROJECTS\32646\PROFILES\50+900\_50+970.dwg  
04/10/2002 13:39

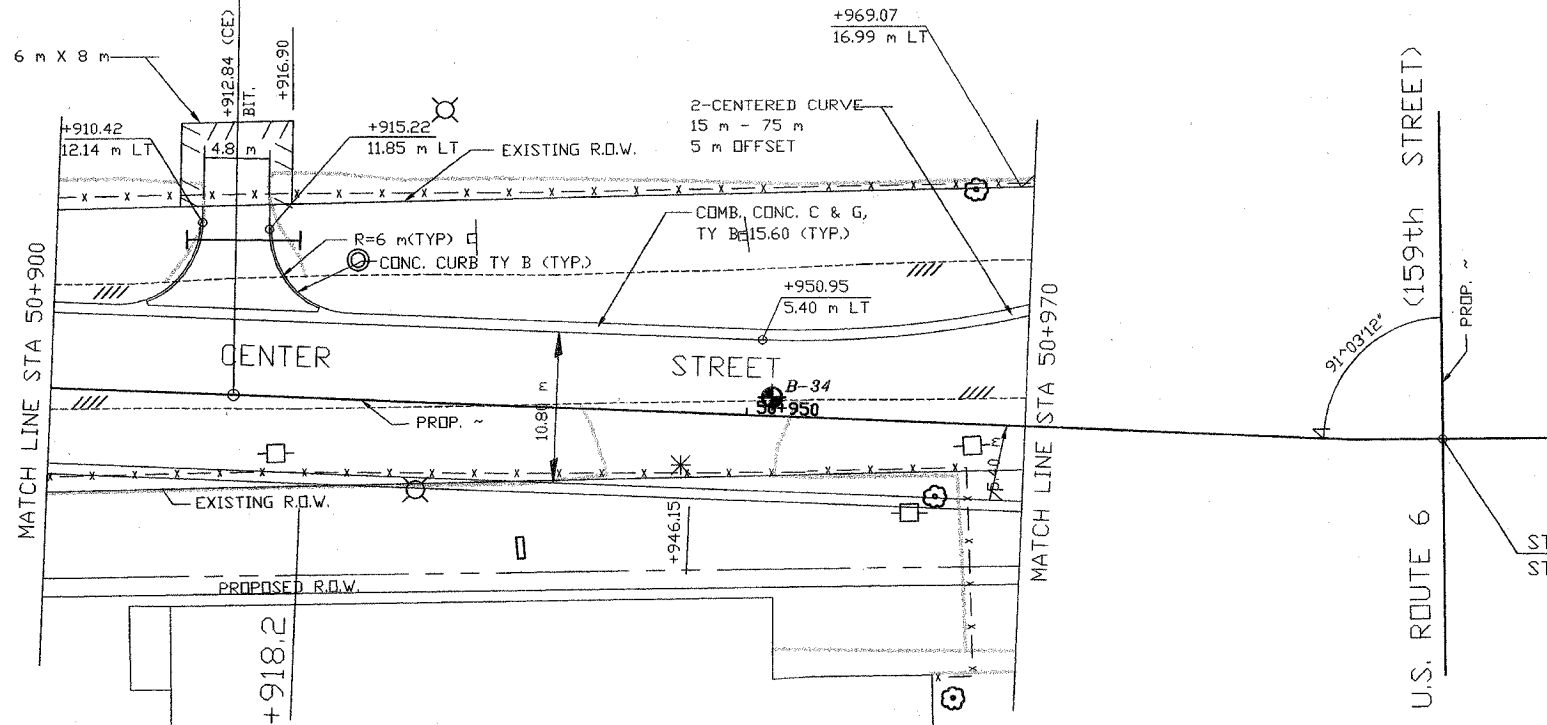

- LEGEND:
- DRIVEWAY TO BE CLOSED
  - TREE TO BE REPLACED
  - TREE TO BE PROTECTED
  - REMOVAL

- LEGEND
- B-43 BORING NO.
  - BORING PERFORMED BY STS CONSULTANTS LTD. (PER. 2002)
  - $N. Q_p$  (kPa) 8, 175
  - 22.1, 200 WATER CONTENT (%),  $Q_u$  (kPa)
  - WATER LEVEL DURING DRILLING
  - DELAYED WATER LEVEL
  - DRY
  - NOTE: DRY INDICATED IF GROUNDWATER NOT ENCOUNTERED

NOTE:  
THE STRATA LINES SHOWN ARE INTERPOLATED FROM DATA OBTAINED AT BORING LOCATIONS. ACTUAL SOIL CONDITIONS IN-SITU MAY VARY.

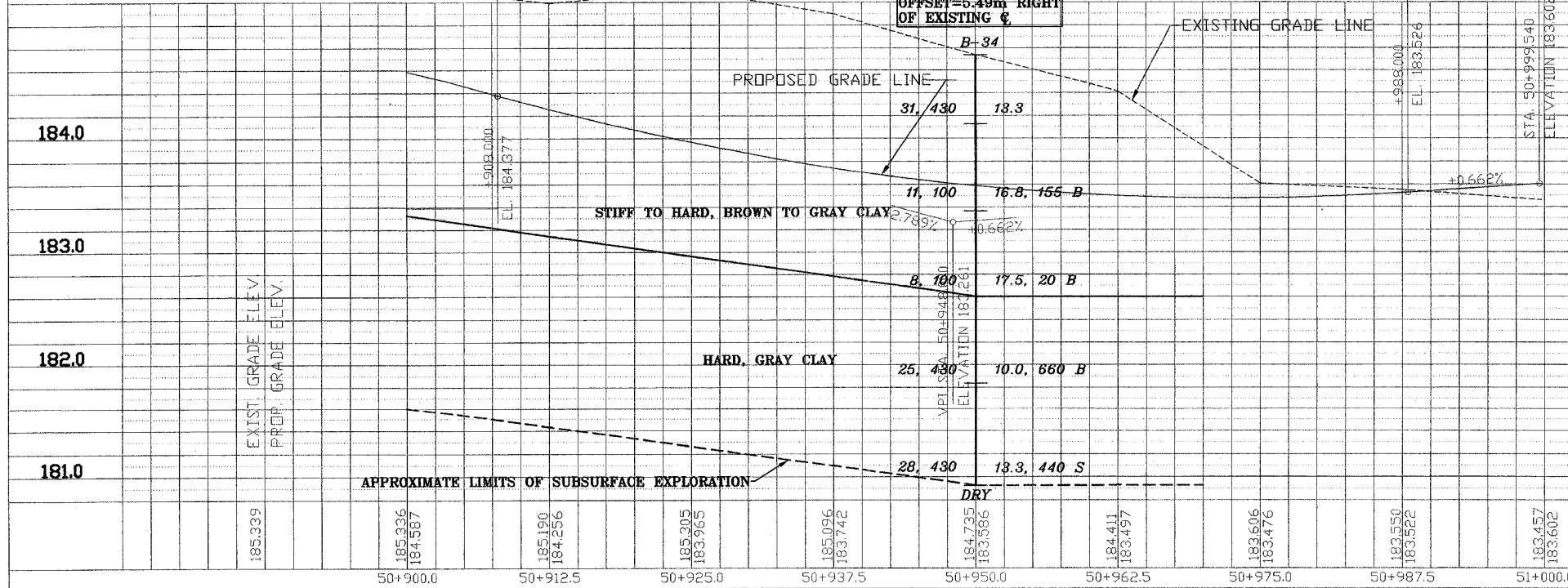
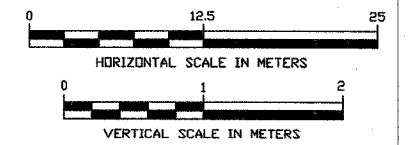

REVISIONS	
NAME	DATE

ILLINOIS DEPARTMENT OF TRANSPORTATION  
US RTE 6 FROM I-294 TO IL RTE 1  
CENTER STREET  
PLAN AND PROFILE  
STA. 50+900 TO STA. 50+970  
DATE 12/20/00  
DRAWN BY VAP  
CHECKED BY JRP