

F.A.P. RTE.	SECTION	COUNTY	TOTAL SHEETS	SHEET NO.
351	2008-001VB	COOK	579	127
STA.		TO STA.		
FED. ROAD DIST. NO.		ILLINOIS FED. AID PROJECT		
CONTRACT NO. 60E10				

NOTES:

1. THE LOCATION OF THE LONGITUDINAL CONSTRUCTION JOINTS MAY VARY, DEPENDING ON THE STAGE CONSTRUCTION OF THE PAVEMENT.
2. SIDE STREET PAVEMENT JOINTS SHALL LINE UP WITH THE CONTRACTION AND CONSTRUCTION JOINTS ON THE MAINLINE PAVEMENT TO AVOID MID-PANEL CRACKING.
3. ALL ELEVATIONS ARE NOTED ON A 4.5m TRANSVERSE GRID AT LANE LINES.
4. ALL ELEVATIONS NOTED ON THIS SHEET ARE 180 m + THE ELEVATION SHOWN ON THE DRAWING.
5. TRANSVERS JOINT SPACING MAY VARY FROM 3.0m TO 4.5m

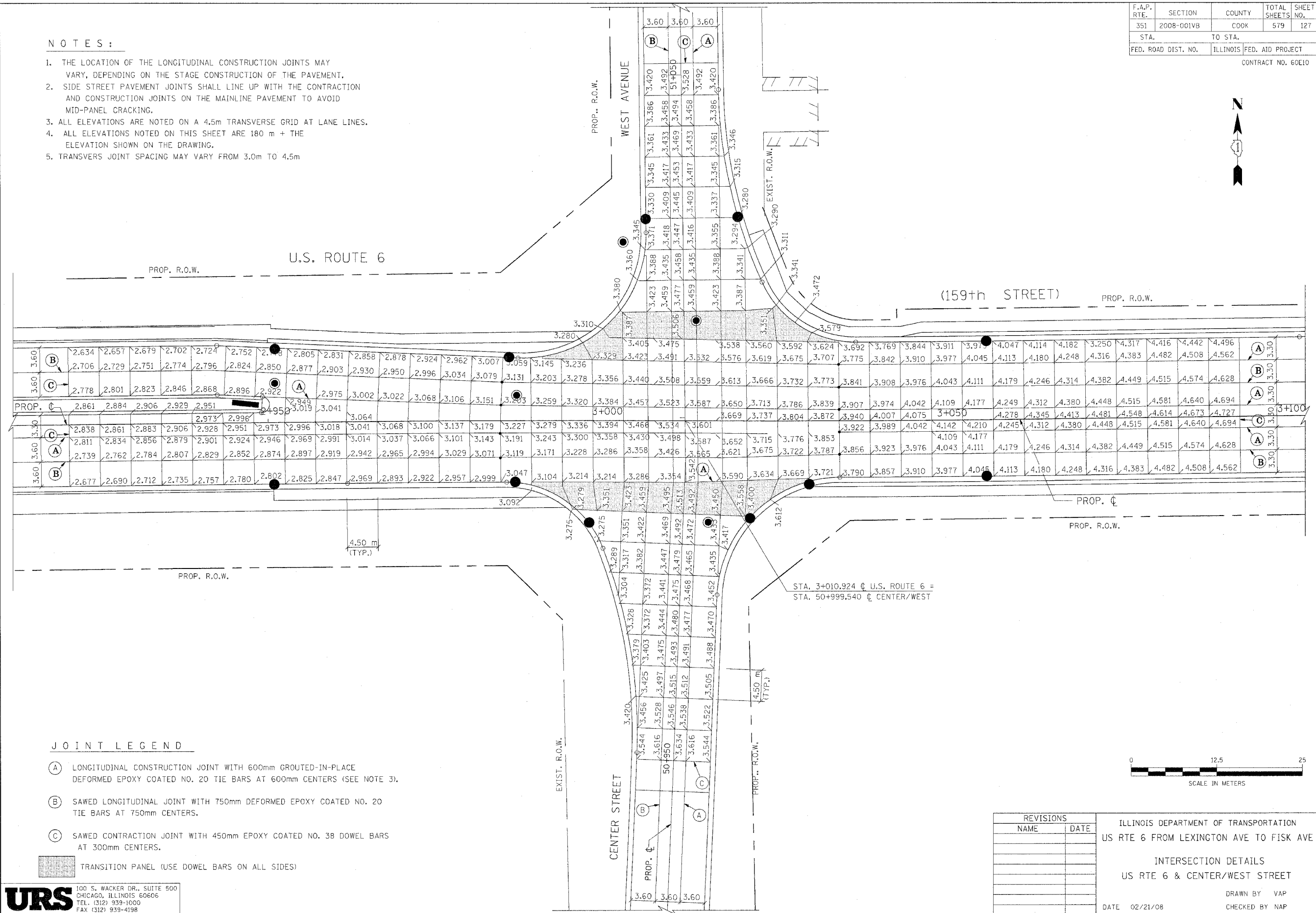

JOINT LEGEND

- (A) LONGITUDINAL CONSTRUCTION JOINT WITH 600mm GROUTED-IN-PLACE DEFORMED EPOXY COATED NO. 20 TIE BARS AT 600mm CENTERS (SEE NOTE 3).
- (B) SAWED LONGITUDINAL JOINT WITH 750mm DEFORMED EPOXY COATED NO. 20 TIE BARS AT 750mm CENTERS.
- (C) SAWED CONTRACTION JOINT WITH 450mm EPOXY COATED NO. 38 DOWEL BARS AT 300mm CENTERS.



TRANSITION PANEL (USE DOWEL BARS ON ALL SIDES)

URS
 100 S. WACKER DR., SUITE 500
 CHICAGO, ILLINOIS 60606
 TEL. (312) 939-1000
 FAX (312) 939-4198

REVISIONS	
NAME	DATE

ILLINOIS DEPARTMENT OF TRANSPORTATION
 US RTE 6 FROM LEXINGTON AVE TO FISK AVE
 INTERSECTION DETAILS
 US RTE 6 & CENTER/WEST STREET
 DRAWN BY VAP
 CHECKED BY NAP
 DATE 02/21/08