

F.A.P. RTE.	SECTION	COUNTY	TOTAL SHEETS	SHEET NO.
351	2008-001VB	COOK	579	132
STA.	TO STA. 2+700			
FED. ROAD DIST. NO.	ILLINOIS	FED. AID PROJECT		

CONTRACT NO. 60E10



EROSION CONTROL AND LANDSCAPING NOTES

ALL SEDIMENT AND EROSION CONTROL MEASURES SHALL BE INSTALLED PER IDOT STANDARD 280001 OR AS SPECIFIED HEREIN AND PAID FOR IN ACCORDANCE WITH SECTION 280 OF THE STANDARD SPECIFICATIONS. ALL CONSTRUCTION ACTIVITIES WILL BE IN ACCORDANCE WITH THE NATIONAL POLLUTION DISCHARGE ELIMINATION SYSTEM STORM WATER PERMIT ILR10.

EROSION CONTROL SHALL BE PROVIDED IN ACCORDANCE WITH THE SEQUENCE OF STAGE CONSTRUCTION. THE CONTRACTOR SHALL SUBMIT A DETAILED SCHEDULE FOR APPROVAL.

SEDIMENTATION AND EROSION CONTROL DEVICES SHALL BE IN PLACE AND FUNCTIONAL BEFORE THE PROJECT SITE IS OTHERWISE DISTURBED.

ALL DISTURBED AREAS SHALL BE SEEDED OR SODDED AS SOON AS PRACTICAL AFTER CONSTRUCTION ACTIVITIES IN THAT AREA HAVE CONCLUDED. AREAS THAT HAVE BEEN STRIPPED AND WILL NOT RECEIVE PERMANENT LANDSCAPING BEFORE THE END OF THE FALL SEEDING RESTRICTIONS SHALL RECEIVE "TEMPORARY EROSION CONTROL SEEDING".

THE CONTRACTOR SHALL TAKE ALL PRECAUTIONS TO PROTECT WETLANDS FROM DAMAGE BY SEDIMENT, CONSTRUCTION EQUIPMENT OR BY HIS WORK CREWS. THE CONTRACTOR SHALL ASSURE THAT DEBRIS OR ANY CONSTRUCTION MATERIAL IS NOT DISPOSED OF IN WETLANDS.

WATER PUMPED OR OTHERWISE DISCHARGED FROM THE SITE DURING CONSTRUCTION DEWATERING SHALL BE FILTERED.

GRAVEL ROADS, ACCESS DRIVES, PARKING AREAS OF SUFFICIENT WIDTH AND LENGTH, AND VEHICLE WASH DOWN FACILITIES IF NECESSARY, SHALL BE PROVIDED TO PREVENT THE DEPOSIT OF SOIL FROM BEING TRACKED ONTO PUBLIC OR PRIVATE ROADWAYS. ANY SOIL REACHING A PUBLIC OR PRIVATE ROADWAY SHALL BE REMOVED BEFORE THE END OF EACH WORKDAY OR SOONER AS NEEDED.

EROSION CONTROL MEASURES WILL BE INSPECTED BY THE ENGINEER PERIODICALLY AND WITHIN 24 HOURS OF ANY STORM EXCEEDING 1/2-INCH PRECIPITATION. DAMAGED AND INEFFECTIVE EROSION CONTROL MEASURES SHALL BE REPAIRED OR REPLACED WITHIN 72 HOURS.

ALL CONTROL MEASURES SHALL BE KEPT OPERATIONAL AND MAINTAINED CONTINUOUSLY THROUGHOUT THE PERIOD OF LAND DISTURBANCE UNTIL PERMANENT SEDIMENT AND EROSION CONTROL MEASURES ARE OPERATIONAL.

THE SEEDING DATES FOR BARE EARTH SEEDING OF MIXTURE CLASS 2A SHALL BE FROM APRIL 1 TO JUNE 1, AND FROM AUGUST 15 TO SEPTEMBER 30.

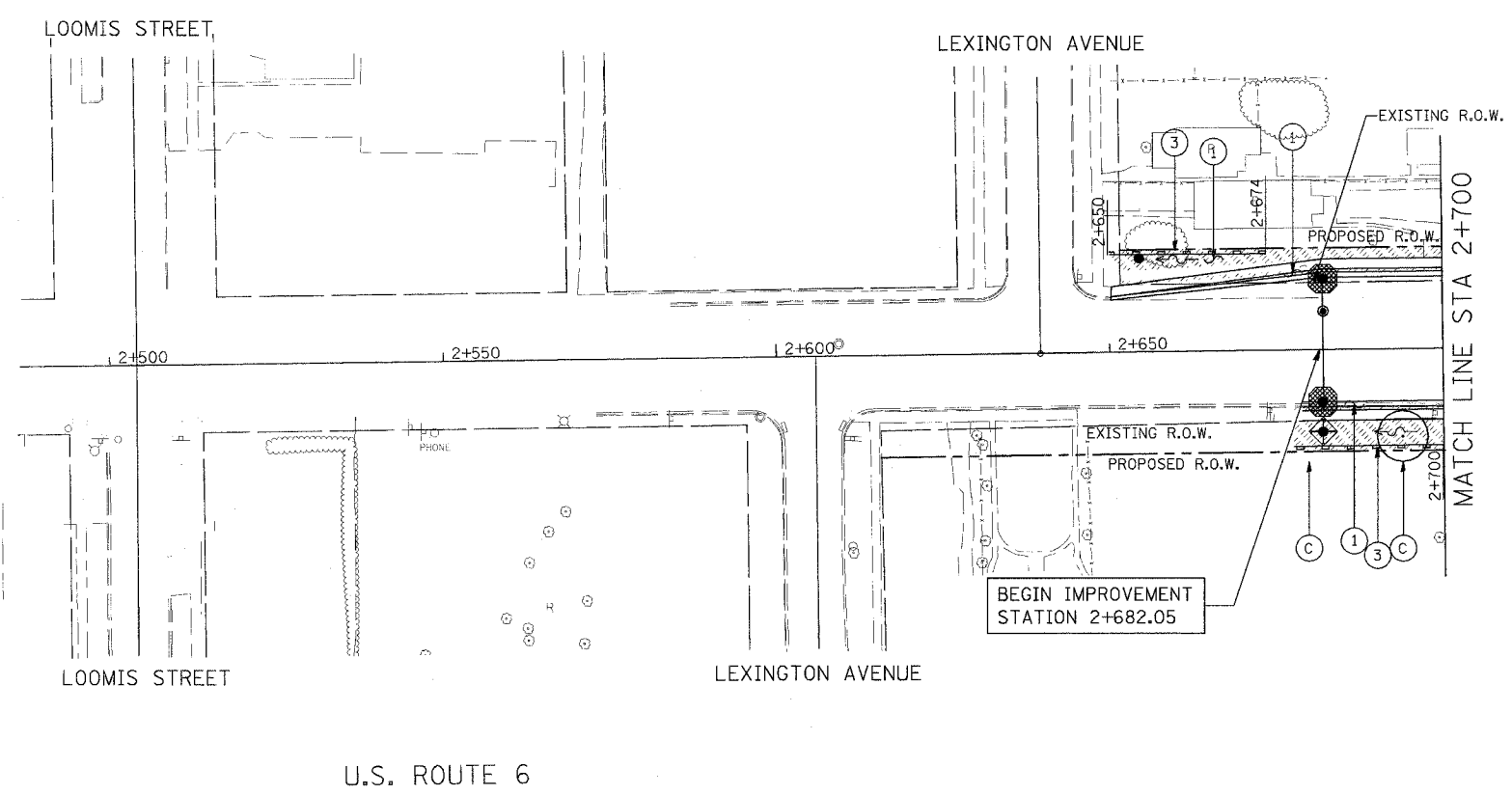

TREE LEGEND

- (A) AUTUMN BLAZE MAPLE
- (B) AUTUMN PURPLE ASH
- (C) SKYLINE HONEYLOCUST
- (D) KENTUCKY COFFEETREE
- (E) GREENSPIRE LINDEN
- (F) RED JEWEL CRABAPPLE
- (G) CHANTICLEER PEAR

LEGEND

- (1) SODDING, SALT TOLERANT
- (2) SEEDING, CLASS 2A
- (3) PERIMETER EROSION BARRIER
- INLET & PIPE PROTECTION
- INLET FILTER

URS 100 S. WACKER DR., SUITE 500
CHICAGO, ILLINOIS 60606
TEL. (312) 939-1000
FAX (312) 939-4198

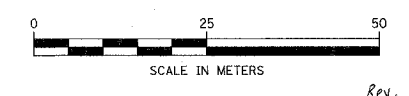

REVISIONS		ILLINOIS DEPARTMENT OF TRANSPORTATION US RTE 6 FROM LEXINGTON AVE TO FISK AVE EROSION CONTROL AND LANDSCAPING PLAN STA. 2+150 TO STA. 2+700
NAME	DATE	
		EC-04
		DATE 02/21/08
		DRAWN BY VAP
		CHECKED BY NAP