

ROUTE NO.	SECTION	COUNTY	TOTAL SHEETS	SHEET NO
F.A.P. 351	2008-001VB	COOK	579	196
STA.		TO STA.		
FED. ROAD DIST. NO. 7		ILLINOIS		FED. AID PROJECT
CONTRACT NO. 60E10				

3/13/2008 2:09:39 PM

q:\17049\069\Track & Rail Main Contract\FINAL PLANS\atg\new_2.dgn

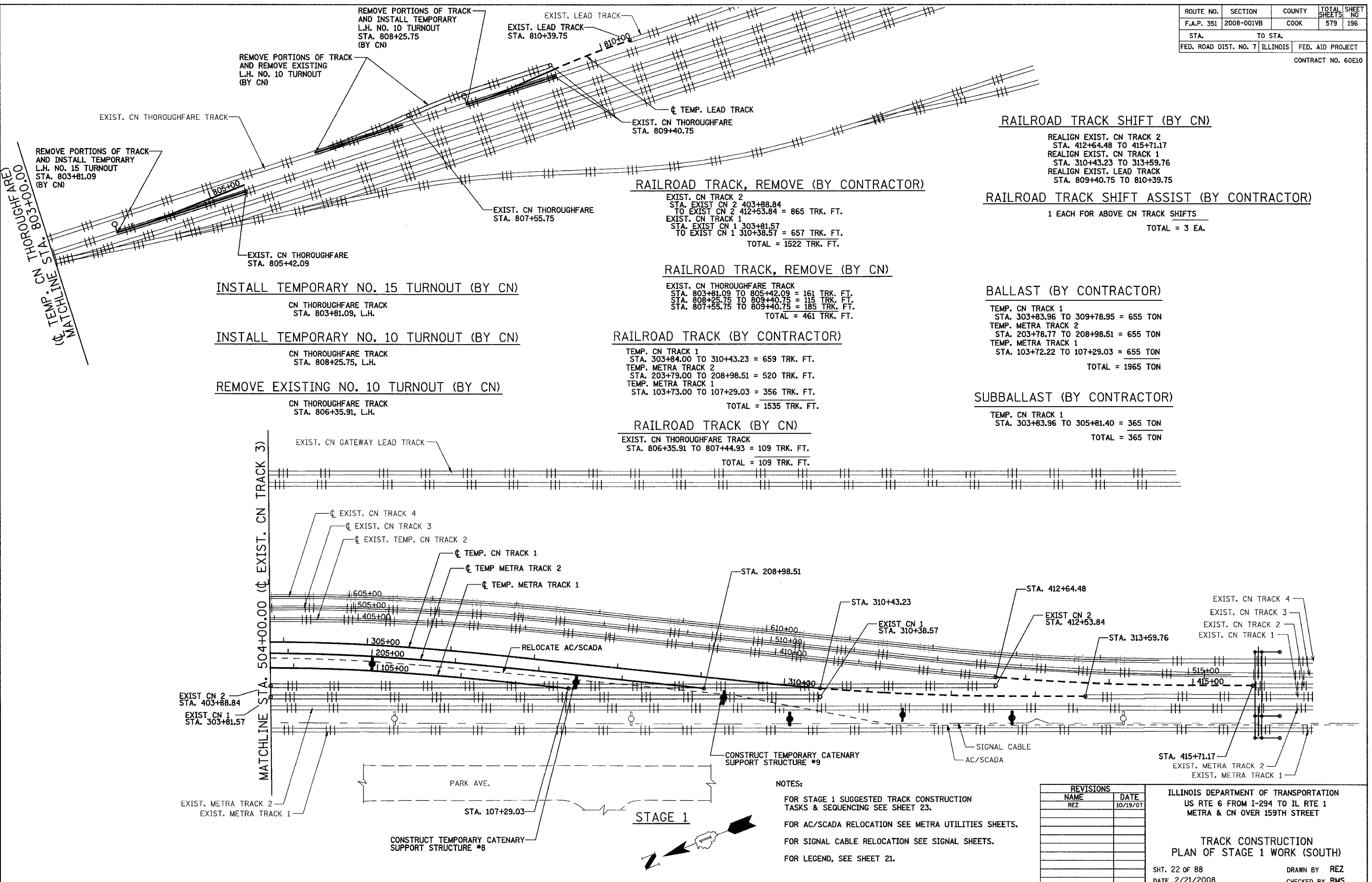

RAILROAD TRACK SHIFT (BY CN)

REALIGN EXIST. CN TRACK 2
STA. 412+64.48 TO 415+71.17
REALIGN EXIST. CN TRACK 1
STA. 310+43.23 TO 313+59.76
REALIGN EXIST. LEAD TRACK
STA. 809+40.75 TO 810+39.75

RAILROAD TRACK SHIFT ASSIST (BY CONTRACTOR)

1 EACH FOR ABOVE CN TRACK SHIFTS
TOTAL = 3 EA.

RAILROAD TRACK, REMOVE (BY CONTRACTOR)

EXIST. CN TRACK 2
STA. EXIST CN 2 403+88.84
TO EXIST CN 2 412+53.84 = 865 TRK. FT.
EXIST. CN TRACK 1
STA. EXIST CN 1 303+81.57
TO EXIST CN 1 310+38.57 = 657 TRK. FT.
TOTAL = 1522 TRK. FT.

RAILROAD TRACK, REMOVE (BY CN)

EXIST. CN THOROUGHFARE TRACK
STA. 803+81.09 TO 805+42.09 = 161 TRK. FT.
STA. 808+25.75 TO 809+40.75 = 115 TRK. FT.
STA. 807+55.75 TO 809+40.75 = 185 TRK. FT.
TOTAL = 461 TRK. FT.

RAILROAD TRACK (BY CONTRACTOR)

TEMP. CN TRACK 1
STA. 303+84.00 TO 310+43.23 = 659 TRK. FT.
TEMP. METRA TRACK 2
STA. 203+79.00 TO 208+98.51 = 520 TRK. FT.
TEMP. METRA TRACK 1
STA. 103+73.00 TO 107+29.03 = 356 TRK. FT.
TOTAL = 1535 TRK. FT.

RAILROAD TRACK (BY CN)

EXIST. CN THOROUGHFARE TRACK
STA. 806+35.91 TO 807+44.93 = 109 TRK. FT.
TOTAL = 109 TRK. FT.

BALLAST (BY CONTRACTOR)

TEMP. CN TRACK 1
STA. 303+83.96 TO 309+78.95 = 655 TON
TEMP. METRA TRACK 2
STA. 203+78.77 TO 208+98.51 = 655 TON
TEMP. METRA TRACK 1
STA. 103+72.22 TO 107+29.03 = 655 TON
TOTAL = 1965 TON

SUBBALLAST (BY CONTRACTOR)

TEMP. CN TRACK 1
STA. 303+83.96 TO 305+81.40 = 365 TON
TOTAL = 365 TON

INSTALL TEMPORARY NO. 15 TURNOUT (BY CN)

CN THOROUGHFARE TRACK
STA. 803+81.09, L.H.

INSTALL TEMPORARY NO. 10 TURNOUT (BY CN)

CN THOROUGHFARE TRACK
STA. 808+25.75, L.H.

REMOVE EXISTING NO. 10 TURNOUT (BY CN)

CN THOROUGHFARE TRACK
STA. 806+35.91, L.H.

NOTES:

- FOR STAGE 1 SUGGESTED TRACK CONSTRUCTION TASKS & SEQUENCING SEE SHEET 23.
- FOR AC/SCADA RELOCATION SEE METRA UTILITIES SHEETS.
- FOR SIGNAL CABLE RELOCATION SEE SIGNAL SHEETS.
- FOR LEGEND, SEE SHEET 21.

REVISIONS	
NAME	DATE
REZ	10/19/07

ILLINOIS DEPARTMENT OF TRANSPORTATION
US RTE 6 FROM I-294 TO IL RTE 1
METRA & CN OVER 159TH STREET

**TRACK CONSTRUCTION
PLAN OF STAGE 1 WORK (SOUTH)**

SHT. 22 OF 88
DATE 2/21/2008

DRAWN BY REZ
CHECKED BY RMS