

ROUTE NO.	SECTION	COUNTY	TOTAL SHEETS	SHEET NO.
F.A.P. 351	2008-001VB	COOK	579	204
STA.		TO STA.		
FED. ROAD DIST. NO. 7		ILLINOIS	FED. AID PROJECT	

CONTRACT NO. 60E10

RAILROAD TRACK, REMOVE (BY METRA)

EXIST. METRA TRACK 1 TO BE REMOVED
 STA. 94+54.40 TO STA. 96+13.40 = 159 TRK. FT.
 TOTAL = 159 TRK. FT.

RAILROAD TRACK (BY METRA)

TEMP. METRA TRACK 1
 STA. 96+13.74 TO 98+35.74 = 222 TRK. FT.
 TOTAL = 222 TRK. FT.

TEMPORARY NO. 15 TURNOUT (BY METRA)

METRA TRACK 1
 STA. 94+54.40, L.H. = 1 EA.
 TOTAL = 1 EA.

RAILROAD TRACK (BY CONTRACTOR)

TEMP. METRA TRACK 1
 STA. 98+35.74 TO 100+11.56 = 176 TRK. FT.
 TOTAL = 176 TRK. FT.

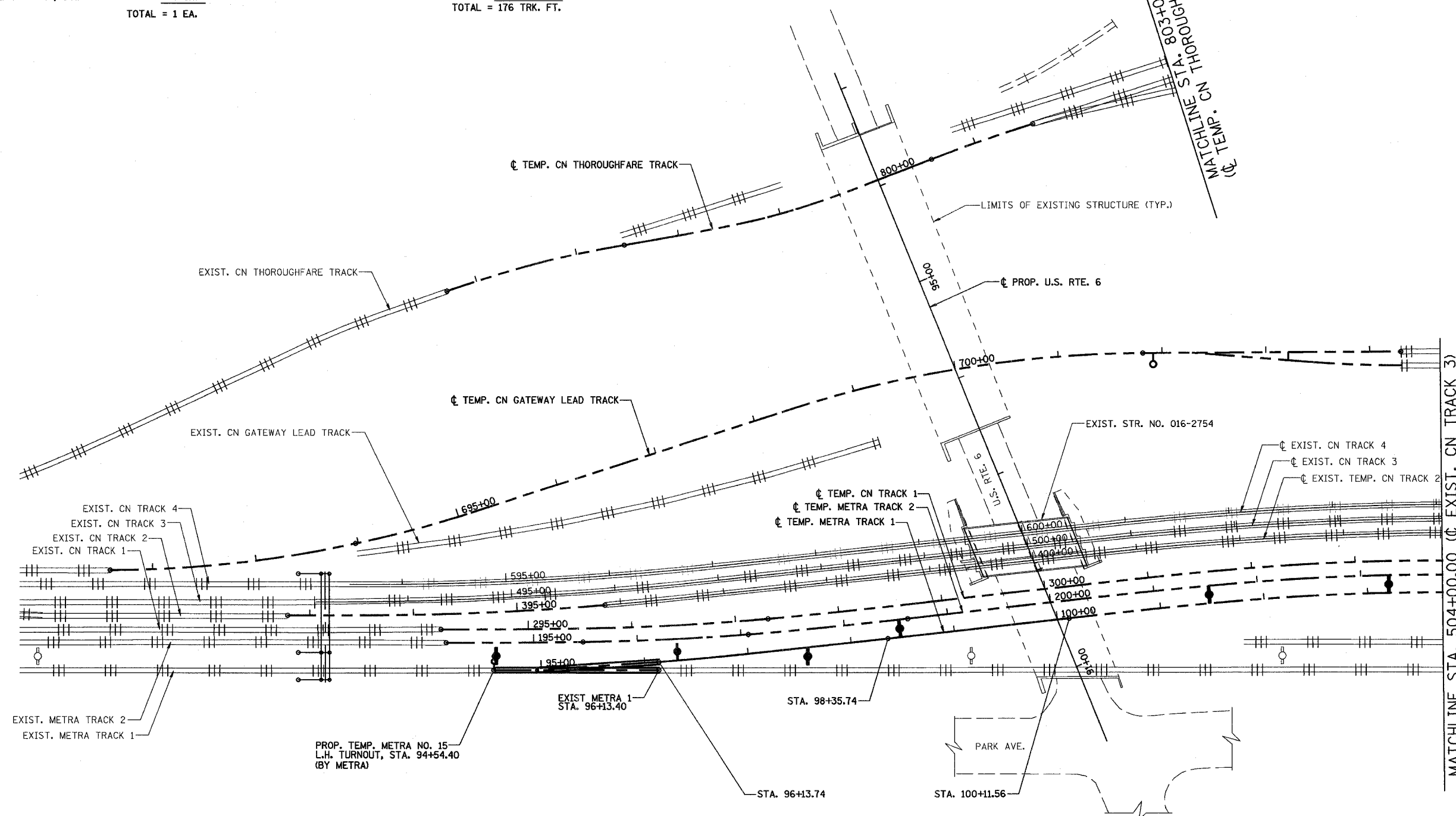

3/13/2008 2:09:43 PM

q:\17049\069\Track & Rail Main Contract\FINAL PLANS\stg4new_1.dgn

STAGE 4

NOTES:
 FOR STAGE 4 SUGGESTED TRACK CONSTRUCTION TASKS & SEQUENCING SEE SHEET 32.
 FOR AC/SCADA AND SIGNAL RELOCATION SEE METRA UTILITIES SHEETS.
 FOR SIGNAL CABLE RELOCATION SEE SIGNAL SHEETS.
 FOR LEGEND, SEE SHEET 21.

STAGE 4 WORK SUMMARY	
BUILD PORTIONS OF METRA 1	
INSTALL METRA 1 TURNOUTS AND CONSTRUCT TEMP. TRACK 1 CATENARY	

REVISIONS	
NAME	DATE
REZ	10/19/07

ILLINOIS DEPARTMENT OF TRANSPORTATION
 US RTE 6 FROM I-294 TO IL RTE 1
 METRA & CN OVER 159TH STREET

**TRACK CONSTRUCTION
 PLAN OF STAGE 4 WORK (NORTH)**

SHT. 30 OF 88
 DATE 2/21/2008

DRAWN BY REZ
 CHECKED BY RMS