

|                       |            |          |                  |          |
|-----------------------|------------|----------|------------------|----------|
| ROUTE NO.             | SECTION    | COUNTY   | TOTAL SHEETS     | SHEET NO |
| F.A.P. 351            | 2008-001VB | COOK     | 579              | 207      |
| STA.                  |            | TO STA.  |                  |          |
| FED. ROAD DIST. NO. 7 |            | ILLINOIS | FED. AID PROJECT |          |
| CONTRACT NO. 60E10    |            |          |                  |          |

**RAILROAD TRACK, REMOVE (BY METRA)**  
 EXIST. METRA TRACK 1 TO BE REMOVED  
 STA. 98+59.77 TO STA. 101+78.77 = 319 TRK. FT.  
 TOTAL = 319 TRK. FT.

**REMOVE NO. 15 TURNOUT (BY METRA)**  
 METRA TRACK 1  
 STA. 94+54.40, L.H. = 1 EA.  
 TOTAL = 1 EA.

**RAILROAD TRACK (BY METRA)**  
 TEMP. METRA TRACK 1  
 STA. 94+54.40 TO 96+13.74 = 159 TRK. FT.  
 TOTAL = 159 TRK. FT.

**RAILROAD TRACK SHIFT (BY METRA)**  
 REALIGN EXIST. METRA TRACK 1  
 STA. 93+25.33 TO 94+54.40  
 STA. 96+13.74 TO 97+96.94

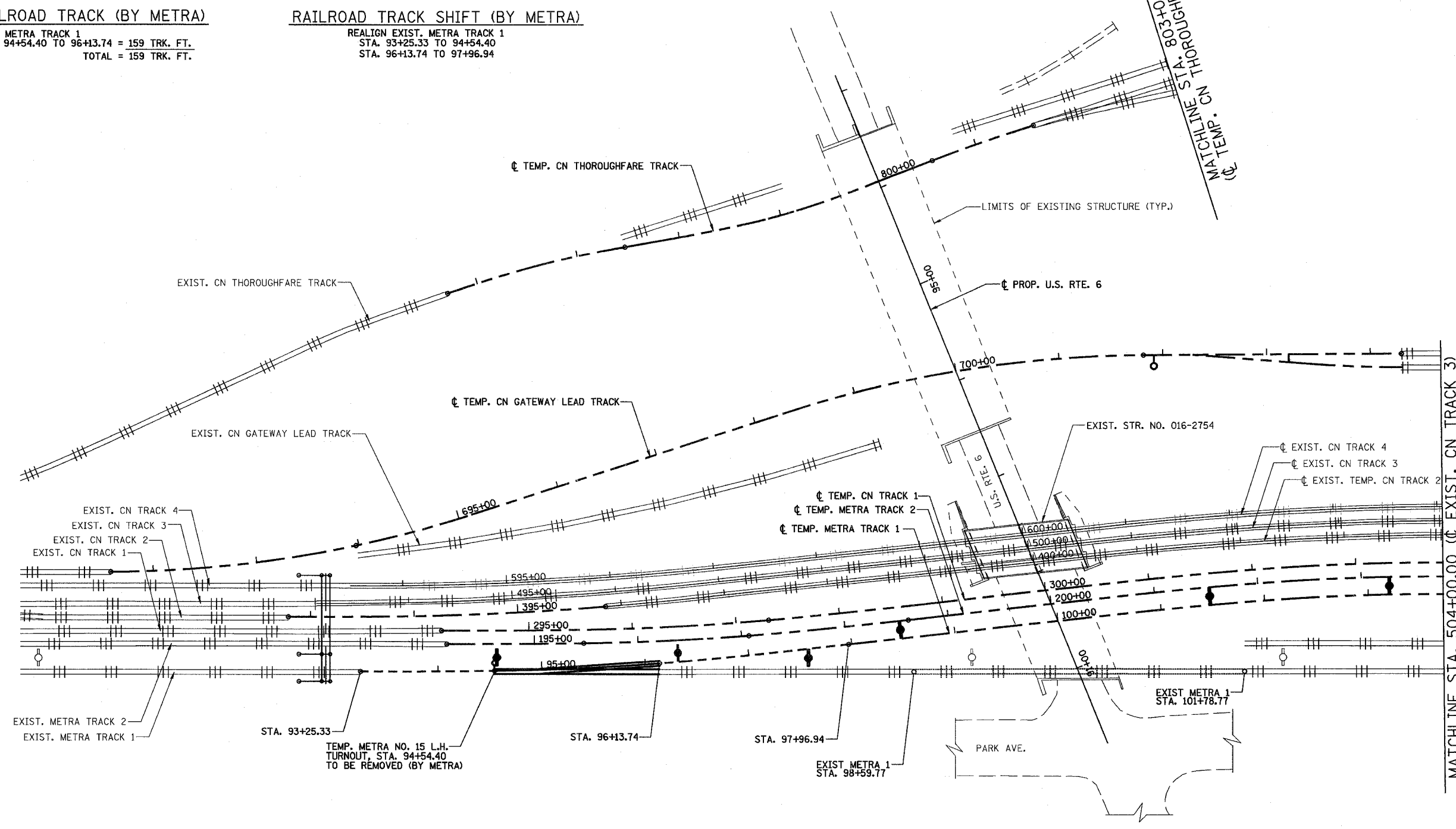

3/13/2008 2:09:44 PM

q:\17049,069\Track & Rail Main Contract\FINAL PLANS\stg4new\_1a.dgn

**STAGE 5**

NOTES:  
 FOR STAGE 5 SUGGESTED TRACK CONSTRUCTION TASKS & SEQUENCING SEE SHEET 35.  
 FOR AC/SCADA AND SIGNAL RELOCATION SEE METRA UTILITIES SHEETS.  
 FOR SIGNAL CABLE RELOCATION SEE SIGNAL SHEETS.  
 FOR LEGEND, SEE SHEET 21.

| STAGE 5 WORK SUMMARY                                 |  |
|--|--|
| REMOVE TURNOUTS AND RE-ALIGN TEMP. METRA 1 TO 55 MPH |  |
| CONSTRUCT 2-TRACK METRA PORTION OF BRIDGE            |  |

| REVISIONS |          |
|-----------|----------|
| NAME      | DATE     |
| REZ       | 10/19/07 |
|           |          |
|           |          |
|           |          |
|           |          |
|           |          |
|           |          |
|           |          |
|           |          |

ILLINOIS DEPARTMENT OF TRANSPORTATION  
 US RTE 6 FROM I-294 TO IL RTE 1  
 METRA & CN OVER 159TH STREET

**TRACK CONSTRUCTION  
 PLAN OF STAGE 5 WORK (NORTH)**

SHT. 33 OF 88  
 DATE 2/21/2008

DRAWN BY REZ  
 CHECKED BY RMS

