

ROUTE NO.	SECTION	COUNTY	TOTAL SHEETS	SHEET NO.
F.A.P. 351	2008-001VB	COOK	579	211
STA.		TO STA.		
FED. ROAD DIST. NO. 7		ILLINOIS	FED. AID PROJECT	

CONTRACT NO. 60E10

3/13/2008 2:09:46 PM

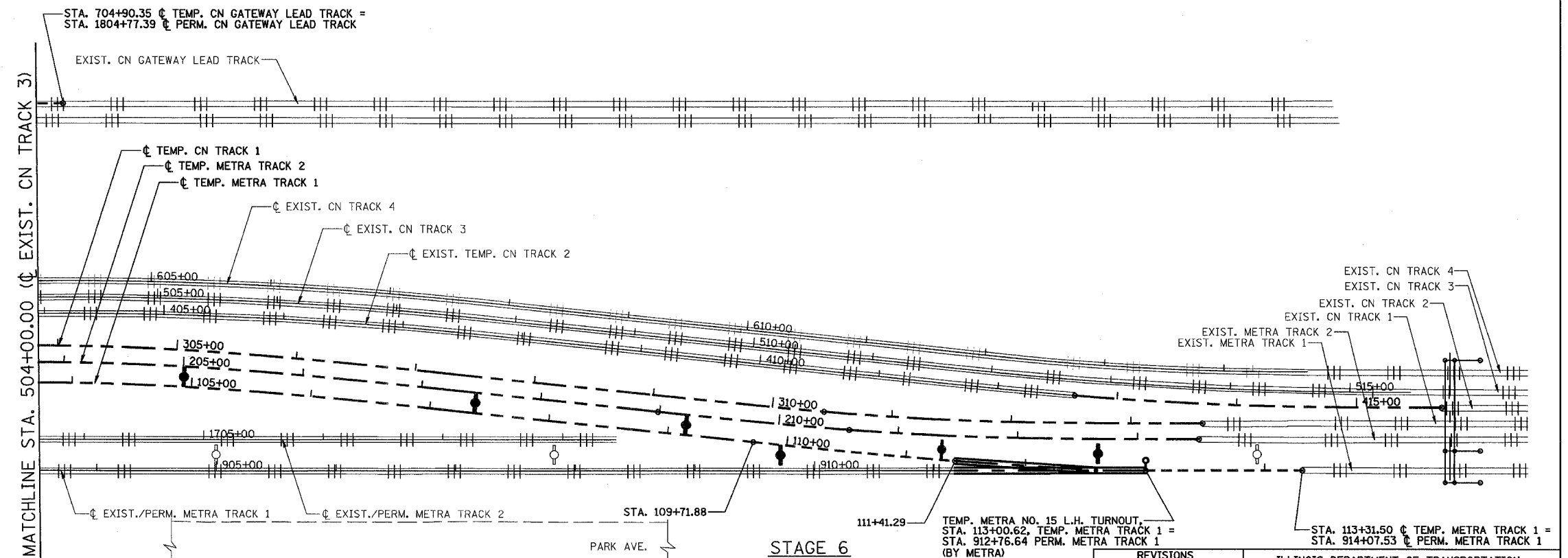
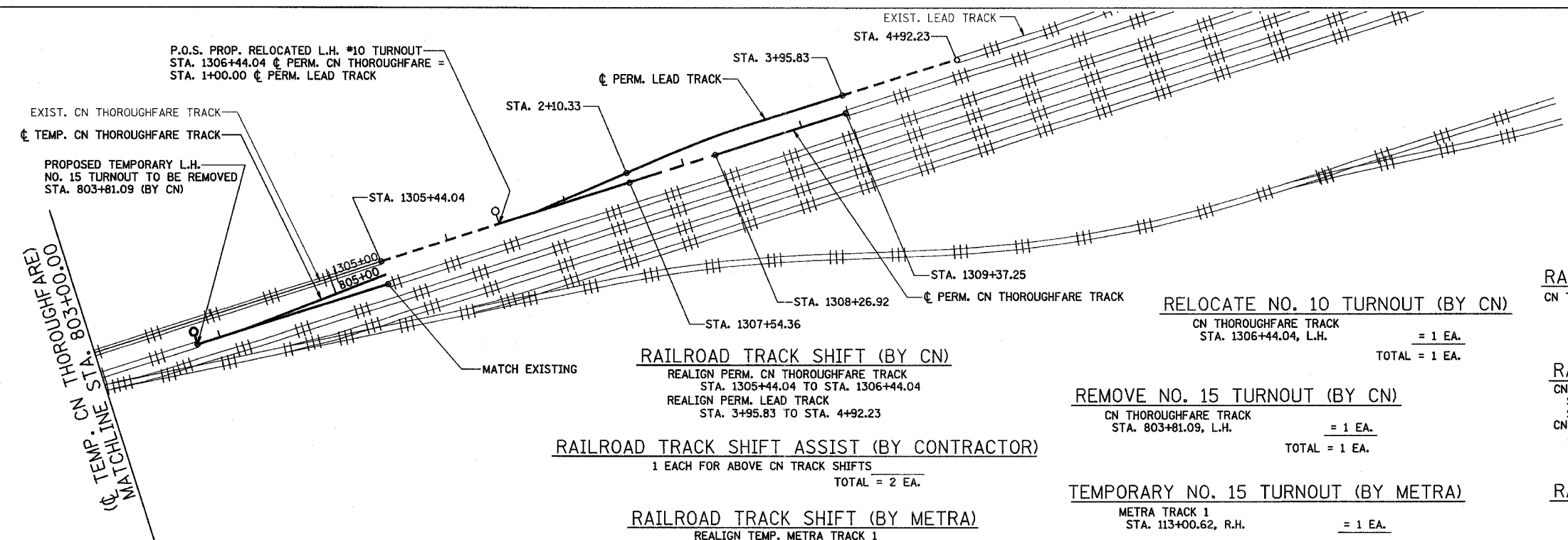

RAILROAD TRACK SHIFT (BY CN)
 REALIGN PERM. CN THOROUGHFARE TRACK
 STA. 1305+44.04 TO STA. 1306+44.04
 REALIGN PERM. LEAD TRACK
 STA. 3+95.83 TO STA. 4+92.23

RAILROAD TRACK SHIFT ASSIST (BY CONTRACTOR)
 1 EACH FOR ABOVE CN TRACK SHIFTS
 TOTAL = 2 EA.

RAILROAD TRACK SHIFT (BY METRA)
 REALIGN TEMP. METRA TRACK 1
 STA. 109+71.88 TO 111+41.29
 REALIGN PERM. METRA TRACK 1
 STA. 912+76.64 TO 914+07.53

RELOCATE NO. 10 TURNOUT (BY CN)
 CN THOROUGHFARE TRACK
 STA. 1306+44.04, L.H.
 = 1 EA.
 TOTAL = 1 EA.

REMOVE NO. 15 TURNOUT (BY CN)
 CN THOROUGHFARE TRACK
 STA. 803+81.09, L.H.
 = 1 EA.
 TOTAL = 1 EA.

TEMPORARY NO. 15 TURNOUT (BY METRA)
 METRA TRACK 1
 STA. 113+00.62, R.H.
 = 1 EA.
 TOTAL = 1 EA.

RAILROAD TRACK, REMOVE (BY CN)
 CN THOROUGHFARE TRACK
 STA. 1306+44.04 TO STA. 1307+54.36 = 110 TRK. FT.
 TOTAL = 110 TRK. FT.

RAILROAD TRACK (BY CN)
 CN THOROUGHFARE TRACK
 STA. 803+81.09 TO 805+42.09 = 161 TRK. FT.
 STA. 1308+26.92 TO 1309+37.25 = 110 TRK. FT.
 CN LEAD TRACK
 STA. 2+10.33 TO 3+95.83 = 186 TRK. FT.
 TOTAL = 457 TRK. FT.

RAILROAD TRACK, REMOVE (BY METRA)
 TEMPORARY METRA TRACK 1 TO BE REMOVED
 STA. 111+41.29 TO STA. 113+00.62 = 159 TRK. FT.
 TOTAL = 159 TRK. FT.

NOTES:
 FOR STAGE 6 SUGGESTED TRACK CONSTRUCTION TASKS & SEQUENCING SEE SHEET 38.
 FOR AC/SCADA AND SIGNAL RELOCATION SEE METRA UTILITIES SHEETS.
 FOR SIGNAL CABLE RELOCATION SEE SIGNAL SHEETS.
 FOR LEGEND, SEE SHEET 21.

STAGE 6

REVISIONS	
NAME	DATE

ILLINOIS DEPARTMENT OF TRANSPORTATION
 US RTE 6 FROM I-294 TO IL RTE 1
 METRA & CN OVER 159TH STREET

TRACK CONSTRUCTION PLAN OF STAGE 6 WORK (SOUTH)

SHT. 37 OF 88
 DATE 2/21/2008
 DRAWN BY REZ
 CHECKED BY RMS

c:\17049\069\Track & Rail Main Contract\FINAL PLANS\stg5new_2.dgn