

ROUTE NO.	SECTION	COUNTY	TOTAL SHEETS	SHEET NO.
F.A.P. 351	2008-001VB	COOK	579	219
STA.		TO STA.		
FED. ROAD DIST. NO. 7		ILLINOIS		FED. AID PROJECT
CONTRACT NO. 60E10				

RAILROAD TRACK, REMOVE (BY CONTRACTOR)

TEMP. CN TRACK 1 TO BE REMOVED
 STA. 297+31.57 TO STA. 301+00.00 = 368 TRK. FT.
 TOTAL = 368 TRK. FT.

RAILROAD TRACK SHIFT (BY CN)

REALIGN PERM. CN TRACK 1
 STA. 994+02.12 TO STA. 997+17.41
 REALIGN PERM. CN TRACK 2
 STA. 1092+59.66 TO STA. 1095+65.59

RELOCATE TEMPORARY CN TRACK NO 1 (BY CONTRACTOR)

TEMP. CN TRACK 1 TO BE RELOCATED TO PERM. CN TRACK 2 LOCATION
 STA. 301+00.00 TO STA. 303+83.98 = 284 TRK. FT.
 TOTAL = 284 TRK. FT.

RAILROAD TRACK SHIFT ASSIST (BY CONTRACTOR)

1 EACH FOR ABOVE CN TRACK SHIFTS
 TOTAL = 2 EACH

BALLAST (BY CONTRACTOR)

PERM. CN TRACK 1
 STA. 995+74.61 TO 1007+57.17 = 1035 TON
 PERM. CN TRACK 2
 STA. 1095+78.64 TO 1107+63.99 = 1035 TON
 TOTAL = 2070 TON

RAILROAD TRACK (BY CONTRACTOR)

PERM. CN TRACK 2
 STA. 1095+65.59 TO STA. 1100+89.07 = 523 TRK. FT.
 PERM. CN TRACK 1
 STA. 997+17.41 TO STA. 1003+67.74 = 650 TRK. FT.
 TOTAL = 1173 TRK. FT.

SUBBALLAST (BY CONTRACTOR)

PERM. CN TRACK 1
 STA. 998+57.36 TO 1001+76.02 = 483 TON
 PERM. CN TRACK 2
 STA. 1098+62.65 TO 1101+81.32 = 483 TON
 TOTAL = 966 TON

REMOVAL AND DISPOSAL OF UNSUITABLE MATERIAL (BY CONTRACTOR)

PERM. CN TRACK 1
 STA. 998+57.36 TO 1001+76.02 = 382 CU. YD.
 PERM. CN TRACK 2
 STA. 1098+62.65 TO 1101+81.32 = 382 CU. YD.
 TOTAL = 764 CU. YD.

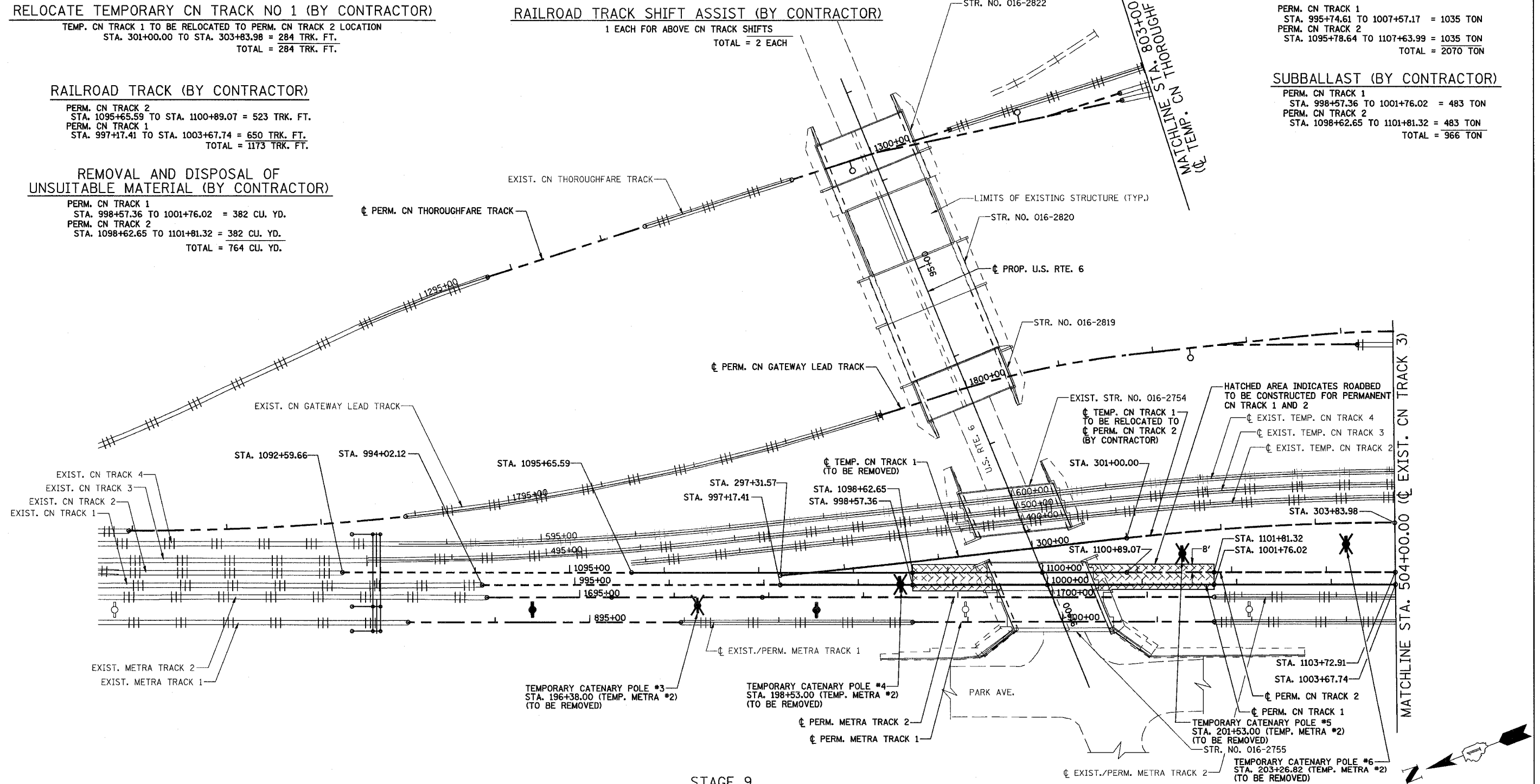

STAGE 9

NOTES:
 FOR STAGE 9 SUGGESTED TRACK CONSTRUCTION TASKS & SEQUENCING SEE SHEET 47.
 FOR AC/SCADA AND SIGNAL RELOCATION SEE METRA UTILITIES SHEETS.
 FOR SIGNAL CABLE RELOCATION SEE SIGNAL SHEETS.
 FOR LEGEND, SEE SHEET 21.

STAGE 9 WORK SUMMARY	
REMOVE TEMPORARY CATENARY STRUCTURES	
RECONSTRUCT AND SHIFT BACK CN TRACKS 1 AND 2	
CONSTRUCT EAST WINGWALLS OF BRIDGE	

REVISIONS	
NAME	DATE
REZ	10/19/07

ILLINOIS DEPARTMENT OF TRANSPORTATION
 US RTE 6 FROM I-294 TO IL RTE 1
 METRA & CN OVER 159TH STREET

TRACK CONSTRUCTION
 PLAN OF STAGE 9 WORK (NORTH)

SHT. 45 OF 88
 DATE 2/21/2008

DRAWN BY REZ
 CHECKED BY RMS

3/13/2008 2:09:50 PM q:\17049\069\Track & Rail Main Contract\FINAL PLANS\stg7new_1.dgn