

ROUTE NO.	SECTION	COUNTY	TOTAL SHEETS	SHEET NO
F.A.P. 351	2008-001VB	COOK	579	268
STA.	TO STA.			
FED. ROAD DIST. NO. 7	ILLINOIS	FED. AID PROJECT		
CONTRACT NO. 60E10				

THIS SHEET IS FOR REFERENCE ONLY.
(NO CONTRACTOR WORK)

LEGEND

- METRA SIGNAL CASE
- SIGNAL POWER CABLE (5C #9)
- SIGNAL CABLE (19C #14)
- RIGID GALVANIZED CONDUIT 4"
- EXISTING CATENARY SUPPORT STRUCTURE
- NEW CATENARY SUPPORT STRUCTURE

NOTES:

1. ALL SIGNAL WORK SHOWN ON THIS SHEET TO BE PERFORMED BY METRA BEFORE START OF PROJECT.
 2. ALL MATERIALS REQUIRED FOR WORK SHOWN ON THIS SHEET TO BE FURNISHED BY METRA BEFORE START OF PROJECT.
 3. SIGNAL WORK SHOWN FOR THIS PRESTAGE IS REQUIRED TO ELIMINATE CONFLICT OF EXISTING BURIED SIGNAL CABLE WITH PROPOSED CATENARY STRUCTURE FOUNDATIONS.
- APPROXIMATELY 3047' OF 19C #14 CABLE WILL BE PROVIDED BY METRA FOR THE WORK SHOWN ON THIS SHEET.

4/14/2008 11:43:48 AM

D:\17049\069\Signal Work for Metra\Plans\01_PRESTAGE_SIGNAL_ROUTING1.dgn

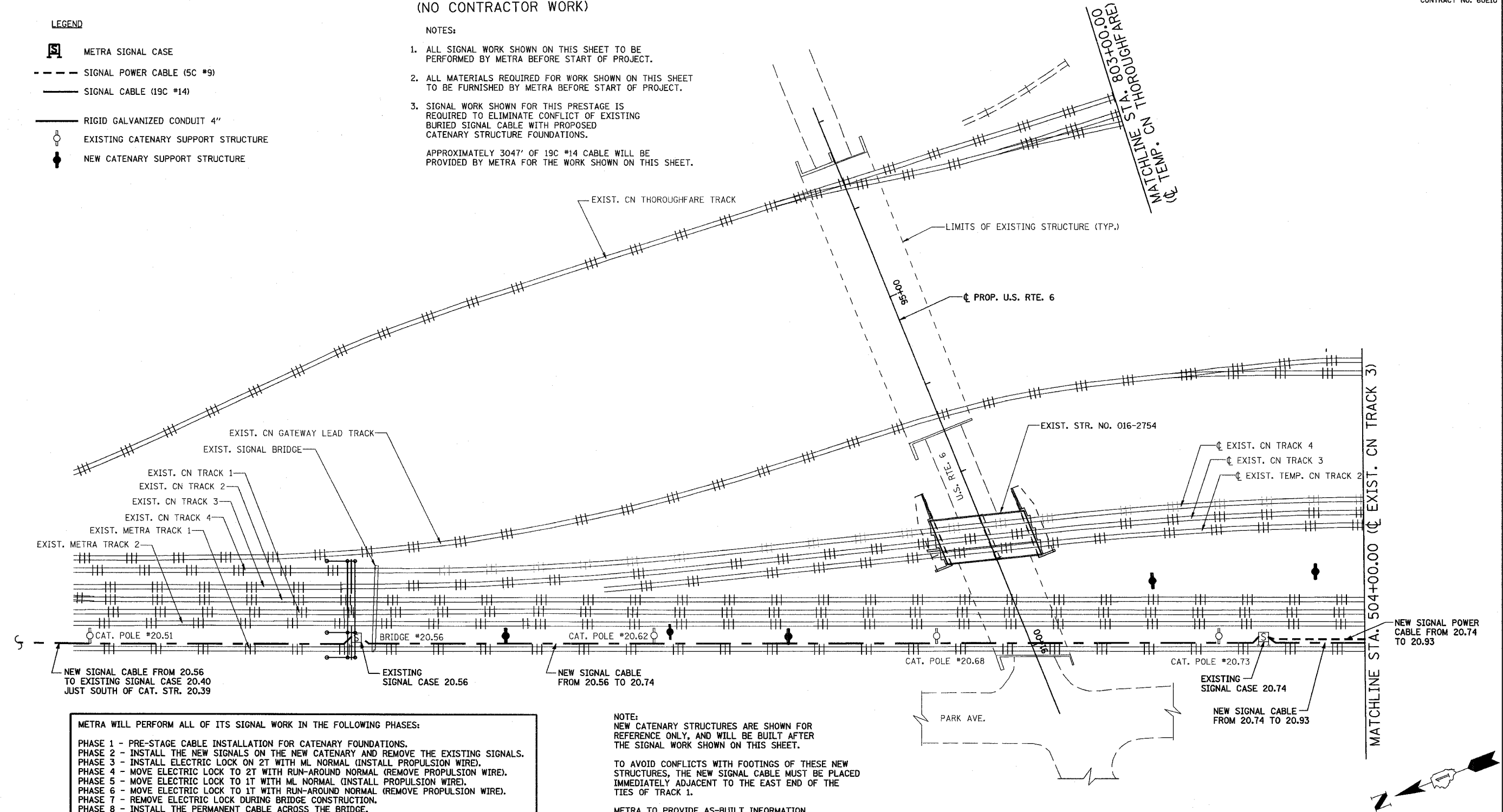

METRA WILL PERFORM ALL OF ITS SIGNAL WORK IN THE FOLLOWING PHASES:

PHASE 1 - PRE-STAGE CABLE INSTALLATION FOR CATENARY FOUNDATIONS.
 PHASE 2 - INSTALL THE NEW SIGNALS ON THE NEW CATENARY AND REMOVE THE EXISTING SIGNALS.
 PHASE 3 - INSTALL ELECTRIC LOCK ON 2T WITH ML NORMAL (INSTALL PROPULSION WIRE).
 PHASE 4 - MOVE ELECTRIC LOCK TO 2T WITH RUN-AROUND NORMAL (REMOVE PROPULSION WIRE).
 PHASE 5 - MOVE ELECTRIC LOCK TO 1T WITH ML NORMAL (INSTALL PROPULSION WIRE).
 PHASE 6 - MOVE ELECTRIC LOCK TO 1T WITH RUN-AROUND NORMAL (REMOVE PROPULSION WIRE).
 PHASE 7 - REMOVE ELECTRIC LOCK DURING BRIDGE CONSTRUCTION.
 PHASE 8 - INSTALL THE PERMANENT CABLE ACROSS THE BRIDGE.
 PHASE 9 - INSTALL ELECTRIC LOCK ON 1T WITH RUN-AROUND NORMAL (INSTALL PROPULSION WIRE).
 PHASE 10 - MOVE ELECTRIC LOCK TO 1T WITH ML NORMAL (REMOVE PROPULSION WIRE).
 PHASE 11 - MOVE ELECTRIC LOCK TO 2T WITH RUN-AROUND NORMAL (INSTALL PROPULSION WIRE).
 PHASE 12 - MOVE ELECTRIC LOCK TO 2T WITH ML NORMAL (REMOVE PROPULSION WIRE).
 PHASE 13 - REMOVE ELECTRIC LOCK (FINAL PLANS).

THE CONTRACTOR SHALL COORDINATE HIS SCHEDULE WITH METRA IN ORDER TO PROVIDE MATERIALS TO METRA AND ALLOW ADEQUATE TIME FOR METRA TO INSTALL THEM.

NOTE:
NEW CATENARY STRUCTURES ARE SHOWN FOR REFERENCE ONLY, AND WILL BE BUILT AFTER THE SIGNAL WORK SHOWN ON THIS SHEET.

TO AVOID CONFLICTS WITH FOOTINGS OF THESE NEW STRUCTURES, THE NEW SIGNAL CABLE MUST BE PLACED IMMEDIATELY ADJACENT TO THE EAST END OF THE TIES OF TRACK 1.

METRA TO PROVIDE AS-BUILT INFORMATION CONCERNING ACTUAL LOCATION OF THESE LINES.

REVISIONS	
NAME	DATE

ILLINOIS DEPARTMENT OF TRANSPORTATION
US RTE 6 FROM I-294 TO IL RTE 1
METRA OVER 159TH STREET

METRA SIGNALS
TEMP SIGNAL ROUTING (PRESTAGE-NORTH)

SHT. SG-01 OF SG-36
DATE 4/11/2008

DRAWN BY MAD
CHECKED BY AB