







4/14/2008 8:13:21 AM

q:\17049.069\signal work for metra\plans\03_signal_relocation1.dgn

CONTRACTOR-PROVIDED HARDWARE ASSOCIATED WITH SIGNAL RELOCATION AND CABLE RE-ROUTING

ROUTE NO.	SECTION	COUNTY	TOTAL SHEETS	SHEET NO
F.A.P. 351	2008-001VB	COOK	579	270
STA.		TO STA.		
FED. ROAD DIST. NO. 7		ILLINOIS	FED. AID PROJECT	
CONTRACT NO. 60E10				

LEGEND

-  METRA SIGNAL CASE
-  SIGNAL POWER CABLE (5C #9)
-  SIGNAL CABLE (19C #14)
-  METRA CONDUIT 4"
-  EXISTING CATENARY SUPPORT STRUCTURE
-  NEW CATENARY SUPPORT STRUCTURE

- NOTES:**
- ALL SIGNAL WORK SHOWN ON THIS SHEET TO BE PERFORMED BY METRA.
 - ALL MATERIALS REQUIRED FOR WORK SHOWN ON THIS SHEET TO BE FURNISHED BY THE CONTRACTOR.

ITEM	UNIT	QTY
SIGNALS METRA - 5C #9 POWER CABLE	LF	1,290
SIGNALS METRA - 19C #14 MULTI-CONDUCTOR CABLE	LF	2,705
SIGNALS METRA - CASE WIRE #10	LF	750
SIGNALS METRA - 2C #6 TRACK CABLE	LF	200
SIGNALS METRA - TRACK CIRCUIT RAIL CONNECTORS	EA	4
SIGNALS METRA - BOOTLEGS	EA	4
SIGNALS METRA - 2-5C #6 SIGNAL CABLE	LF	200
SIGNALS METRA - 3 LIGHT COLORLIGHT UNIT	EA	2
SIGNALS METRA - MISC. - W-10 TRANSFORMER	EA	2
SIGNALS METRA - MISC. - RECTIFIER (20 AMP)	EA	1
SIGNALS METRA - MISC. - RECTIFIER (40 AMP)	EA	1
SIGNALS METRA - MISC. - LIGHTNING ARRESTER	EA	2
SIGNALS METRA - MISC. - EQUALIZER	EA	2
SIGNALS METRA - MISC. - RESISTORS 5 WATT	EA	2
SIGNALS METRA - MISC. - FUSE 6 AMP	EA	2
SIGNALS METRA - MISC. - FUSE 30 AMP	EA	5
SIGNALS METRA - MISC. - FUSE 40 AMP	EA	2
SIGNALS METRA - RELAY CASE E	EA	2
SIGNALS METRA - VITAL RELAY (FN-27 FLASHER)	EA	1
SIGNALS METRA - VITAL RELAY (MODEL-15 SPEC1588 TRACK RELAY)	EA	1
SIGNALS METRA - VITAL RELAY (MODEL-15 SPEC 1989 TRACK RELAY)	EA	1
SIGNALS METRA - VITAL RELAY (DP-21 150 OHM HD RELAY)	EA	1
SIGNALS METRA - VITAL RELAY (DP-21 250 OHM HD RELAY)	EA	1
SIGNALS METRA - VITAL RELAY (ORDINARY ACTING 670 OHM 4FB RELAY)	EA	5
SIGNALS METRA - VITAL RELAY (SLOW ACTING 400 OHM RELAY)	EA	1
SIGNALS METRA - VITAL RELAY (SLV-13 POWER TRANSFER RELAY)	EA	1
SIGNALS METRA - SIGNAL CASE FOUNDATIONS	EA	4
SIGNALS METRA - INSULATED JOINT KIT	EA	4
SIGNALS METRA - NUMBER BOARDS	EA	2

NOTE:
ALL OF THE ABOVE ITEMS ARE STANDARD RAILROAD COMPONENTS USED BY METRA.
ALL OF THESE COMPONENTS SHALL BE PURCHASED FROM A METRA-APPROVED DISTRIBUTOR.

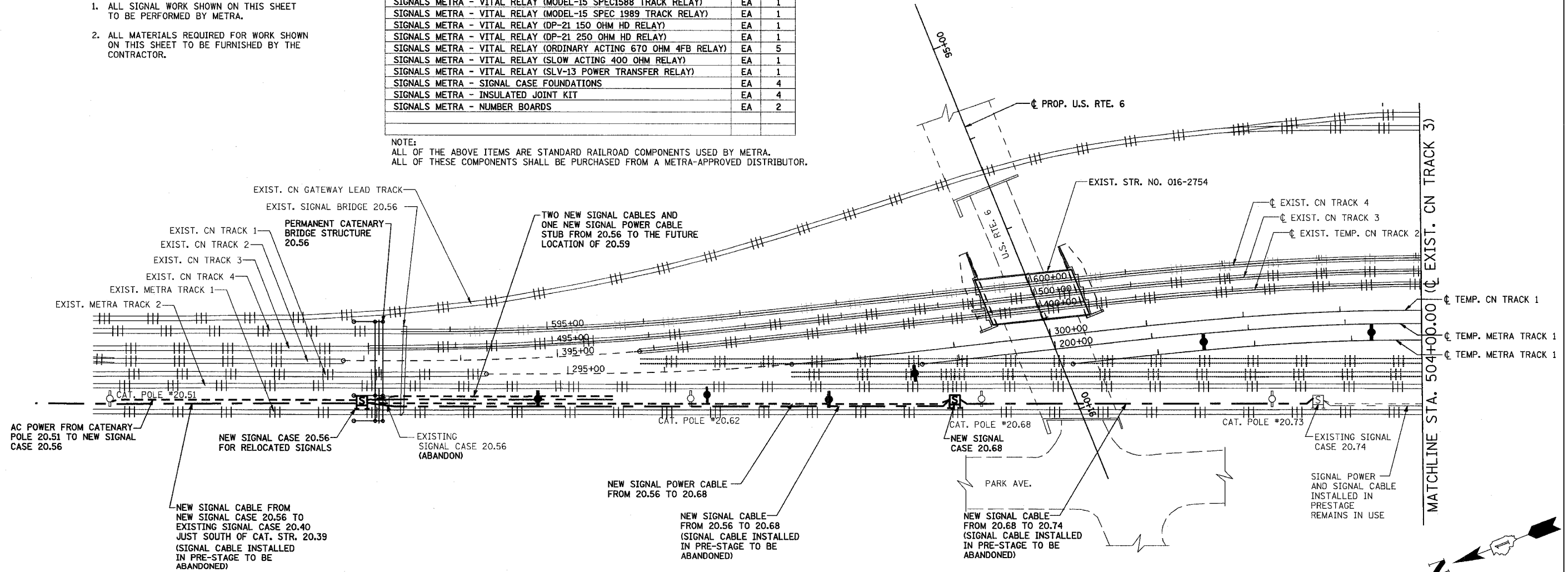

REVISIONS	
NAME	DATE

ILLINOIS DEPARTMENT OF TRANSPORTATION
US RTE 6 FROM I-294 TO IL RTE 1
METRA OVER 159TH STREET

**METRA SIGNALS
SIGNAL RELOCATION (NORTH)**

SHT. S6-03 OF S6-36 DRAWN BY MAD
DATE 4/11/2008 CHECKED BY AB