

STATE OF ILLINOIS
DEPARTMENT OF TRANSPORTATION

ROUTE NO.	SECTION	COUNTY	TOTAL SHEETS	SHEET NO.
F.A.P. 351	2008-001VB	COOK	579	470
FED. ROAD DIST. NO. 7		ILLINOIS	FED. AID PROJECT	

CONTRACT NO. 60E10

SHEET NO. 6
26 SHEETS

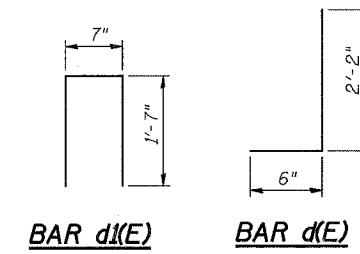
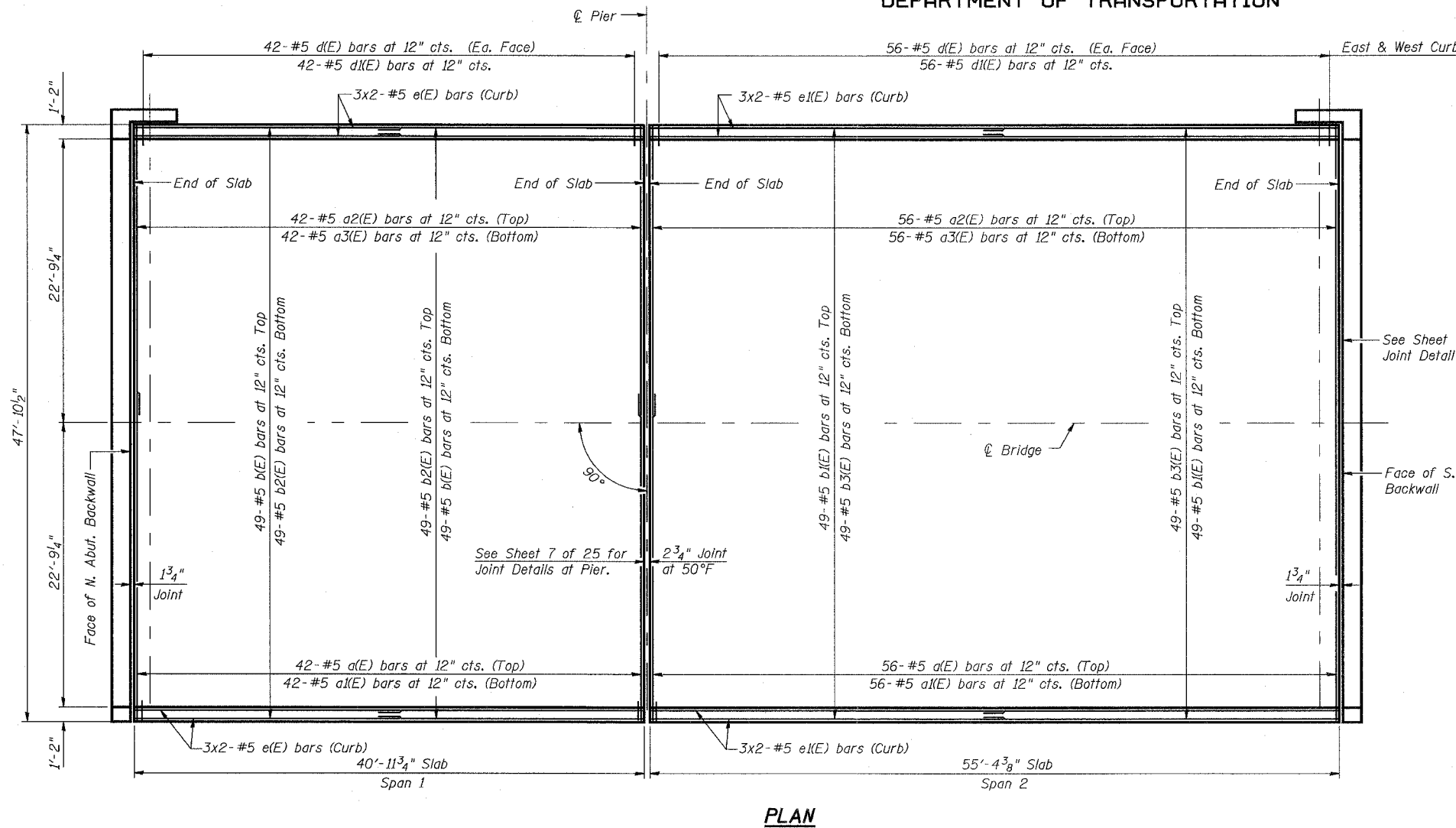

**SUPERSTRUCTURE
BILL OF MATERIAL**

Bar	No.	Size	Length	Shape
a(E)	98	#5	28'-11"	—
a1(E)	98	#5	19'-4"	—
a2(E)	98	#5	20'-8"	—
a3(E)	98	#5	30'-3"	—
b(E)	98	#5	15'-4"	—
b1(E)	98	#5	35'-0"	—
b2(E)	98	#5	27'-3"	—
b3(E)	98	#5	22'-0"	—
d(E)	392	#5	2'-8"	J
d1(E)	196	#5	3'-9"	□
e(E)	24	#5	21'-4"	—
e1(E)	24	#5	28'-6"	—
Concrete Superstructure			Cu. Yd.	158.0
Reinforcement Bars, Epoxy Coated			Pound	23,420
Membrane Waterproofing (Special)			Sq. Ft.	5,422

See Sheet 7 of 25 for Joint Detail at Abuts. (Typ.)

Face of S. Abut. Backwall

DETAIL 2

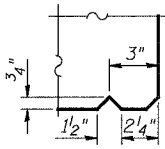

DETAIL 1

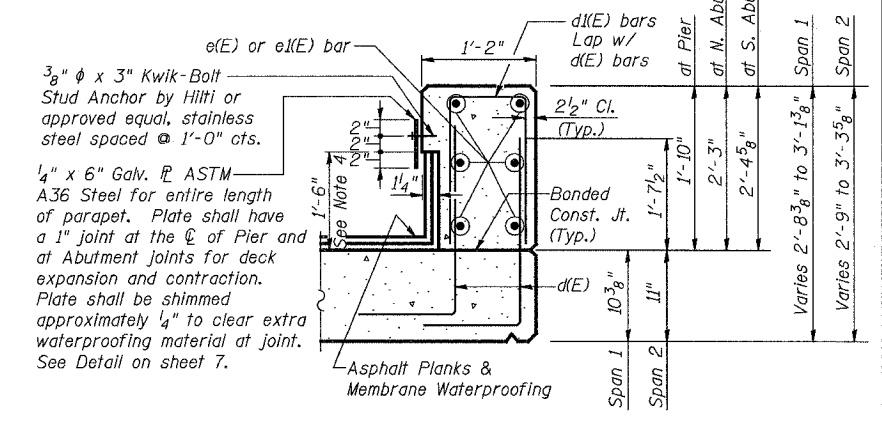

- Notes:
1. Reinforcement bars designated (E) shall be Epoxy Coated.
 2. Min. bar lap for a #5 bar shall be 2'-0".
 3. For Handrail Details see Sheet 8 of 25.
 4. Blockout for 3/32" Butyl Rubber Membrane and 2-1/2" Asphalt Planks.
 5. See Sheet 7 of 25 for Membrane Waterproofing Details at Joints.
 6. All exposed edges shall have 3/4" chamfer, except as noted.

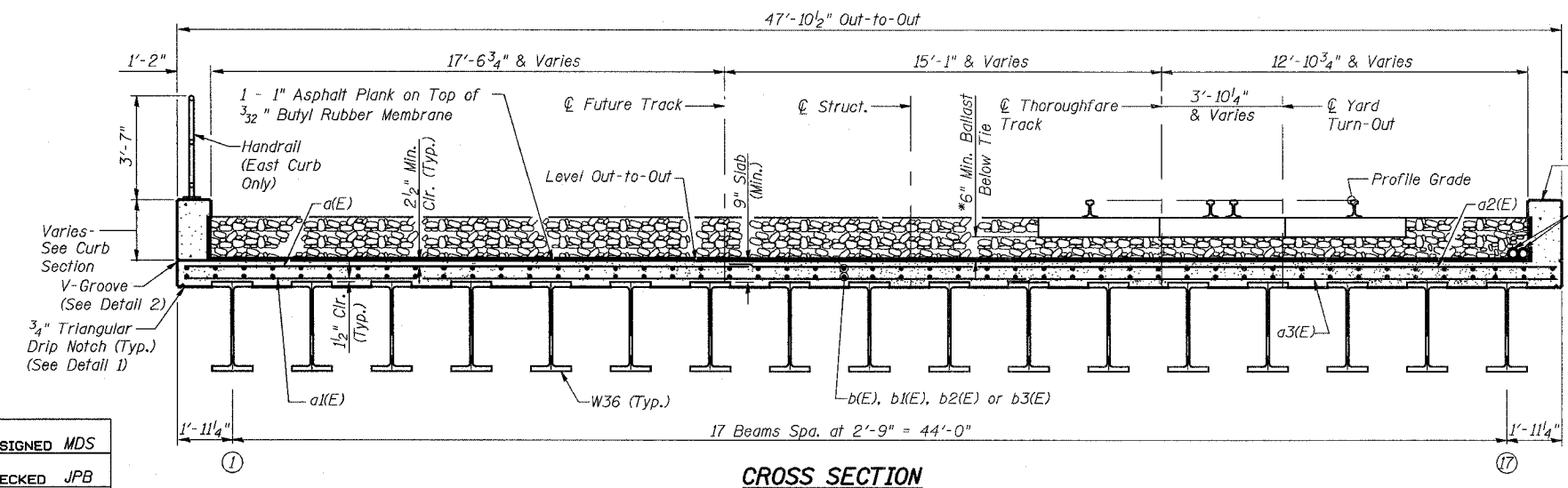

CROSS SECTION
(Looking South)

* 6" Min. Ballast at \O Pier
9" Min. Ballast at \O Bearings (Abut's)

3/13/2008 1:26:45 PM g:\17049\059\structures\2822.e.r\dwg\06.superstructure.dwg

DESIGNED	MDS
CHECKED	JPB
DRAWN	MDS
CHECKED	JPB

URS
100 South Wacker Drive,
Suite 500
Chicago, IL 60606
(312) 939-1000

REVISIONS	
NAME	DATE

ILLINOIS DEPARTMENT OF TRANSPORTATION
US RTE 6 FROM I-294 TO IL RTE 1
SUPERSTRUCTURE
CN THOROUGHFARE TRACK
BRIDGE 20.6E OVER U.S. RTE. 6 (159TH STREET)
STATION 96+36.66 STRUCTURE NO. 016-2822
SCALE: 3/16"=1'-0" DATE: 2/21/2008