

STATE OF ILLINOIS
DEPARTMENT OF TRANSPORTATION

ROUTE NO.	SECTION	COUNTY	TOTAL SHEETS	SHEET NO.
F.A.P. 351	2008-001VB	COOK	579	481
FED. ROAD DIST. NO. 7	ILLINOIS	FED. AID PROJECT-	CONTRACT NO. 60E10	

SHEET NO. 17
26 SHEETS

BILL OF MATERIAL - NORTH ABUTMENT

Bar	No.	Size	Length	Shape
h(E)	72	#5	25'-6"	—
h1(E)	6	#5	0'-11"	—
h2(E)	7	#5	5'-0"	—
h3(E)	7	#5	6'-8"	—
h4(E)	11	#5	19'-6"	—
h5(E)	10	#5	19'-2"	—
h6(E)	2	#5	22'-2"	—
h7(E)	28	#5	13'-11"	—
n1(E)	62	#5	6'-0"	—
n2(E)	21	#5	5'-0"	—
n3(E)	40	#7	6'-7"	—
n5(E)	265	#10	31'-11"	—
n6(E)	22	#10	17'-11"	—
n7(E)	100	#9	13'-3"	—
sp2	10	#5	27'-2"	
sp3	5	#5	28'-2"	
t(E)	66	#10	16'-2"	—
t1(E)	50	#6	16'-2"	—
t3(E)	17	#7	23'-1"	—
t4(E)	10	#5	23'-1"	—
u(E)	100	#5	8'-8"	—
u1(E)	2	#5	8'-9"	—
v(E)	47	#7	7'-4"	—
v1(E)	47	#5	6'-1"	—
v3(E)	12	#5	8'-7"	—
v4(E)	10	#5	19'-1"	—
v5(E)	20	#6	19'-1"	—
v6(E)	1	#5	15'-1"	—
v7(E)	1	#6	15'-1"	—
v8(E)	50	#5	8'-6"	—
v10(E)	14	#5	12'-10"	—
v11(E)	4	#10	12'-10"	—
v14(E)	2	#5	2'-3"	—
w(E)	72	#7	26'-2"	—
w1(E)	10	#5	19'-2"	—
w2(E)	10	#7	19'-2"	—
w3(E)	3	#5	19'-6"	—
w4(E)	3	#7	19'-6"	—
w5(E)	2	#5	20'-0"	—
Porous Granular Embankment		Cu. Yd.	378	
Concrete Structures		Cu. Yd.	277.6	
Reinforcement Bars		Lbs.	8,770	
Reinforcement Bars, Epoxy Coated		Lbs.	61,730	
Concrete Sealer		Sq. Ft.	180	
Braced Excavation		Cu. Yd.	457.4	
Non-Special Waste Disposal		Cu. Yd.	1102.7	
Geocomposite Wall Drain		Sq. Yd.	81.3	
Structure Excavation		Cu. Yd.	504.1	
Drilled Shaft in Soil		Cu. Yd.	174.0	
Drilled Shaft in Rock		Cu. Yd.	16.7	
Permanent Steel Sheet Piling		Sq. Ft.	1,036	

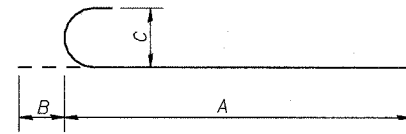

BARS nx(E)

Bar	A	B	C
n1(E)	5'-5"	7"	5"
n2(E)	4'-5"	7"	5"
n3(E)	5'-9"	10"	7"
n5(E)	30'-6"	1'-5"	1'-1 1/4"
n6(E)	16'-6"	1'-5"	1'-1 1/2"
n7(E)	12'-0"	1'-3"	11 3/4"

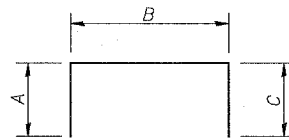

BARS u(E) & u1(E)

Bar	A	B	C
u(E)	2'-0"	4'-8"	2'-0"
u1(E)	4'-1"	7"	4'-1"

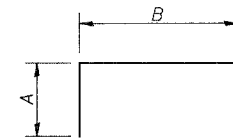

BARS h2(E) & h3(E)

Bar	A	B
h2(E)	1'-3"	3'-9"
h3(E)	2'-0"	4'-8"

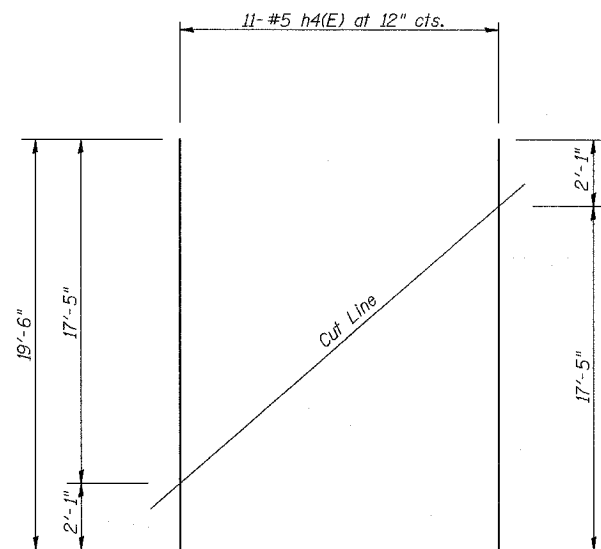

FIELD CUTTING DIAGRAM #1

Order bars full length. Cut bars in field as shown. Use top half in F.F. and bottom half in B.F. for h4(E) bars.

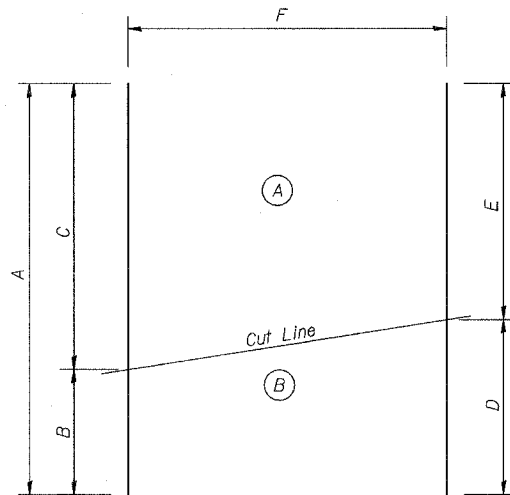

FIELD CUTTING DIAGRAM #2

Order bars full length. Cut bars in field as shown. Place patterns (A) & (B) side by side as shown on sheet 16 for tx(E) bars, sheet 13 for vx(E) bars and sheet 16 for wx(E) bars.

Bar	A	B	C	D	E	F
t3(E)	23'-1"	8'-8"	14'-5"	11'-4"	11'-8"	17'-#7 bars at 7" cts.
t4(E)	23'-1"	8'-8"	14'-5"	11'-4"	11'-8"	10-#5 bars at 12" cts.
v4(E)	19'-1"	3'-10"	15'-3"	9'-3"	9'-10"	10-#5 bars at 12" cts.
v5(E)	19'-1"	3'-10"	15'-3"	9'-4"	9'-9"	20-#6 bars at 6" cts.
w3(E)	19'-6"	1'-3"	18'-3"	8'-0"	11'-6"	3-#5 bars at 12" cts.
w4(E)	19'-6"	1'-3"	18'-3"	8'-0"	11'-6"	3-#7 bars at 12" cts.

NOTES:

Place backfill behind sidewalk retaining wall prior to backfilling behind abutment and abutment retaining wall.

Bars designated (E) shall be epoxy coated.

Length of Spiral given is Height of Spiral. Weight includes Weight of Spacers for Spiral.

3/13/2008 1:26:51 PM G:\17049_069\structures\2822_e-r\dwg\17_n-abut.bom.dgn

DESIGNED	MDS
CHECKED	JPB
DRAWN	MDS
CHECKED	JPB

URS
100 South Wacker Drive,
Suite 500
Chicago, IL 60606
(312) 939-1000

REVISIONS	
NAME	DATE

ILLINOIS DEPARTMENT OF TRANSPORTATION
US RTE 6 FROM I-294 TO IL RTE 1
**NORTH ABUTMENT
DETAILS III**
CN THOROUGHFARE TRACK
BRIDGE 20.6E OVER U.S. RTE. 6 (159TH STREET)
STATION 96+36.66 STRUCTURE NO. 016-2822
SCALE: N.T.S. DATE: 2/21/2008