

| | | | | |
|---------------------|---------------------------|--------|--------------|-----------|
| F.A.P. RTE. | SECTION | COUNTY | TOTAL SHEETS | SHEET NO. |
| 351 | 2008-001VB | COOK | 579 | 491 |
| STA. | TO STA. | | | |
| FED. ROAD DIST. NO. | ILLINOIS FED. AID PROJECT | | | |
| CONTRACT NO. 60E10 | | | | |

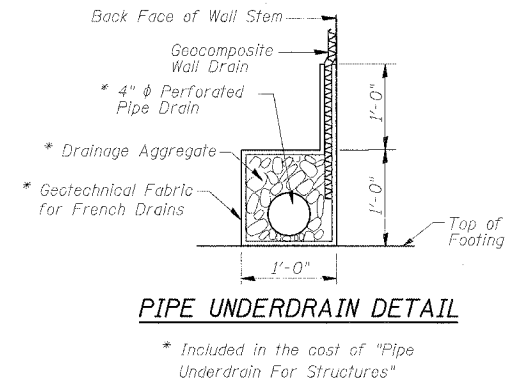
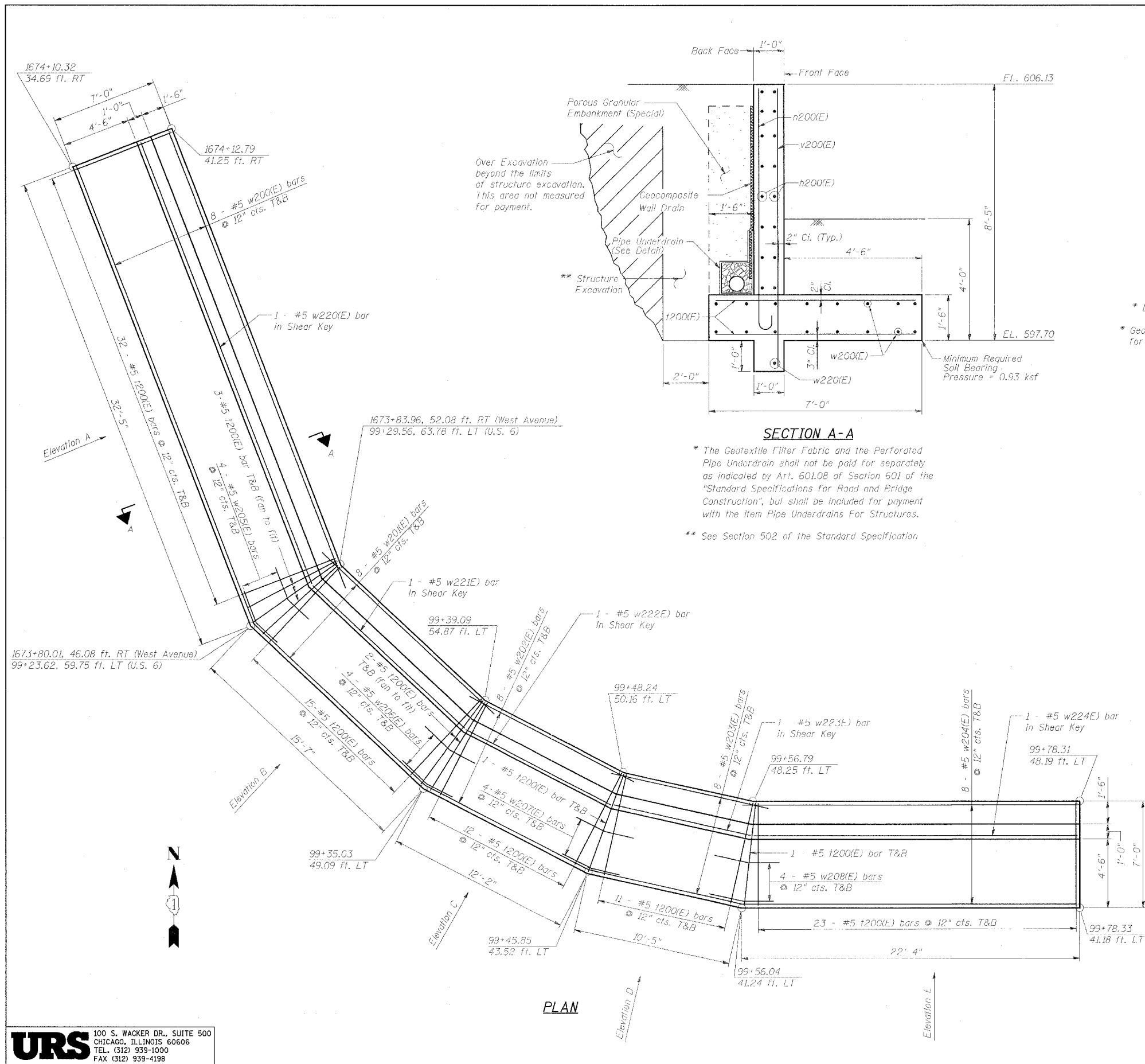

SECTION A-A

* The Geotextile Filter Fabric and the Perforated Pipe Underdrain shall not be paid for separately as indicated by Art. 601.08 of Section 601 of the "Standard Specifications for Road and Bridge Construction", but shall be included for payment with the item Pipe Underdrains For Structures.

** See Section 502 of the Standard Specification

LEGEND:

F.F. = Front Face
 B.F. = Back Face
 E.F. = Each Face
 T&B = Top and Bottom

NOTES:

1. Work this Sheet with Sheets R2 & R3.
2. See Sheet R2 for Wall Plan and Sections B-B and C-C.
3. See Sheet R3 for Elevations and Bill of Materials.
4. Reinforcement bars designated (E) shall be epoxy coated.
5. Concrete clear cover shall be 2" minimum unless noted otherwise.
6. All edges shall have standard 3/4" chamfers except as noted.
7. Min. Lap for Bar #5 = 2'-2"

INDEX OF SHEETS:

- R1 West Ave. Retaining Wall - General Plan & Cross Sections
- R2 West Ave. Retaining Wall - Wall Plan
- R3 West Ave. Retaining Wall - Elevations & Bill of Materials
- R4 Park Ave. Retaining Wall - Location Plan
- R5 Park Ave. Retaining Wall - Sta. 1346+78.21 to Sta. 1347+30.70
- R6 Park Ave. Retaining Wall - Sta. 1346+22.43 to Sta. 1346+78.21
- R7 Park Ave. Retaining Wall - Sta. 1343+82.93 to Sta. 1344+48.55
- R8 Park Ave. Retaining Wall - Sta. 1343+50.12 to Sta. 1343+82.93
- R9 Park Ave. Retaining Wall - Sta. 1342+84.51 to Sta. 1343+50.12
- R10 Park Ave. Retaining Wall - Railing Details
- R11 US Rte 6 & Park Ave. NW Ret. Wall - Sheet 1 of 2
- R12 US Rte 6 & Park Ave. NW Ret. Wall - Sheet 2 of 2

SHEET R1 OF R12

URS 100 S. WACKER DR., SUITE 500
 CHICAGO, ILLINOIS 60606
 TEL. (312) 939-1000
 FAX (312) 939-4196

| REVISIONS | | ILLINOIS DEPARTMENT OF TRANSPORTATION US RTE 6 FROM LEXINGTON AVE TO FISK AVE |
|-----------|------|--|
| NAME | DATE | |
| | | WEST AVENUE RETAINING WALL GENERAL PLAN & CROSS SECTIONS |
| | | |
| | | |
| | | |
| | | |
| | | DRAWN BY MAD |
| | | CHECKED BY JPB |
| | | DATE 02/21/08 |