

STATE OF ILLINOIS
DEPARTMENT OF TRANSPORTATION

ROUTE NO.	SECTION	COUNTY	TOTAL SHEETS	SHEET NO.
F.A.P. 351	2008-001VB	COOK	579	504
FED. ROAD DIST. NO. 7	ILLINOIS	FED. AID PROJECT-	CONTRACT NO. 60E10	

SHEET NO. 2
24 SHEETS

- ① 7 - #5 v102(E) bars @ 12" cts. F.F. (Trim to Fit)
- ② 7 - #5 v103(E) bars @ 12" cts. B.F. (Trim to Fit)

For Continuation See
Existing Retaining Wall
Sta. 92+10.93
End of Wall "A"

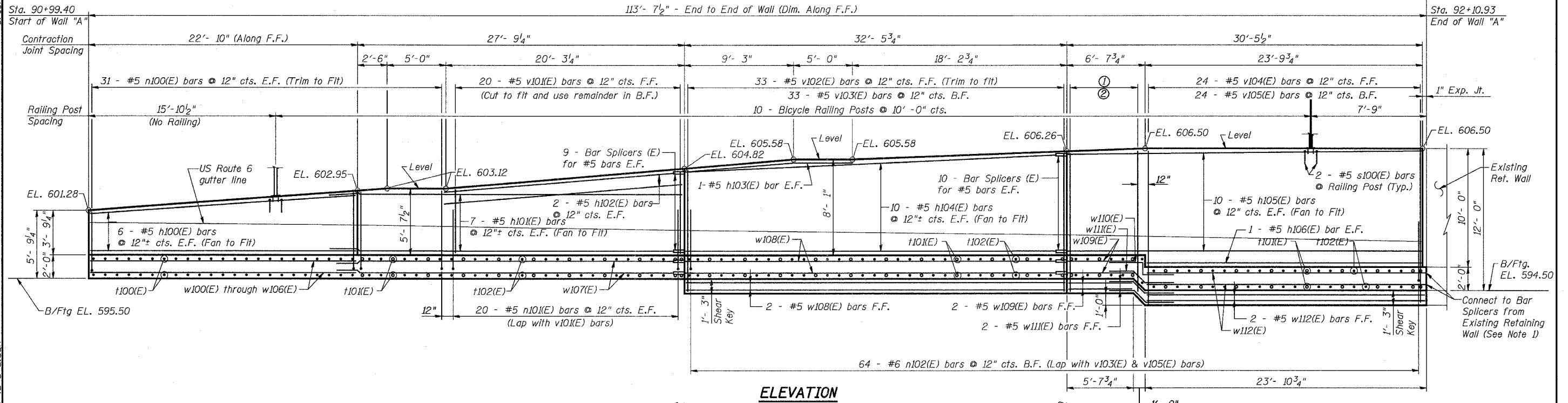

ELEVATION

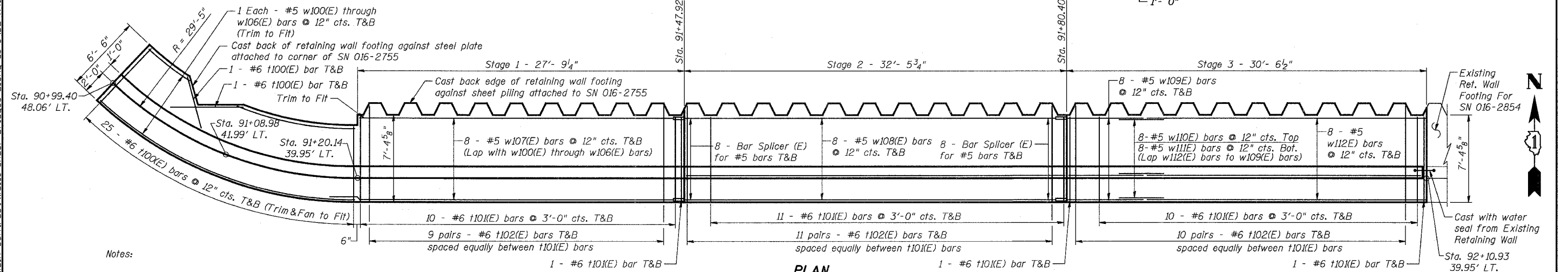

PLAN

(Showing footing & shear key reinforcement)
(Wall reinforcement has been omitted for clarity)

Notes:

- See sheet 23 for details of Bicycle Railing
- The remainder of the bar splicers used in the existing retaining wall were given to I.D.O.T. for storage and will be provided by I.D.O.T. for this contract.
- Minimum Bar Laps are as follows:
#5 = 2'-2"
#6 = 2'-7"
- Work this sheet with Sheet 3.
- For Cross-sections, Bar bend diagrams, Bar Bill & Bill of Materials, see Sheet 3.

Legend:
F.F. = Front Face
B.F. = Back Face
E.F. = Each Face
T&B = Top & Bottom

URS
100 South Wacker Drive,
Suite 500
Chicago, IL 60606
(312) 939-1000

REVISIONS	
NAME	DATE

ILLINOIS DEPARTMENT OF TRANSPORTATION
US RTE 6 FROM I-294 TO IL RTE 1
RETAINING WALL "A"
STA. 90+99.40 TO 92+10.93
US. 6 MAINLINE RETAINING WALLS
ALONG 159TH STREET

SCALE: DATE: 2/21/2008

3/13/2008 5:50:01 PM G:\17049\659\structures\retainna walls\main contract\walls under bridges along us 6\02_n91-92_a.dgn

DESIGNED MAD
CHECKED JPB
DRAWN MAD
CHECKED DEY