

STATE OF ILLINOIS
DEPARTMENT OF TRANSPORTATION

ROUTE NO.	SECTION	COUNTY	TOTAL SHEETS	SHEET NO.
F.A.P. 351	2008-001VB	COOK	579	56
FED. ROAD DIST. NO. 7	ILLINOIS	FED. AID PROJECT-	CONTRACT NO. 60E10	

SHEET NO. 14
24 SHEETS

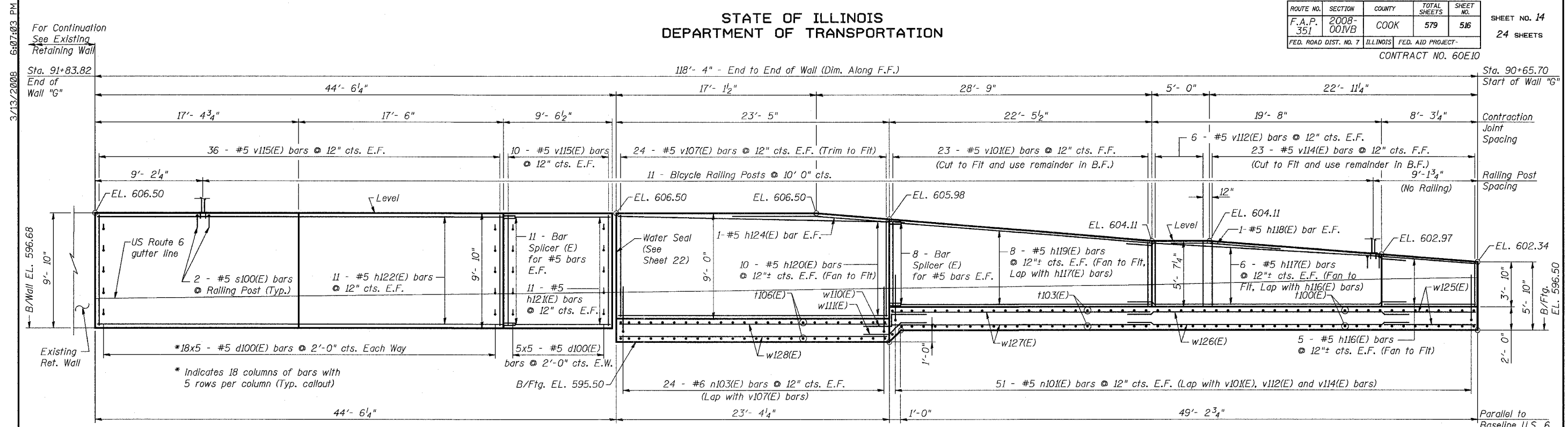

ELEVATION
(Dim. Along F.F. of Wall)

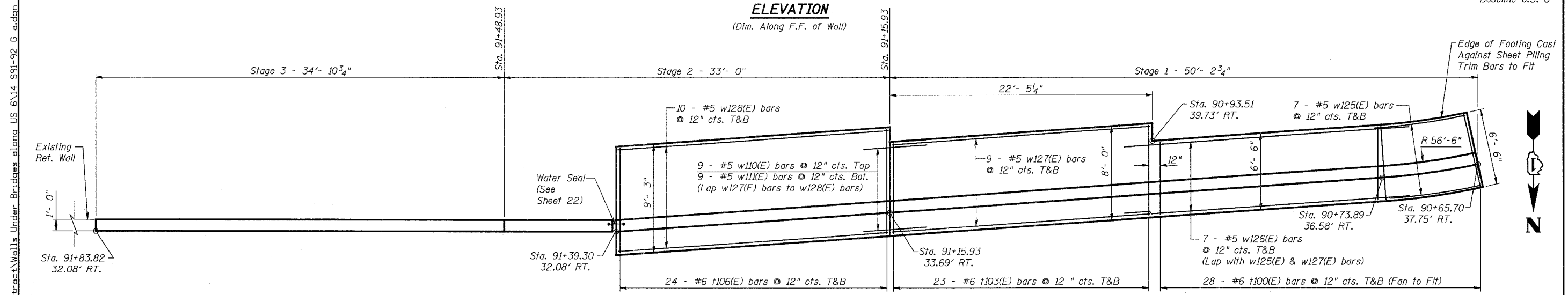

PLAN
(Showing footing reinforcement)
(Wall reinforcement has been omitted for clarity)

- Notes:
- The remainder of the bar splicers used in the existing retaining wall were given to I.D.O.T. for storage and will be provided by I.D.O.T. for this contract.
 - Minimum Bar Laps are as follows:
#5 = 2'-2"
#6 = 2'-7"
 - Work this sheet with Sheet 15.
 - Contractor to place contraction joints at location of existing construction joints.
 - For details of Bicycle Railing, see Sheet 23.
 - Bars indicated thus: 2x5 - #5 etc. indicates 2 lines of bars with 5 lengths of bar per line.

Legend:
F.F. = Front Face
B.F. = Back Face
E.F. = Each Face
T&B = Top & Bottom
E.W. = Each Way

DESIGNED MAD
CHECKED JPB
DRAWN MDS
CHECKED DEY

REVISIONS	
NAME	DATE

ILLINOIS DEPARTMENT OF TRANSPORTATION
US RTE 6 FROM I-294 TO IL RTE 1
RETAINING WALL "G"
STA. 90+65.70 TO 91+83.82
U.S. 6 MAINLINE RETAINING WALLS
ALONG 159TH STREET
SCALE: DATE: 2/21/2008

URS
100 South Wacker Drive,
Suite 500
Chicago, IL 60606
(312) 939-1000

3/13/2008 6:07:03 PM
D:\17049\068\structures\Retaining Walls\Main Contract\Walls Under Bridges along US 6\14 S91-92 G aden