

HOT-MIX ASPHALT SURFACE REMOVAL, 2 1/2"  
 POLYMERIZED LEVELING BINDER (MACHINE METHOD), IL-4.75, N50, 3/4"  
 POLYMERIZED HOT-MIX ASPHALT SURFACE COURSE, MIX "F", N90 (IL-9.5 mm), 1 3/4"

PROJECT BEGINS STA. 0+00

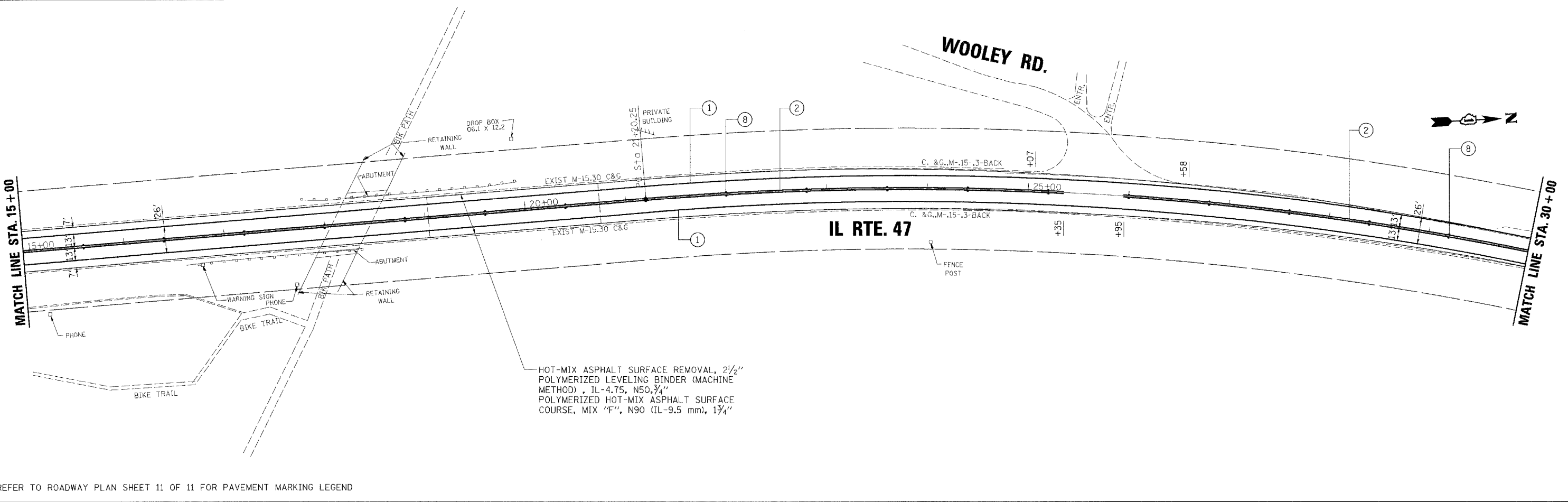
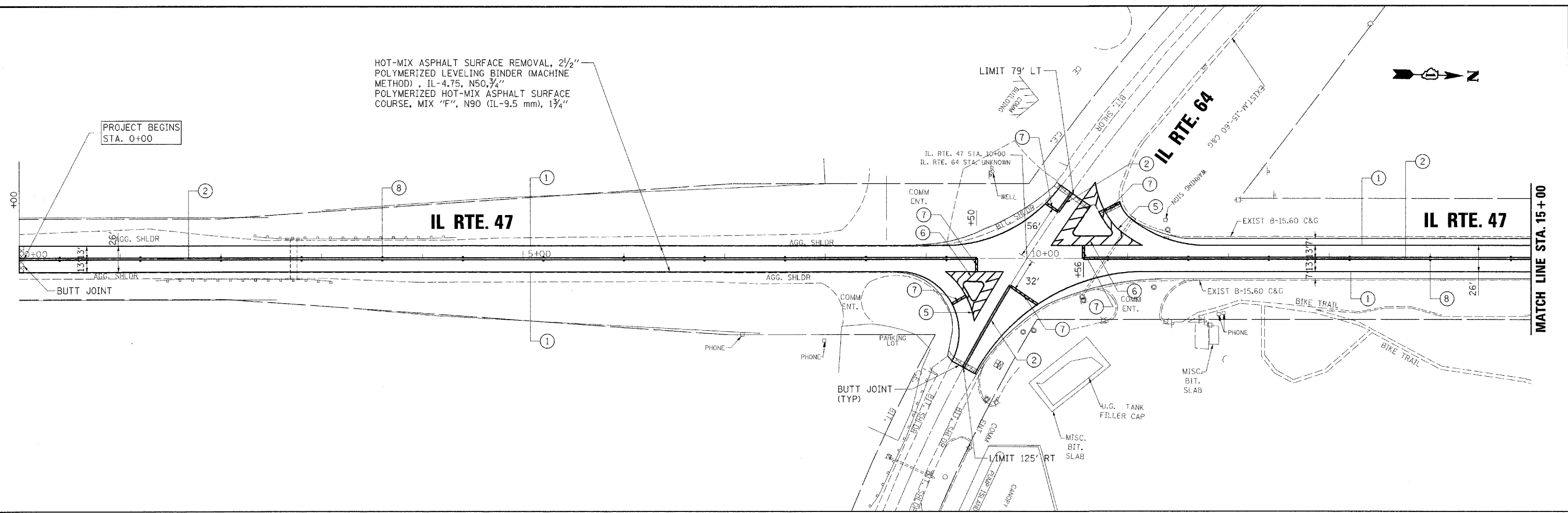

HOT-MIX ASPHALT SURFACE REMOVAL, 2 1/2"  
 POLYMERIZED LEVELING BINDER (MACHINE METHOD), IL-4.75, N50, 3/4"  
 POLYMERIZED HOT-MIX ASPHALT SURFACE COURSE, MIX "F", N90 (IL-9.5 mm), 1 3/4"

REFER TO ROADWAY PLAN SHEET 11 OF 11 FOR PAVEMENT MARKING LEGEND

PLOT DATE = 4/18/2008  
 FILE NAME = k:\11225504\asv\1\sheet\11225504-Pl\_01.dgn  
 PLOT SCALE = 1"=50'  
 MODEL = E:\asv\1\sheet\11225504-Pl\_01.dgn  
 MODEL = E:\asv\1\sheet\11225504-Pl\_01.dgn

**rjngroup**  
 Excellence through Ownership  
 200 West Front Street  
 Wheaton, IL 60187

DESIGNED	- LCM	REVISED	-
DRAWN	- JMT	REVISED	-
CHECKED	- BLB	REVISED	-
DATE	- 3/28/08	REVISED	-

**STATE OF ILLINOIS  
 DEPARTMENT OF TRANSPORTATION**

**IL ROUTE 47  
 EXISTING & PROPOSED ROADWAY PLAN**

SCALE: 1"=50' SHEET NO. 1 OF 11 SHEETS STA. 0+00 TO STA. 30+00

F.A.P. RTE. 326	SECTION 106X-RS-6	COUNTY KANE	TOTAL SHEETS 23	SHEET NO. 6
CONTRACT NO. 60E19				
FED. ROAD DIST. NO. 1 ILLINOIS FED. AID PROJECT				