

TYPICAL ENTRANCE/EXIT RAMP COMBINATION PAVEMENT MARKINGS

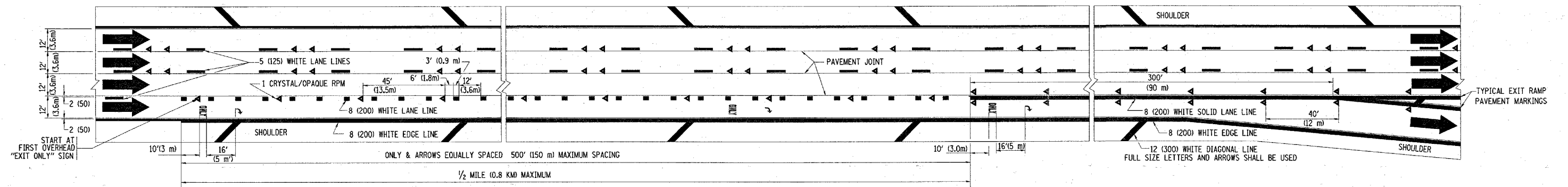

TYPICAL EXIT ONLY LANE PAVEMENT MARKINGS

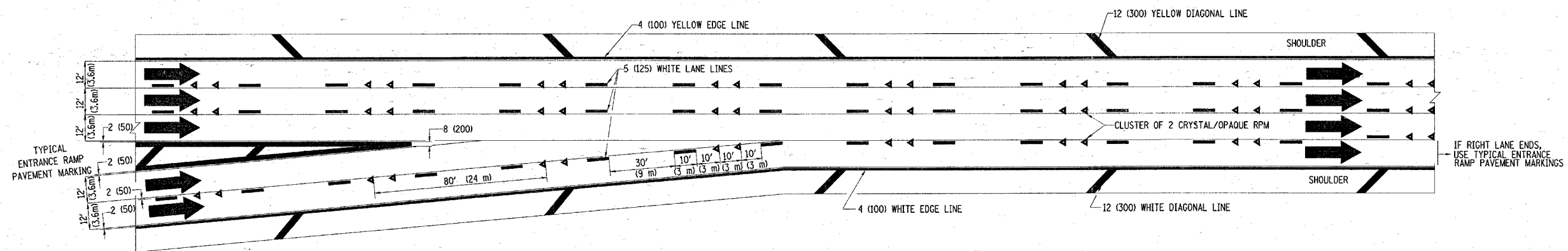

TYPICAL TWO LANE ENTRANCE RAMP PAVEMENT MARKINGS

FILE NAME = W:\dists\std\22x34\tot2.dgn	USER NAME = hamdanah	DESIGNED - D.W.S.	REVISED - A.H. 03-96	STATE OF ILLINOIS DEPARTMENT OF TRANSPORTATION	MULTI-LANE FREEWAY PAVEMENT MARKING DETAILS		F.A.P. RTE.	SECTION	COUNTY	TOTAL SHEETS	SHEET NO.
	PLOT SCALE = 50,000 1" IN.	DRAWN -	REVISED - D.W.S. 07-96				342 (530 & 531) RS-4	COOK	31	27	
	PLOT DATE = 4/16/2008	CHECKED -	REVISED - J.A.F. 02-06				TC-12		CONTRACT NO. 62079		
	DATE - 01-90	REVISED - S.P.B. 01-07		SCALE: NONE	SHEET NO. 1 OF 2 SHEETS	STA. TO STA.	FED. ROAD DIST. NO. 1 ILLINOIS FED. AID PROJECT				