

| F.A.P. RTE. | SECTION | COUNTY | TOTAL SHEETS | SHEET NO. |
|---------------------|---------|---------------------------|--------------|-----------|
| 348 | * | COOK | 86 | 78 |
| STA. 10+20 R-2 | | TO STA. 10+00 R-3 | | |
| FED. ROAD DIST. NO. | | ILLINOIS FED. AID PROJECT | | |

* (1214 & 3127-1) R5-1

*REF-plan01
*REF-plan08

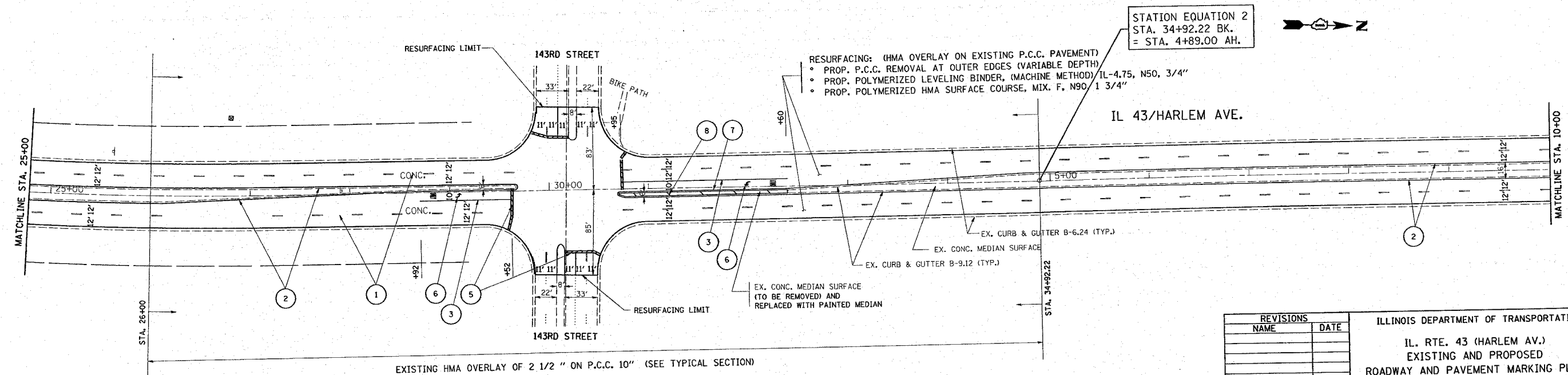
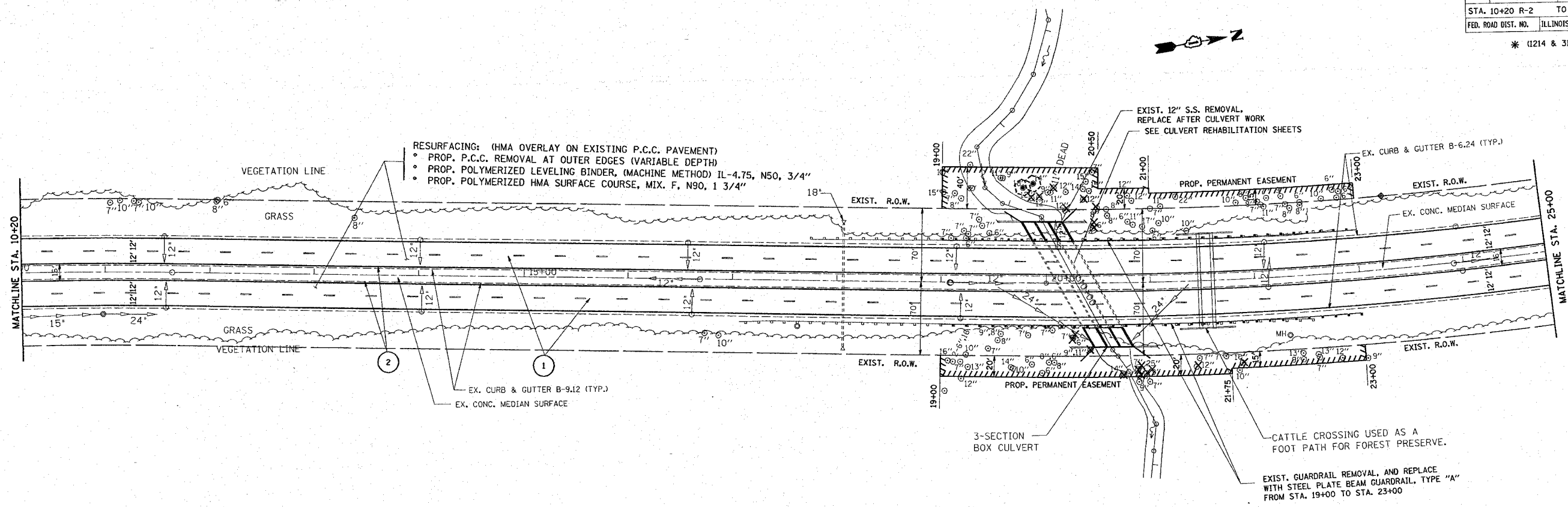

| REVISIONS | |
|-----------|------|
| NAME | DATE |
| | |
| | |
| | |
| | |
| | |
| | |
| | |
| | |
| | |

ILLINOIS DEPARTMENT OF TRANSPORTATION

IL. RTE. 43 (HARLEM AV.)
EXISTING AND PROPOSED
ROADWAY AND PAVEMENT MARKING PLAN
U.S. 6 TO IL. RTE. 7

SCALE: VERT. 1" = 50'
HORIZ. 1" = 50'

DATE 12/13/2007

DRAWN BY
CHECKED BY

PLOT DATE = 12/13/2007
FILE NAME = c:\pav\proj\ta\143rd\ah_rdg.dgn
PLOT SCALE = 1/8" = 10' / IN.
USER NAME = dr\veloeng