

*REF-plan7
*REF-plan8

CONTRACT NO. 62343			
F.A.P. RTE.	SECTION	COUNTY	TOTAL SHEETS
348	*	COOK	86
STA. 130+00		TO STA. 160+00	
FED. ROAD DIST. NO.	ILLINOIS	FED. AID PROJECT	

* (1214 & 3127-1) RS-1

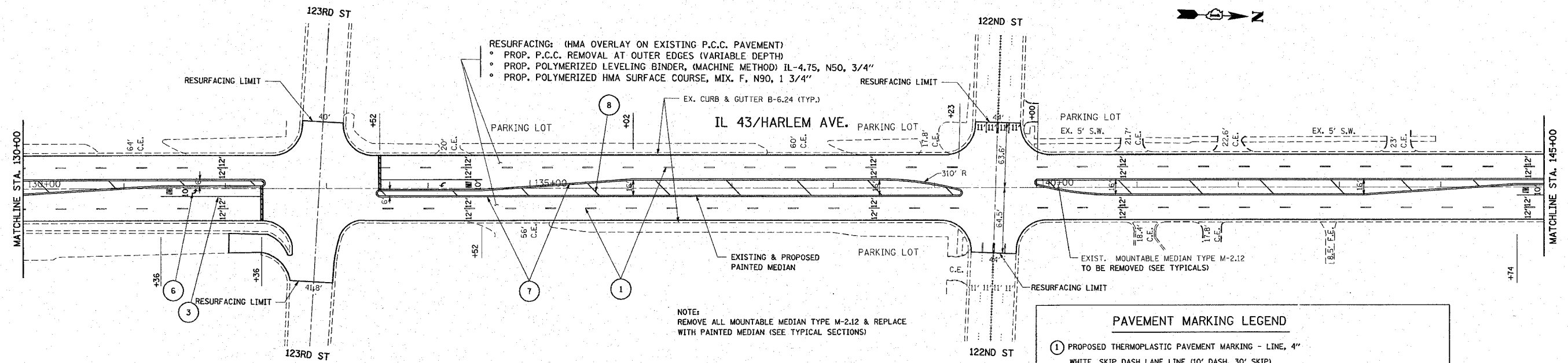

PAVEMENT MARKING LEGEND	
①	PROPOSED THERMOPLASTIC PAVEMENT MARKING - LINE, 4" WHITE, SKIP DASH LANE LINE (10' DASH, 30' SKIP)
②	PROPOSED THERMOPLASTIC PAVEMENT MARKING - LINE, 4" SOLID YELLOW
③	PROPOSED THERMOPLASTIC PAVEMENT MARKING - LINE, 6" SOLID WHITE, TURN LANE
④	PROPOSED THERMOPLASTIC PAVEMENT MARKING - LINE, 12" WHITE DIAGONALS @ 75' C-C
⑤	PROPOSED THERMOPLASTIC PAVEMENT MARKING - LINE, 24" WHITE, STOP BAR
⑥	PROPOSED THERMOPLASTIC PAVEMENT MARKING - LETTERS AND SYMBOLS
⑦	PROPOSED THERMOPLASTIC PAVEMENT MARKING - LINE, 4" SOLID DOUBLE YELLOW @ 11" C-C, FOR PAINTED MEDIAN
⑧	PROPOSED THERMOPLASTIC PAVEMENT MARKING - LINE, 12" YELLOW DIAGONALS @ 75' C-C

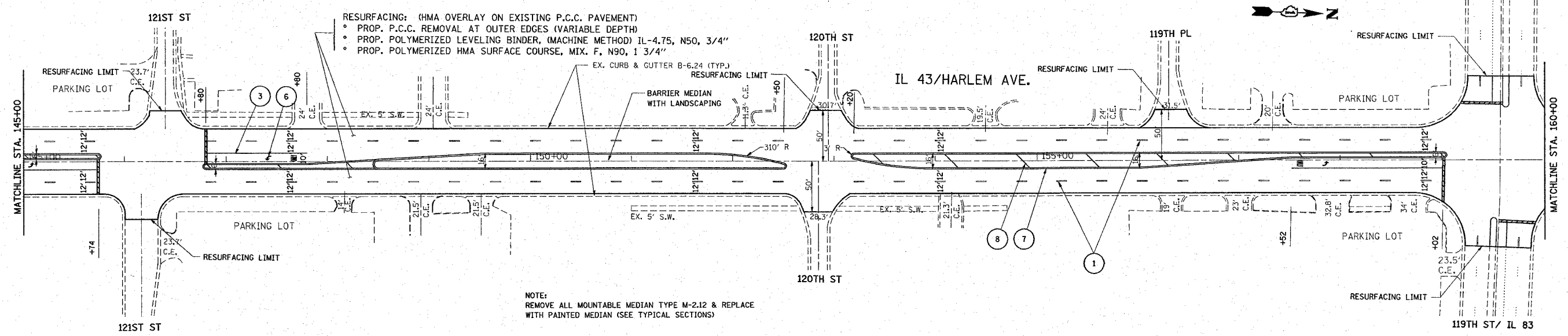

REVISIONS	
NAME	DATE

ILLINOIS DEPARTMENT OF TRANSPORTATION

IL. RTE. 43 (HARLEM AV.)
EXISTING AND PROPOSED
ROADWAY AND PAVEMENT MARKING PLAN
U.S. 6 TO IL. RTE. 7

SCALE: VERT. 1" = 50'
HORIZ. DATE 12/12/2007

DRAWN BY
CHECKED BY

PLOT DATE = 12/12/2007
 FILE NAME = c:\projects\145281\h_rdw.dgn
 PLOT SCALE = 80.0000 / IN.
 USER NAME = drvelocean