

CONTRACT NO. 62343				
F.A.P. RTE.	SECTION	COUNTY	TOTAL SHEETS	SHEET NO.
348	*	COOK	86	25
STA. 190+00		TO STA. 220+00		
FED. ROAD DIST. NO.	ILLINOIS	FED. AID PROJECT		

* (1214 & 3127-1) RS-1

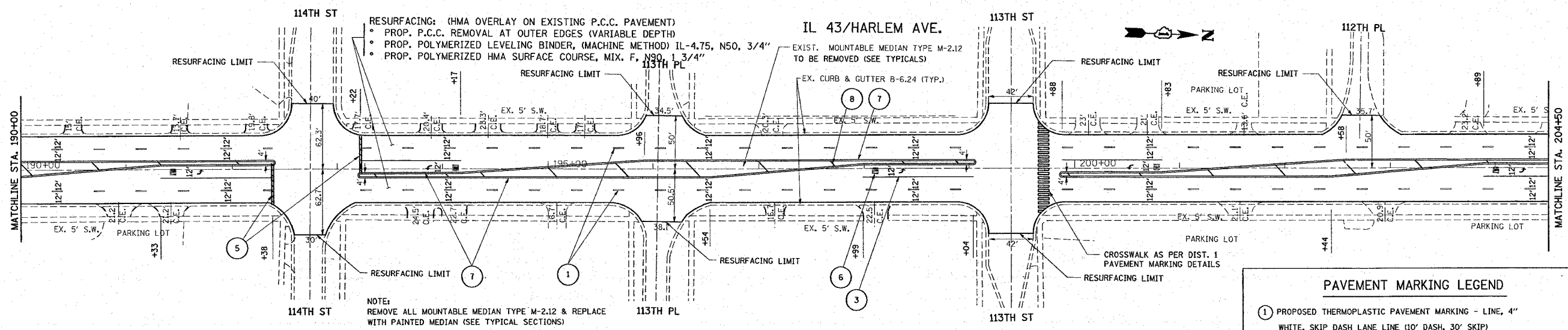

PAVEMENT MARKING LEGEND

- ① PROPOSED THERMOPLASTIC PAVEMENT MARKING - LINE, 4" WHITE, SKIP DASH LANE LINE (10' DASH, 30' SKIP)
- ② PROPOSED THERMOPLASTIC PAVEMENT MARKING - LINE, 4" SOLID YELLOW
- ③ PROPOSED THERMOPLASTIC PAVEMENT MARKING - LINE, 6" SOLID WHITE, TURN LANE
- ④ PROPOSED THERMOPLASTIC PAVEMENT MARKING - LINE, 12" WHITE DIAGONALS @ 75' C-C
- ⑤ PROPOSED THERMOPLASTIC PAVEMENT MARKING - LINE, 24" WHITE, STOP BAR
- ⑥ PROPOSED THERMOPLASTIC PAVEMENT MARKING - LETTERS AND SYMBOLS
- ⑦ PROPOSED THERMOPLASTIC PAVEMENT MARKING - LINE, 4" SOLID DOUBLE YELLOW @ 11" C-C, FOR PAINTED MEDIAN
- ⑧ PROPOSED THERMOPLASTIC PAVEMENT MARKING - LINE, 12" YELLOW DIAGONALS @ 75' C-C
- ⑩ PROPOSED THERMOPLASTIC PAVEMENT MARKING - DIAGONAL LINE, 4" WHITE, 5' SPACING (IN FRONT OF FIRE STATION)

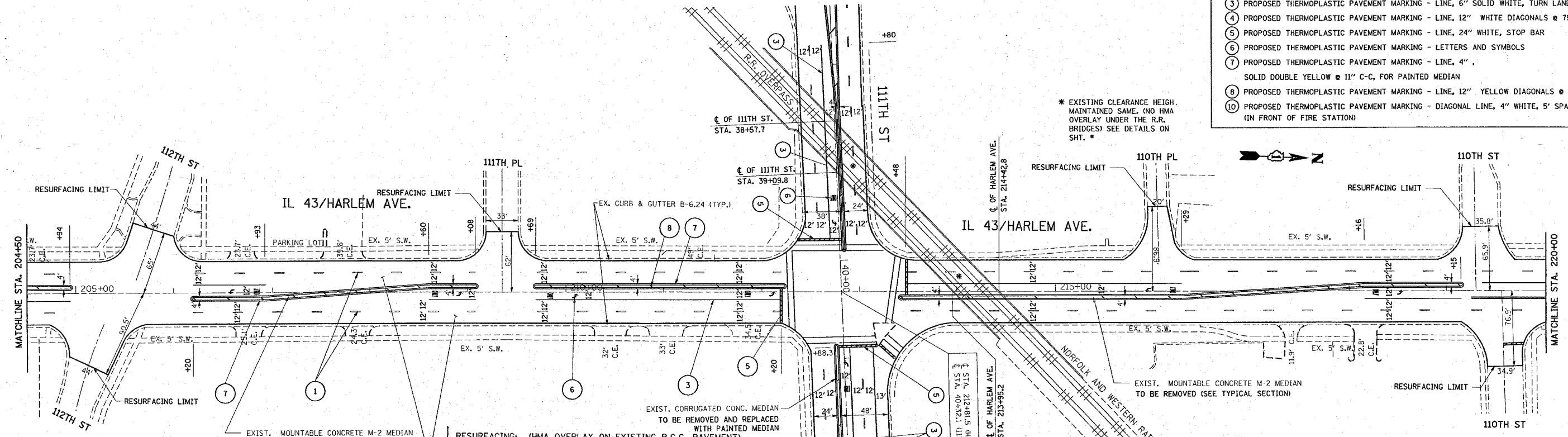

REVISIONS	
NAME	DATE

ILLINOIS DEPARTMENT OF TRANSPORTATION

IL. RTE. 43 (HARLEM AV.)
EXISTING AND PROPOSED
ROADWAY AND PAVEMENT MARKING PLAN
U.S. 6 TO IL. RTE. 7

SCALE: VERT. 1" = 50'
HORIZ. 1" = 50'

DATE 12/5/2007

DRAWN BY
CHECKED BY

PLOT DATE = 12/5/2007
FILE NAME = c:\projects\449281\h_rch\h.dgn
PLOT SCALE = 60,0000 / 1 IN.
USER NAME = driskong