

RTE	SECTION	COUNTY	TOTAL SHEETS	SHEET NO.
338	114R-1	WILL	355	84
STA. 3075+00 TO STA. 3098+00 (IL RTE 59)				
STA. 13+75 TO STA. 16+50 (BLACK ROAD)				
FED. ROAD DIST. NO. 7 ILLINOIS FED. AID PROJECT				

PLAN	DATE	BY
SURVEYED		
PLANNED		
DESIGNED		
CHECKED		
IN CHARGE		
NOTE BOOK NO.		
PAID FILE NAME		

PROFILE	DATE	BY
SURVEYED		
PLANNED		
DESIGNED		
CHECKED		
IN CHARGE		
NOTE BOOK NO.		
STRUCTURE NOTATIONS		

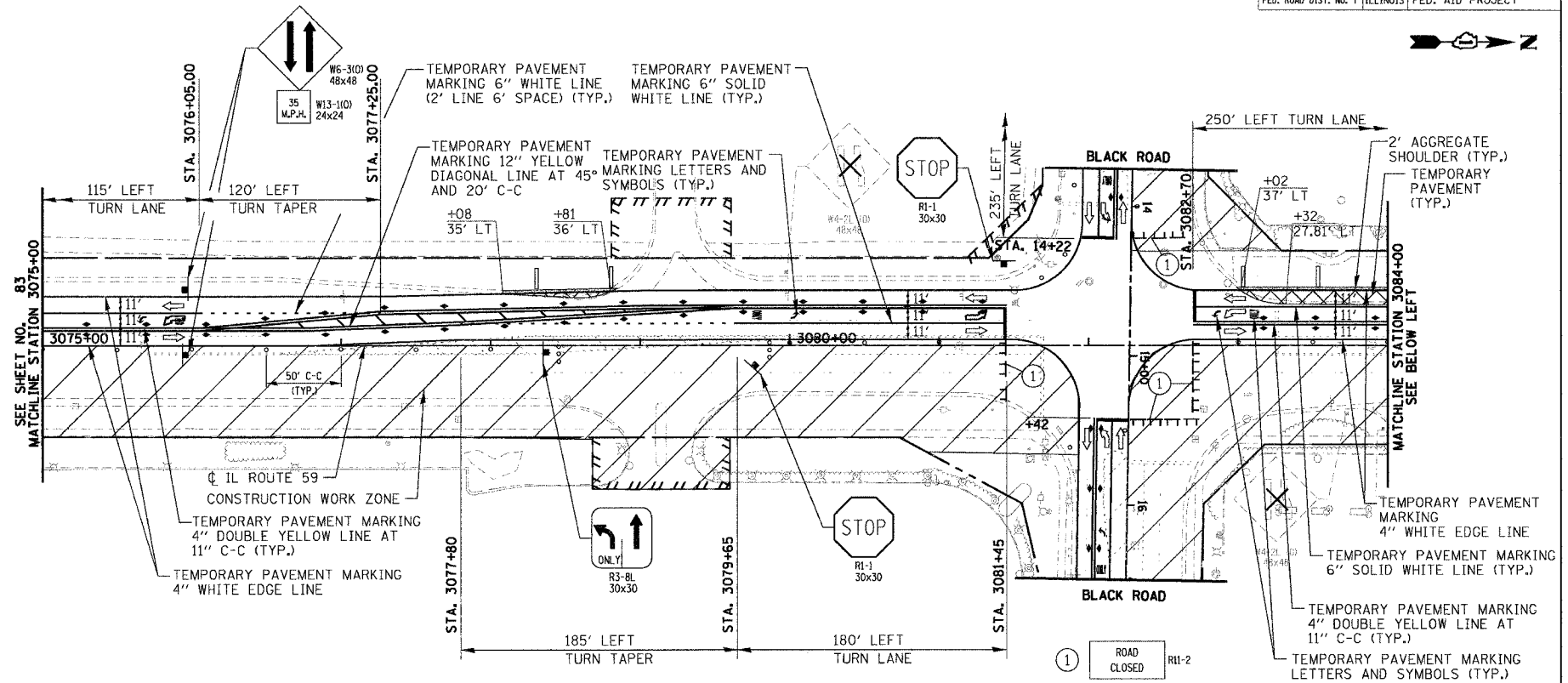

STAGE I CONSTRUCTION TRAFFIC CONTROL AND PROTECTION

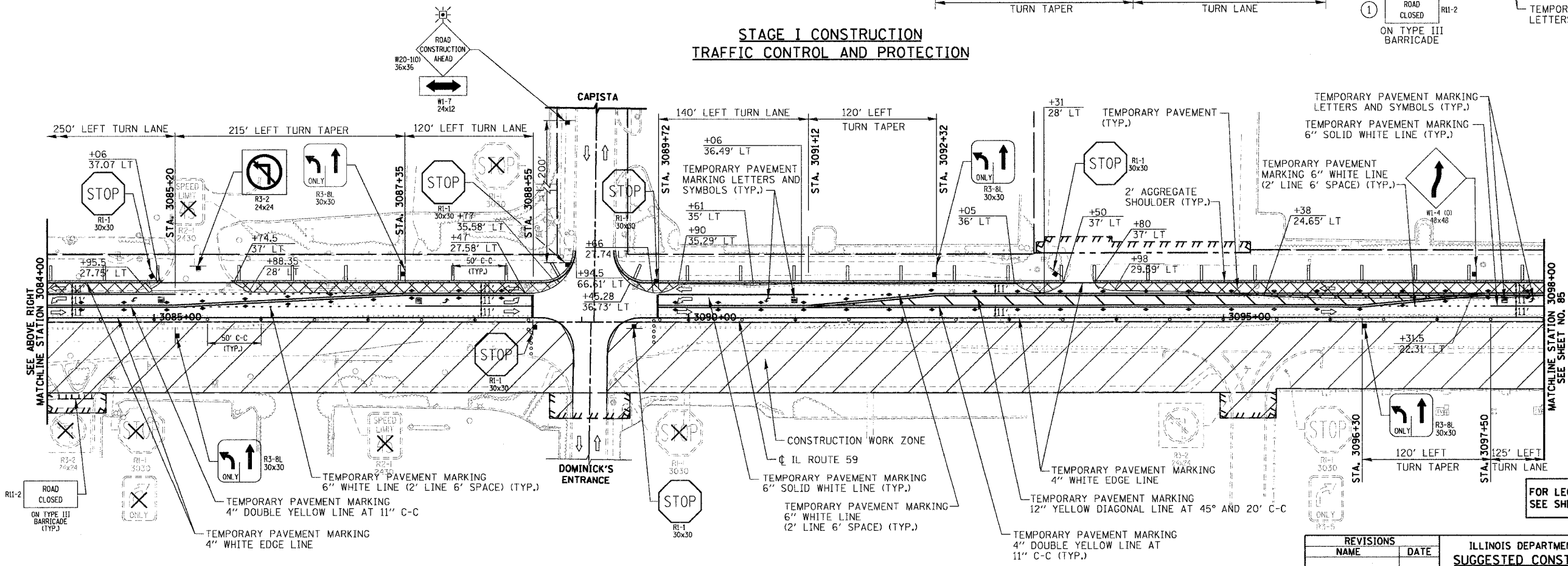

STAGE I CONSTRUCTION TRAFFIC CONTROL AND PROTECTION

NOTES

- FOR THE INTERSECTION CONSTRUCTION PROCEDURE AND MAINTENANCE OF TRAFFIC STAGING OF IL-59 AND BLACK ROAD SEE SUB STAGING SHEETS.

REVISIONS	
NAME	DATE

**ILLINOIS DEPARTMENT OF TRANSPORTATION
SUGGESTED CONSTRUCTION PROCEDURE
AND MAINTENANCE OF TRAFFIC STAGE I**

ILLINOIS ROUTE 59
STATION 3075+00 TO STATION 3098+00
BLACK ROAD
STATION 13+75 TO STATION 16+50

DATE: 3/18/08
DRAWN BY: NM, RM
CHECKED BY: AS

SCALE IN FEET

FOR LEGEND SEE SHEET NO. 81