

F.A.P. RTE.	SECTION	COUNTY	TOTAL SHEETS	SHEET NO.
338	114R-1	WILL	355	185
STA.	TO STA.			
FED. ROAD DIST. NO. 1	ILLINOIS	FED. AID PROJECT		

BLACK ROAD



LEGEND

SEE SHEET 12 FOR JOINTING DETAILS

SAWED CONSTRUCTION JOINT

13.9 LENGTH (IN FEET) OF PAVEMENT PANEL (BETWEEN SAWED CONTRACTION JOINTS) IF DIFFERENT THAN 15'

TRANSVERSE CONSTRUCTION JOINT (SEE HIGHWAY STANDARD 420101)

PLAN	DATE
SURVEYED	
PLOTTED	
NOTED	
BY	
DATE	

PROFILE	DATE
SURVEYED	
PLOTTED	
NOTED	
BY	
DATE	

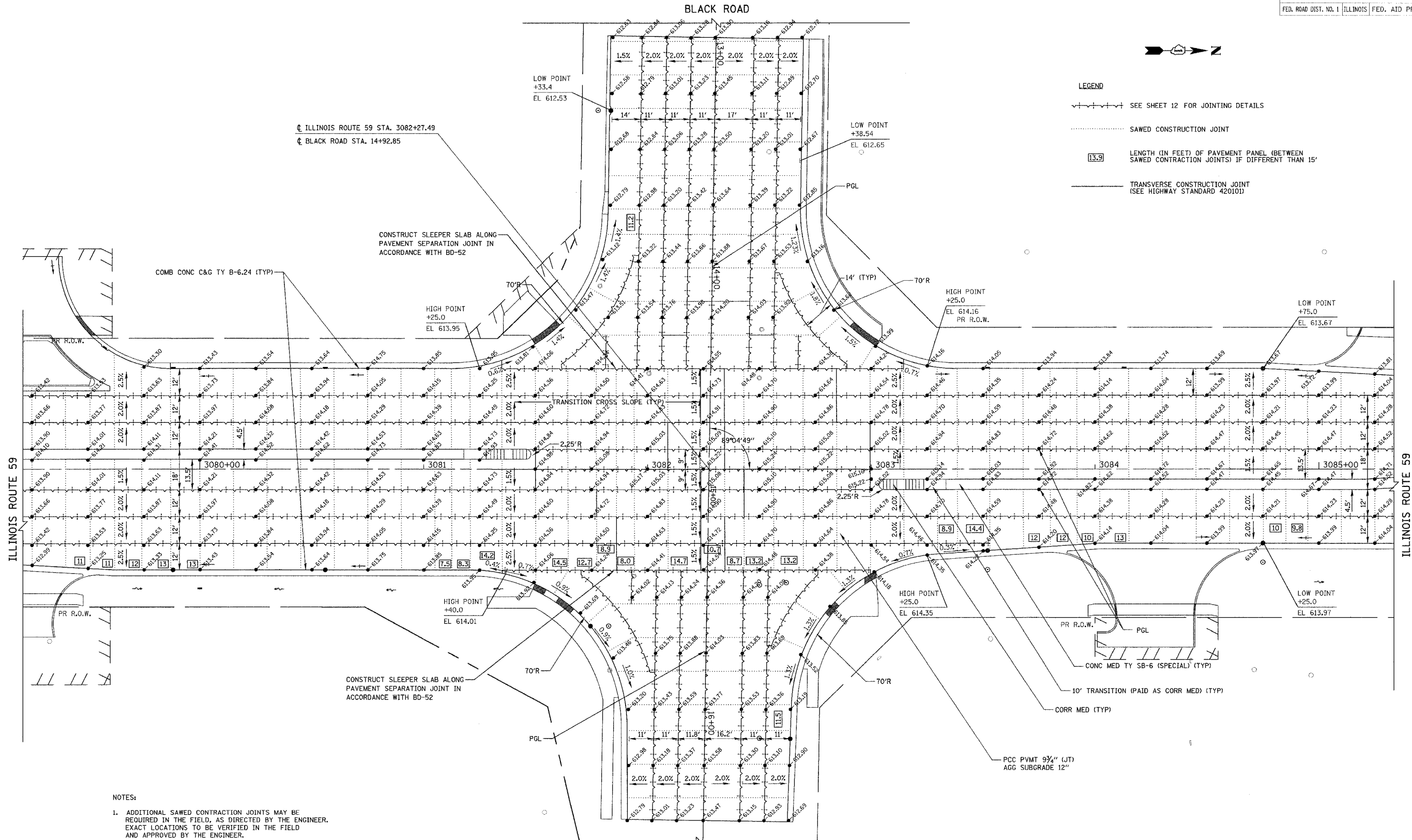

NOTES:

- ADDITIONAL SAWED CONTRACTION JOINTS MAY BE REQUIRED IN THE FIELD, AS DIRECTED BY THE ENGINEER. EXACT LOCATIONS TO BE VERIFIED IN THE FIELD AND APPROVED BY THE ENGINEER.
- PAVEMENT ROUND-OUTS FOR MANHOLES AND VALVE VAULTS SHALL BE CONSTRUCTED IN ACCORDANCE WITH HIGHWAY STANDARD 420111 AND DISTRICT DETAIL BD-46.

REVISIONS	
NAME	DATE
REVISED IL 59 ALIGN.	12/22/06

ILLINOIS DEPARTMENT OF TRANSPORTATION

INTERSECTION PAVING PLAN

ILLINOIS ROUTE 59
ILLINOIS ROUTE 59 AND BLACK ROAD

DATE 3/18/08
DRAWN BY MJG
CHECKED BY VJD

SCALE IN FEET