

CONTRACT NO. 62417

FAP NO.	SECTION	COUNTY	TOTAL SHEETS	SHEET NO.
338	(113 & 114) R-5	WILL	525	119
STA.	3218+00	TO STA.	3232+00	
FED. ROAD DIST. NO.	ILLINOIS	FAP 338 (IL RTE. 59)		

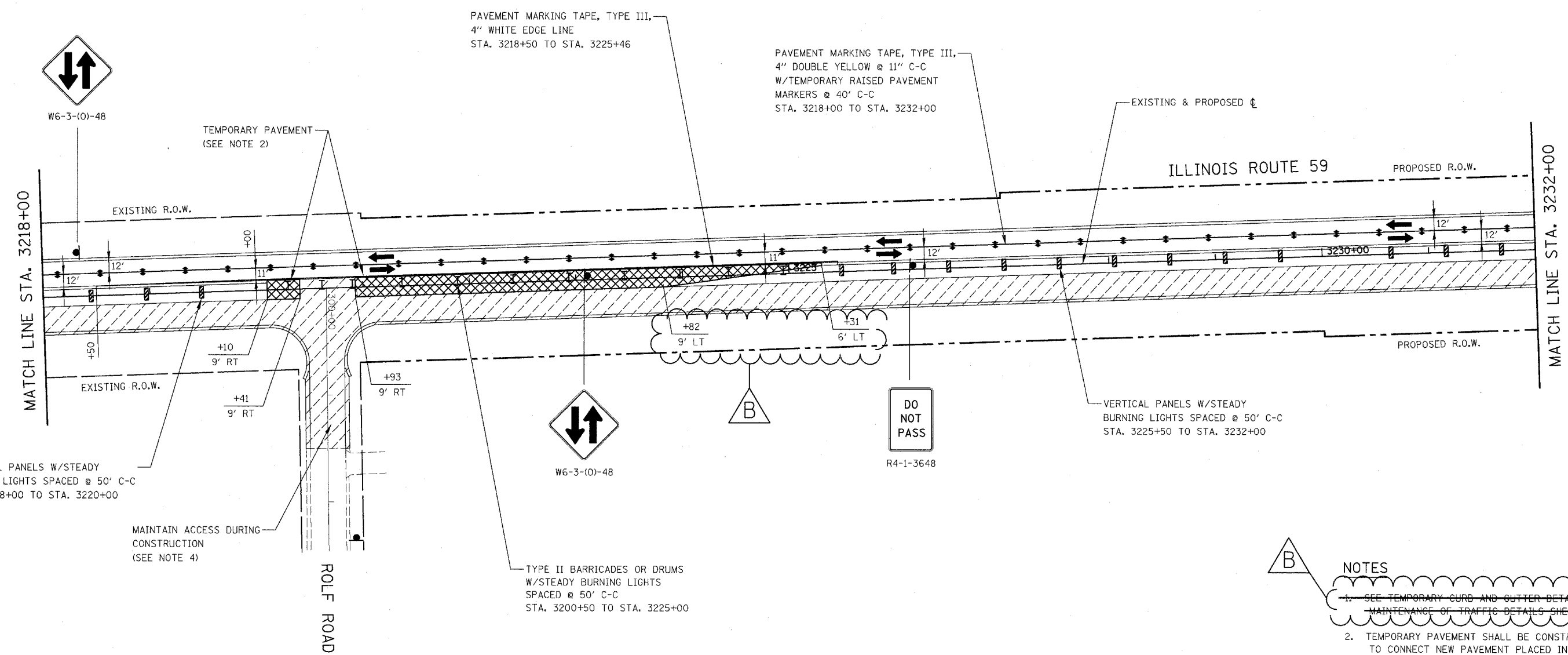

- NOTES**
- SEE TEMPORARY CURB AND GUTTER DETAIL ON MAINTENANCE OF TRAFFIC DETAILS SHEET.
 - TEMPORARY PAVEMENT SHALL BE CONSTRUCTED TO CONNECT NEW PAVEMENT PLACED IN PREVIOUS STAGE TO NEW PAVEMENT PLACED IN THIS STAGE.
 - PAVEMENT MARKING, VERTICAL PANELS, TYPE II BARRICADES OR DRUMS, AND SIGNAGE NOT INDICATED REMAIN FROM PREVIOUS STAGE.
 - SEE MAINTENANCE OF TRAFFIC GENERAL NOTES 26, 31, 32 & 33.
 - SEE MAINTENANCE OF TRAFFIC GENERAL NOTES 35 & 36.

REVISIONS	
NAME	DATE
ADDENDUM B	05-27-08

ILLINOIS DEPARTMENT OF TRANSPORTATION
 DISTRICT NO. 1 SCHAUMBURG
STAGING PLANS
 ILLINOIS ROUTE 59
 STAGE 2

SCALE AS SHOWN
 DATE MARCH 18, 2008

DRAWN BY REW
 CHECKED BY JCM

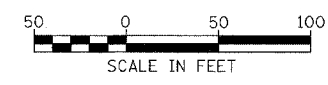

Rev. 05-01-08 JCM