

FAR NO.	SECTION	COUNTY	TOTAL SHEETS	SHEET NO.
338	(113 & 114) R-5	WILL	525	123
STA. 3274+00		TO STA. 3288+00		
FED. ROAD DIST. NO.		ILLINOIS		
FAP 338 (IL RTE. 59)				

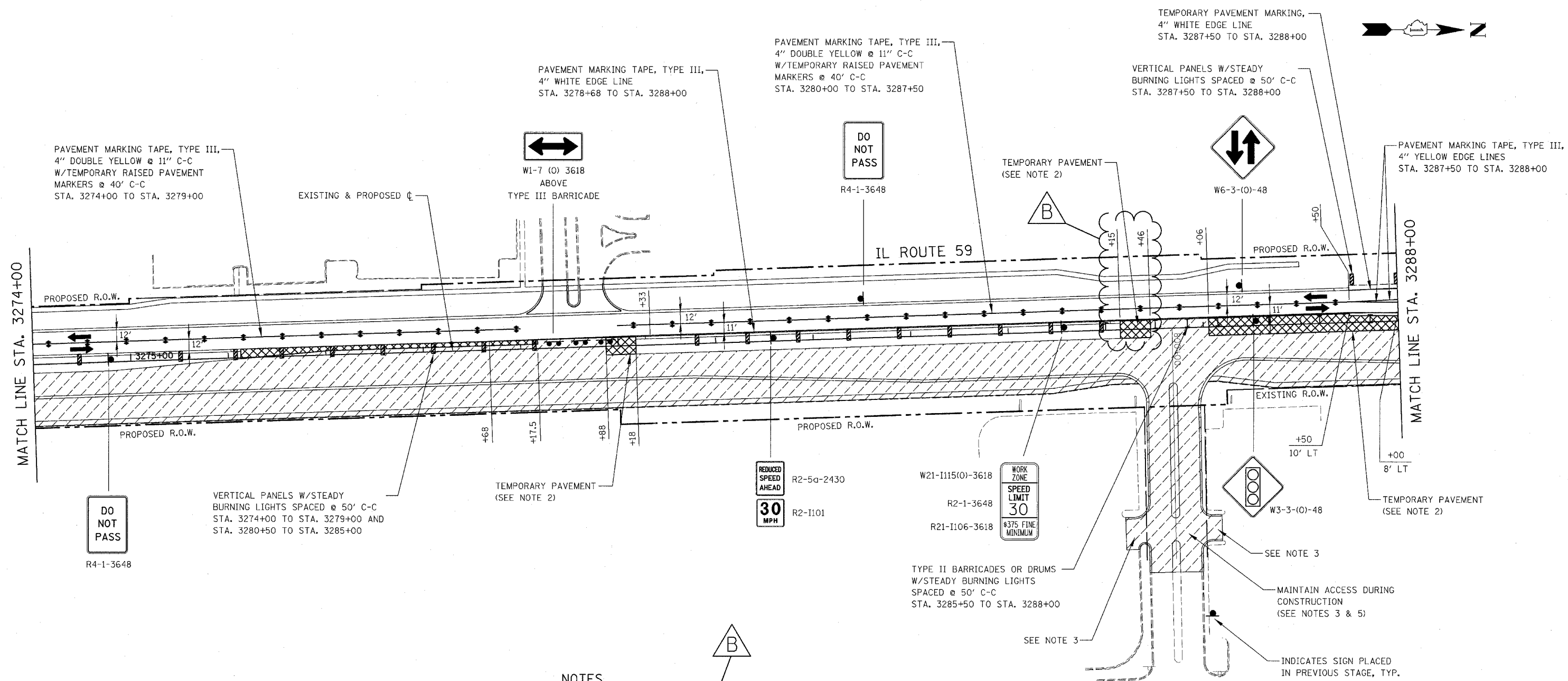

**NOTES**

1. SEE TEMPORARY CURB AND GUTTER DETAIL ON MAINTENANCE OF TRAFFIC DETAILS SHEET.

2. TEMPORARY PAVEMENT SHALL BE CONSTRUCTED TO CONNECT NEW PAVEMENT PLACED IN PREVIOUS STAGE TO NEW PAVEMENT PLACED IN THIS STAGE.
3. SEE MAINTENANCE OF TRAFFIC GENERAL NOTE 26.
4. PAVEMENT MARKING, VERTICAL PANELS, TYPE II BARRICADES OR DRUMS, AND SIGNAGE NOT INDICATED REMAIN FROM PREVIOUS STAGE.
5. SEE MAINTENANCE OF TRAFFIC GENERAL NOTES 31, 32 & 33.
6. SEE MAINTENANCE OF TRAFFIC GENERAL NOTES 35 & 36.



REVISIONS	
NAME	DATE
ADDENDUM B	05-27-08

Rev. 05-01-08 JCM

ILLINOIS DEPARTMENT OF TRANSPORTATION  
DISTRICT NO. 1 SCHAUMBURG

**STAGING PLANS**  
**ILLINOIS ROUTE 59**  
**STAGE 2**

SCALE AS SHOWN  
DATE MARCH 18, 2008

DRAWN BY REW  
CHECKED BY JCM