

CONTRACT NO. 62417		FAP NO.	SECTION	COUNTY	TOTAL SHEETS
338	(113 & 114) R-5	WILL	525	142	
STA. 3246+00	TO STA. 3260+00	FED. ROAD DIST. NO.	DISTRICT	FAP 338 (ILL. RTE. 59)	

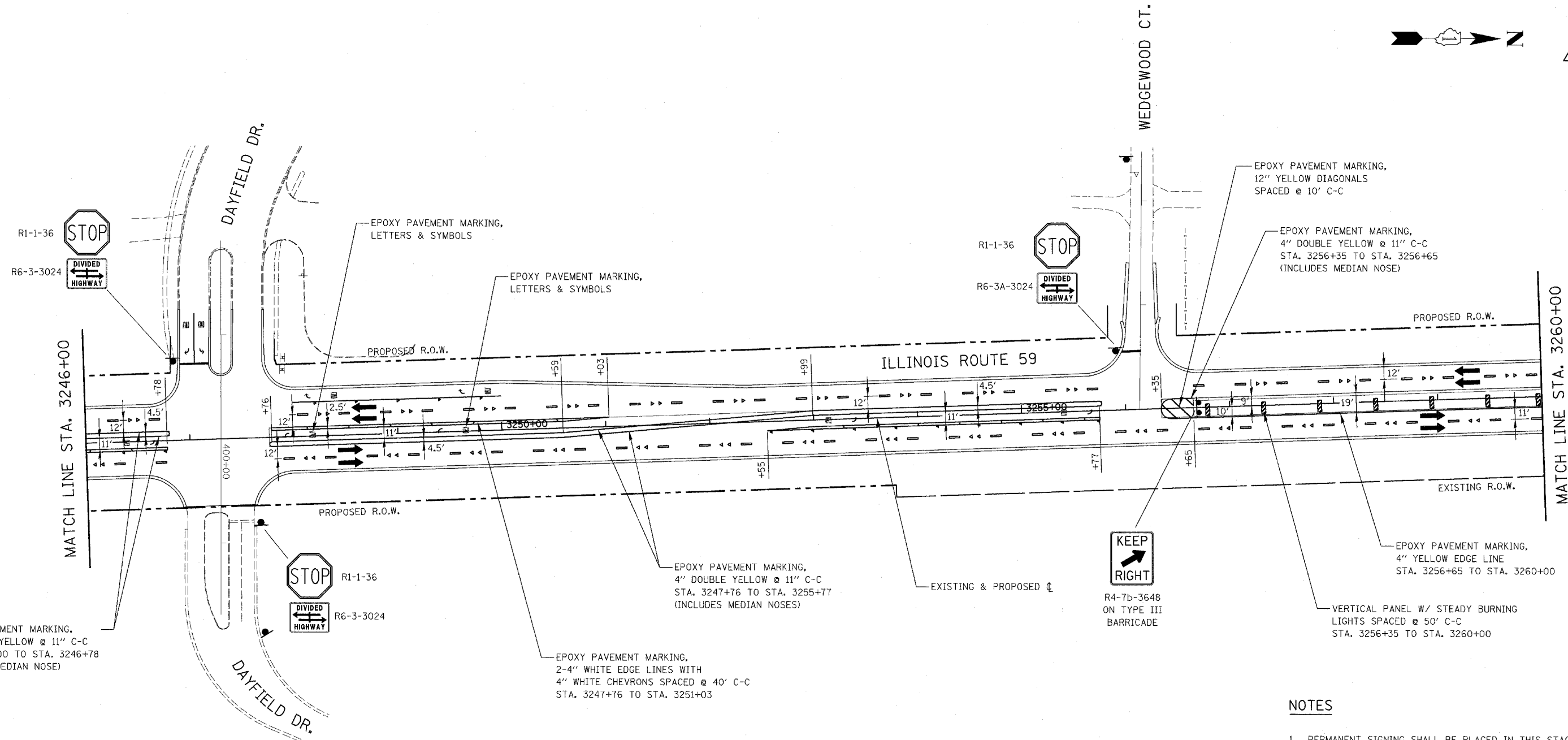
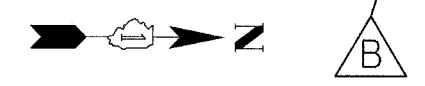

EPOXY PAVEMENT MARKING,
4" DOUBLE YELLOW @ 11" C-C
STA. 3246+00 TO STA. 3246+78
(INCLUDES MEDIAN NOSE)

R1-1-36
R6-3-3024
STOP
DIVIDED HIGHWAY

EPOXY PAVEMENT MARKING,
4" DOUBLE YELLOW @ 11" C-C
STA. 3247+76 TO STA. 3255+77
(INCLUDES MEDIAN NOSES)

EPOXY PAVEMENT MARKING,
2-4" WHITE EDGE LINES WITH
4" WHITE CHEVRONS SPACED @ 40' C-C
STA. 3247+76 TO STA. 3251+03

R4-7b-3648
ON TYPE III
BARRICADE
KEEP RIGHT

EPOXY PAVEMENT MARKING,
12" YELLOW DIAGONALS
SPACED @ 10' C-C

EPOXY PAVEMENT MARKING,
4" DOUBLE YELLOW @ 11" C-C
STA. 3256+35 TO STA. 3256+65
(INCLUDES MEDIAN NOSE)

EPOXY PAVEMENT MARKING,
4" YELLOW EDGE LINE
STA. 3256+65 TO STA. 3260+00

VERTICAL PANEL W/ STEADY BURNING
LIGHTS SPACED @ 50' C-C
STA. 3256+35 TO STA. 3260+00

NOTES

1. PERMANENT SIGNING SHALL BE PLACED IN THIS STAGE. ANY SIGNING IN CONFLICT WITH MAINTENANCE OF TRAFFIC SIGNING SHALL BE COVERED.
2. SIGNAGE NOT INDICATED REMAINS FROM PREVIOUS STAGE.
3. PAVEMENT MARKING SHOWN ON THIS PLAN NOT NOTED ARE PERMANENT MARKINGS. SEE PAVEMENT MARKING AND SIGNING PLANS FOR PERMANENT PAVEMENT MARKING INFORMATION.

REVISIONS	
NAME	DATE
ADDENDUM B	05-27-08

ILLINOIS DEPARTMENT OF TRANSPORTATION
DISTRICT NO. 1 SCHAUMBURG
STAGING PLANS
ILLINOIS ROUTE 59
WINTER SHUTDOWN
SCALE AS SHOWN
DATE MARCH 18, 2008
DRAWN BY REW
CHECKED BY JCM

