

APP. NO.	SECTION	COUNTY	TOTAL SHEETS	SHEET NO.
338	(113 & 114) R-5	WILL	625	62
STA. 3245+00		TO STA. 3298+00		
FED. ROAD DIST. NO.		ILLINOIS	FAP 338 (IL RTE. 59)	

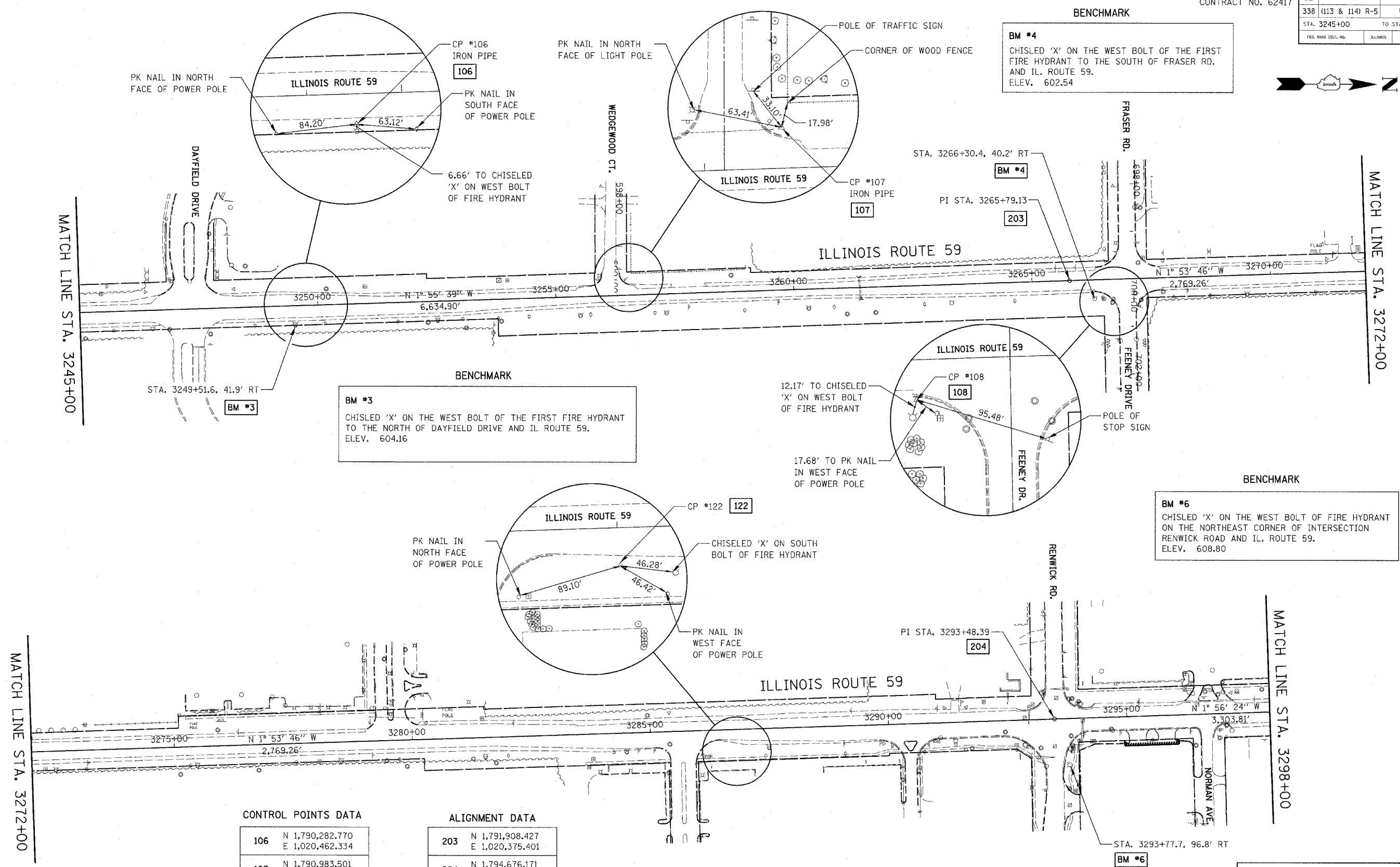

CONTROL POINTS DATA

106	N 1,790,282.770 E 1,020,462.334
107	N 1,790,983.501 E 1,020,377.709
108	N 1,791,963.863 E 1,020,401.439
122	N 1,794,030.814 E 1,020,337.151

ALIGNMENT DATA

203	N 1,791,908.427 E 1,020,375.401
204	N 1,794,676.171 E 1,020,283.774

NOTE:
ENLARGED DETAILS ARE NOT TO SCALE.

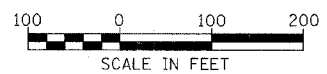

Rev. 05-01-08 JCM

ILLINOIS DEPARTMENT OF TRANSPORTATION
DISTRICT NO. 1 SCHAUMBURG

**ILLINOIS ROUTE 59
ALIGNMENT, BENCHMARKS,
AND TIES**

SCALE 1" = 100'
DATE MARCH 18, 2008

DRAWN BY REW
CHECKED BY JCM