

FAP DIST.	SECTION	COUNTY	TOTAL SHEETS	SHEET NO.
338	(113 & 114) R-5	WILL	525	75
STA. TO STA.		FAP 338 (IL RTE. 59)		
FED. ROAD DIST. NO.		ILLINOIS		

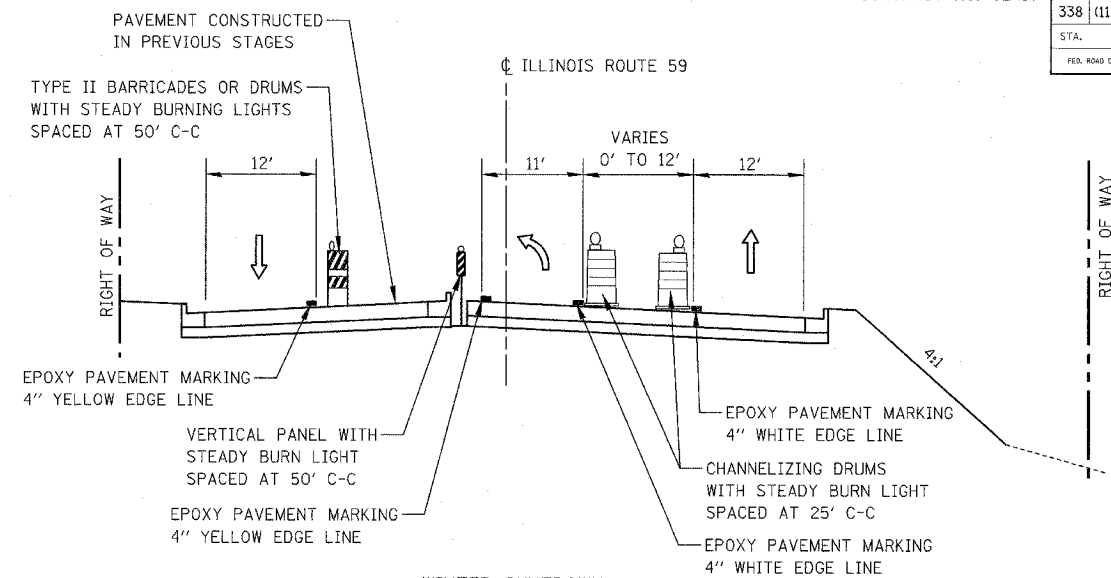

- STA 3244+50 TO STA 3246+80 (DAYFIELD DRIVE)
- STA 3252+70 TO STA 3255+80 (WEDGEWOOD COURT)
- STA 3264+00 TO STA 3266+45 (FRASER ROAD)
- STA 3276+75 TO STA 3279+20 (COMMERCIAL ENTRANCE)
- STA 3290+30 TO STA 3293+00 (RENWICK ROAD)
- STA 3317+35 TO STA 3319+60 (FORT BEGGS DRIVE)

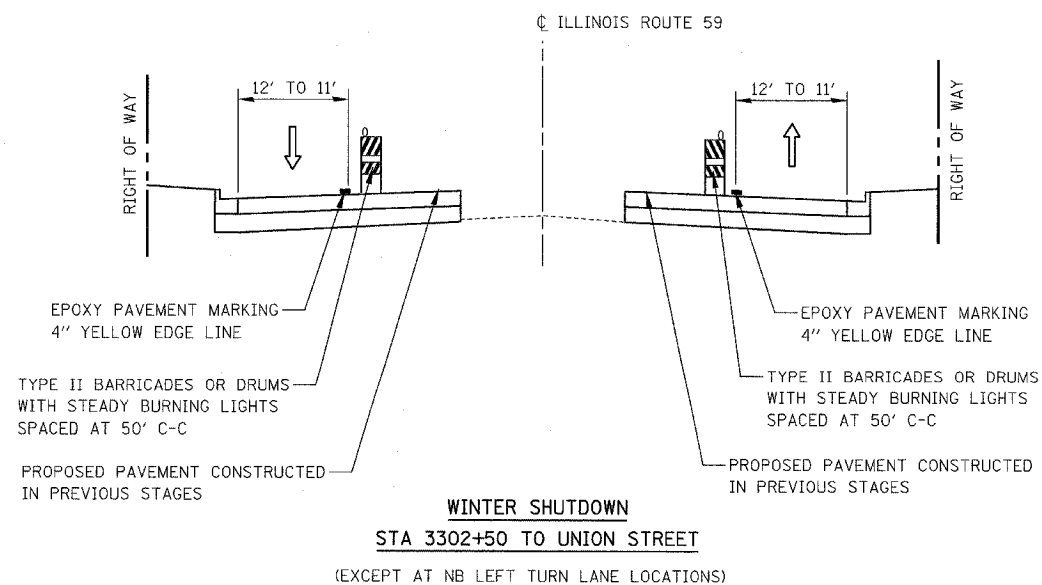
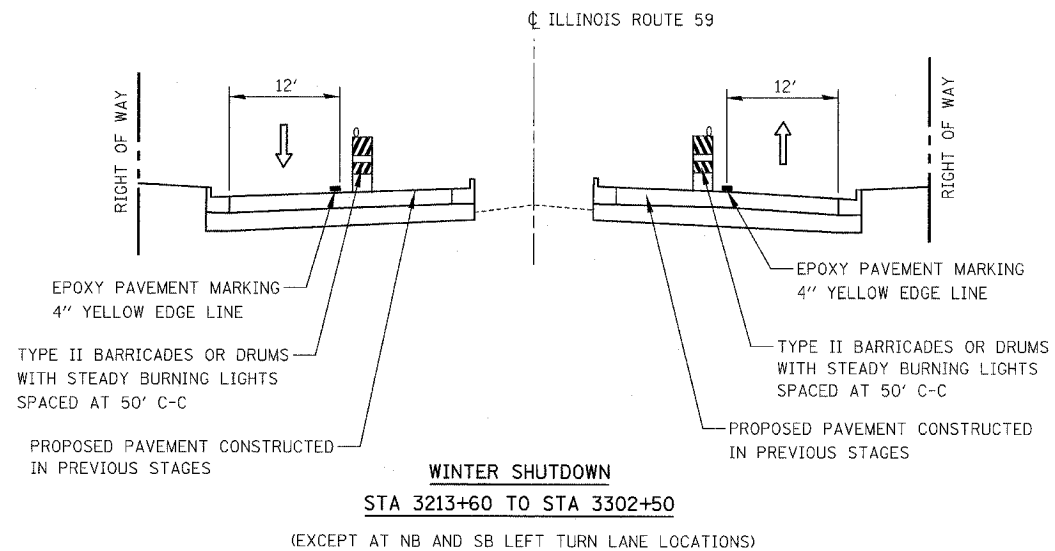
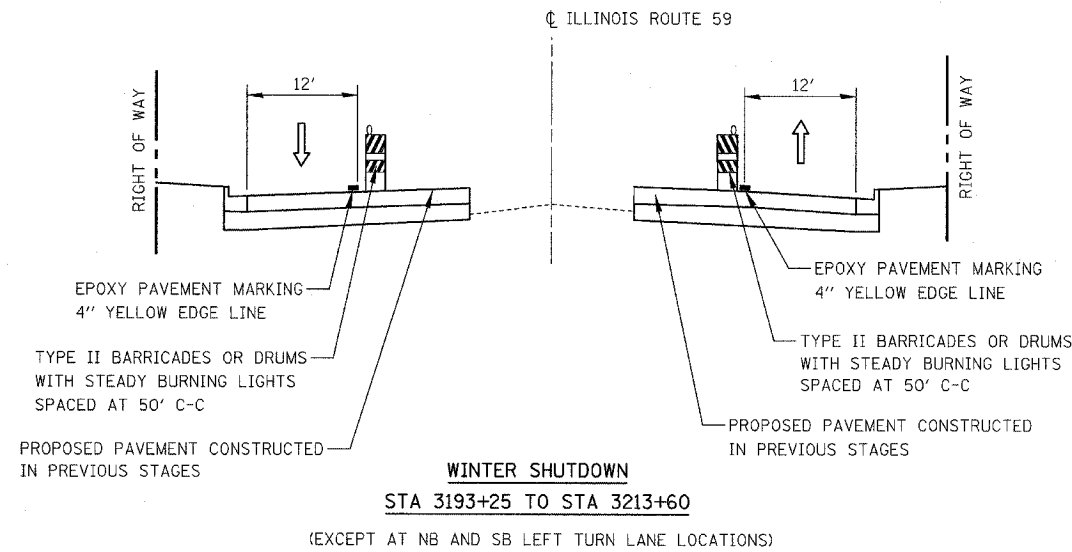
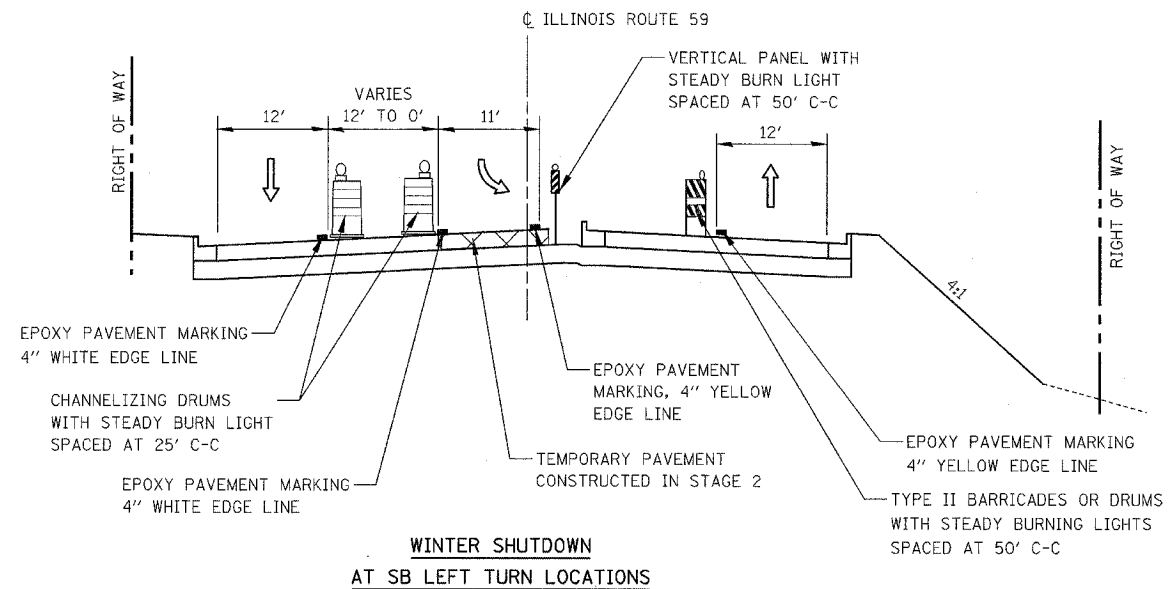

- STA 3200+50 TO STA 3203+10 (RIVERWALK DRIVE)
- STA 3220+90 TO STA 3223+25 (ROLF ROAD)
- STA 3247+75 TO STA 3250+90 (DAYFIELD DRIVE)
- STA 3267+55 TO STA 3270+05 (FEENEY DRIVE)
- STA 3286+05 TO STA 3288+55 (COMMERCIAL ENTRANCE)
- STA 3294+00 TO STA 3299+45 (RENWICK ROAD)
- STA 3315+20 TO STA 3316+40 (ROBERTS AVENUE)

ILLINOIS DEPARTMENT OF TRANSPORTATION
 DISTRICT NO. 1 SCHAUMBURG
 MAINTENANCE OF TRAFFIC
 TYPICAL SECTIONS
 WINTER SHUTDOWN

SCALE NOT TO SCALE
 DATE MARCH 18, 2008
 DRAWN BY REW
 CHECKED BY HME