

| FAP NO.             | SECTION         | COUNTY                        | TOTAL SHEETS | SHEET NO. |
|---------------------|-----------------|-------------------------------|--------------|-----------|
| 338                 | (113 & 114) R-5 | WILL                          | 525          | 123       |
| STA. 3274+00        |                 | TO STA. 3288+00               |              |           |
| FED. ROAD DIST. NO. |                 | ILLINOIS FAP 338 (IL RTE. 59) |              |           |

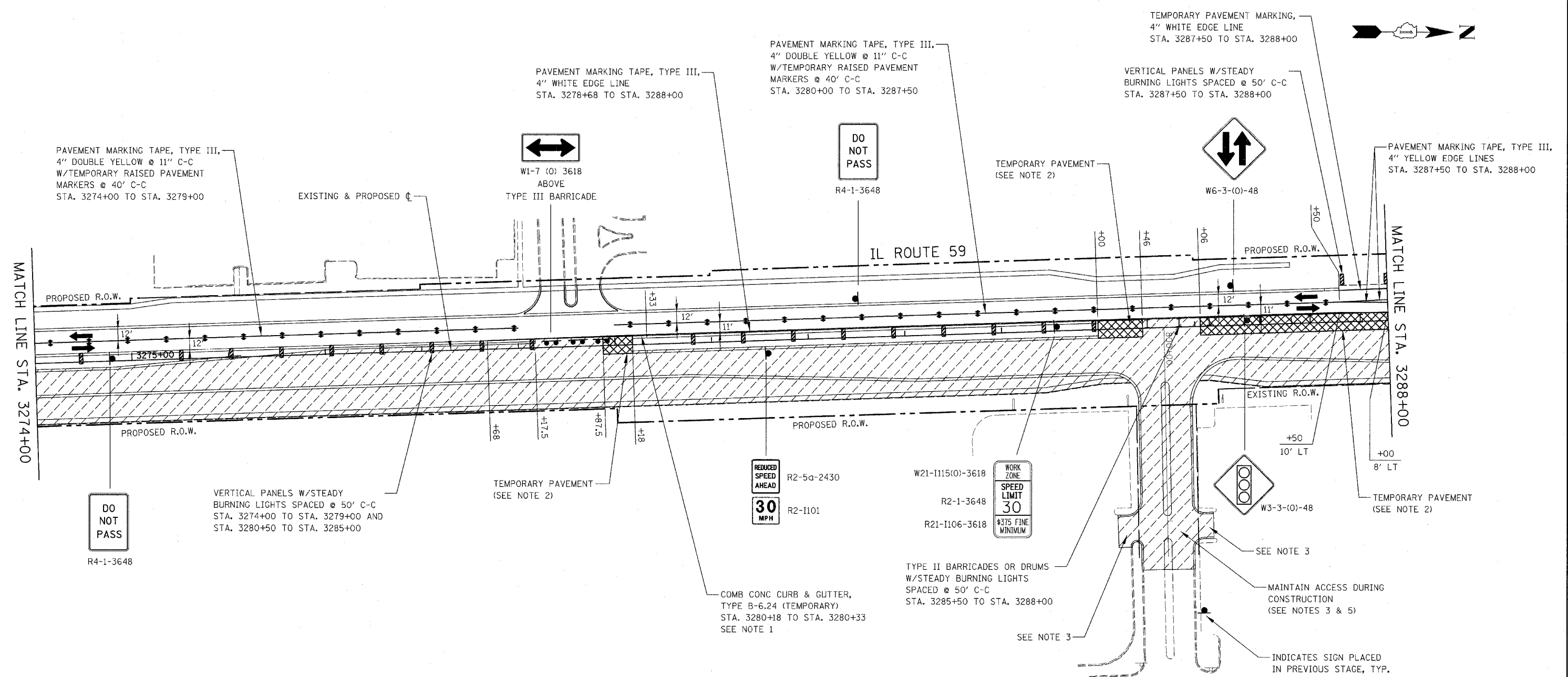

**NOTES**

1. SEE TEMPORARY CURB AND GUTTER DETAIL ON MAINTENANCE OF TRAFFIC DETAILS SHEET.
2. TEMPORARY PAVEMENT SHALL BE CONSTRUCTED TO CONNECT NEW PAVEMENT PLACED IN PREVIOUS STAGE TO NEW PAVEMENT PLACED IN THIS STAGE.
3. SEE MAINTENANCE OF TRAFFIC GENERAL NOTE 26.
4. PAVEMENT MARKING, VERTICAL PANELS, TYPE II BARRICADES OR DRUMS, AND SIGNAGE NOT INDICATED REMAIN FROM PREVIOUS STAGE.
5. SEE MAINTENANCE OF TRAFFIC GENERAL NOTES 31, 32 & 33.
6. SEE MAINTENANCE OF TRAFFIC GENERAL NOTES 35 & 36.



Rev. 05-01-08 JCM

ILLINOIS DEPARTMENT OF TRANSPORTATION  
 DISTRICT NO. 1 SCHAUMBURG  
**STAGING PLANS**  
 ILLINOIS ROUTE 59  
**STAGE 2**

SCALE AS SHOWN  
 DATE MARCH 18, 2008

DRAWN BY REW  
 CHECKED BY JCM