

|                     |                 |                      |              |           |
|---------------------|-----------------|----------------------|--------------|-----------|
| CONTRACT NO. 62417  |                 |                      |              |           |
| FAP. SFE.           | SECTION         | COUNTY               | TOTAL SHEETS | SHEET NO. |
| 338                 | (113 & 114) R-5 | WILL                 | 525          | 127       |
| STA. 3328+00        |                 | TO STA. 3337+00      |              |           |
| FED. ROAD DIST. NO. | ILLINOIS        | FAP 338 (IL RTE. 59) |              |           |

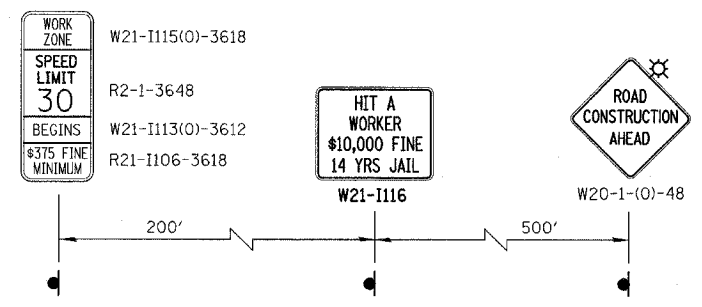

SEE ADVANCE SIGNING FOR SOUTHBOUND ILLINOIS ROUTE 59



PAVEMENT MARKING TAPE, TYPE III,  
4" DOUBLE YELLOW @ 11" C-C  
W/TEMPORARY RAISED PAVEMENT  
MARKERS @ 40' C-C  
STA. 3328+00 TO STA. 3328+57

DRUMS W/STEADY BURNING  
LIGHTS SPACED @ 25' C-C  
IN MEDIAN, TYP.

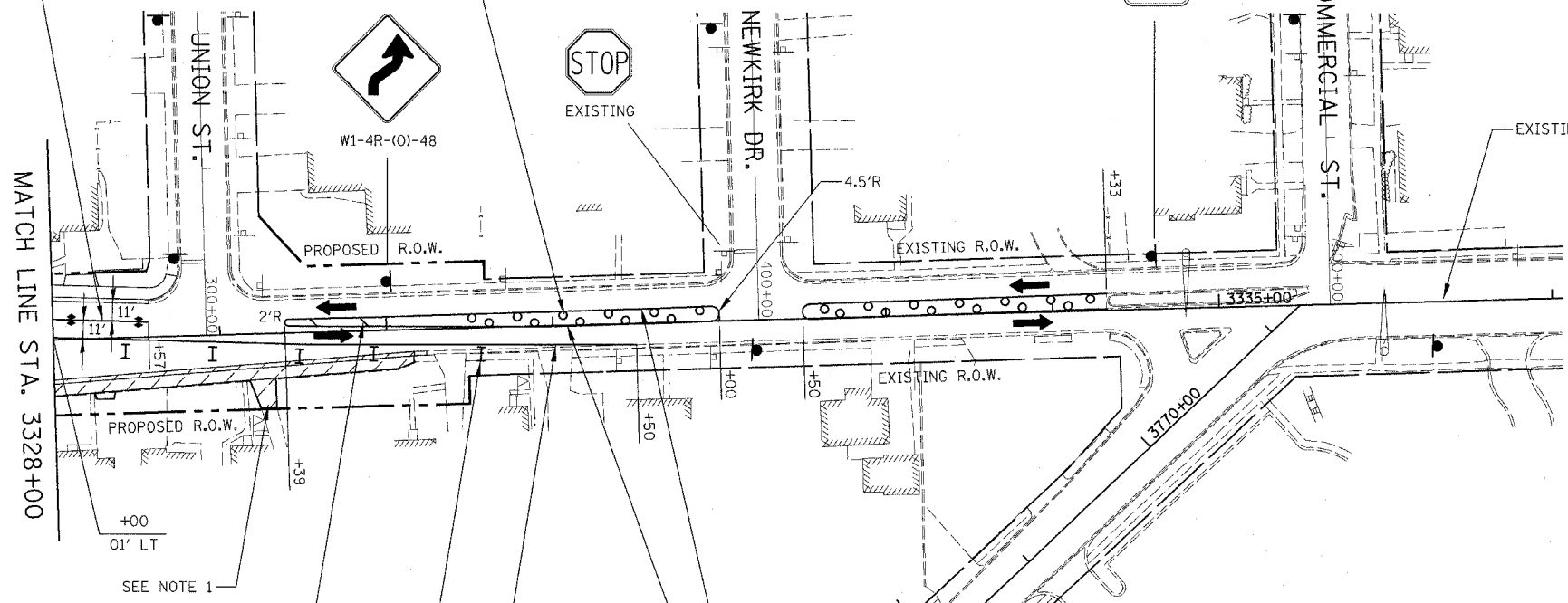

PAVEMENT MARKING TAPE, TYPE III,  
12" YELLOW DIAGONALS  
SPACED @ 30' C-C

TYPE II BARRICADES OR DRUMS  
W/STEADY BURNING LIGHTS  
SPACED @ 50' C-C  
STA. 3328+00 TO STA. 3330+50

PAVEMENT MARKING TAPE, TYPE III,  
4" WHITE EDGE LINE  
STA. 3328+00 TO STA. 3331+50

PAVEMENT MARKING TAPE, TYPE III,  
4" YELLOW LINES  
STA. 3329+39 TO STA. 3332+00

**NOTES**

1. SEE MAINTENANCE OF TRAFFIC GENERAL NOTE 26.
2. PAVEMENT MARKING, VERTICAL PANELS, TYPE II BARRICADES OR DRUMS, AND SIGNAGE NOT INDICATED REMAIN FROM PREVIOUS STAGE.
3. SEE MAINTENANCE OF TRAFFIC GENERAL NOTES 35 & 36.

ILLINOIS DEPARTMENT OF TRANSPORTATION  
DISTRICT NO. 1 SCHAUMBURG  
STAGING PLANS  
ILLINOIS ROUTE 59  
STAGE 2

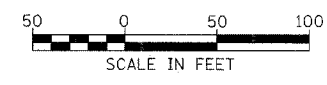

Rev. 05-01-08 JCM

SCALE AS SHOWN  
DATE MARCH 18, 2008  
DRAWN BY REW  
CHECKED BY JCM