

FAP DIST.	SECTION	COUNTY	TOTAL SHEETS	SHEET NO.
338	(113 & 114) R-5	WILL	525	147
STA. 3316+00		TO STA. 3328+00		
FED. ROAD DIST. NO.		ALLEGES	FAP 338 (IL RTE. 59)	

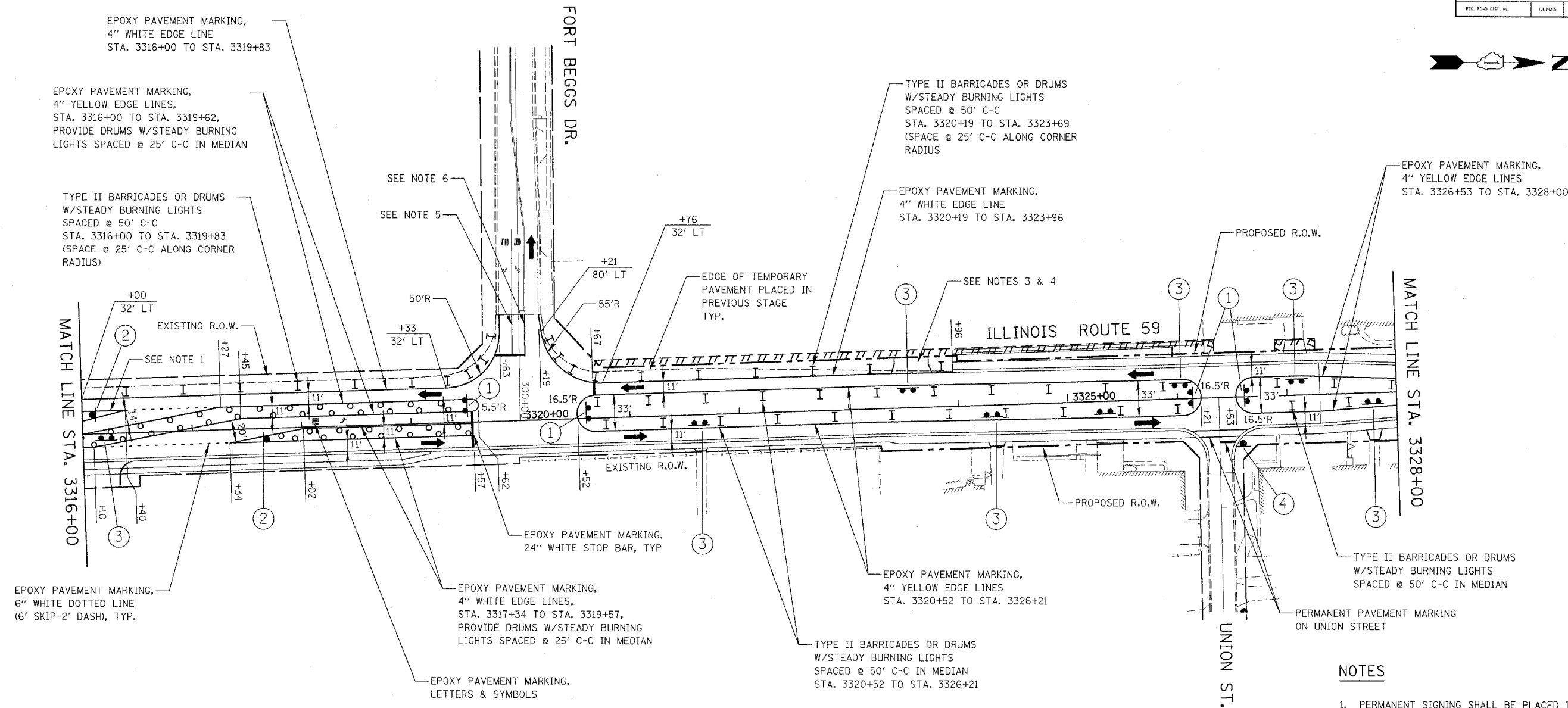

EPOXY PAVEMENT MARKING,
6\"/>

TYPE II BARRICADES OR DRUMS
W/STEADY BURNING LIGHTS
SPACED @ 50' C-C
STA. 3316+00 TO STA. 3319+83
(SPACE @ 25' C-C ALONG CORNER
RADIUS)

EPOXY PAVEMENT MARKING,
4\"/>

EPOXY PAVEMENT MARKING,
4\"/>

SEE NOTE 6
SEE NOTE 5

+76 32' LT
+21 80' LT
+55' R
+67
+33 32' LT
50' R
+45
+21
+40
+34
+02
+57
+62
+52

EXISTING R.O.W.
EXISTING R.O.W.
PROPOSED R.O.W.
PROPOSED R.O.W.

EPOXY PAVEMENT MARKING,
24\"/>

EPOXY PAVEMENT MARKING,
4\"/>

EPOXY PAVEMENT MARKING,
LETTERS & SYMBOLS

EDGE OF TEMPORARY
PAVEMENT PLACED IN
PREVIOUS STAGE
TYP.

EPOXY PAVEMENT MARKING,
4\"/>

TYPE II BARRICADES OR DRUMS
W/STEADY BURNING LIGHTS
SPACED @ 50' C-C
STA. 3320+19 TO STA. 3323+69
(SPACE @ 25' C-C ALONG CORNER
RADIUS)

SEE NOTES 3 & 4

EPOXY PAVEMENT MARKING,
4\"/>





TYPE II BARRICADES OR DRUMS
W/STEADY BURNING LIGHTS
SPACED @ 50' C-C IN MEDIAN
STA. 3320+52 TO STA. 3326+21

EPOXY PAVEMENT MARKING,
4\"/>

TYPE II BARRICADES OR DRUMS
W/STEADY BURNING LIGHTS
SPACED @ 50' C-C IN MEDIAN

PERMANENT PAVEMENT MARKING
ON UNION STREET

SIGN LEGEND

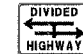
- ①  R4-7b-3648 ON TYPE III BARRICADE
- ②  R3-1100-2424
 M6-2L-2115
- ③  R6-2R-2430 ON TYPE III BARRICADE
- ④  R1-1-36
 R6-3A-3024

NOTES

1. PERMANENT SIGNING SHALL BE PLACED IN THIS STAGE. ANY SIGNING IN CONFLICT WITH MAINTENANCE OF TRAFFIC SIGNING SHALL BE COVERED.
2. SIGNAGE NOT INDICATED REMAINS FROM PREVIOUS STAGE.
3. SEE MAINTENANCE OF TRAFFIC GENERAL NOTE 26.
4. 2\"/>

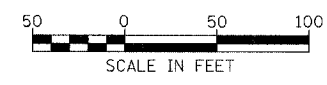

ILLINOIS DEPARTMENT OF TRANSPORTATION
DISTRICT NO. 1 SCHAUMBURG

**STAGING PLANS
ILLINOIS ROUTE 59
WINTER SHUTDOWN**

SCALE AS SHOWN DATE MARCH 18, 2008
DRAWN BY REW CHECKED BY JCM