

FAP NO.	SECTION	COUNTY	TOTAL SHEETS	SHEET NO.
338	(113 & 114) R-5	WILL	525	153
STA. 3246+00	TO STA. 3260+00			
FED. ROAD DIST. NO.	ILLINOIS	FAP 338 (IL RTE. 59)		

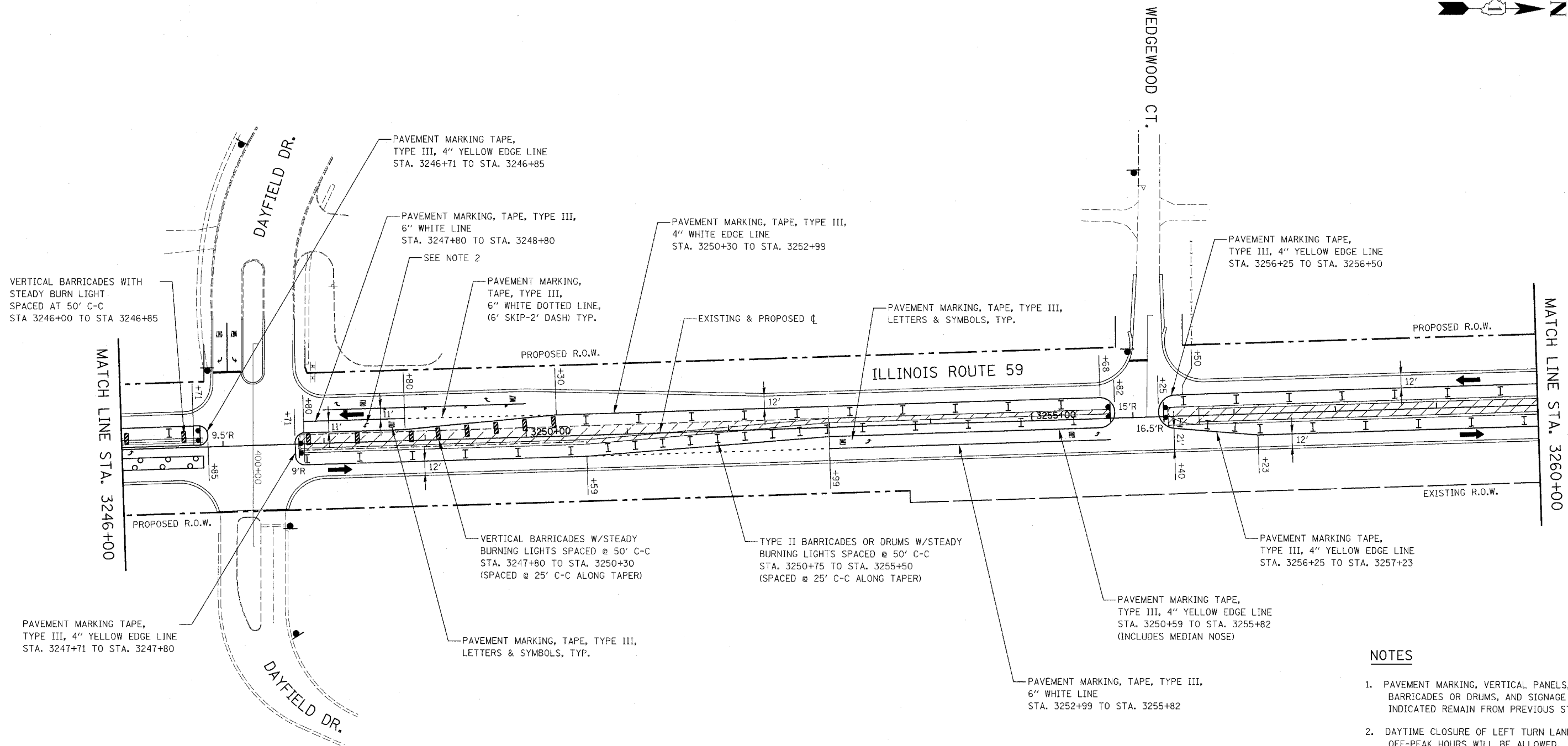

**NOTES**

1. PAVEMENT MARKING, VERTICAL PANELS, TYPE II BARRICADES OR DRUMS, AND SIGNAGE NOT INDICATED REMAIN FROM PREVIOUS STAGE.
2. DAYTIME CLOSURE OF LEFT TURN LANE DURING OFF-PEAK HOURS WILL BE ALLOWED. CONTRACTOR SHALL PROVIDE FLAGGERS DURING CLOSURE OF LEFT TURN LANE. COST OF LANE CLOSURE AND FLAGGERS SHALL BE INCLUDED IN THE CONTRACT UNIT PRICE FOR TRAFFIC CONTROL AND PROTECTION (SPECIAL).

ILLINOIS DEPARTMENT OF TRANSPORTATION  
 DISTRICT NO. 1 SCHAUMBURG  
 STAGING PLANS  
 ILLINOIS ROUTE 59  
 STAGE 3



SCALE AS SHOWN  
 DATE MARCH 18, 2008  
 DRAWN BY REW  
 CHECKED BY JCM