

CONTRACT NO. 62417

FAP NO.	SECTION	COUNTY	TOTAL SHEETS	SHEET NO.
338	(113 & 114) R-5	WILL	525	154
STA. 3260+00		TO STA. 3274+00		
FED. ROAD DIST. NO.	ILLINOIS	FAP 338 (IL RTE. 59)		

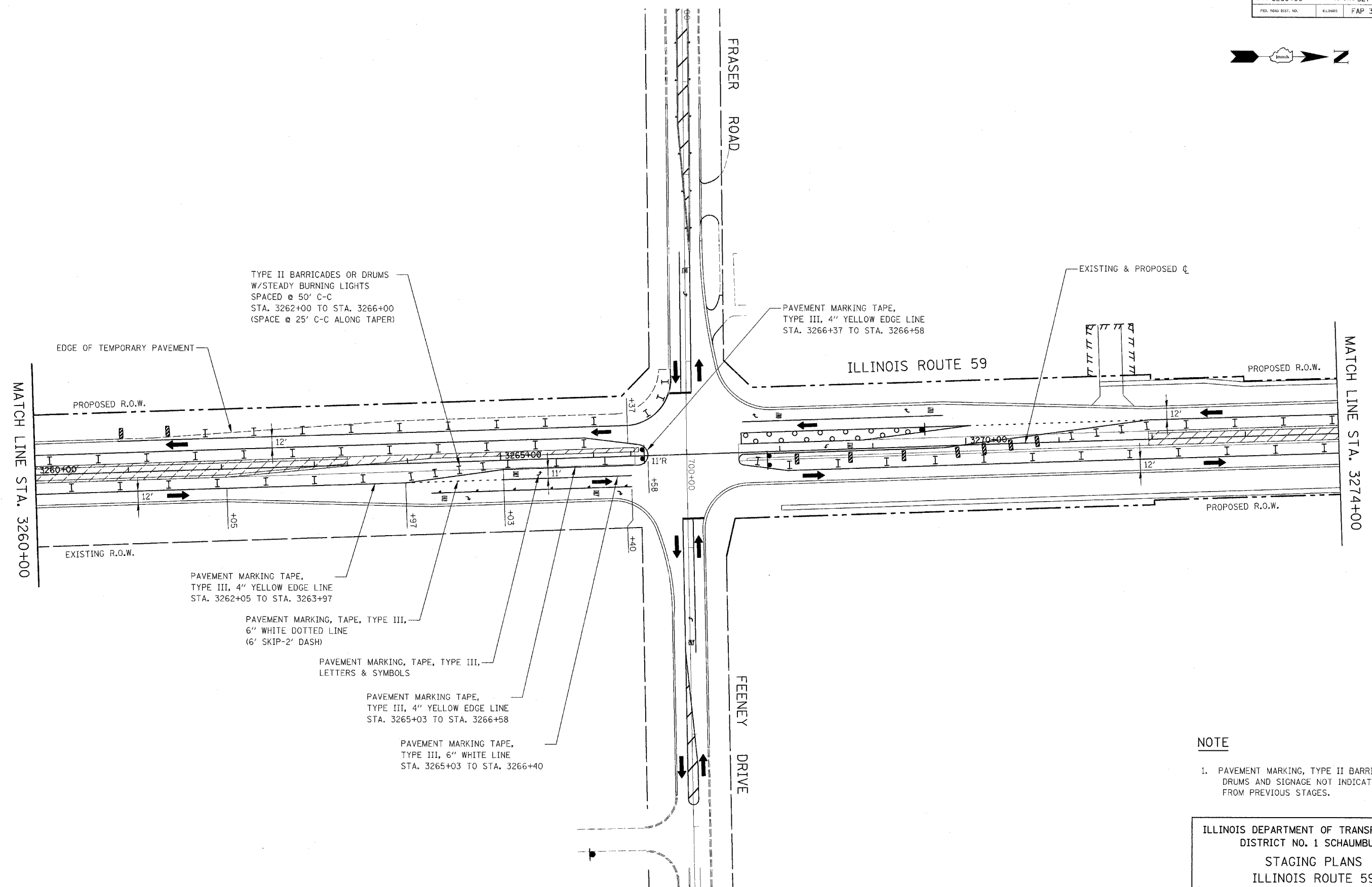

TYPE II BARRICADES OR DRUMS
W/STEADY BURNING LIGHTS
SPACED @ 50' C-C
STA. 3262+00 TO STA. 3266+00
(SPACE @ 25' C-C ALONG TAPER)

PAVEMENT MARKING TAPE,
TYPE III, 4" YELLOW EDGE LINE
STA. 3266+37 TO STA. 3266+58

MATCH LINE STA. 3260+00

MATCH LINE STA. 3274+00

EDGE OF TEMPORARY PAVEMENT

PROPOSED R.O.W.

EXISTING R.O.W.

PAVEMENT MARKING TAPE,
TYPE III, 4" YELLOW EDGE LINE
STA. 3262+05 TO STA. 3263+97

PAVEMENT MARKING, TAPE, TYPE III,
6" WHITE DOTTED LINE
(6' SKIP-2' DASH)

PAVEMENT MARKING, TAPE, TYPE III,
LETTERS & SYMBOLS

PAVEMENT MARKING TAPE,
TYPE III, 4" YELLOW EDGE LINE
STA. 3265+03 TO STA. 3266+58

PAVEMENT MARKING TAPE,
TYPE III, 6" WHITE LINE
STA. 3265+03 TO STA. 3266+40

ILLINOIS ROUTE 59

FRASER ROAD

FEENEY DRIVE

NOTE

1. PAVEMENT MARKING, TYPE II BARRICADES OR DRUMS AND SIGNAGE NOT INDICATED REMAIN FROM PREVIOUS STAGES.

ILLINOIS DEPARTMENT OF TRANSPORTATION
DISTRICT NO. 1 SCHAUMBURG
STAGING PLANS
ILLINOIS ROUTE 59
STAGE 3

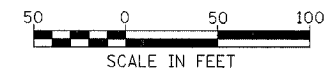

SCALE AS SHOWN
DATE MARCH 18, 2008
DRAWN BY REW
CHECKED BY JCM