

FAP NO.	SECTION	COUNTY	TOTAL SHEETS	SHEET NO.
338	(113 & 114) R-5	WILL	525	192
STA. 3316+00		TO STA. 3330+00		
FED. ROAD DIST. NO.		ILLINOIS		
		FAP 338 (ILL. RTE. 59)		

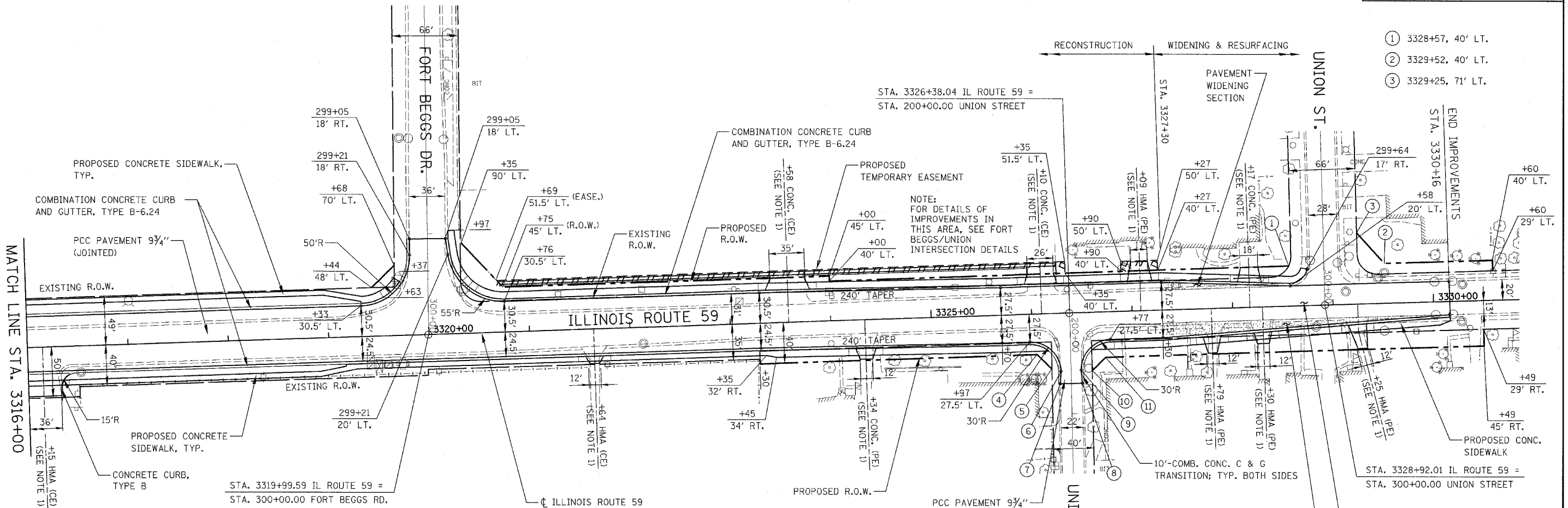

- ① 3328+57, 40' LT.
- ② 3329+52, 40' LT.
- ③ 3329+25, 71' LT.

**NOTES:**

1. DRIVEWAY & GEOMETRICS MATERIAL SHALL BE IN ACCORDANCE WITH IDOT DISTRICT 1 STANDARDS BD-01 AND BD-02.

- ④ 3326+04, 40' RT.
- ⑤ 3326+18, 55' RT.
- ⑥ 200+58, 10' RT.
- ⑦ 200+70, 11' RT.
- ⑧ 200+70, 11' LT.
- ⑨ 200+58, 10' LT.
- ⑩ 3326+58, 58' RT.
- ⑪ 3326+72, 45' RT.

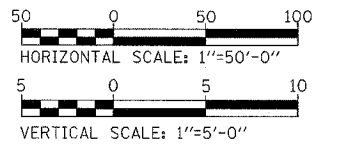

DATE	BY
DATE	BY
DATE	BY

DATE	BY
DATE	BY
DATE	BY

