

FAP NO.	SECTION	COUNTY	TOTAL SHEETS	SHEET NO.
338	(113 & 114) R-5	WILL	525	193
STA. 696+13.48		TO STA. 703+65.64		
FED. ROAD DIST. NO.		ILLINOIS FAP 338 (IL RTE. 59)		

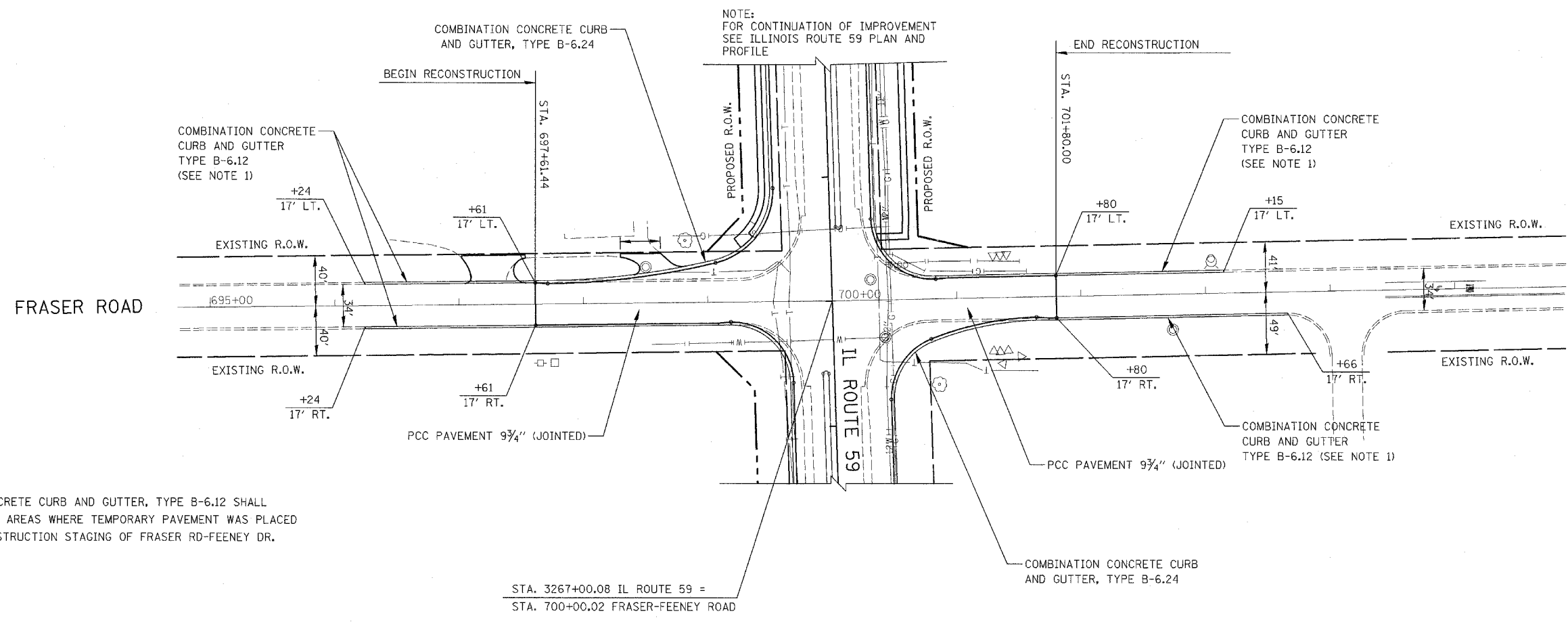

NOTES:

1. COMBINATION CONCRETE CURB AND GUTTER, TYPE B-6.12 SHALL BE INSTALLED IN AREAS WHERE TEMPORARY PAVEMENT WAS PLACED DURING THE CONSTRUCTION STAGING OF FRASER RD-FEENEY DR.

STA. 3267+00.08 IL ROUTE 59 =
STA. 700+00.02 FRASER-FEENEY ROAD

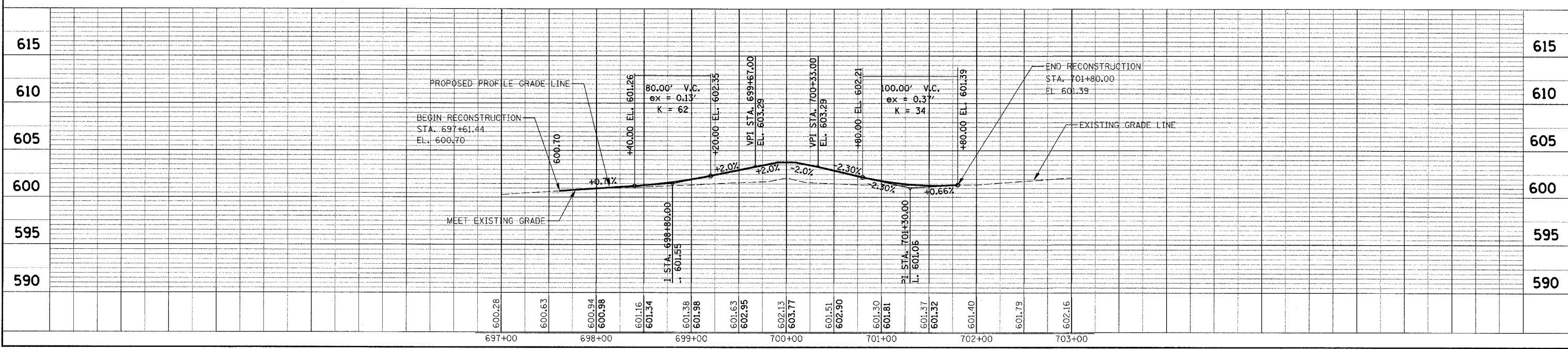
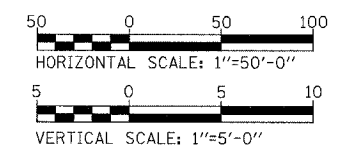

PLAN /PROFILE - FRASER RD./FEENEY DR.

DATE	BY
SURVEYED	PLANNED
PLOTTED	DESIGNED
NOTE BOOK	FILED
NO.	CADD FILE NAME

DATE	BY
PROFILE	STRUCTURE NOTATIONS
PLOTTED	CHG
NOTE BOOK	NO.
NO.	STRUCTURE NOTATIONS